

MAINSTAYS PERKINS ROLLING FILE CABINET

VENDOR STOCK NUMBERS

MS18-D1-1009-36 WHITE

MS18-D1-1009-37 TRUE BLACK OAK

MS18-D1-1009-38 COCOA

TOP PANEL MAXIMUM LOAD
11 LB (5 KG)

DRAWERS MAXIMUM LOAD
4.4 LB (2 KG)

ADJUSTABLE SHELF MAXIMUM
LOAD 11 LB (5 KG)

BOTTOM PANEL MAXIMUM LOAD
11 LB (5 KG)

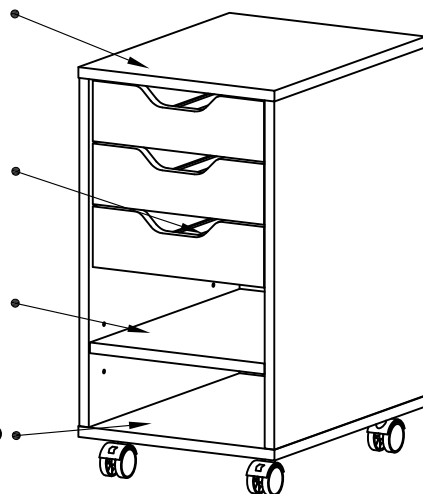

RECOMMENDED NUMBER OF PEOPLE FOR ASSEMBLY : 1
ESTIMATED ASSEMBLY TIME: 1 HOUR

- CALL OUR TOLL FREE NUMBER **1-800-729-1569** FOR FURTHER ASSISTANCE.
- ADDITIONAL PARTS ARE AVAILABLE FOR A FEE.
- THIS INSTRUCTION BOOK CONTAINS IMPORTANT SAFETY INFORMATION, PLEASE READ IT AND KEEP FOR FUTURE REFERENCE.
- DO NOT ALLOW CHILDREN TO CLIMB OR PLAY ON THE UNIT.
- CLEAN THE PRODUCT WITH YOUR FAVORITE FURNITURE POLISH AND A SOFT CLOTH.
- DO NOT USE HARSH CHEMICALS OR ABRASIVE CLEANERS.
- MOVE YOUR NEW FURNITURE CAREFULLY WITH TWO PEOPLE. NEVER PUSH OR DRAG THE UNIT.

DO NOT RETURN THE PRODUCT TO THE STORE.
INDIVIDUAL STORES DO NOT STOCK PARTS.
FOR MISSING OR DAMAGED PARTS CALL 1-800-729-1569.
PARTS WILL BE SHIPPED FREE OF CHARGE.

FOR PROMPT, RELIABLE SERVICE, PLEASE HAVE YOUR ASSEMBLY MANUAL READY.

LOT NUMBER _____
DATE OF PURCHASE ____/____/____

Huisen Furniture (Longnan) Co.,Ltd.
Designed in the USA
Made in China



We are available to assist you Monday -Friday
from 9:00 am - 5:00 pm Eastern Standard Time.
1-800-729-1569
USA only.

MAINSTAYS PERKINS ROLLING FILE CABINET

VENDOR STOCK NUMBERS

MS18-D1-1009-36 WHITE

MS18-D1-1009-37 TRUE BLACK OAK

MS18-D1-1009-38 COCOA



BEFORE STARTING

- Read and understand all the steps carefully before starting. If each step is not followed in the correct order the assembly will be difficult and may result in damages.
- Work in a spacious area, preferably on a carpeted surface, near where the unit will be used.
- Make sure all the parts are included. Most boards are labeled with a removable sticker.

Helpful hints

- Call our toll free number if you need assistance. We are available to assist you Monday - Friday from 9:00 am - 5:00 pm Eastern Standard Time.
- **1-800-729-1569** USA only.

TOOLS NEEDED TO ASSEMBLE

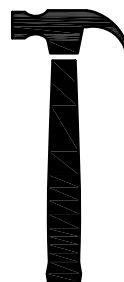

hammer



flat head
screw driver



philips head
screw driver

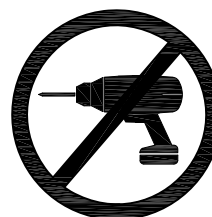

**DO NOT USE POWER TOOLS TO
ASSEMBLE YOUR FURNITURE.
POWER TOOLS MAY DAMAGE THE
PARTS AND RESULT IN DAMAGE.**

Huisen Furniture (Longnan) Co.,Ltd.
Designed in the USA
Made in China



We are available to assist you Monday -Friday
from 9:00 am - 5:00 pm Eastern Standard Time.
1-800-729-1569
USA only.

MAINSTAYS PERKINS ROLLING FILE CABINET

VENDOR STOCK NUMBERS

MS18-D1-1009-36 WHITE

MS18-D1-1009-37 TRUE BLACK OAK

MS18-D1-1009-38 COCOA

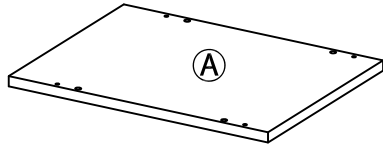

Top panel
(Qty: 1)

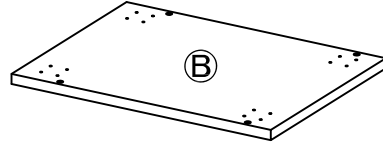

Bottom panel
(Qty: 1)

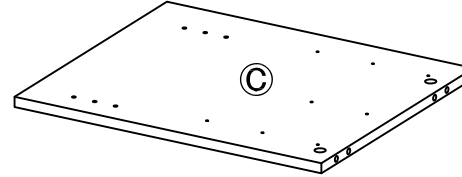

Left side panel
(Qty: 1)

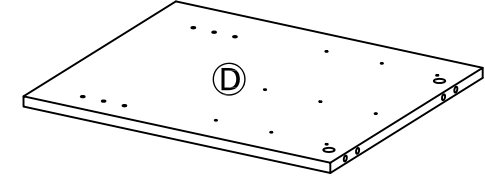

Right side panel
(Qty: 1)

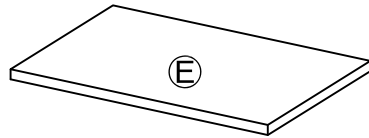

Adjustable shelf
(Qty: 1)

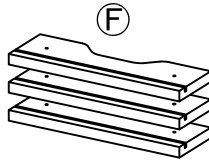

Drawer front panel
(Qty: 3)

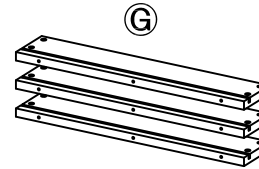

Drawer left side panel
(Qty: 3)

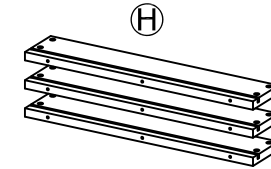

Drawer right side panel
(Qty: 3)

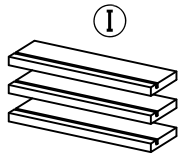

Drawer back panel
(Qty: 3)

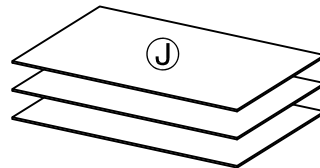

Drawer bottom panel
(Qty: 3)

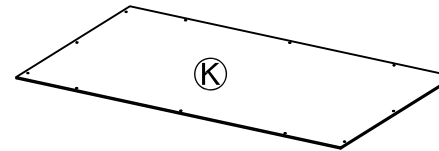

Back panel
(Qty: 1)

VERIFY THAT ALL PARTS ARE LISTED BEFORE BEGINNING



We are available to assist you Monday -Friday
from 9:00 am - 5:00 pm Eastern Standard Time.
1-800-729-1569
USA only.

MAINSTAYS PERKINS ROLLING FILE CABINET

VENDOR STOCK NUMBERS
MS18-D1-1009-36 WHITE
MS18-D1-1009-37 TRUE BLACK OAK
MS18-D1-1009-38 COCOA

①

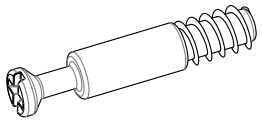

Cam bolt
Qty: 4

②

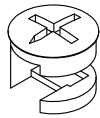

Cam lock
Qty: 4

③

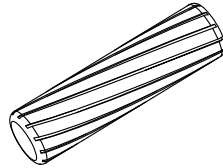

Wood dowel
Qty: 8

④

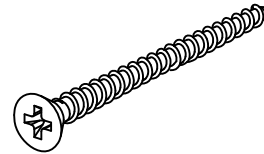

Screw 1
Qty: 16

⑤

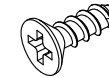

Screw 2
Qty: 52+2 Extra

⑥



Screw 3
Qty: 12

⑦

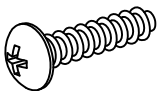

Screw 4
Qty: 6

⑧

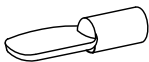

Shelf support
Qty: 4

⑨

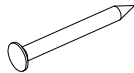

Nail
Qty: 12

⑩

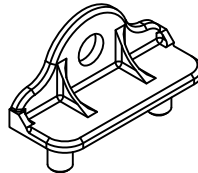

Plastic connector
Qty: 6

⑪

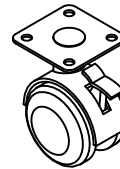

Locking caster
Qty: 2

⑫

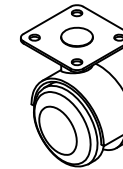

Caster
Qty: 2

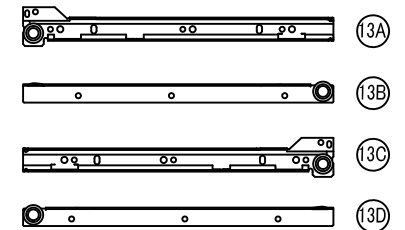

Drawer slide
Qty: 3

VERIFY THAT ALL PARTS ARE LISTED BEFORE BEGINNING



We are available to assist you Monday -Friday
from 9:00 am - 5:00 pm Eastern Standard Time.
1-800-729-1569
USA only.

MAINSTAYS PERKINS ROLLING FILE CABINET

VENDOR STOCK NUMBERS

MS18-D1-1009-36 WHITE

MS18-D1-1009-37 TRUE BLACK OAK

MS18-D1-1009-38 COCOA

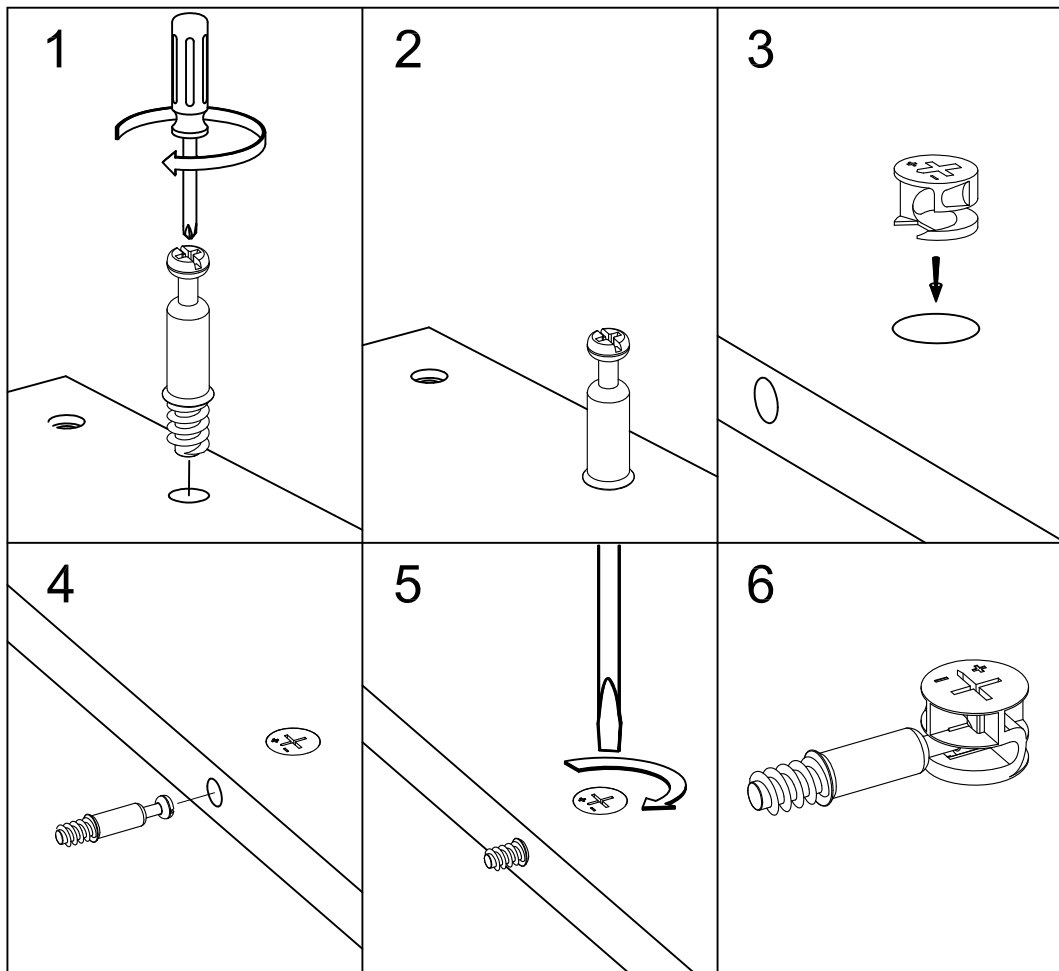

CAM FASTENING SYSTEM

1. Screw the **cam bolt** into the predrilled panel. The screw should be tightened so no threads are visible.
2. The larger ring of the cam should touch the panel.
3. Insert the **cam lock** into the predrilled hole in the panel. The plus and minus signs should be facing the outside of the panel.
4. Connect the previously tightened **cam bolt** with the panel connected into the **cam lock**.
5. Using a flat head screw driver, turn the **cam lock** halfway counterclockwise to secure the **cam bolt**.
6. **FAILURE TO PROPERLY SECURE THE CAM LOCK AND CAM BOLT COULD RESULT IN PRODUCT INSTABILITY AND FAILURE.**

Huisen Furniture (Longnan) Co.,Ltd.
Designed in the USA
Made in China



We are available to assist you Monday -Friday
from 9:00 am - 5:00 pm Eastern Standard Time.
1-800-729-1569
USA only.

1

Insert hardware ① into part A as shown.

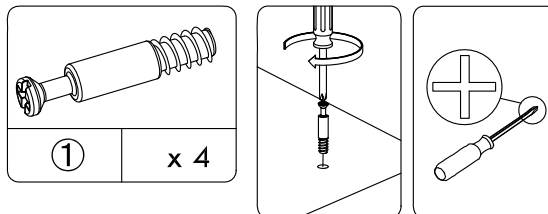
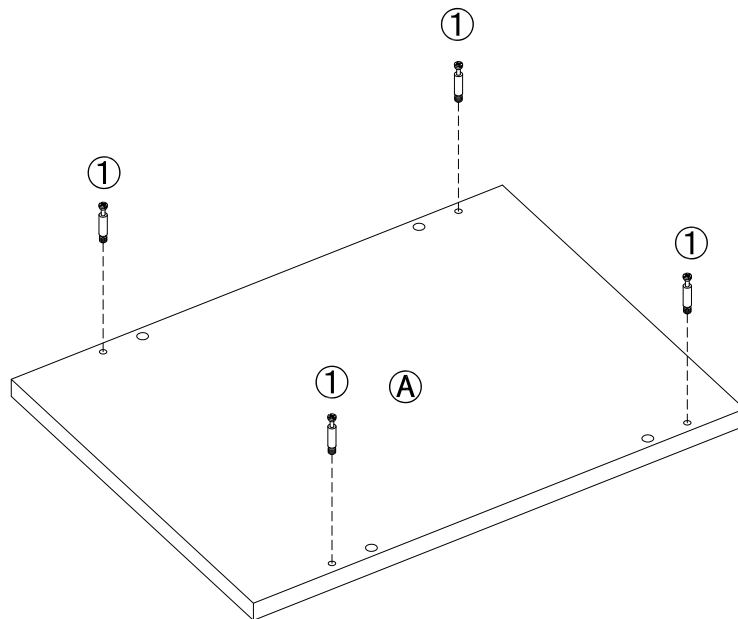

Cam bolt

2

Insert hardware ⑤ ⑪ ⑫ into part B as shown.

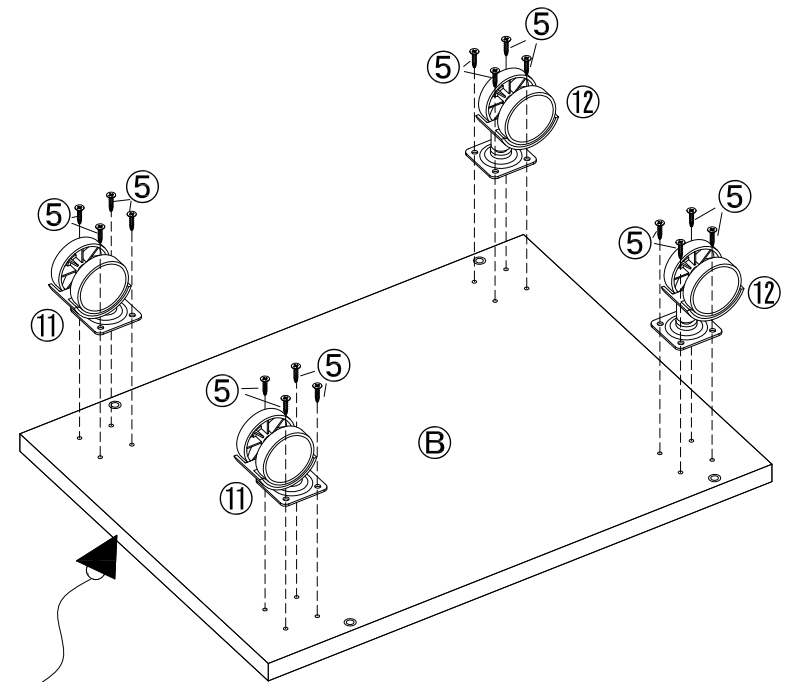

Finished edge

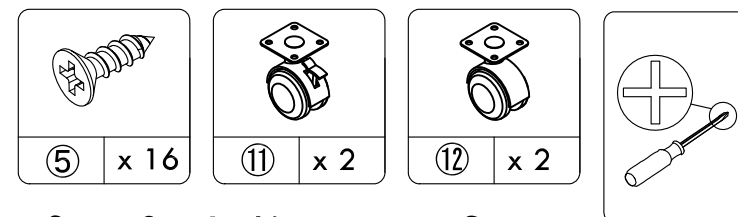

Screw 2

Locking caster

Caster

3

Insert hardware ② ③ ⑤ ⑬A ⑬C into part C & D as shown.

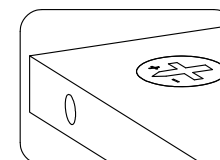
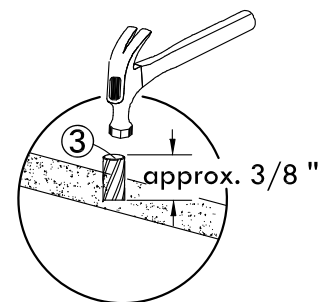
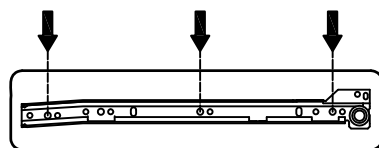
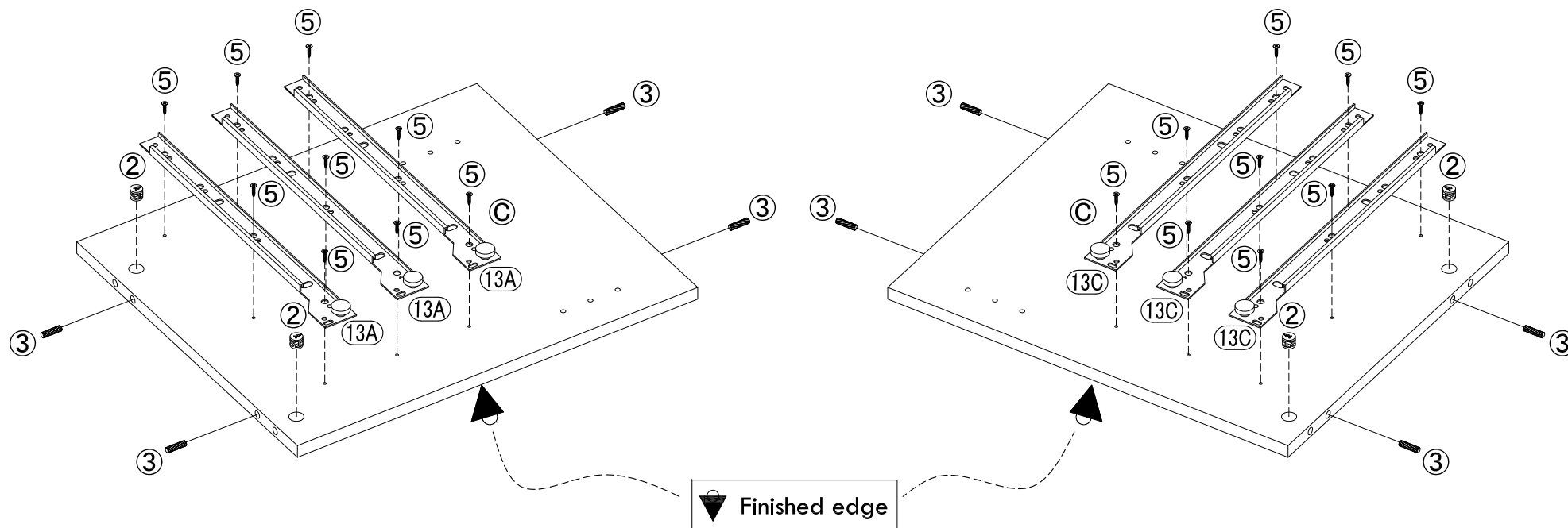

arrow of cam
lock points to
predrilled hole

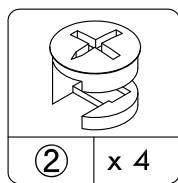

Cam lock

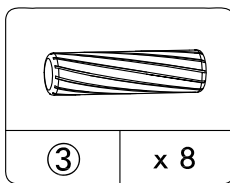

Wood dowel

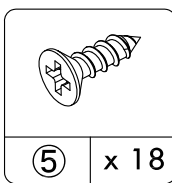

Screw 2

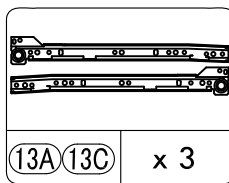

Drawer slide

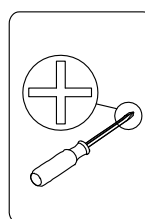

4

Attach part B to part C & D using screw ④ as shown.
Attach part A to part C & D and then tighten the cam
locks ②.

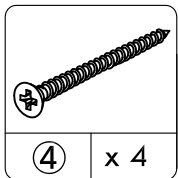
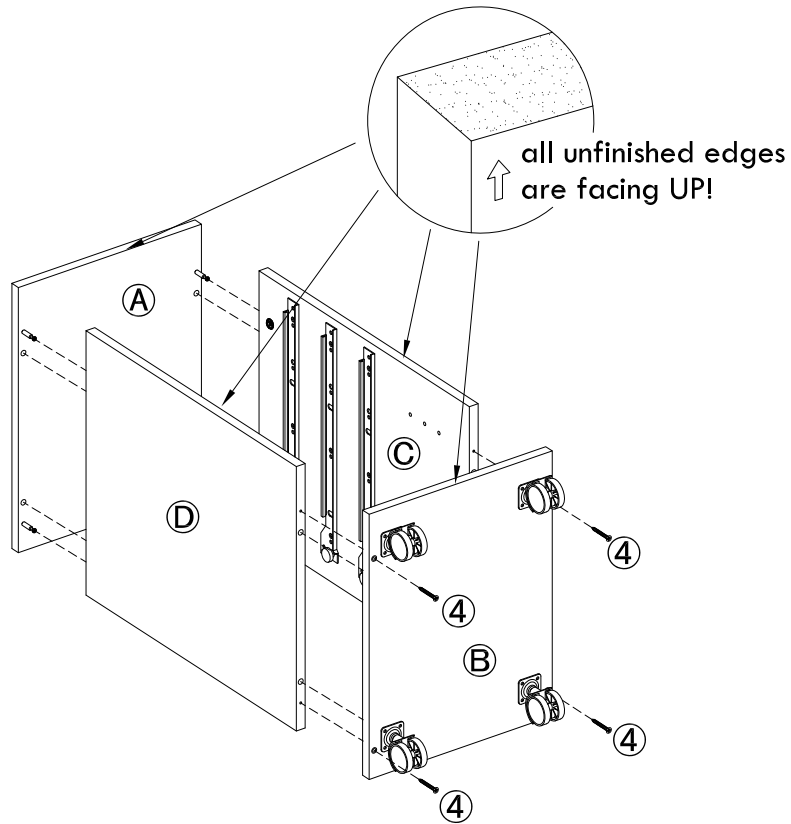

Screw 1

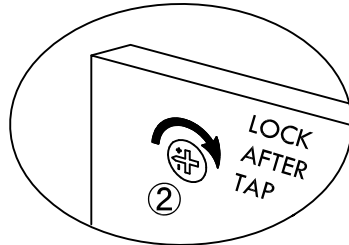
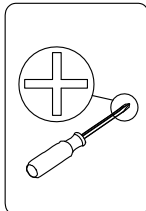

5

Align and attach part K to the unit using nail ⑨ as shown.

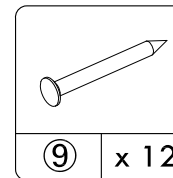
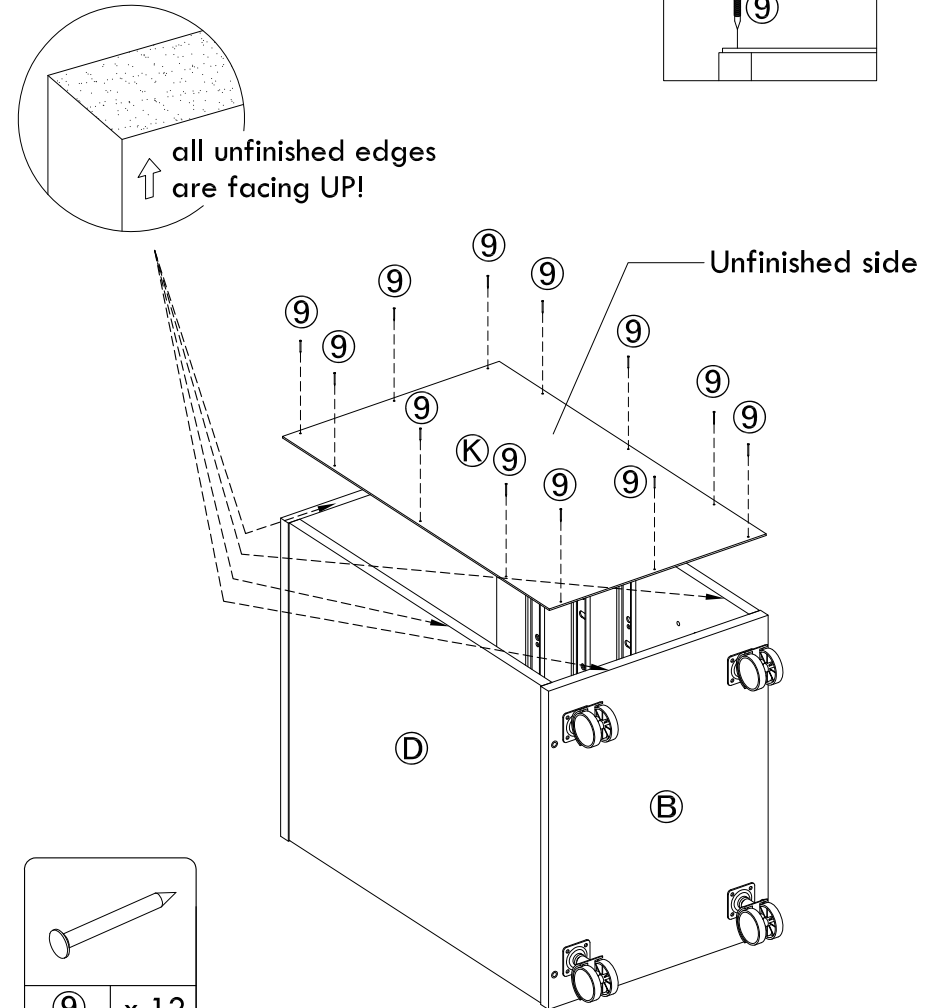
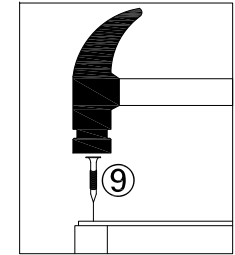

Nail

6

Attach part G & H to part I using screw ④ as shown.

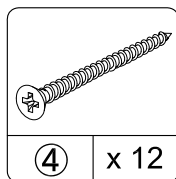
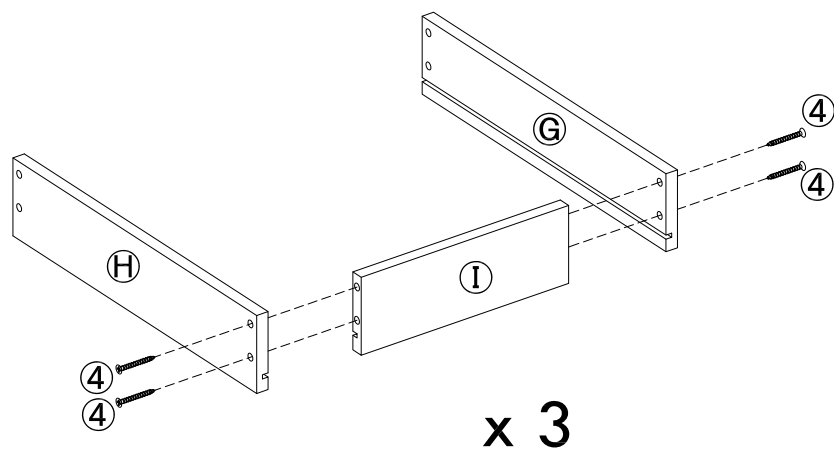

Screw 1

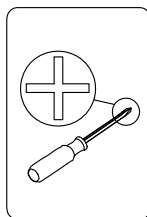

7

Insert part J to the bottom as shown. then attach part F to the structure using screw ⑥⑦ as shown.

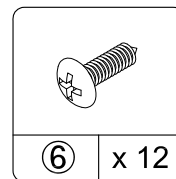
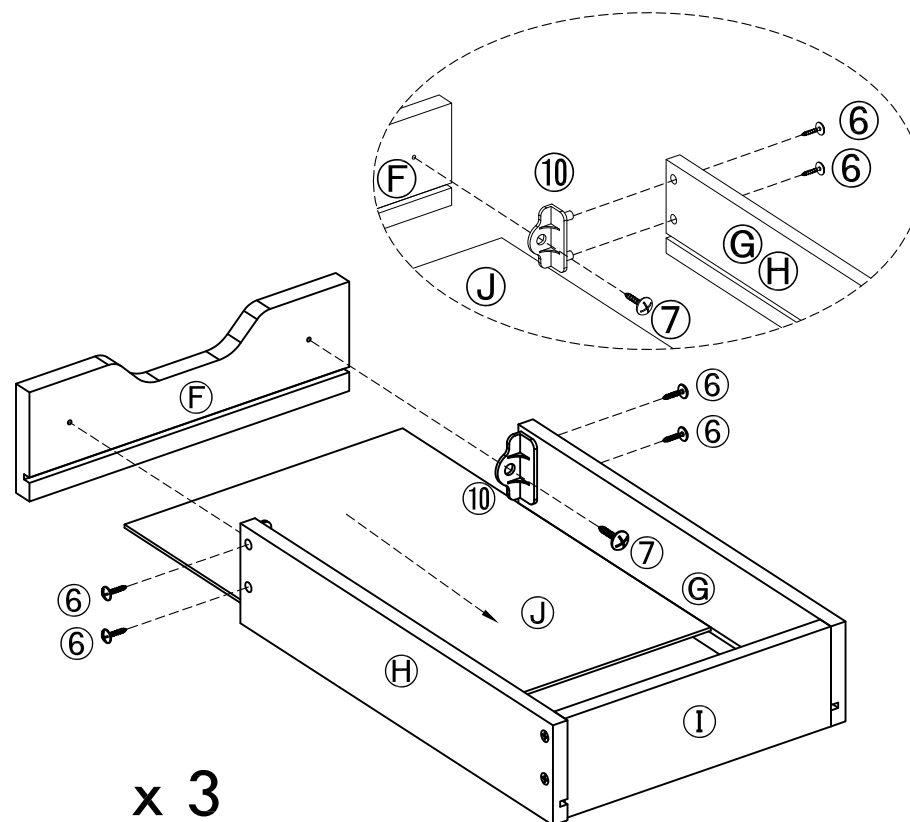

Screw 3

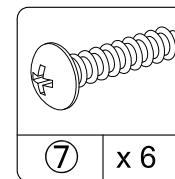

Screw 4

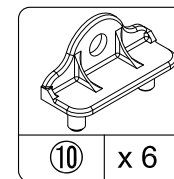

Plastic connector

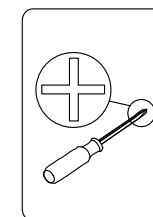

8

Attach drawer slides (13B) (13D) to part G & H using screw (5) as shown.

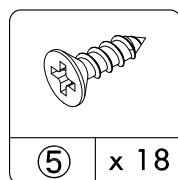
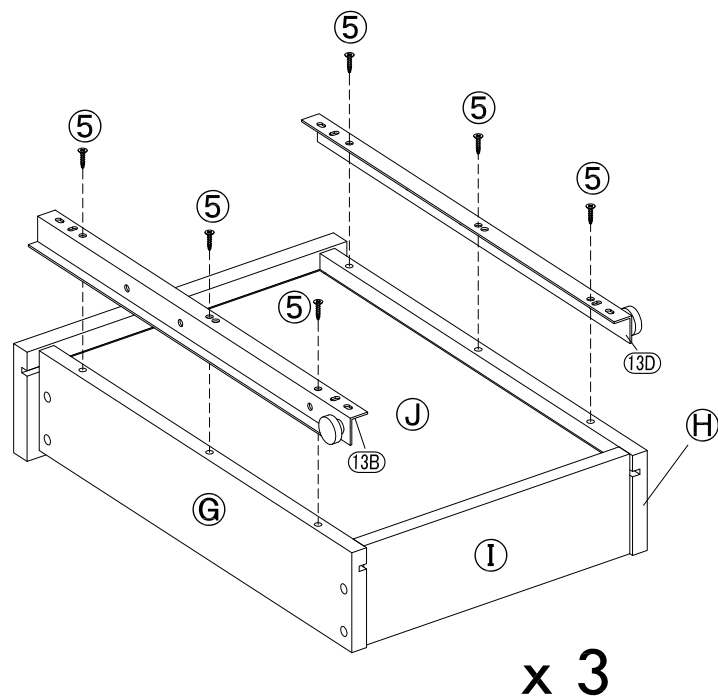

Screw 2

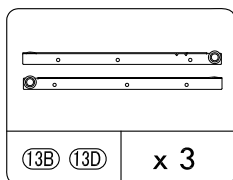

Drawer slide

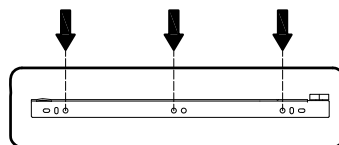
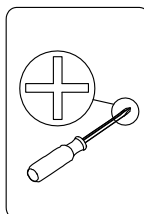

9

Put the drawers inside as shown

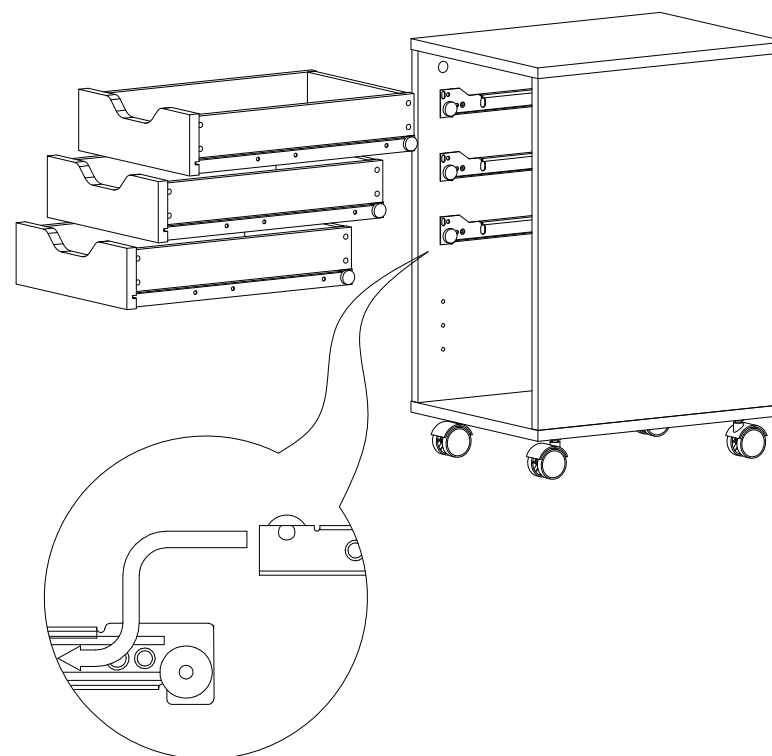

10

Insert the shelf support ⑧ to part C & D, Then place part E on shelf supports as shown.

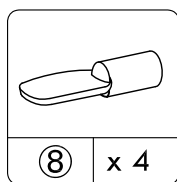
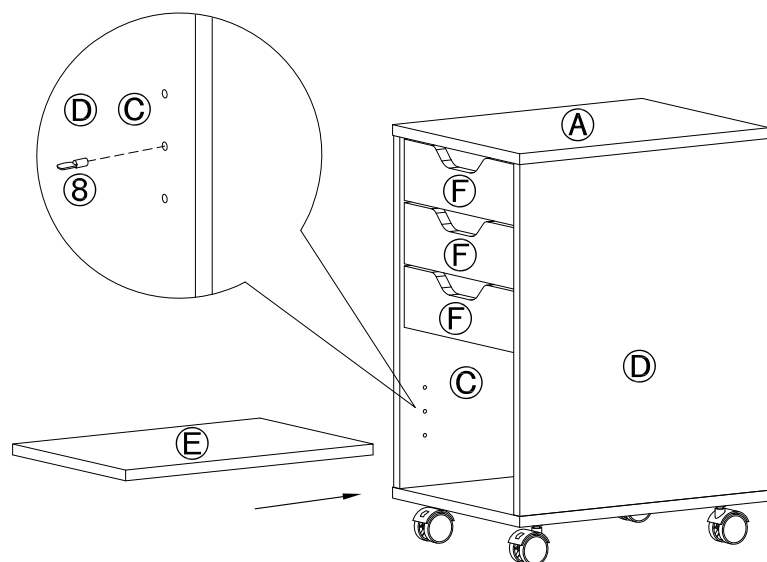

⑧ x 4

Shelf support

11

Now Your Unit Is Completed

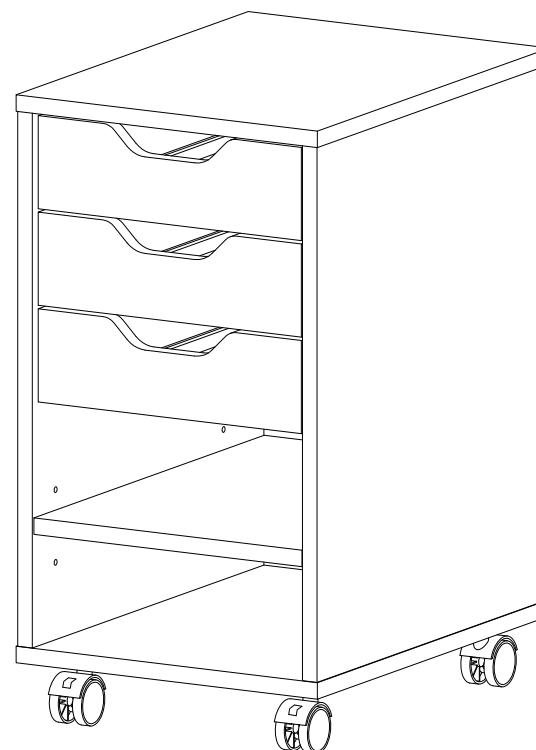

**Please call for replacement parts or assistance: 1-800-729-1569
Monday - Friday 9:00 am - 5:00 pm EST**

MAINSTAYS PERKINS GABINETE DEL ARCHIVO DEL BALANCEO

NÚMERO DE STOCK DEL VENDEDOR
MS18-D1-1009-36 BLANCO
MS18-D1-1009-37 VERDADERO ROBLE NEGRO
MS18-D1-1009-38 CACAO

PANEL SUPERIOR CARGA MÁXIMA
11 LB (5 KG)

CAJONES CARGA MÁXIMA
4.4 LB (2 KG)

ESTANTE AJUSTABLE CARGA
MÁXIMA 11 LB (5 KG)

PANEL INFERIOR CARGA MÁXIMA
11 LB (5 KG)

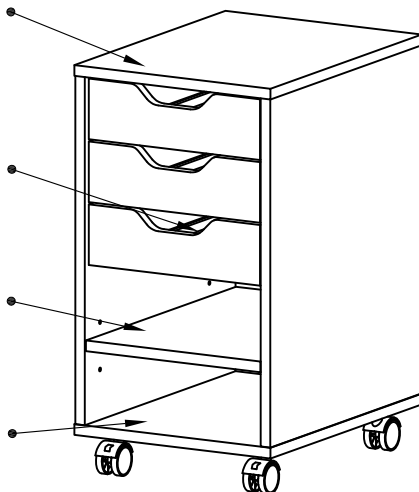

NÚMERO DE PERSONAS RECOMENDADO PARA EL ENSAMBLAJE: 1
TIEMPO ESTIMADO DE ENSAMBLAJE: 1.0 HORA.

- LLAME A NUESTRO NÚMERO GRATUITO **1-800-729-1569** PARA OBTENER MÁS AYUDA.
- PIEZAS ADICIONALES ESTÁN DISPONIBLES POR UNA TARIFA.
- ESTE MANUAL DE INSTRUCCIÓN CONTIENE INFORMACIÓN IMPORTANTE DE SEGURIDAD, POR FAVOR DE LEER Y GUARDAR PARA FUTURAS REFERENCIAS.
- NO DEJAR A LOS NIÑOS SUBIR O JUGAR SOBRE LA UNIDAD.
- LIMPIAR EL PRODUCTO CON TU PULIDOR FAVORITE DE MUEBLE Y UN TRAPO BLANDO.
- NO USAR QUÍMICOS FUERTES O PRODUCTO DE LIMPIEZA ABRASIVO.
- MUEVA SUS NUEVOS MUEBLES CUIDADOSAMENTE CON DOS PERSONAS, NUNCA EMPUJE O ARRASTRE LA UNIDAD.

NO DEVOLVER EL PRODUCTO A LA TIENDA.
TIENDAS INDIVIDUALES NO RESERVAN PIEZAS.
PARA PIEZAS PERDIDAS O DAÑADAS LLAME AL 1-800-729-1569.
PARTES SERÁN ENVIADOS DE FORMA GRATUITA
PARA UN SERVICIO RÁPIDO Y CONFIABLE, POR FAVOR DE TENER A MANO EL MANUAL DE ENSAMBLAJE.

NÚMERO DE PARTIDA _____
FECHA DE COMPRA ____/____/____

Huisen Furniture (Longnan) Co.,Ltd.
Diseñado en el E.E.U.U.
Hecho en China



Estamos disponibles para ayudarlo de Lunes - Viernes
de 9:00 am - 5:00 pm Hora de la Zona Este.
1-800-729-1569
Sólo E.E.U.U.

MAINSTAYS PERKINS GABINETE DEL ARCHIVO DEL BALANCEO

NÚMERO DE STOCK DEL VENDEDOR

MS18-D1-1009-36 BLANCO

MS18-D1-1009-37 VERDADERO ROBLE NEGRO

MS18-D1-1009-38 CACAO



ANTES DE COMENZAR

- Leer y entender todos los pasos cuidadosamente antes de comenzar. si no se sigue cada paso en el orden correcto, el montaje será difícil y puede ocasionar daños.
- Trabajar en una zona amplia, mejor sobre la alfombra, cerca del sitio donde la unidad se utiliza.
- Asegurarse de que todas las piezas estén incluidos. La mayoría de los tableros están etiquetados con una pegatina removible.

CONSEJOS ÚTILES

- Llamar a nuestro número gratis para ayuda. Estamos disponibles para ayudarlo de Lunes - Viernes de 9:00 am - 5:00 pm Hora de la Zona Este.
- **1-800-729-1569** Sólo E.E.U.U.

HERRAMIENTAS NECESARIAS PARA ENSAMBLAR

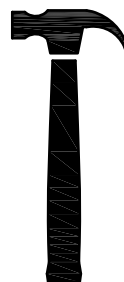

martillo



destornillador de
cabeza plana



destornillador de
cabeza phillips

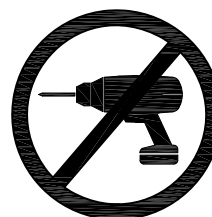

**NO UTILICE HERRAMIENTAS
ELÉCTRICAS PARA MONTAR SUS
MUEBLES. HERRAMIENTAS
ELÉCTRICAS PUEDEN DAÑAR LAS
PIEZAS Y PROVOCAR DAÑOS**

Huisen Furniture (Longnan) Co.,Ltd.
Diseñado en el E.E.U.U.
Hecho en China



Estamos disponibles para ayudarlo de Lunes - Viernes
de 9:00 am - 5:00 pm Hora de la Zona Este.
1-800-729-1569
Sólo E.E.U.U.

MAINSTAYS PERKINS GABINETE DEL ARCHIVO DEL BALANCEO

NÚMERO DE STOCK DEL VENDEDOR
MS18-D1-1009-36 BLANCO
MS18-D1-1009-37 VERDADERO ROBLE NEGRO
MS18-D1-1009-38 CACAO

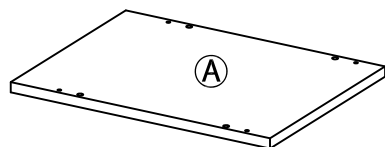

Panel superior
(Cantidad: 1)

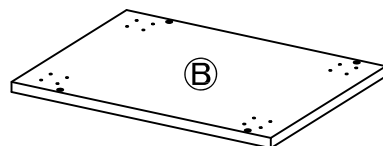

Panel inferior
(Cantidad: 1)

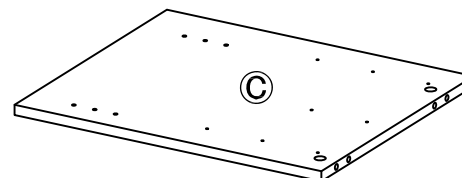

Panel lateral izquierdo
(Cantidad: 1)

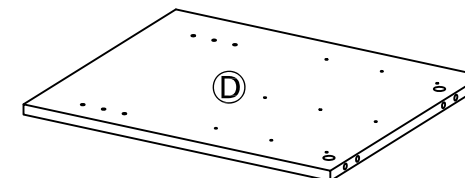

Panel lateral derecho
(Cantidad: 1)

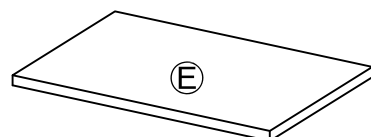

Estante ajustable
(Cantidad: 1)

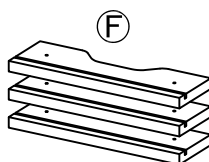

Panel frontal del cajón
(Cantidad: 3)

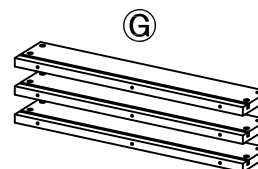

Panel lateral izquierdo del cajón
(Cantidad: 3)

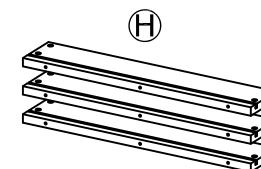

Panel lateral derecho del cajón
(Cantidad: 3)

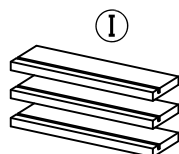

Panel posterior del cajón
(Cantidad: 3)

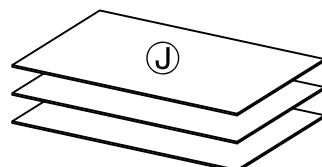

Panel inferior del cajón
(Cantidad: 3)

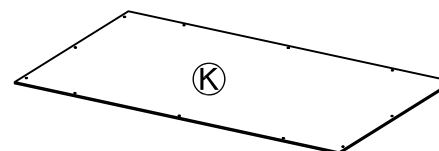

Panel posterior
(Cantidad: 1)

**VERIFIQUE QUE TODAS LAS PIEZAS ESTÉN EN LA LISTA
ANTES DE COMENZAR**



Estamos disponibles para ayudarlo de Lunes - Viernes
de 9:00 am - 5:00 pm Hora de la Zona Este.
1-800-729-1569
Sólo E.E.U.U.

MAINSTAYS PERKINS GABINETE DEL ARCHIVO DEL BALANCEO

NÚMERO DE STOCK DEL VENDEDOR
MS18-D1-1009-36 BLANCO
MS18-D1-1009-37 VERDADERO ROBLE NEGRO
MS18-D1-1009-38 CACAO

①

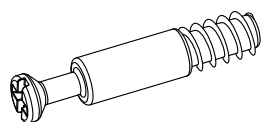

Tornillo de combadura
Cantidad: 4

②

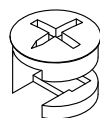

Cerrojo de combadura
Cantidad: 4

③

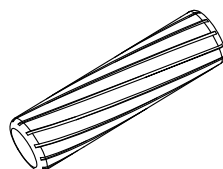

Clavija de madera
Cantidad: 8

④

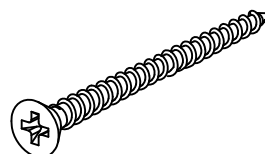

Tornillo 1
Cantidad: 16

⑤

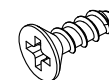

Tornillo 2
Cantidad: 52+2 Extra

⑥



Tornillo 3
Cantidad: 12

⑦

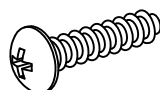

Tornillo 4
Cantidad: 6

⑧



Soporte del estante
Cantidad: 4

⑨

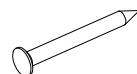

Clavo
Cantidad: 12

⑩

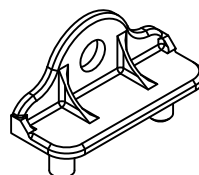

Conector de plástico
Cantidad: 6

⑪

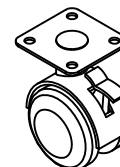

Lanzador de bloqueo
Cantidad: 2

⑫

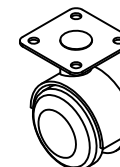

Bloqueo
Cantidad: 2

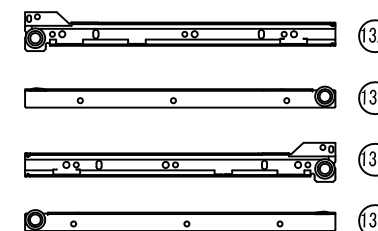

Diapositiva del cajón
Cantidad: 3

**VERIFIQUE QUE TODAS LAS PIEZAS ESTÉN EN LA LISTA
ANTES DE COMENZAR**



Estamos disponibles para ayudarlo de Lunes - Viernes
de 9:00 am - 5:00 pm Hora de la Zona Este.
1-800-729-1569
Sólo E.E.U.U.

MAINSTAYS PERKINS GABINETE DEL ARCHIVO DEL BALANCEO

NÚMERO DE STOCK DEL VENDEDOR

MS18-D1-1009-36 BLANCO

MS18-D1-1009-37 VERDADERO ROBLE NEGRO

MS18-D1-1009-38 CACAO

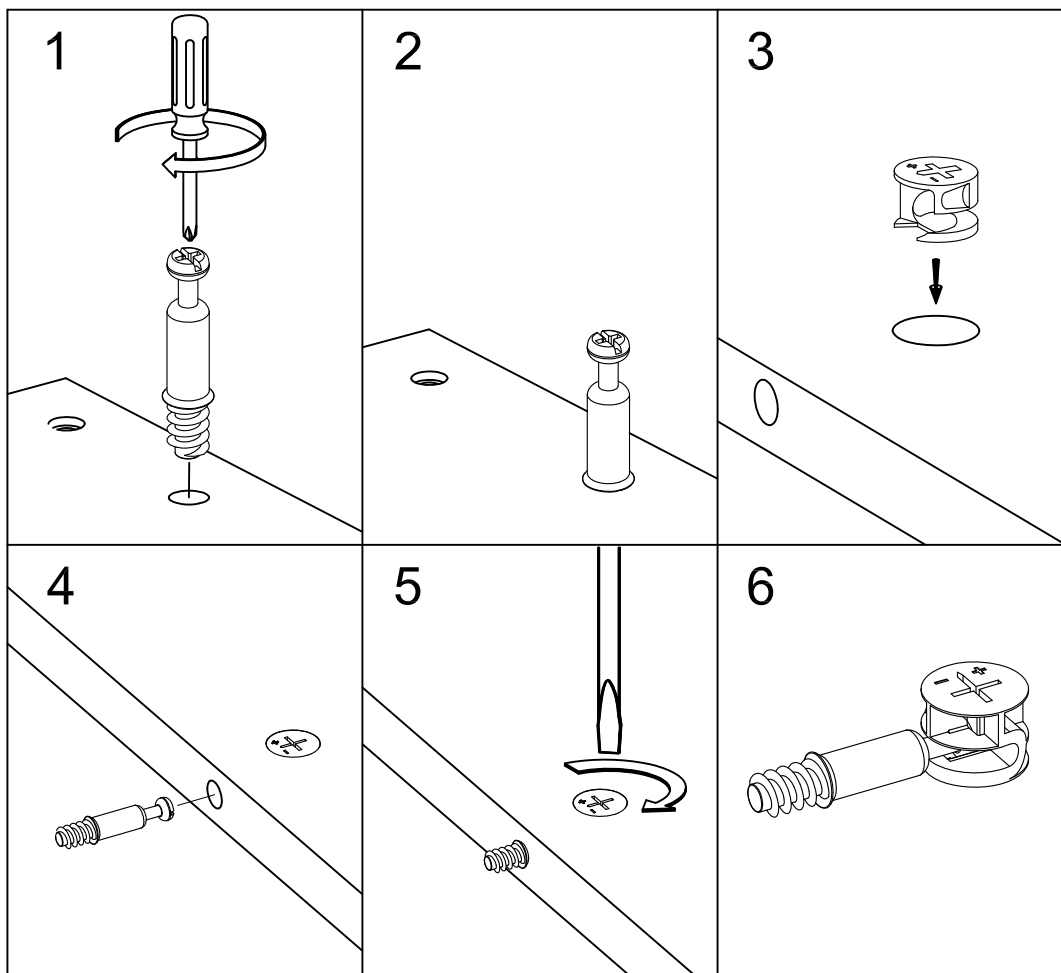

SISTEMA DE FIJACIÓN CAM

1. Atornille el **Tornillo de combadura** en el panel pretaladrado. El tornillo debe apretarse para que no haya roscas visibles.
2. El anillo más grande del cam debe tocar el panel.
3. Inserte el **Cerrojo de combadura** en el agujero pretaladrado en el panel. Los signos de más y menos deben estar orientados hacia el exterior del panel.
4. Conecte el **Tornillo de combadura** previamente apretado con el panel conectado en el **Cerrojo de combadura**.
5. Usando un destornillador de cabeza plana, gire el **Cerrojo de combadura** hasta la mitad en sentido antihorario para asegurar el **Tornillo de combadura**.
6. **SI NO SE ASEGURA ADECUADAMENTE EL CERROJO DE COMBADURA Y EL TORNILLO DE COMBADURA, PODRÍA RESULTAR INESTABILIDAD Y FALLAS EN EL PRODUCTO.**

Huisen Furniture (Longnan) Co.,Ltd.
Diseñado en el E.E.U.U.
Hecho en China



Estamos disponibles para ayudarlo de Lunes - Viernes
de 9:00 am - 5:00 pm Hora de la Zona Este.
1-800-729-1569
Sólo E.E.U.U.

1

Inserte el hardware ① en la parte A como se muestra.

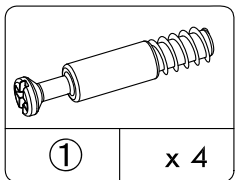
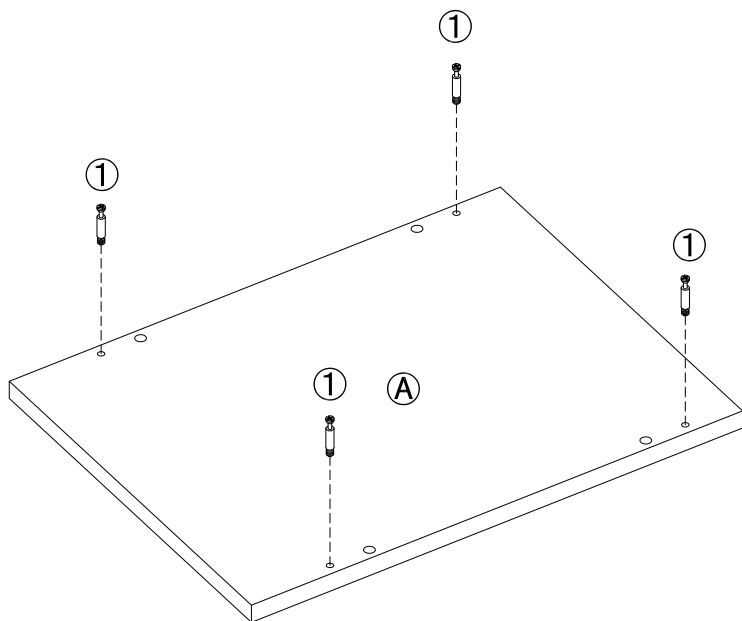

Tornillo de combadura

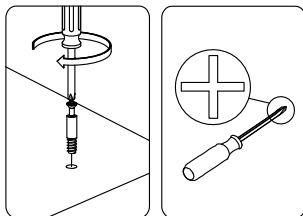

2

Inserte el hardware ⑤ ⑪ ⑫ en la parte B como se muestra.

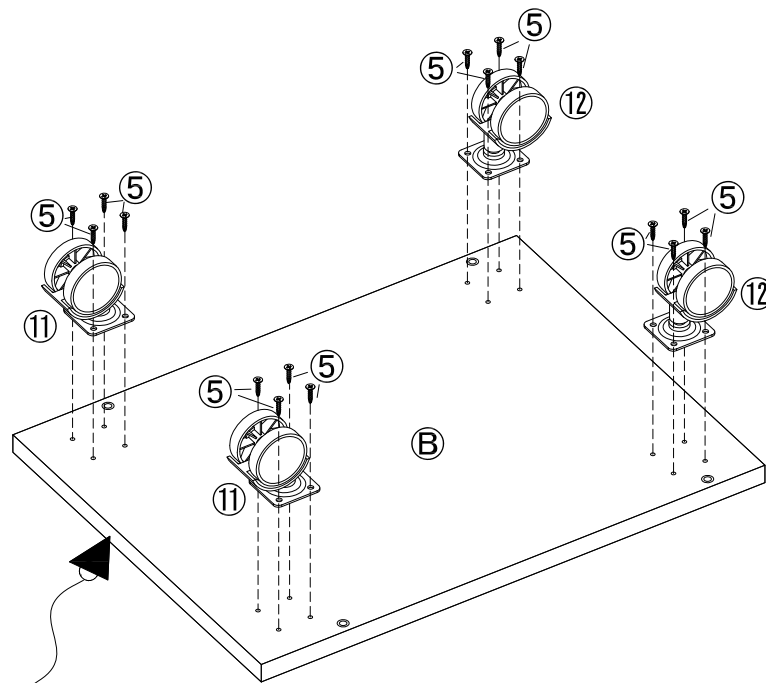

▼ Borde acabado

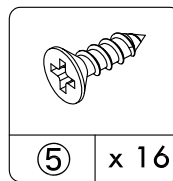

Tornillo 2

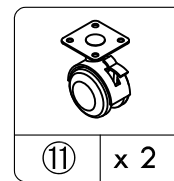

Lanzador de bloqueo

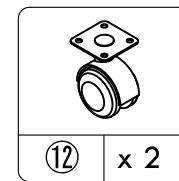

Bloqueo

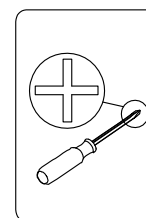

3

Inserte el hardware ② ③ ⑤ ⑬A ⑬C en la parte C y D como se muestra.

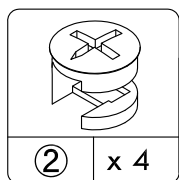
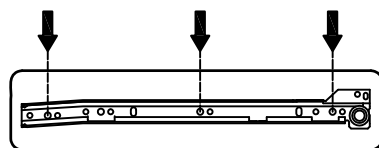
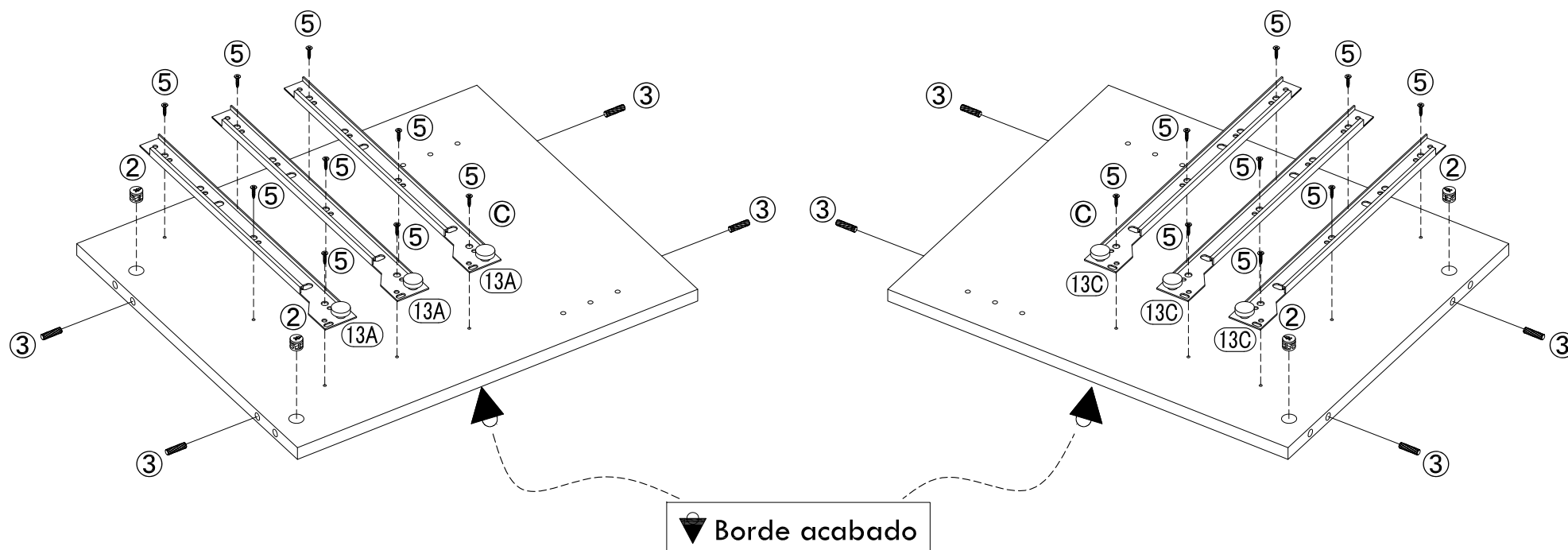

Cerrojo de combadura

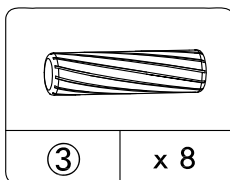

Clavija de madera

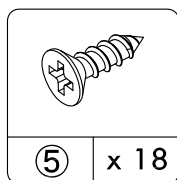

Tornillo 2

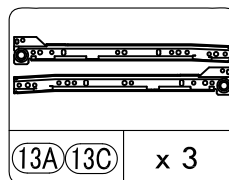

Diapositiva del cajón

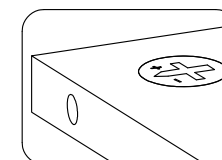
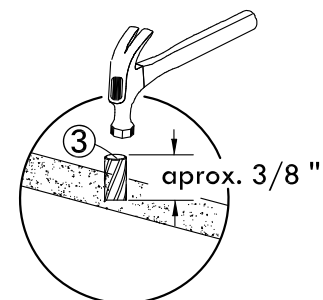
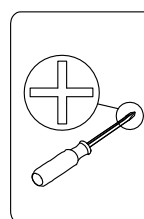

La flecha del camlock debe apuntar al orificio pretaladrado

4

Adjuntar parte B a la parte C y D con el tornillo ④ como se muestra.
Adjuntar parte A a la parte C y D y luego apriete las cerraduras de leva ②.

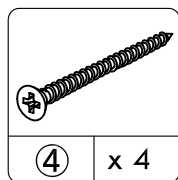
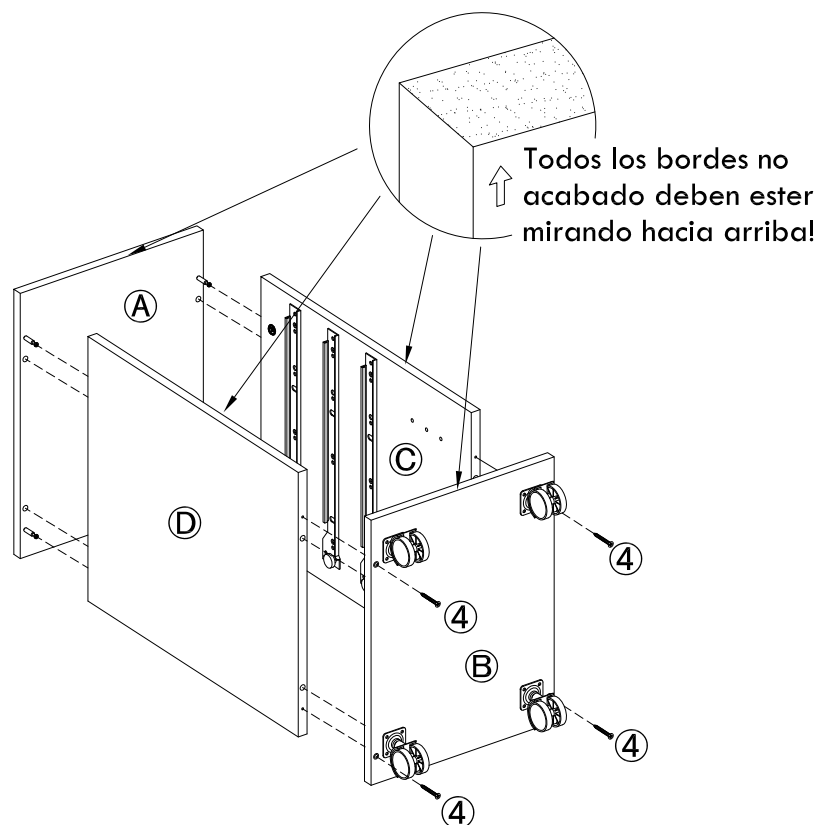

Tornillo 1

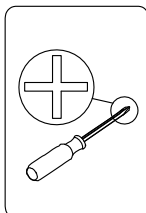

5

Alinee y fije el parte K a la unidad con el clavo ⑨ como se muestra.

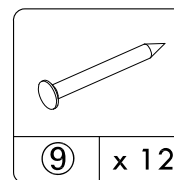
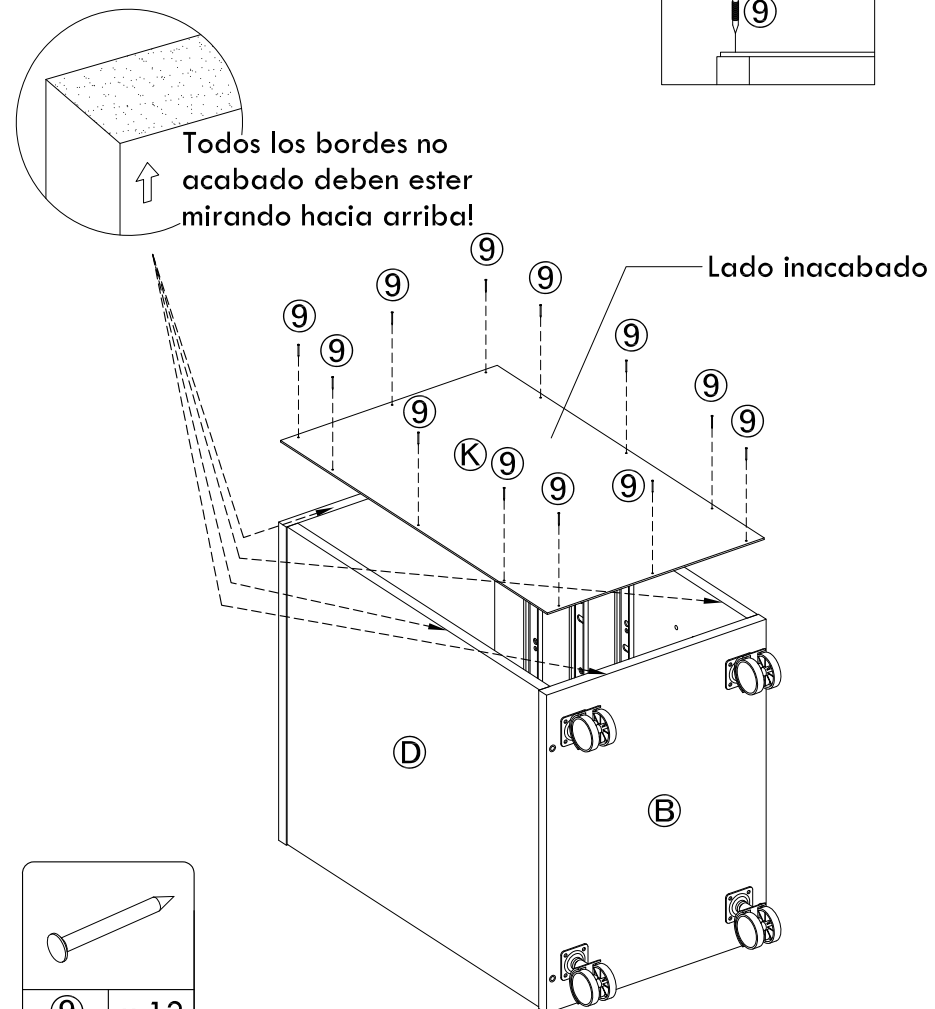
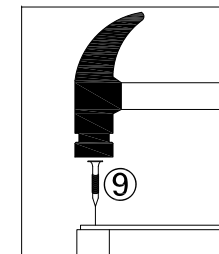

Clavo

6

Adjuntar parte G y H a la parte I con el tornillo ④ como se muestra.

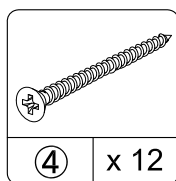
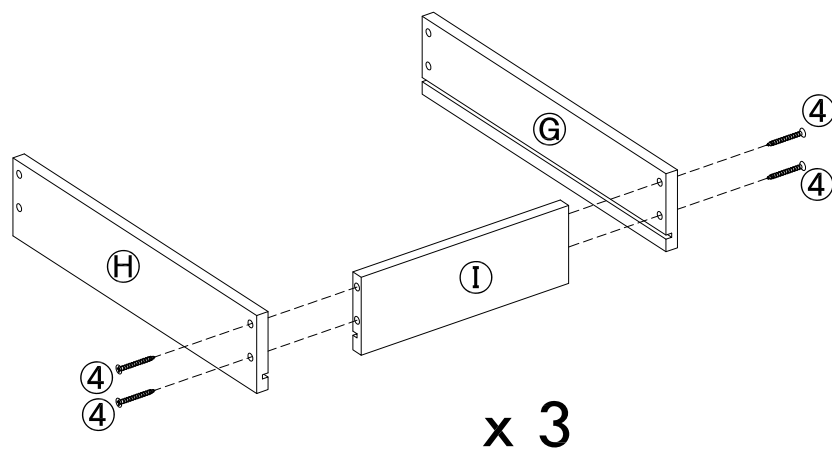

Tornillo 1

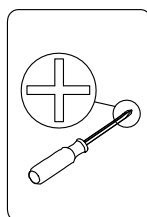

7

inserte la parte J en la parte inferior como se muestra. luego adjunte la parte F a la estructura usando screw ⑥⑦ como se muestra.

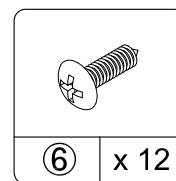
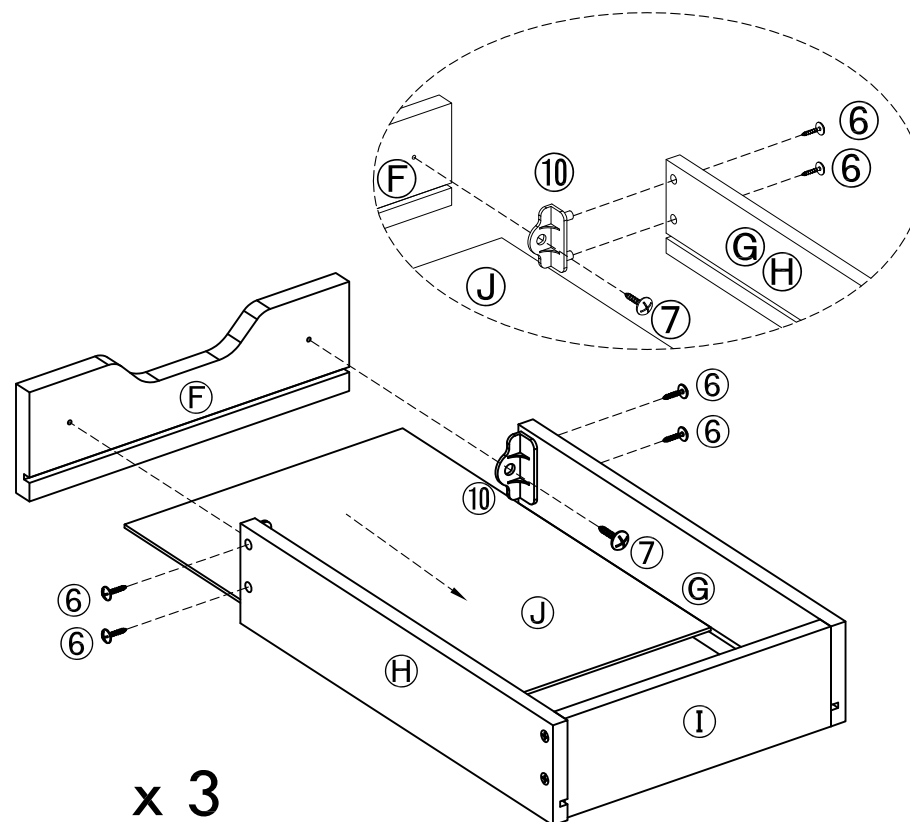

Tornillo 3

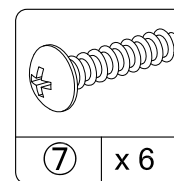

Tornillo 4 Conector de plástico

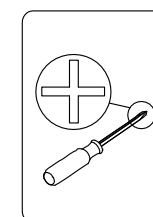
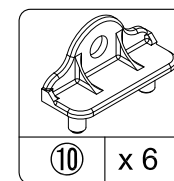

8

Fije la diapositiva del cajón (13B)(13D) a la parte G y H con el tornillo (5) como se muestra.

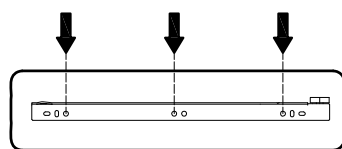
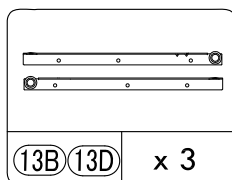
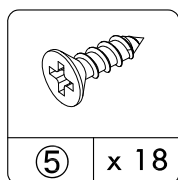
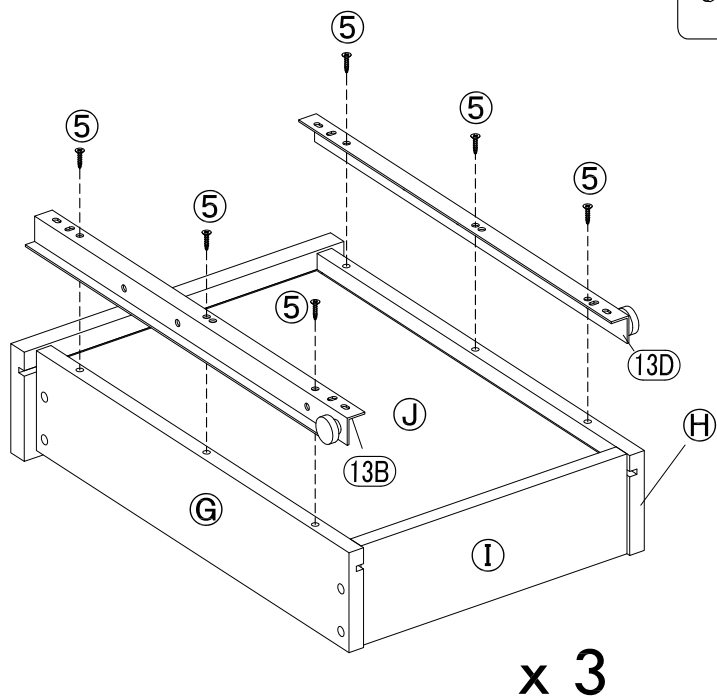
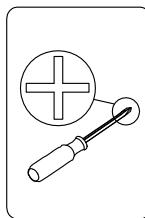

Tornillo 2 Diapositiva del cajón

9

Poner el cajones dentro como se muestra.

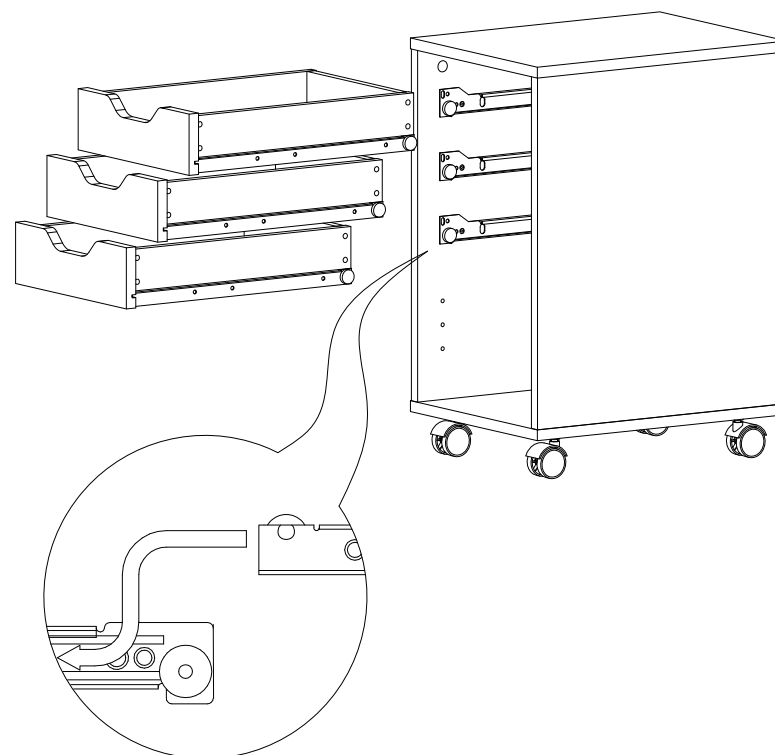

10

Inserte el soporte del estante ⑧ en la parte C y D, luego coloque la parte E en los soportes del estante como se muestra.

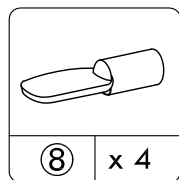
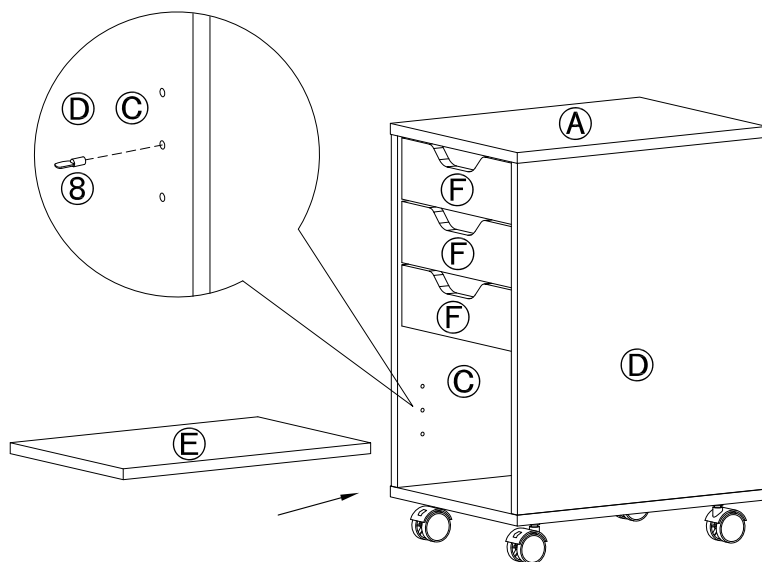

Soporte del estante

11

Ahora Su Unidad Está Compuesta



Por favor de llamarnos para piezas de reemplazo o ayudas:
1-800-729-1569 Lunes-Viernes 9:00am-5:00pm EST