

MAINSTAYS PERKINS DESK WITH METAL FRAME WITH STORAGE FOR FILE CABINET

VENDOR STOCK NUMBERS
MS18-D1-1009-33 WHITE
MS18-D1-1009-34 TRUE BLACK OAK
MS18-D1-1009-35 COCOA

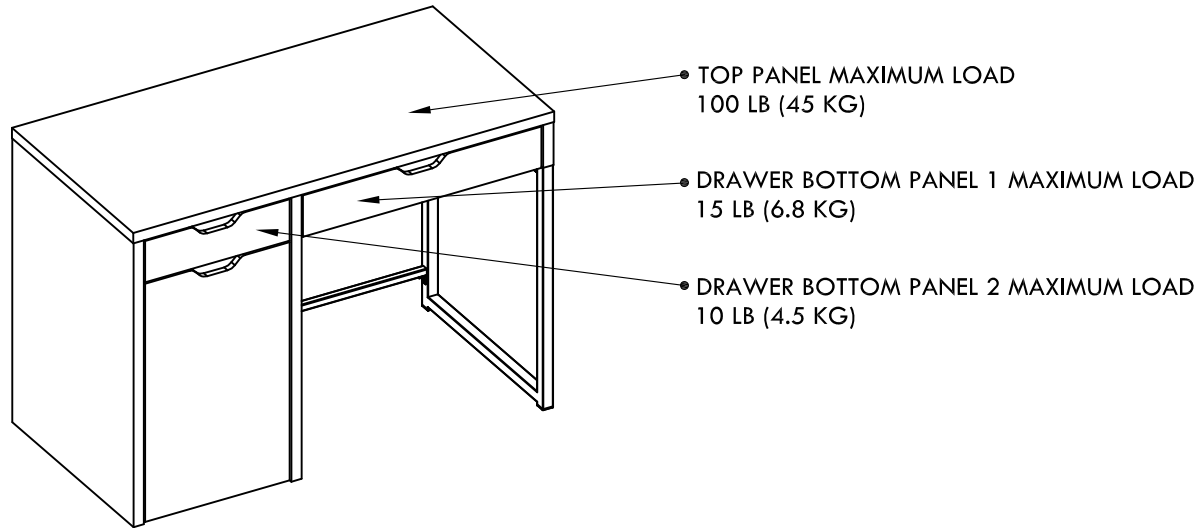

RECOMMENDED NUMBER OF PEOPLE FOR ASSEMBLY : 1
ESTIMATED ASSEMBLY TIME: 1 HOUR

- CALL OUR TOLL FREE NUMBER **1-800-729-1569** FOR FURTHER ASSISTANCE.
- ADDITIONAL PARTS ARE AVAILABLE FOR A FEE.
- THIS INSTRUCTION BOOK CONTAINS IMPORTANT SAFETY INFORMATION, PLEASE READ IT AND KEEP FOR FUTURE REFERENCE.
- DO NOT ALLOW CHILDREN TO CLIMB OR PLAY ON THE UNIT.
- CLEAN THE PRODUCT WITH YOUR FAVORITE FURNITURE POLISH AND A SOFT CLOTH.
- DO NOT USE HARSH CHEMICALS OR ABRASIVE CLEANERS.
- MOVE YOUR NEW FURNITURE CAREFULLY WITH TWO PEOPLE. NEVER PUSH OR DRAG THE UNIT.

DO NOT RETURN THE PRODUCT TO THE STORE.
INDIVIDUAL STORES DO NOT STOCK PARTS.
FOR MISSING OR DAMAGED PARTS CALL 1-800-729-1569.
PARTS WILL BE SHIPPED FREE OF CHARGE.

FOR PROMPT, RELIABLE SERVICE, PLEASE HAVE YOUR ASSEMBLY MANUAL READY.

LOT NUMBER _____
DATE OF PURCHASE ___/___/___

Huisen Furniture (Longnan) Co.,Ltd.
Designed in the USA
Made in China



We are available to assist you Monday -Friday
from 9:00 am - 5:00 pm Eastern Standard Time.
1-800-729-1569
USA only.

MAINSTAYS PERKINS DESK WITH METAL FRAME WITH STORAGE FOR FILE CABINET

VENDOR STOCK NUMBERS
MS18-D1-1009-33 WHITE
MS18-D1-1009-34 TRUE BLACK OAK
MS18-D1-1009-35 COCOA



BEFORE STARTING

- Read and understand all the steps carefully before starting. If each step is not followed in the correct order the assembly will be difficult and may result in damages.
- Work in a spacious area, preferably on a carpeted surface, near where the unit will be used.
- Make sure all the parts are included. Most boards are labeled with a removable sticker.

Helpful hints

- Call our toll free number if you need assistance. We are available to assist you Monday - Friday from 9:00 am - 5:00 pm Eastern Standard Time.
- **1-800-729-1569** USA only.

TOOLS NEEDED TO ASSEMBLE

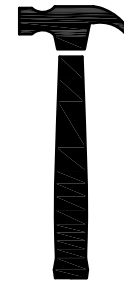

hammer



flat head
screw driver



philips head
screw driver

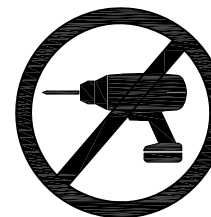

**DO NOT USE POWER TOOLS TO
ASSEMBLE YOUR FURNITURE.
POWER TOOLS MAY DAMAGE THE
PARTS AND RESULT IN DAMAGE.**

Huisen Furniture (Longnan) Co.,Ltd.
Designed in the USA
Made in China



We are available to assist you Monday -Friday
from 9:00 am - 5:00 pm Eastern Standard Time.
1-800-729-1569
USA only.

**MAINSTAYS PERKINS DESK WITH METAL FRAME
WITH STORAGE FOR FILE CABINET**

VENDOR STOCK NUMBERS
MS18-D1-1009-33 WHITE
MS18-D1-1009-34 TRUE BLACK OAK
MS18-D1-1009-35 COCOA

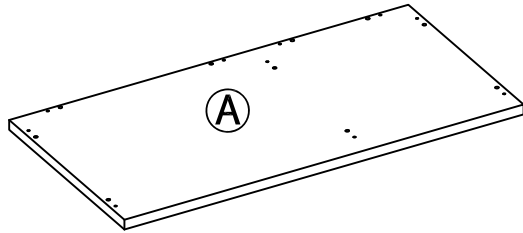

Top panel
(Qty: 1)

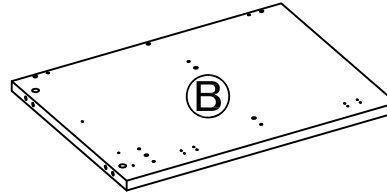

Left panel
(Qty: 1)

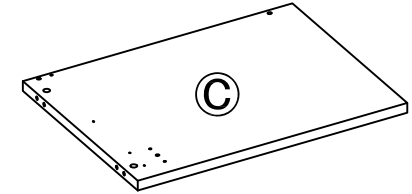

Middle panel
(Qty: 1)

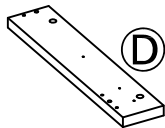

Right panel
(Qty: 1)

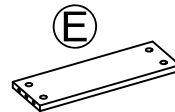

Crossbar 1
(Qty: 1)

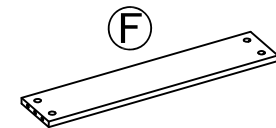

Crossbar 2
(Qty: 1)

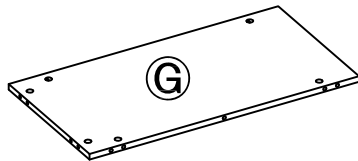

Back panel 1
(Qty: 1)

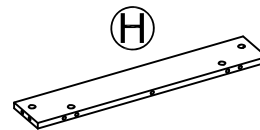

Back panel 2
(Qty: 1)

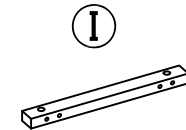

Stopper rail
(Qty: 1)

VERIFY THAT ALL PARTS ARE LISTED BEFORE BEGINNING



We are available to assist you Monday -Friday
from 9:00 am - 5:00 pm Eastern Standard Time.
1-800-729-1569
USA only.

**MAINSTAYS PERKINS DESK WITH METAL FRAME
WITH STORAGE FOR FILE CABINET**

VENDOR STOCK NUMBERS
MS18-D1-1009-33 WHITE
MS18-D1-1009-34 TRUE BLACK OAK
MS18-D1-1009-35 COCOA

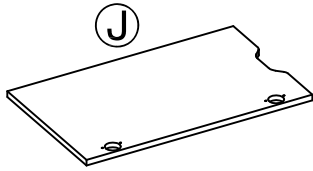

Door panel
(Qty: 1)

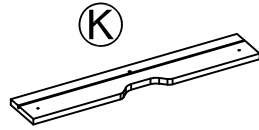

Drawer front panel 1
(Qty: 1)

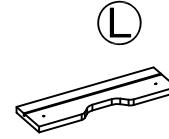

Drawer front panel 2
(Qty: 1)

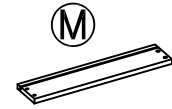

Drawer left panel
(Qty: 2)



Drawer right panel
(Qty: 2)

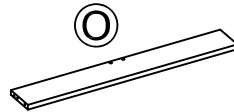

Drawer back panel 1
(Qty: 1)

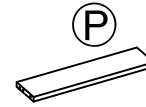

Drawer back panel 2
(Qty: 1)

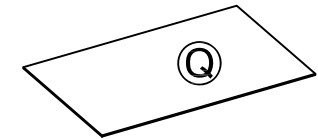

Drawer bottom panel 1
(Qty: 1)

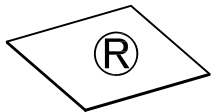

Drawer bottom panel 2
(Qty: 1)

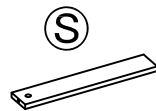

Drawer support panel
(Qty: 1)

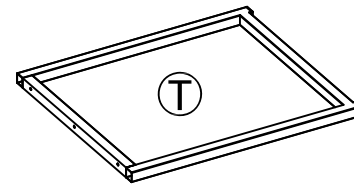

Metal side frame
(Qty: 1)

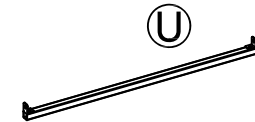

Metal tube
(Qty: 1)

VERIFY THAT ALL PARTS ARE LISTED BEFORE BEGINNING



We are available to assist you Monday -Friday
from 9:00 am - 5:00 pm Eastern Standard Time.
1-800-729-1569
USA only.

**MAINSTAYS PERKINS DESK WITH METAL FRAME
WITH STORAGE FOR FILE CABINET**

**VENDOR STOCK NUMBERS
MS18-D1-1009-33 WHITE
MS18-D1-1009-34 TRUE BLACK OAK
MS18-D1-1009-35 COCOA**

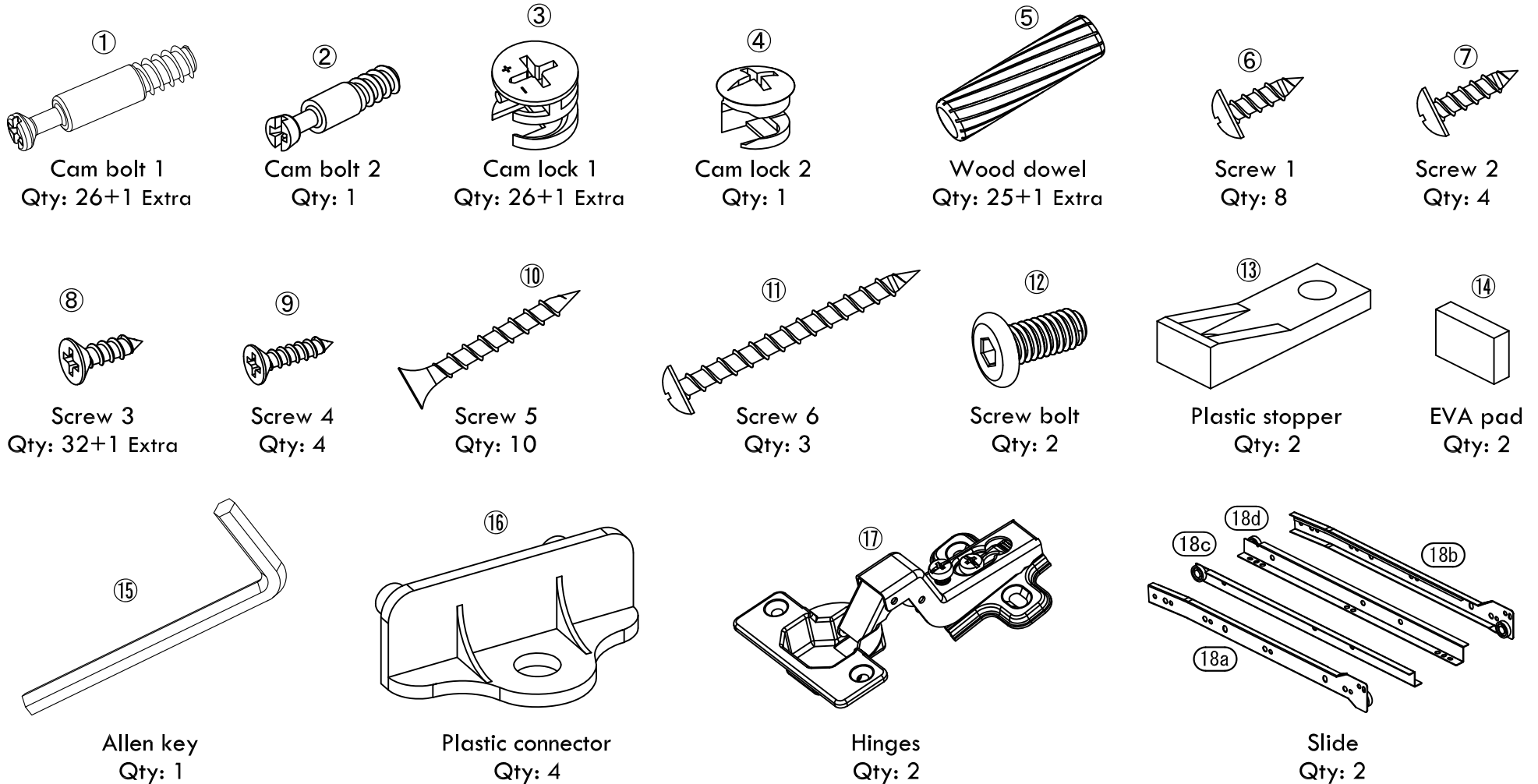

VERIFY THAT ALL PARTS ARE LISTED BEFORE BEGINNING



We are available to assist you Monday -Friday
from 9:00 am - 5:00 pm Eastern Standard Time.
1-800-729-1569
USA only.

**MAINSTAYS PERKINS DESK WITH METAL FRAME
WITH STORAGE FOR FILE CABINET**

VENDOR STOCK NUMBERS
MS18-D1-1009-33 WHITE
MS18-D1-1009-34 TRUE BLACK OAK
MS18-D1-1009-35 COCOA

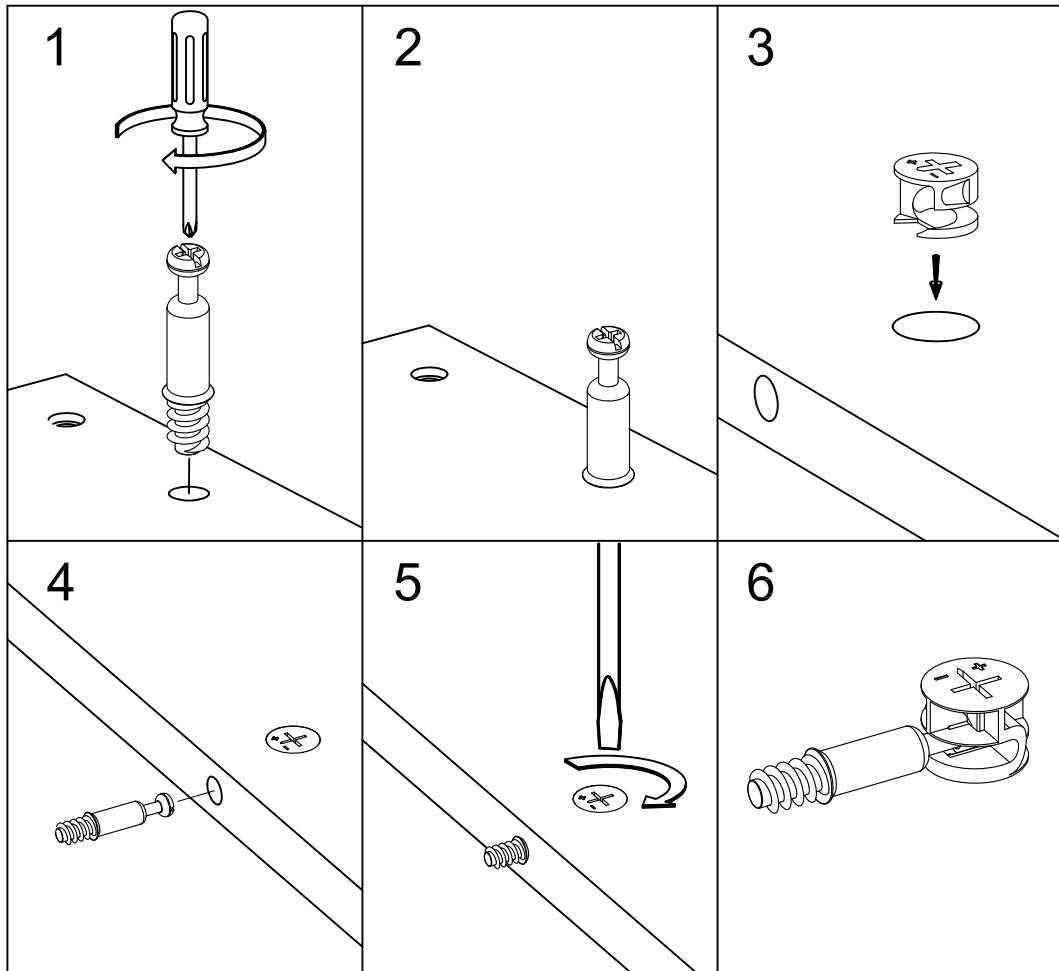

CAM FASTENING SYSTEM

1. Screw the **cam bolt** into the predrilled panel. The screw should be tightened so no threads are visible.
2. The larger ring of the cam should touch the panel.
3. Insert the **cam lock** into the predrilled hole in the panel. The plus and minus signs should be facing the outside of the panel.
4. Connect the previously tightened **cam bolt** with the panel connected into the **cam lock**.
5. Using a flat head screw driver, turn the **cam lock** halfway counterclockwise to secure the **cam bolt**.
6. **FAILURE TO PROPERLY SECURE THE CAM LOCK AND CAM BOLT COULD RESULT IN PRODUCT INSTABILITY AND FAILURE.**

Huisen Furniture (Longnan) Co.,Ltd.
Designed in the USA
Made in China



We are available to assist you Monday -Friday
 from 9:00 am - 5:00 pm Eastern Standard Time.
1-800-729-1569
 USA only.

1

Insert hardware ① ③ ⑤ into part A & I as shown.

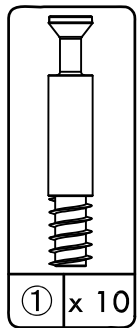
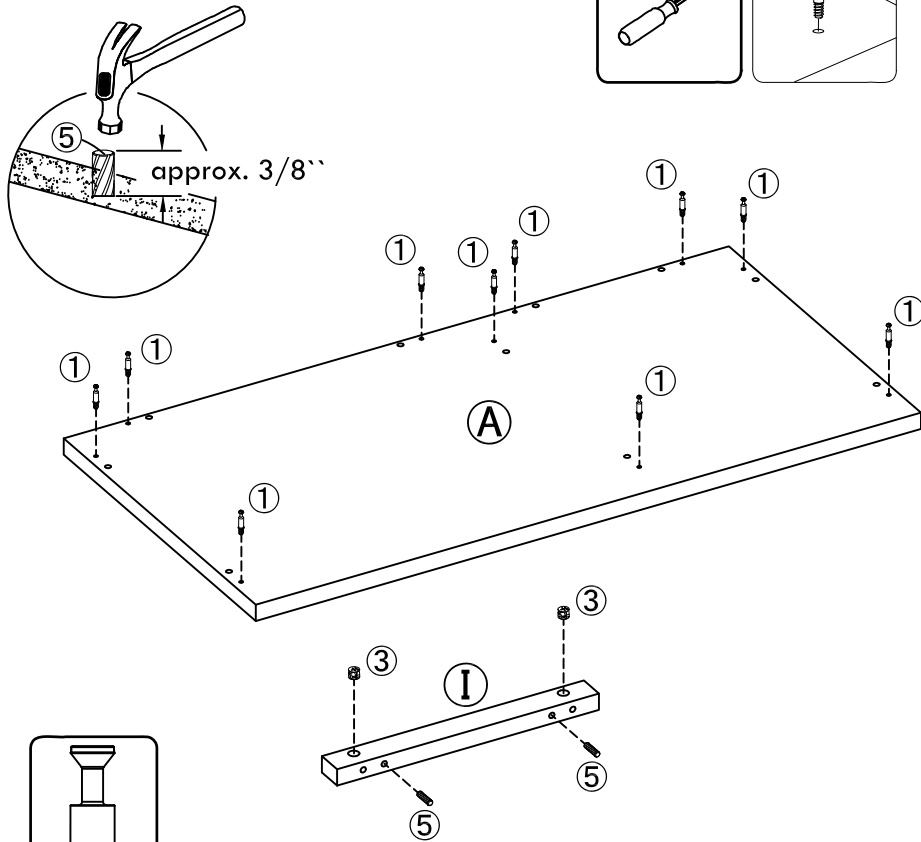
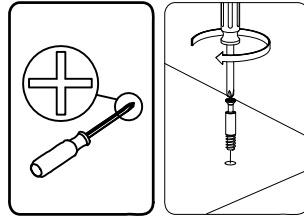

① x 10

Cam bolt 1

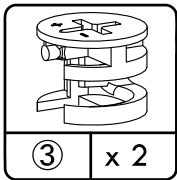

③ x 2

Cam lock 1

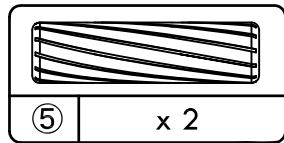

⑤ x 2

Wood dowel

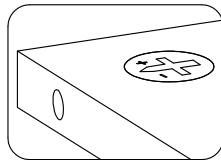

arrow of cam lock points to predrilled hole

2

Insert hardware ③ ④ ⑤ into part E & F & S as shown.

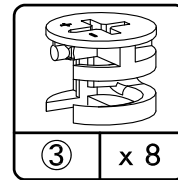
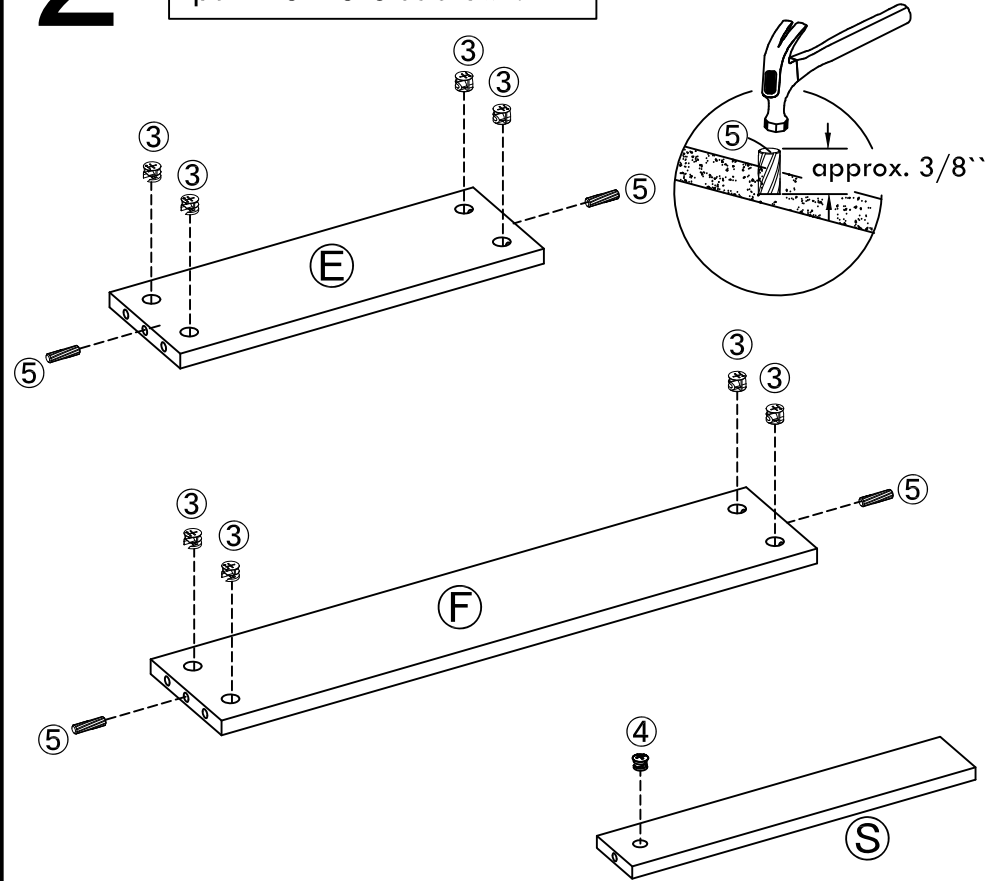

③ x 8

Cam lock 1

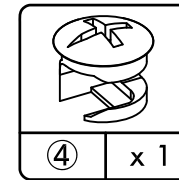

④ x 1

Cam lock 2

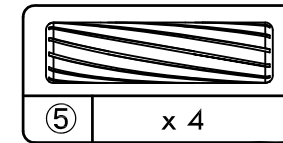

⑤ x 4

Wood dowel

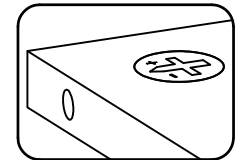

arrow of cam lock points to predrilled hole

3

Insert hardware ①③⑤ into part B as shown, then attach slide 18a using screw ⑧ as shown.

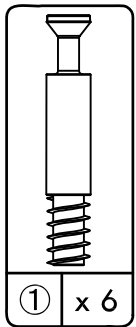
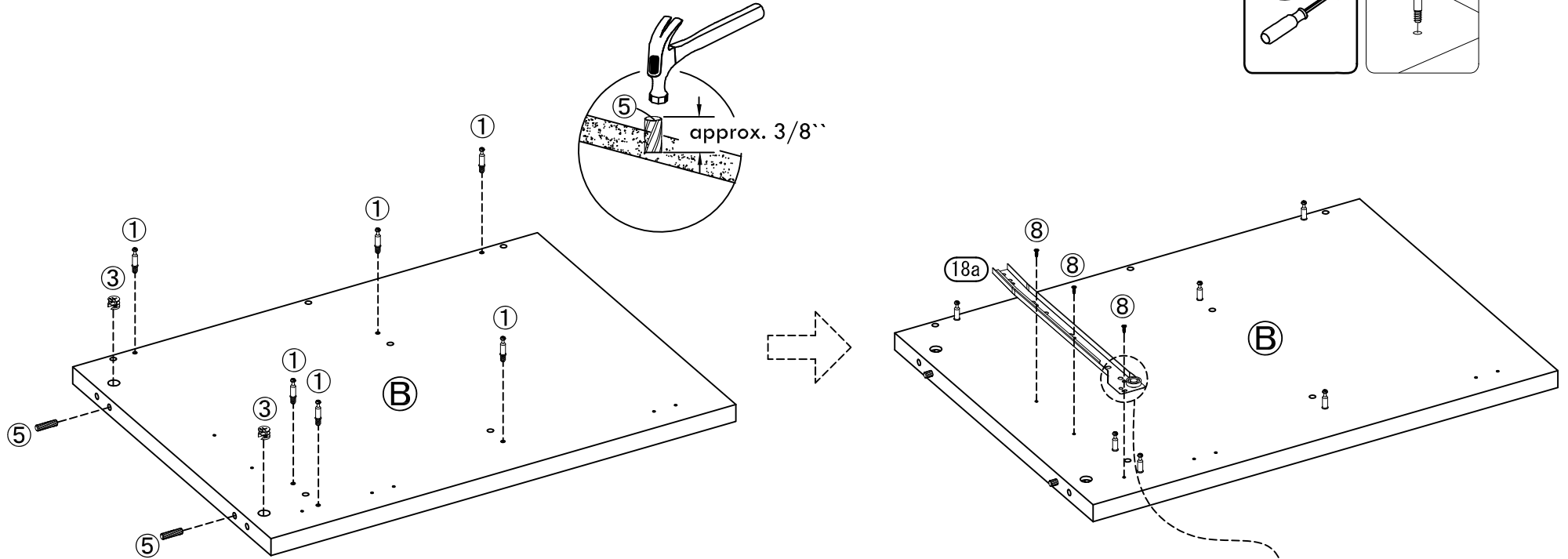
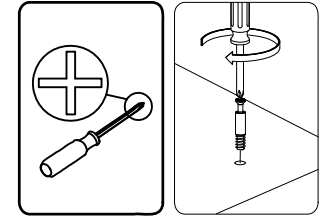

① x 6

Cam bolt 1

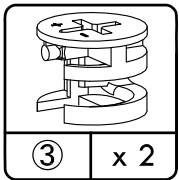

③ x 2

Cam lock 1

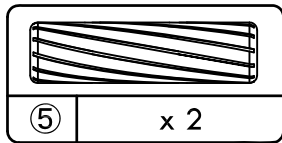

⑤ x 2

Wood dowel

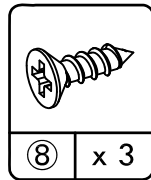

⑧ x 3

Screw 3

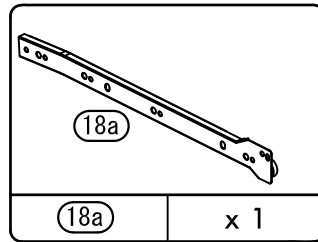

⑱a x 1

Slide

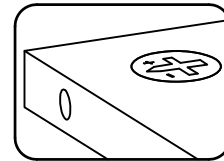

arrow of cam lock points to predrilled hole

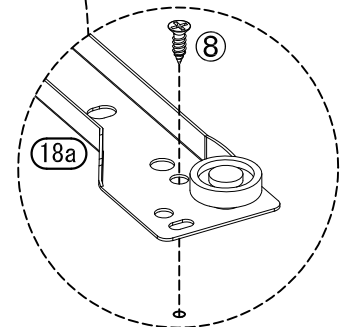

4

Insert hardware ①③⑤ into part D as shown, then attach slide 18b using screw ⑧ as shown.

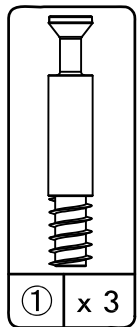
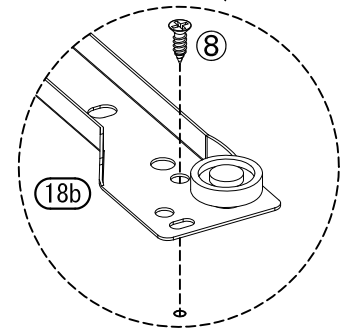
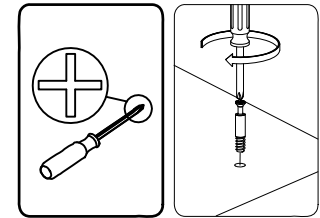
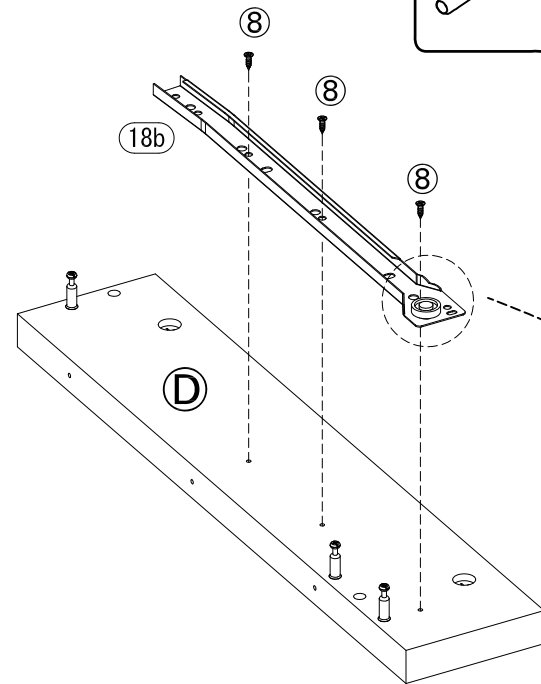
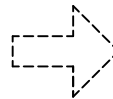
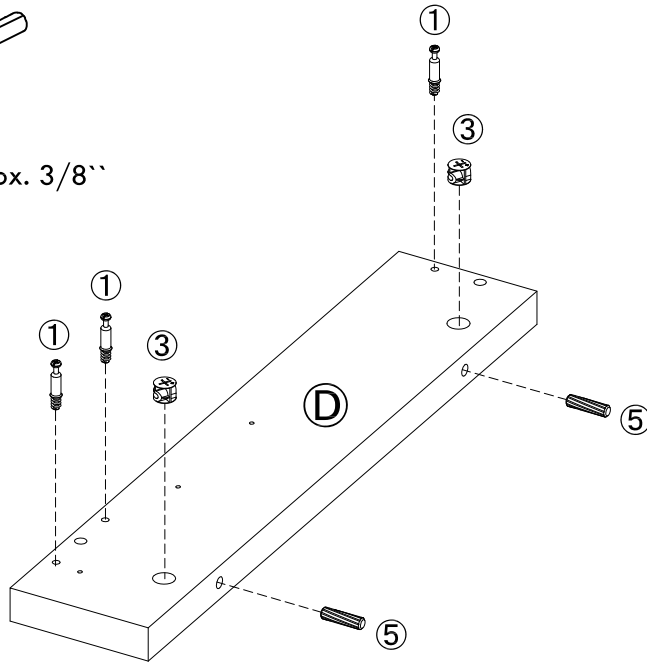
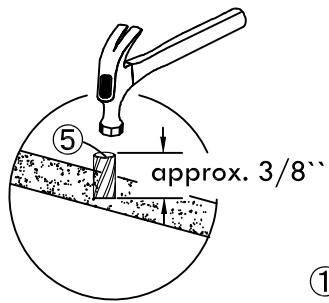

Cam bolt 1

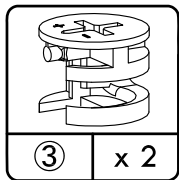

Cam lock 1

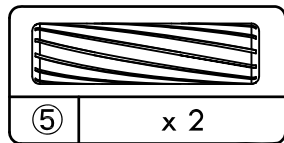

Wood dowel

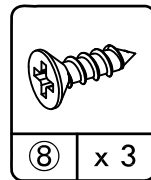

Screw 3

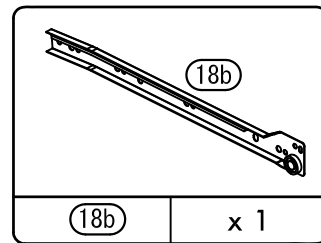

Slide

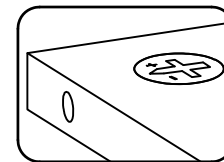

arrow of cam lock points to predrilled hole

5

Insert hardware ①⑨⑬ on the First side of part C, then attach slide 18b using screw ⑧ as shown. Then, flip to the opposite side of part C and insert hardware ①③⑤⑧. Then attach slide 18a using screw ⑧ as shown.

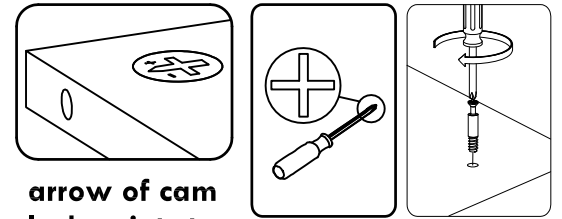
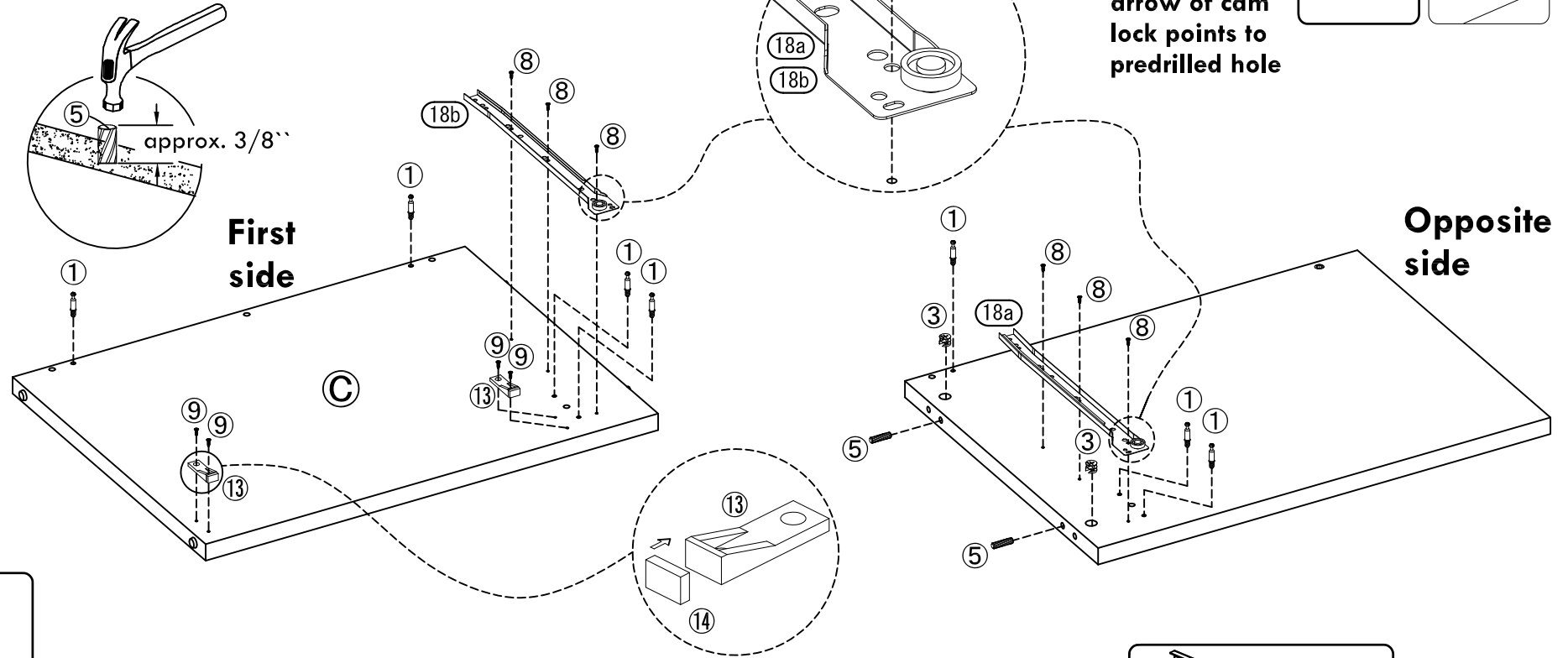

arrow of cam lock points to predrilled hole

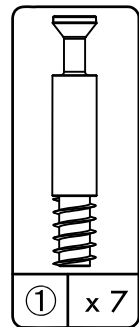

Cam bolt 1 x 7

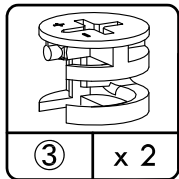

Cam lock 1 x 2

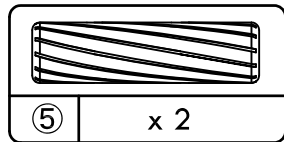

Wood dowel x 2

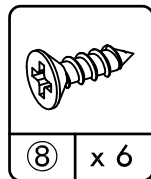

Screw 3 x 6

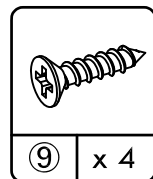

Screw 4 x 4

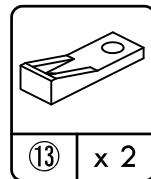

Plastic stopper x 2

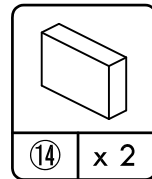

EVA pad x 2

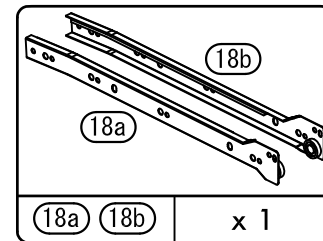

Slide x 1

6

Insert hardware ③ ⑤ into part G & H as shown.

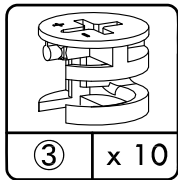
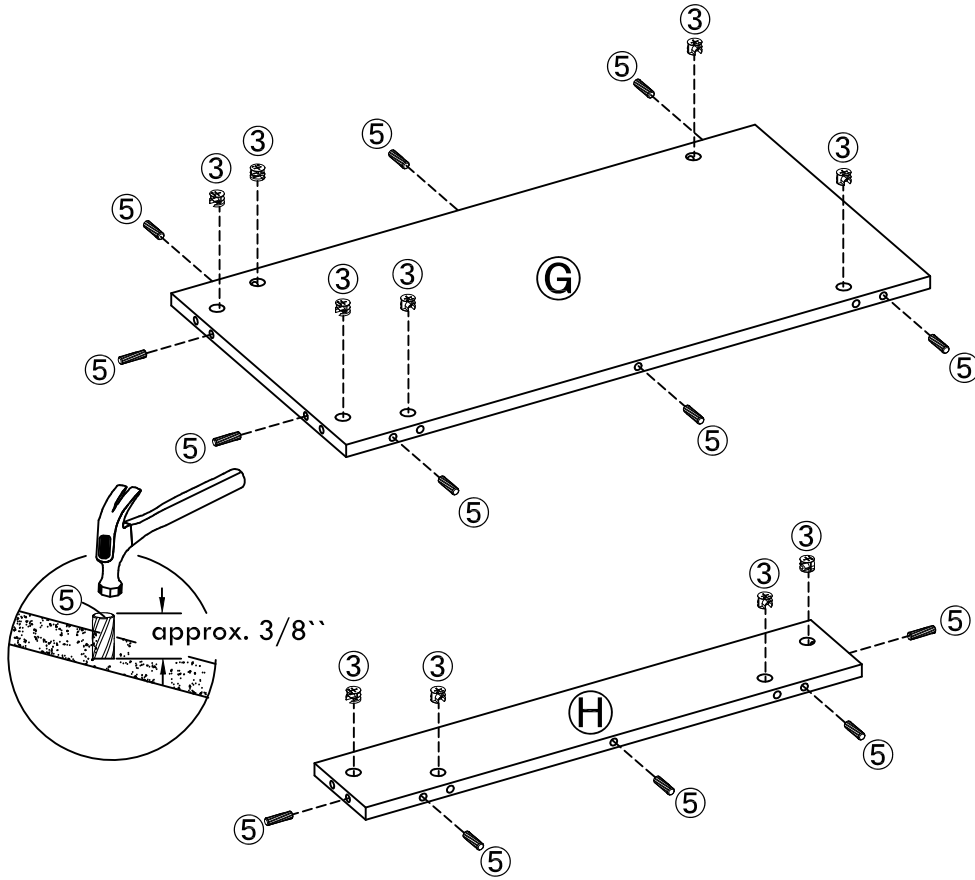

③ x 10
Cam lock 1

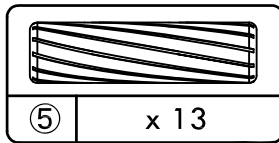

⑤ x 13
Wood dowel

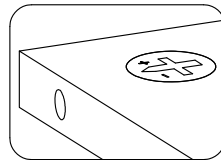

arrow of cam lock points to predrilled hole

7

Attach hinges ⑰ to part J using screw ⑧ as shown.

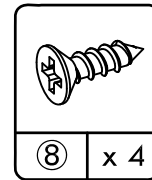
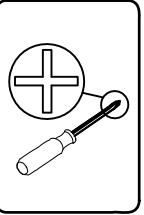
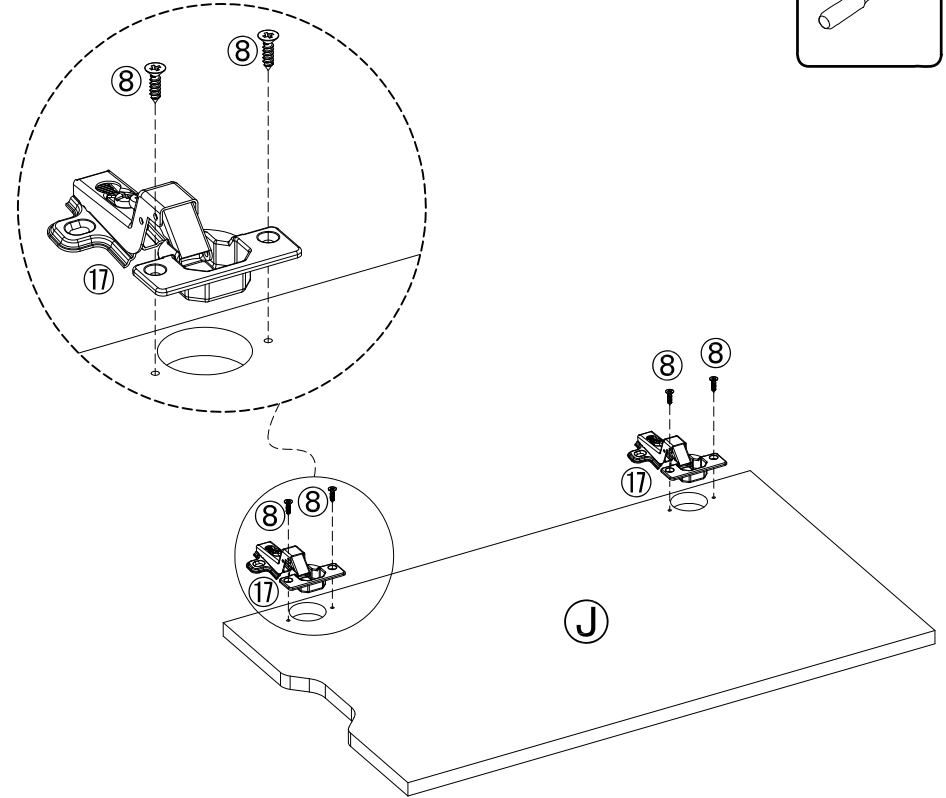

⑧ x 4
Screw 3

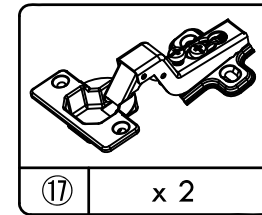

⑰ x 2
Hinges

8

Insert hardware ② ⑦ ⑱ into part K & L as shown.

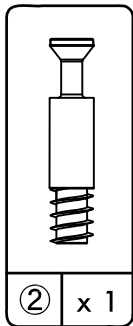
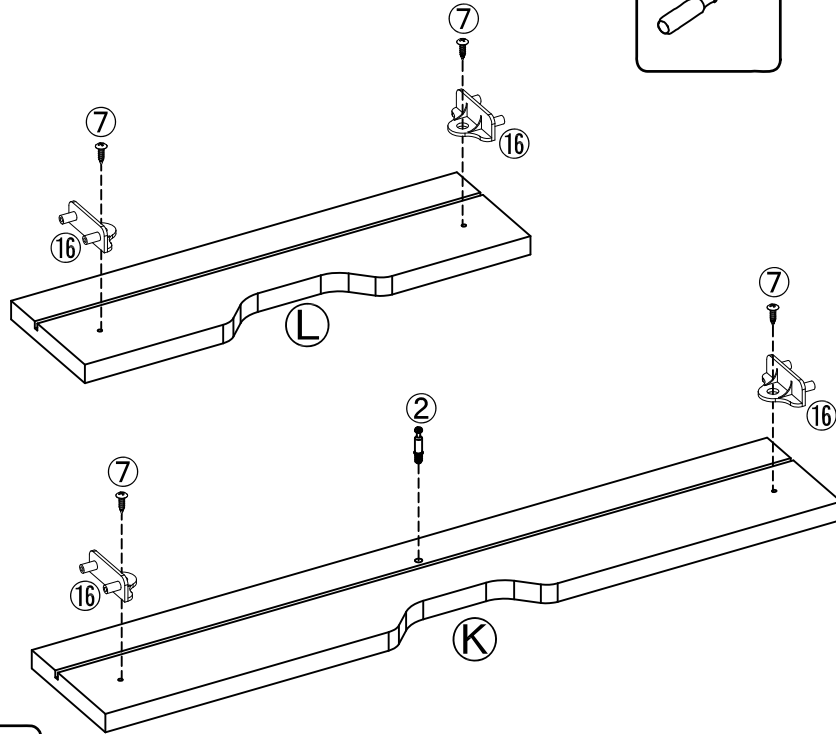
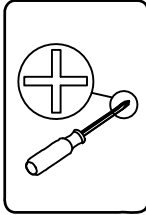

② x 1

Cam bolt 2

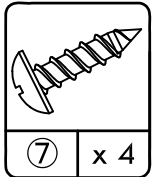

⑦ x 4

Screw 2

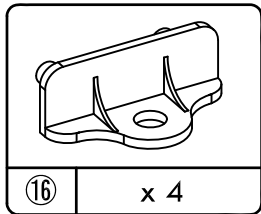

⑱ x 4

Plastic connector

9

Attach part M & N & S to part O using screw ⑩ as shown, then insert part Q to the bottom as shown.

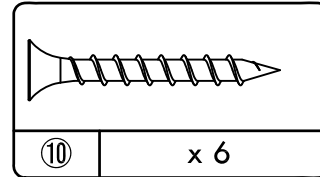
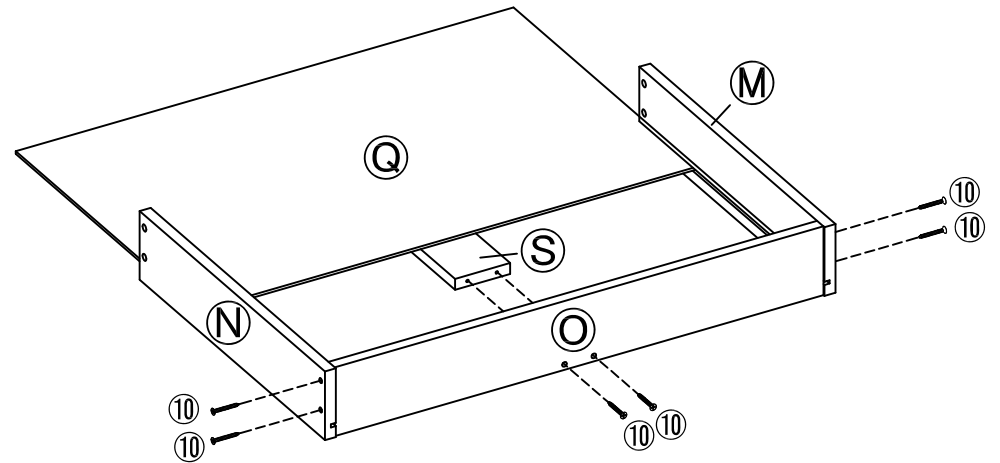
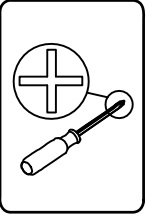

⑩ x 6

Screw 5

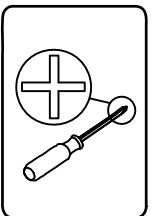

10

Attach part K to the structure using screw ⑥ as shown.

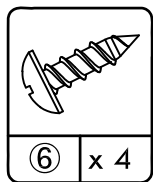
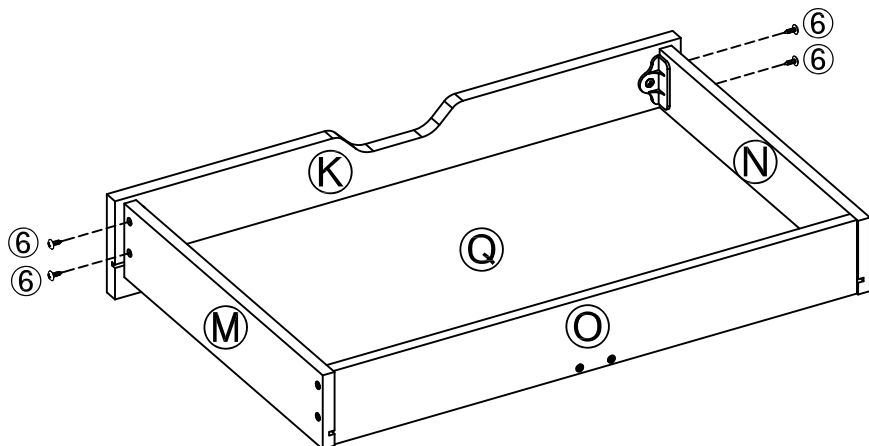
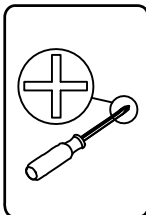

Screw 1

11

Attach part M & N to part P using screw ⑩ as shown, then insert part R to the bottom as shown.

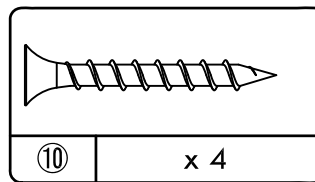
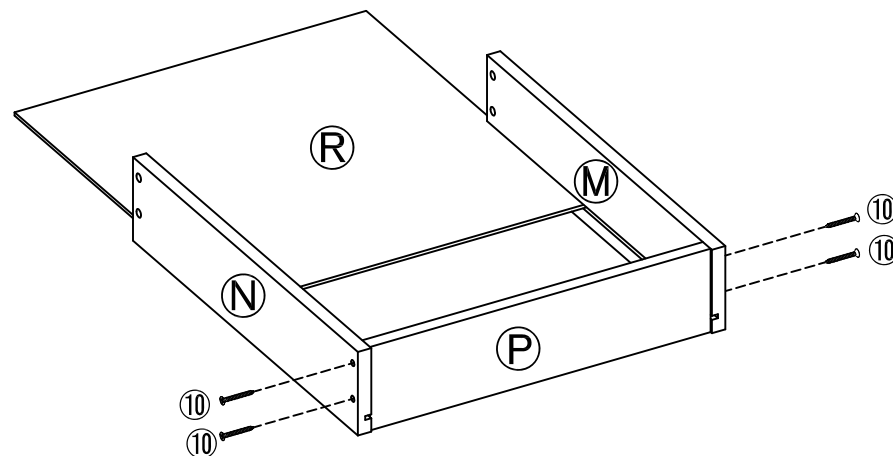
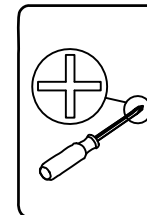

Screw 5

12

Attach part L to the structure using screw ⑥ as shown.

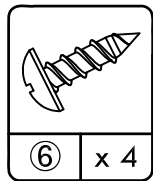
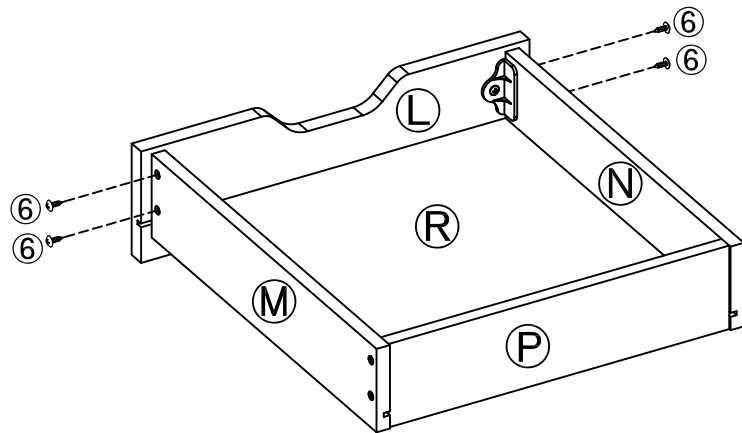
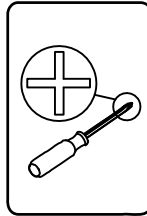

⑥ x 4

Screw 1

13

Attach slide 18c & 18d on part M & N using screw ⑧ as shown, then tighten the cam lock ④ on part S.

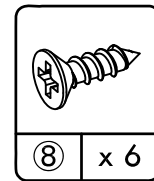
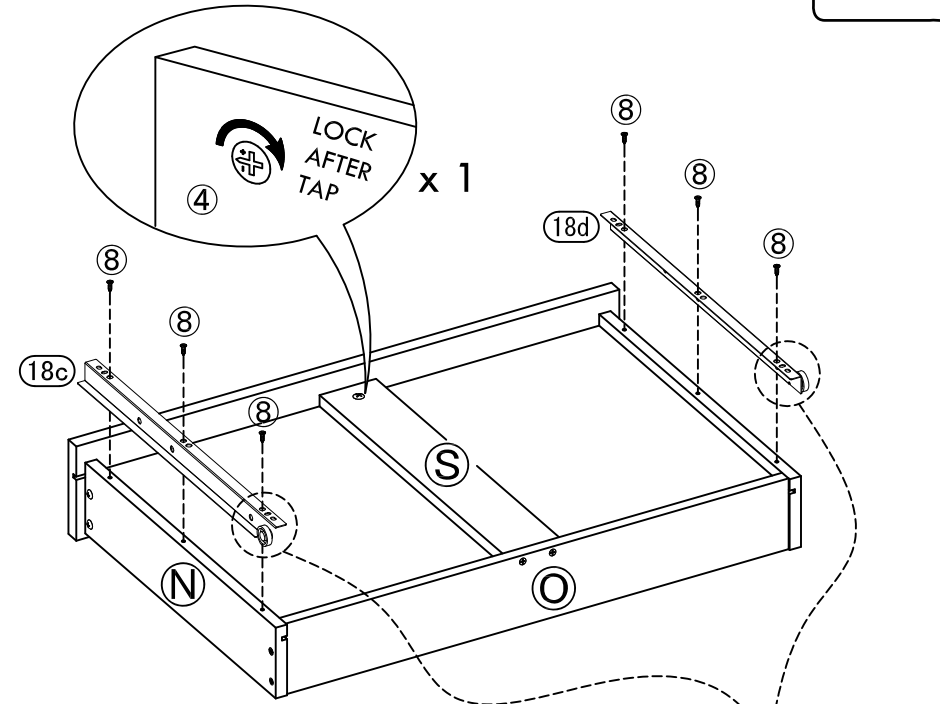
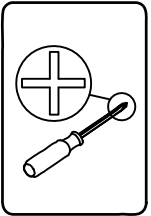

⑧ x 6

Screw 3

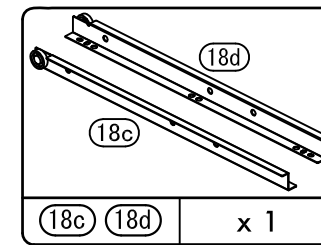

⑬c ⑬d x 1

Slide

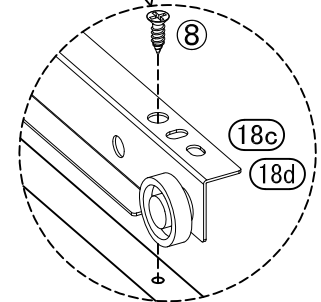

14

Attach slide 18c & 18d on part M & N using screw ⑧ as shown.

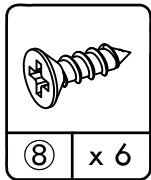
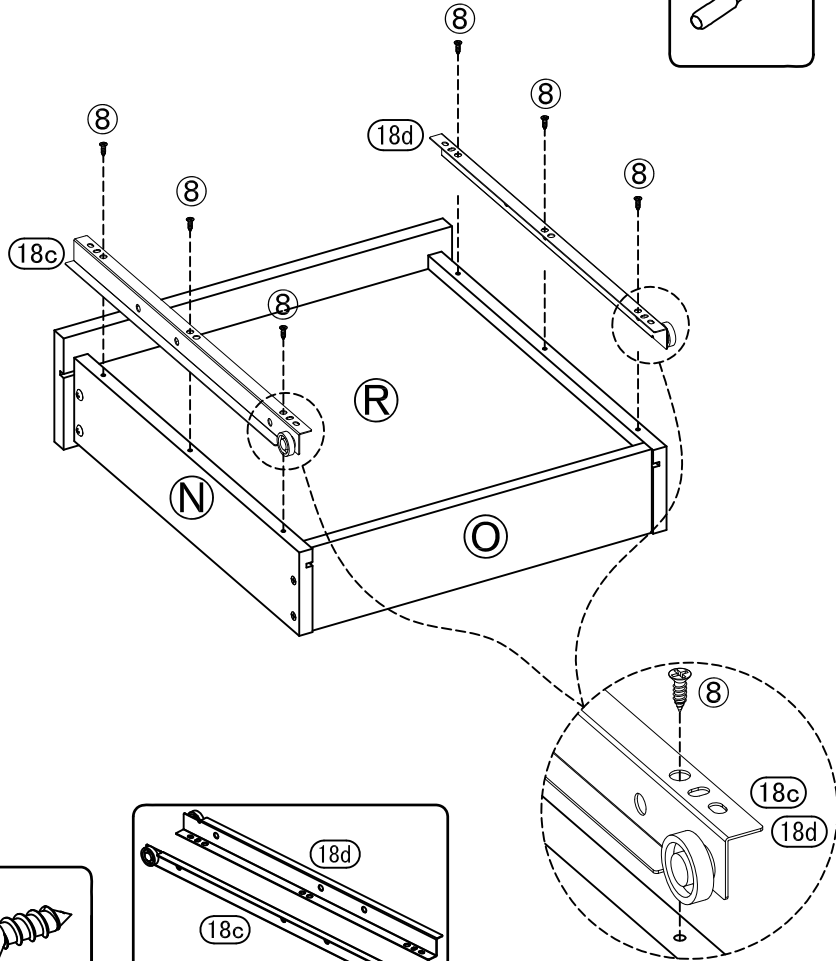
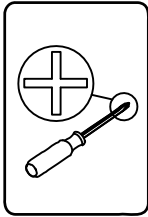

⑧ x 6

Screw 3

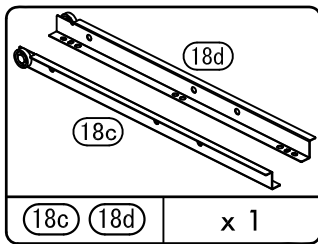

18c 18d x 1

Slide

15

Attach part I to part B and then tighten the cam locks ③.

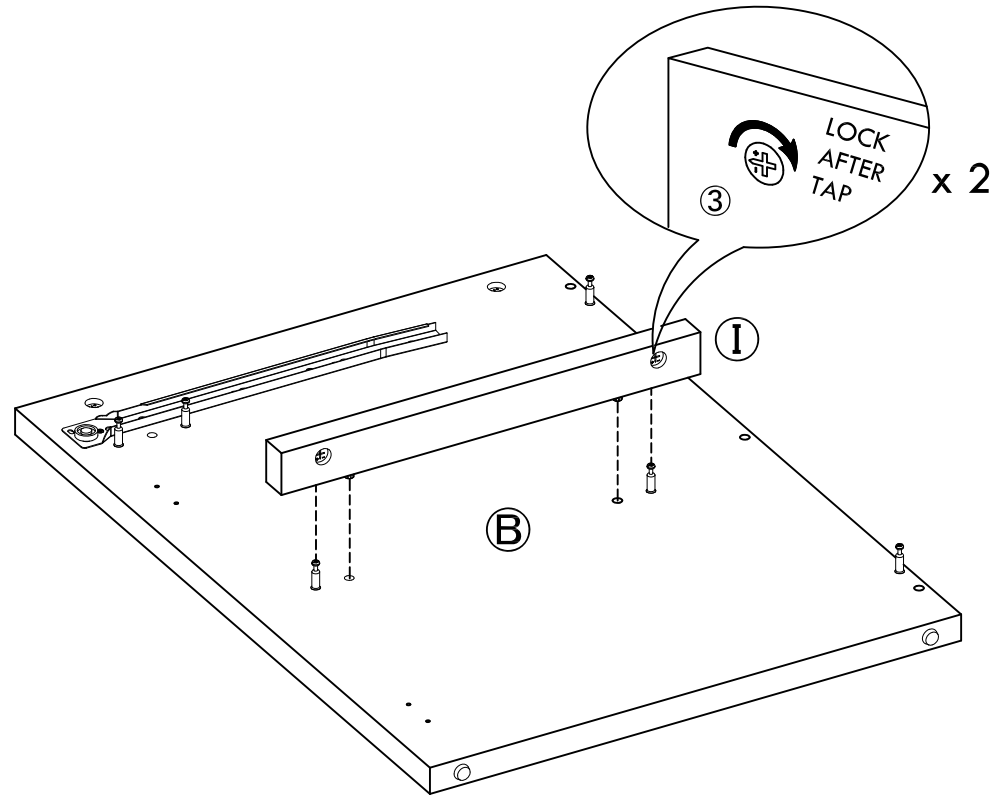
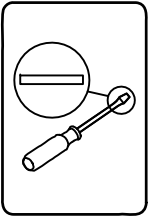

16

Attach part E & G to part C and then tighten the cam locks ③.

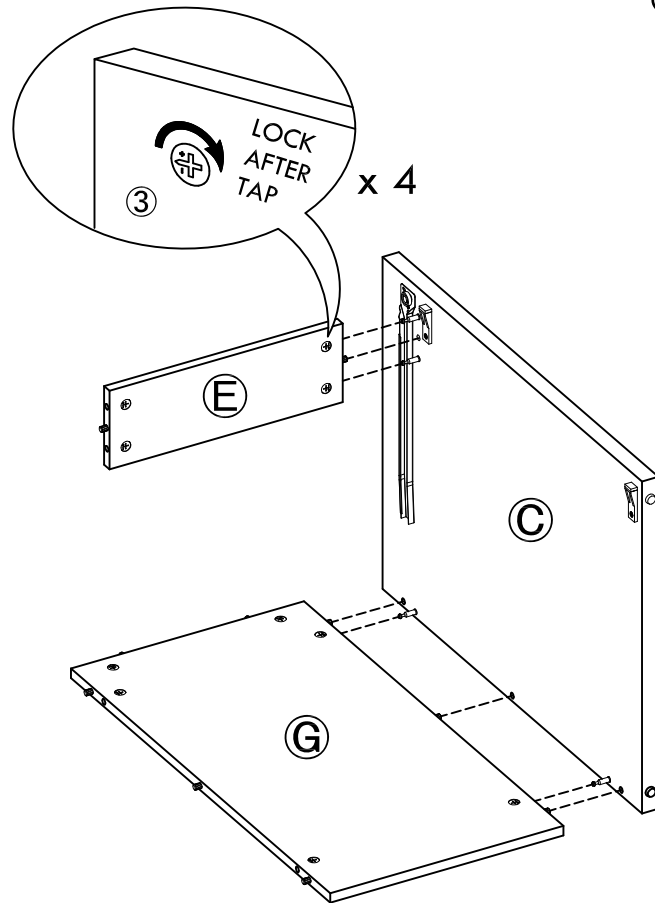
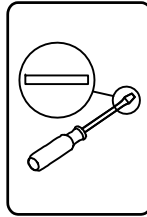

17

Attach part B to the structure and then tighten the cam locks ③.

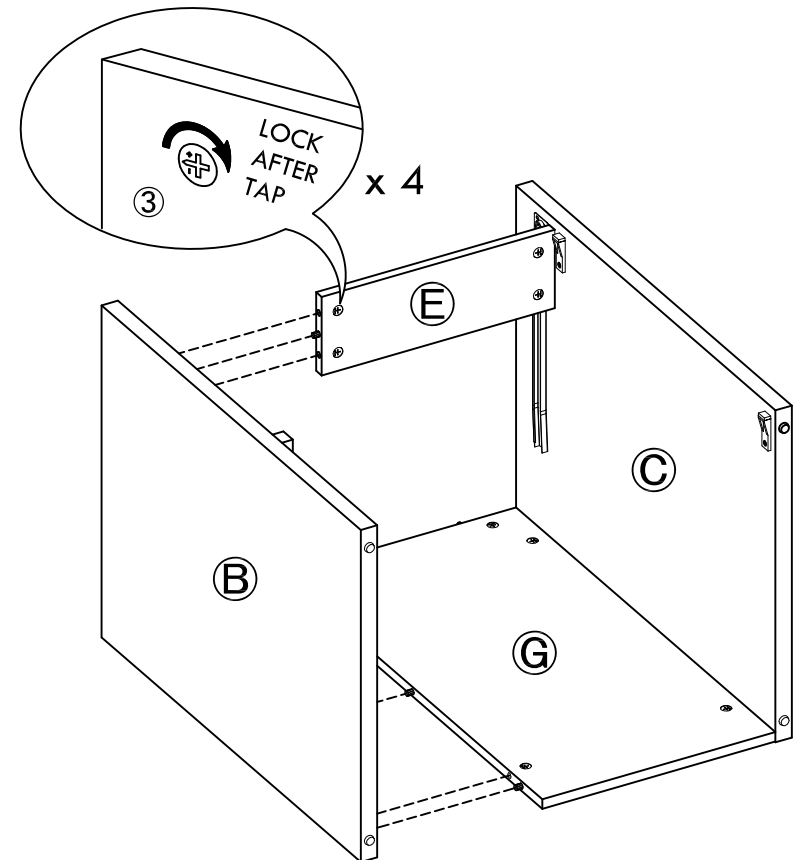
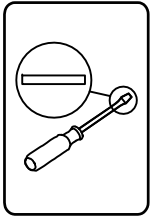

18

Attach part H & F to the structure and then tighten the cam locks ③.

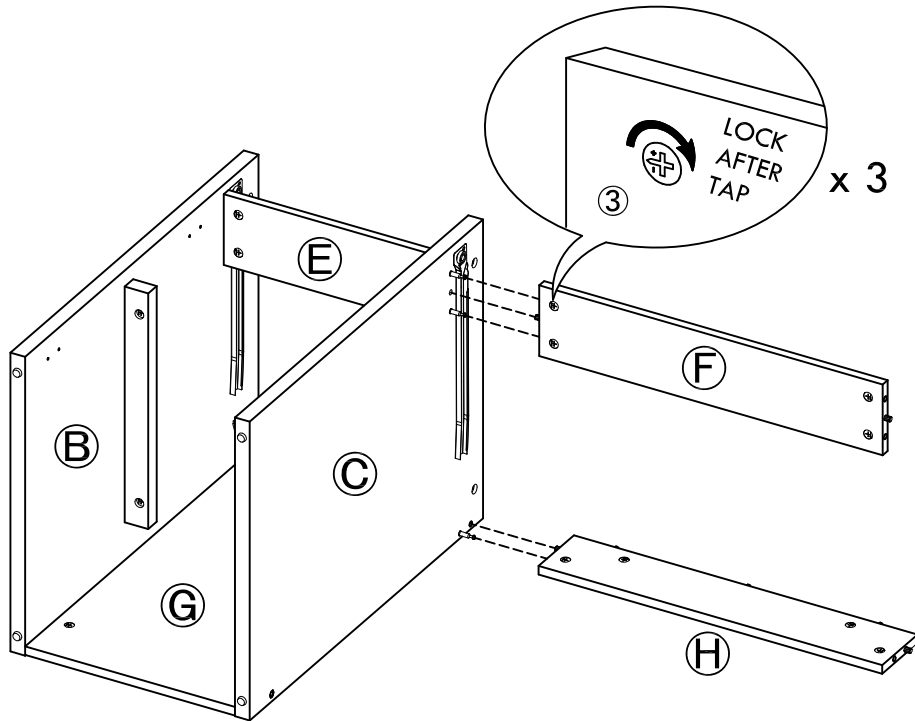
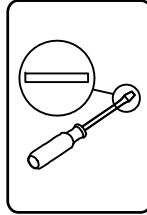

19

Attach part D to the structure and then tighten the cam locks ③.

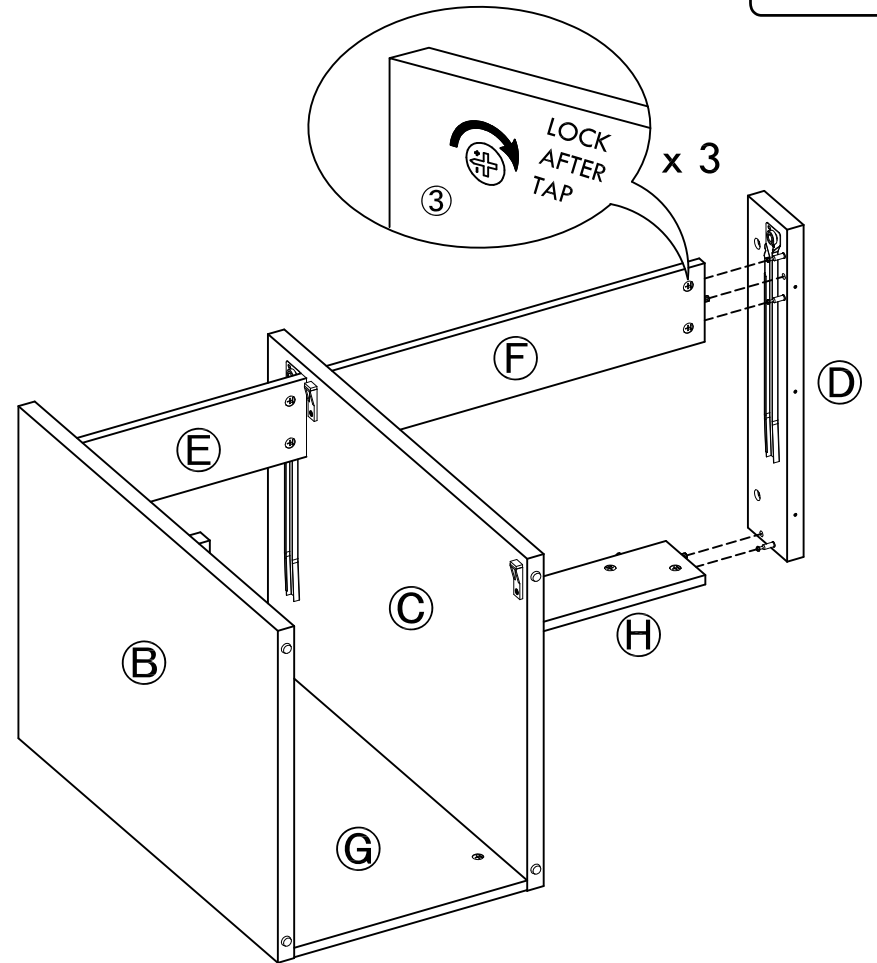
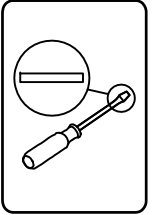

20

Attach part T to the structure using screw ⑪ as shown.

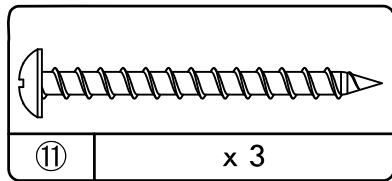
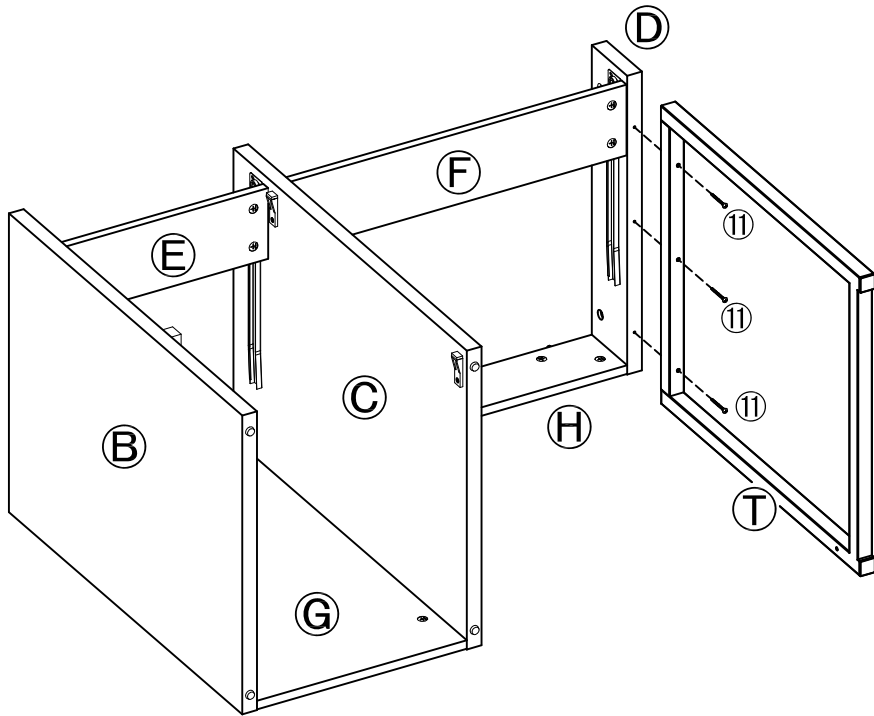
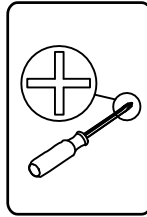

⑪ x 3

Screw 6

21

Attached part U to the structure using screw bolt ⑫ and attached allen key as shown. Tighten the bolts completely in order to avoid wobble/instability.

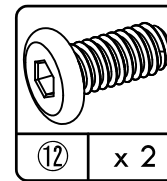
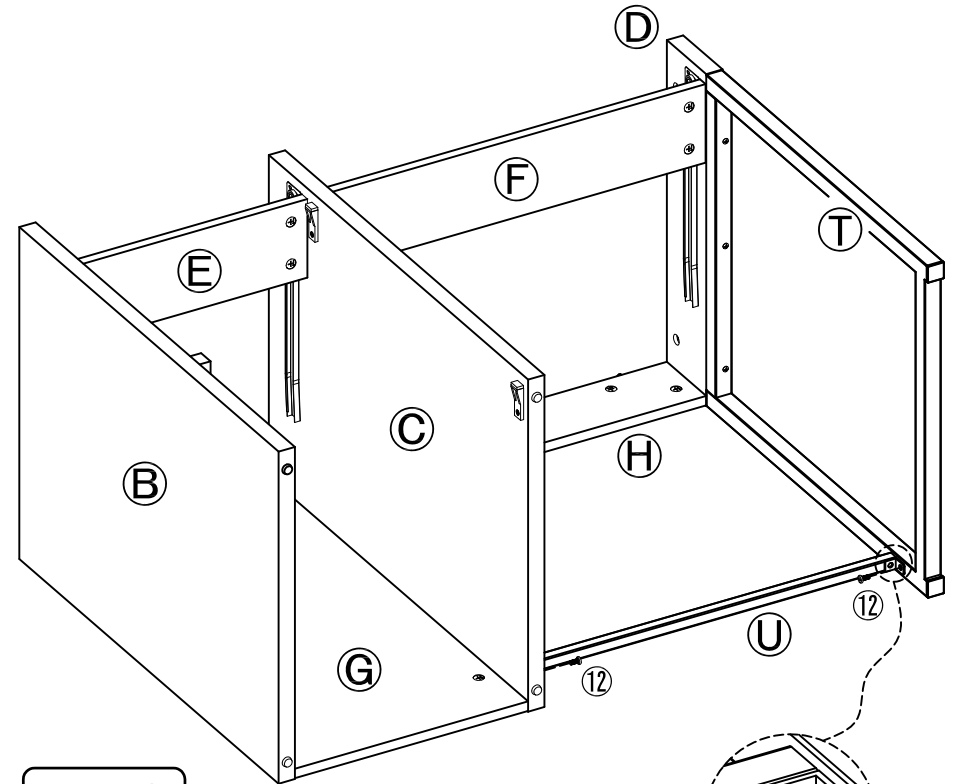
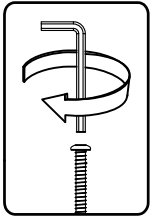

⑫ x 2

Screw bolt

22

Attach part A to the structure and then tighten the cam locks ③.

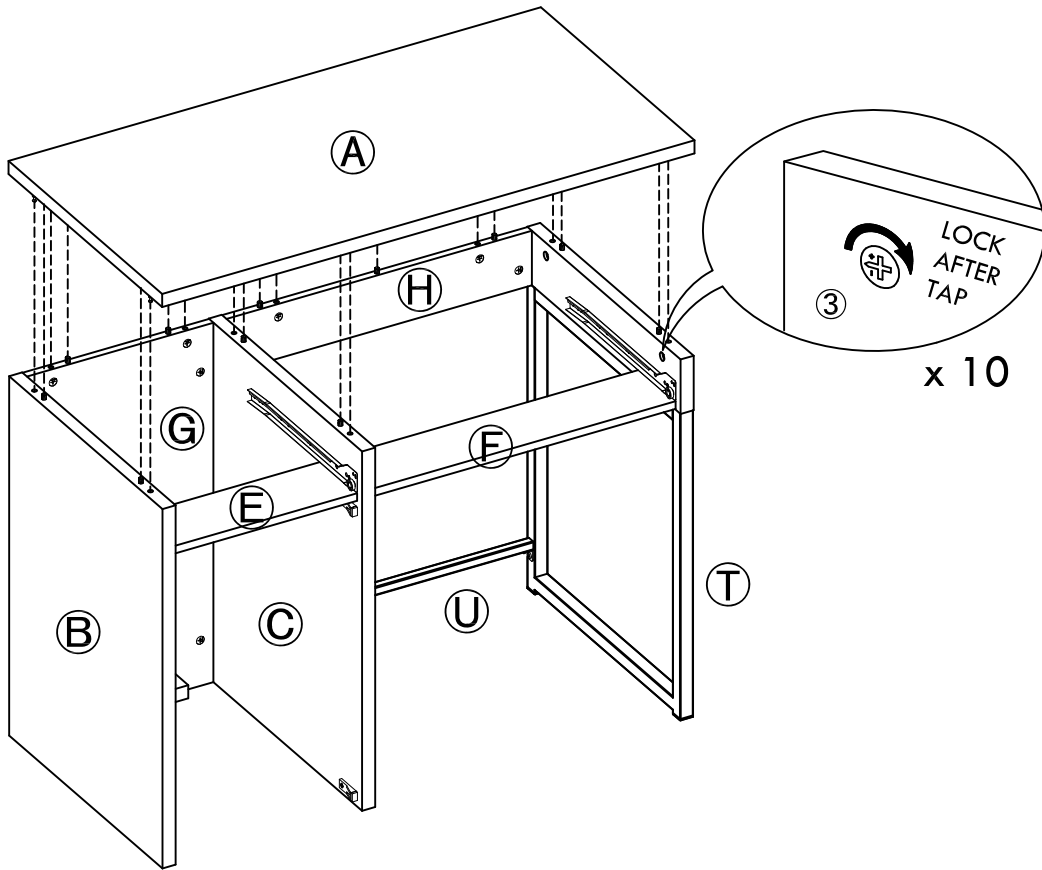
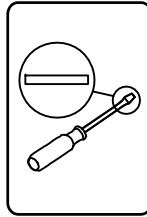

23

Assemble the door panel J on part B using screw ⑧ as shown.

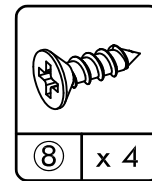
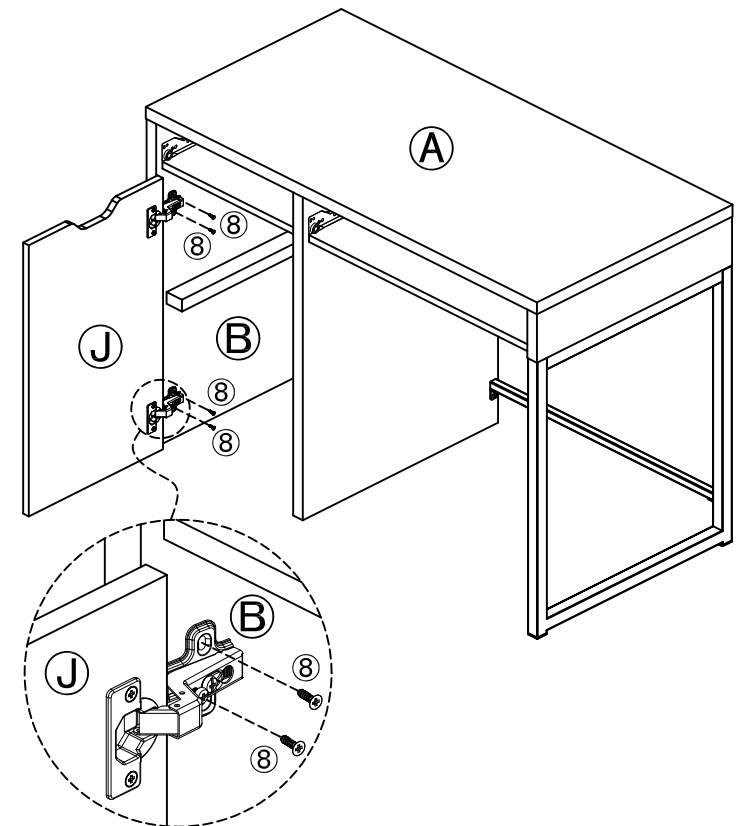
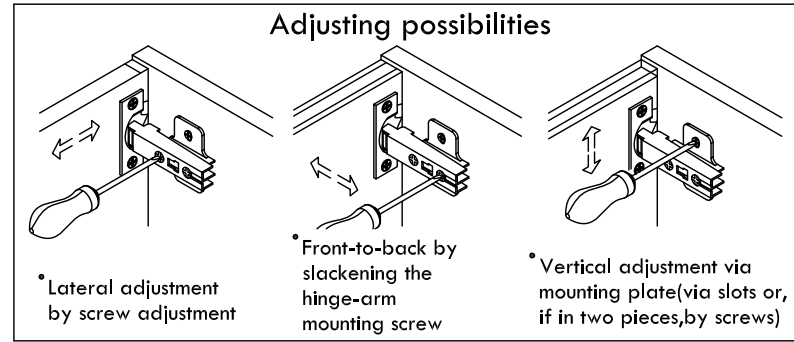
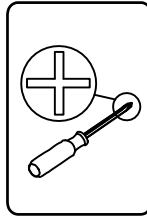

Screw 3

24

Put the drawers inside as shown.

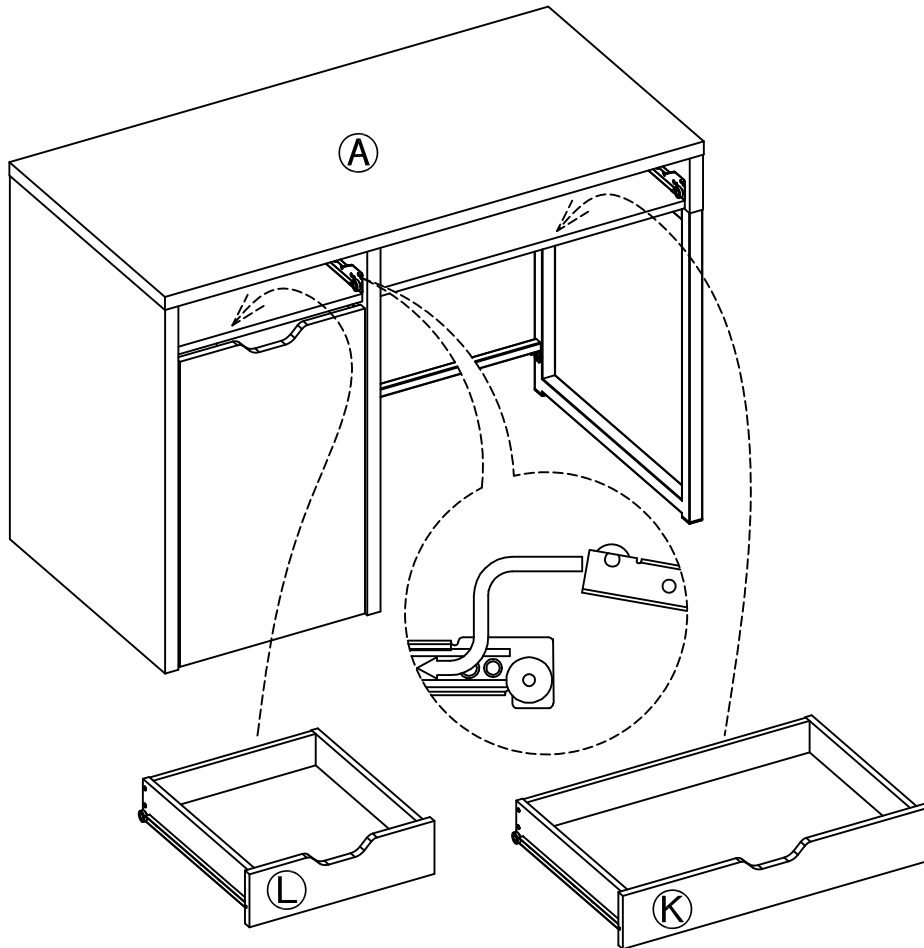

Now Your Unit Is Completed

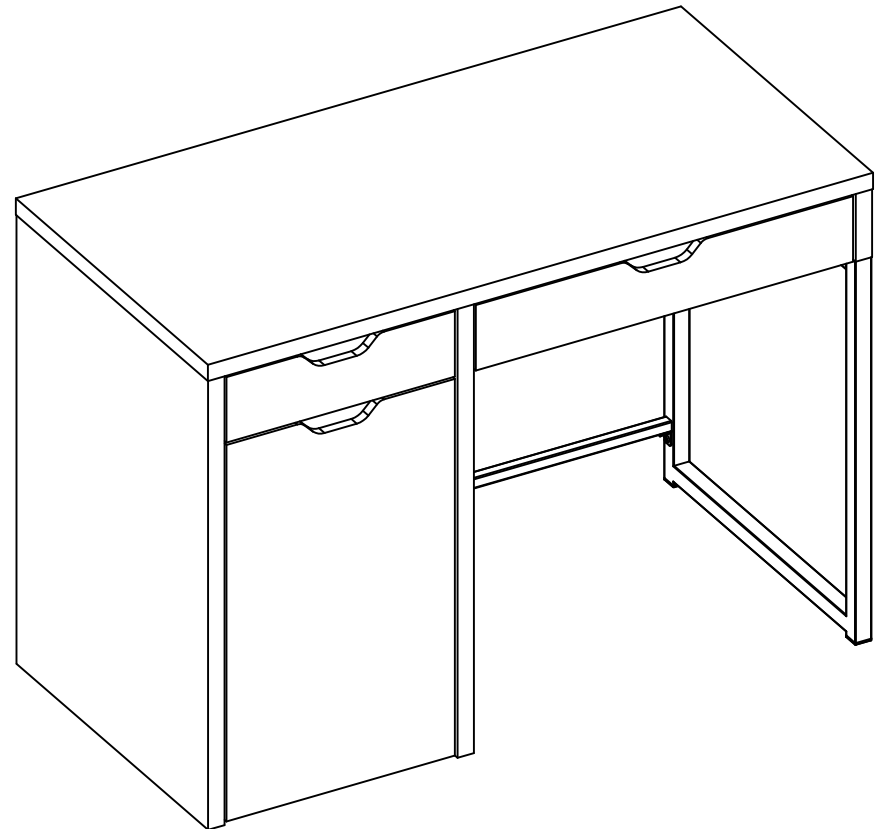

Please call for replacement parts or assistance: 1-800-729-1569
Monday - Friday 9:00 am - 5:00 pm EST

MAINSTAYS PERKINS ESCRITORIO CON EL MARCO DEL METAL CON EL ALMACENAJE PARA EL GABINETE DEL ARCHIVO

NÚMERO DE STOCK DEL VENDEDOR
MS18-D1-1009-33 BLANCO
MS18-D1-1009-34 VERDADERO ROBLE NEGRO
MS18-D1-1009-35 CACAO

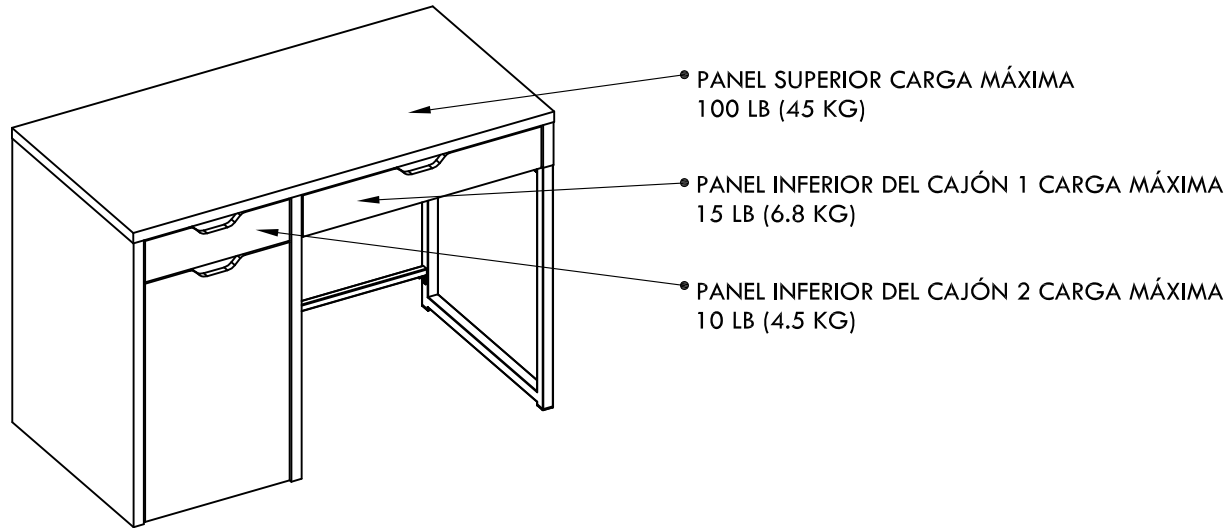

NÚMERO DE PERSONAS RECOMENDADO PARA EL ENSAMBLAJE: 1
TIEMPO ESTIMADO DE ENSAMBLAJE: 1.0 HORA.

- LLAME A NUESTRO NÚMERO GRATUITO **1-800-729-1569** PARA OBTENER MÁS AYUDA.
- PIEZAS ADICIONALES ESTÁN DISPONIBLES POR UNA TARIFA.
- ESTE MANUAL DE INSTRUCCIÓN CONTIENE INFORMACIÓN IMPORTANTE DE SEGURIDAD, POR FAVOR DE LEER Y GUARDAR PARA FUTURAS REFERENCIAS.
- NO DEJAR A LOS NIÑOS SUBIR O JUGAR SOBRE LA UNIDAD.
- LIMPIAR EL PRODUCTO CON TU PULIDOR FAVORITE DE MUEBLE Y UN TRAPO BLANDO.
- NO USAR QUÍMICOS FUERTES O PRODUCTO DE LIMPIEZA ABRASIVO.
- MUEVA SUS NUEVOS MUEBLES CUIDADOSAMENTE CON DOS PERSONAS, NUNCA EMPUJE O ARRASTRE LA UNIDAD.

NO DEVOLVER EL PRODUCTO A LA TIENDA.
TIENDAS INDIVIDUALES NO RESERVAN PIEZAS.
PARA PIEZAS PERDIDAS O DAÑADAS LLAME AL 1-800-729-1569.
PARTES SERÁN ENVIADOS DE FORMA GRATUITA
PARA UN SERVICIO RÁPIDO Y CONFIABLE, POR FAVOR DE TENER A MANO EL MANUAL DE ENSAMBLAJE.

NÚMERO DE PARTIDA _____
FECHA DE COMPRA ____/____/____

Huisen Furniture (Longnan) Co.,Ltd.
Diseñado en el E.E.U.U.
Hecho en China



Estamos disponibles para ayudarlo de Lunes - Viernes de 9:00 am - 5:00 pm Hora de la Zona Este.
1-800-729-1569
Sólo E.E.U.U.

MAINSTAYS PERKINS ESCRITORIO CON EL MARCO DEL METAL CON EL ALMACENAJE PARA EL GABINETE DEL ARCHIVO

NÚMERO DE STOCK DEL VENDEDOR
MS18-D1-1009-33 BLANCO
MS18-D1-1009-34 VERDADERO ROBLE NEGRO
MS18-D1-1009-35 CACAO



ANTES DE COMENZAR

- Leer y entender todos los pasos cuidadosamente antes de comenzar. Si no se sigue cada paso en el orden correcto, el montaje será difícil y puede ocasionar daños.
- Trabajar en una zona amplia, mejor sobre la alfombra, cerca del sitio donde la unidad se utiliza.
- Asegurarse de que todas las piezas estén incluidos. La mayoría de los tableros están etiquetados con una pegatina removible.

CONSEJOS ÚTILES

- Llamar a nuestro número gratis para ayuda. Estamos disponibles para ayudarlo de Lunes - Viernes de 9:00 am - 5:00 pm Hora de la Zona Este.
- **1-800-729-1569** Sólo E.E.U.U.

HERRAMIENTAS NECESARIAS PARA ENSAMBLAR

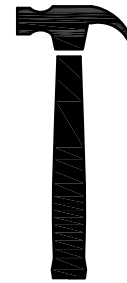

martillo



destornillador de
cabeza plana



destornillador de
cabeza phillips

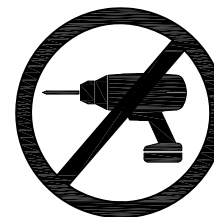

**NO UTILICE HERRAMIENTAS
ELÉCTRICAS PARA MONTAR SUS
MUEBLES. HERRAMIENTAS
ELÉCTRICAS PUEDEN DAÑAR LAS
PIEZAS Y PROVOCAR DAÑOS**

Huisen Furniture (Longnan) Co.,Ltd.
Diseñado en el E.E.U.U.
Hecho en China



Estamos disponibles para ayudarlo de Lunes - Viernes
de 9:00 am - 5:00 pm Hora de la Zona Este.
1-800-729-1569
Sólo E.E.U.U.

MAINSTAYS PERKINS ESCRITORIO CON EL MARCO DEL METAL CON EL ALMACENAJE PARA EL GABINETE DEL ARCHIVO

NÚMERO DE STOCK DEL VENDEDOR
MS18-D1-1009-33 BLANCO
MS18-D1-1009-34 VERDADERO ROBLE NEGRO
MS18-D1-1009-35 CACAO

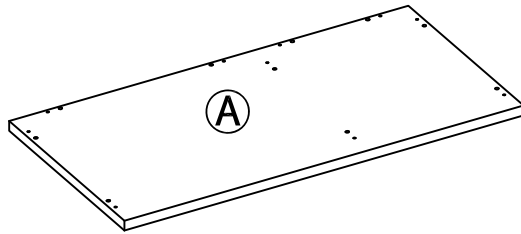

Panel superior
(Cantidad: 1)

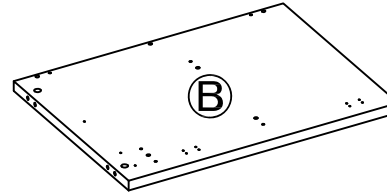

Panel izquierdo
(Cantidad: 1)

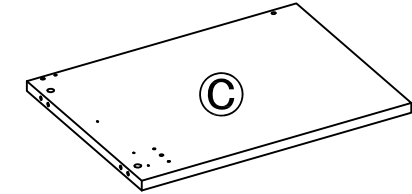

Panel del medio
(Cantidad: 1)

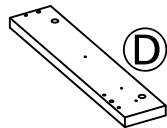

Panel derecho
(Cantidad: 1)

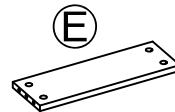

Travesaño 1
(Cantidad: 1)

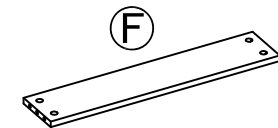

Travesaño 2
(Cantidad: 1)

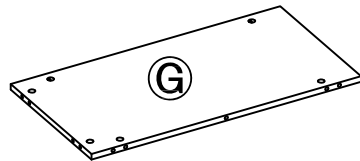

Panel posterior 1
(Cantidad: 1)

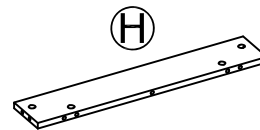

Panel posterior 2
(Cantidad: 1)

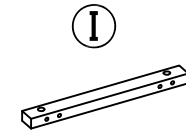

Carril de parada
(Cantidad: 1)

**VERIFIQUE QUE TODAS LAS PIEZAS ESTÉN EN LA LISTA
ANTES DE COMENZAR**



Estamos disponibles para ayudarlo de Lunes - Viernes
de 9:00 am - 5:00 pm Hora de la Zona Este.
1-800-729-1569
Sólo E.E.U.U.

MAINSTAYS PERKINS ESCRITORIO CON EL MARCO DEL METAL CON EL ALMACENAJE PARA EL GABINETE DEL ARCHIVO

NÚMERO DE STOCK DEL VENDEDOR
MS18-D1-1009-33 BLANCO
MS18-D1-1009-34 VERDADERO ROBLE NEGRO
MS18-D1-1009-35 CACAO

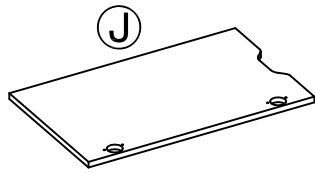

Panel de puerta
(Cantidad: 1)

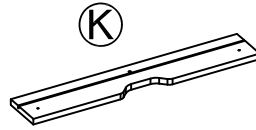

Panel frontal del cajón 1
(Cantidad: 1)

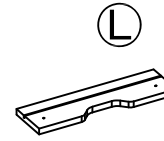

Panel frontal del cajón 2
(Cantidad: 1)

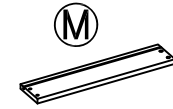

Panel izquierdo cajón
(Cantidad: 2)



Panel derecho cajón
(Cantidad: 2)

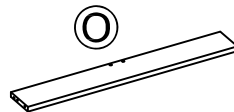

Panel posterior del cajón 1
(Cantidad: 1)

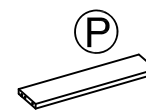

Panel posterior del cajón 2
(Cantidad: 1)

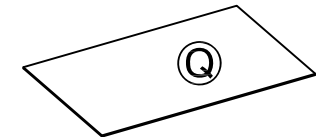

Panel inferior del cajón 1
(Cantidad: 1)

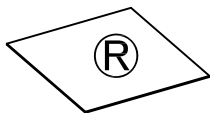

Panel inferior del cajón 2
(Cantidad: 1)

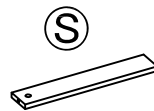

Panel de soporte del cajón
(Cantidad: 1)

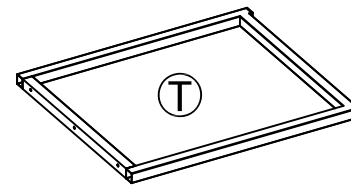

Marco lateral de metal
(Cantidad: 1)

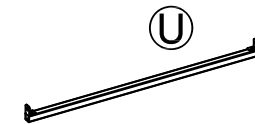

Tubo de metal
(Cantidad: 1)

**VERIFIQUE QUE TODAS LAS PIEZAS ESTÉN EN LA LISTA
ANTES DE COMENZAR**



Estamos disponibles para ayudarlo de Lunes - Viernes
de 9:00 am - 5:00 pm Hora de la Zona Este.
1-800-729-1569
Sólo E.E.U.U.

MAINSTAYS PERKINS ESCRITORIO CON EL MARCO DEL METAL CON EL ALMACENAJE PARA EL GABINETE DEL ARCHIVO

NÚMERO DE STOCK DEL VENDEDOR
MS18-D1-1009-33 BLANCO
MS18-D1-1009-34 VERDADERO ROBLE NEGRO
MS18-D1-1009-35 CACAO

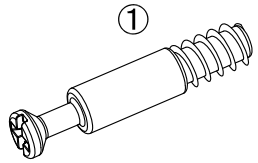

Tornillo de combadura 1
Cantidad: 26+1 Extra

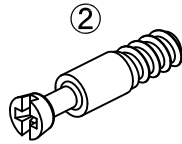

Tornillo de combadura 2
Cantidad: 1

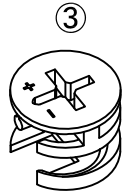

Cerrojo de combadura 1
Cantidad: 26+1 Extra



Cerrojo de combadura 2
Cantidad: 1

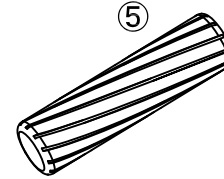

Clavija de madera
Cantidad: 25+1 Extra

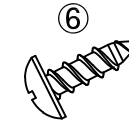

Tornillo 1
Cantidad: 8

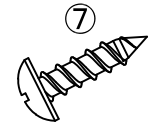

Tornillo 2
Cantidad: 4

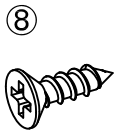

Tornillo 3
Cantidad: 32+1 Extra

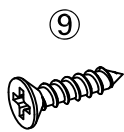

Tornillo 4
Cantidad: 4

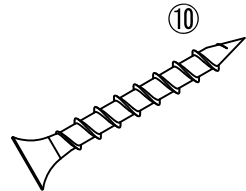

Tornillo 5
Cantidad: 10

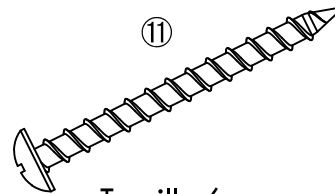

Tornillo 6
Cantidad: 3

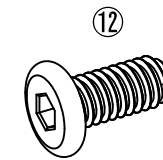

Tornillo
Cantidad: 2

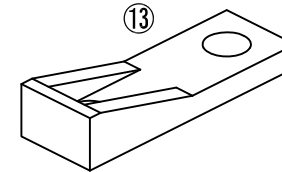

Taco plástico
Cantidad: 2

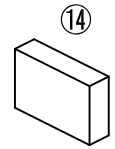

Almohadilla de EVA
Cantidad: 2

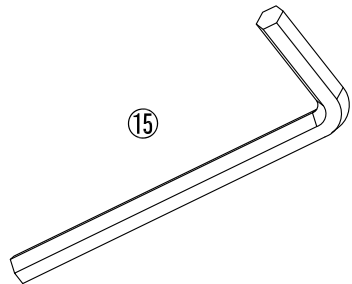

Llave allen
Cantidad: 1

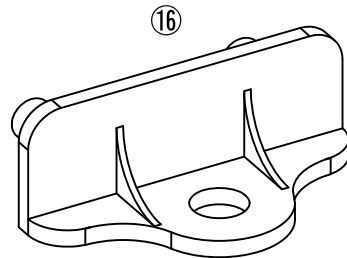

Conector de plástico
Cantidad: 4

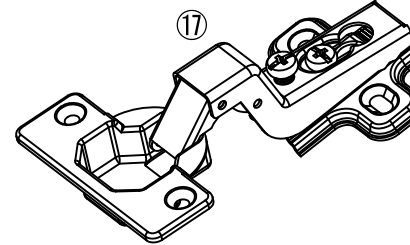

Bisagras
Cantidad: 2

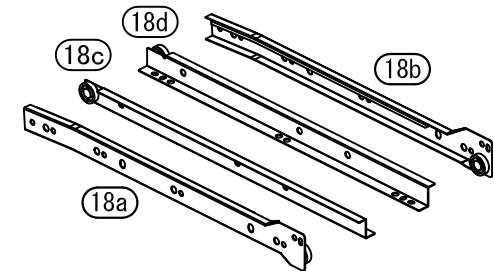

Diapositiva
Cantidad: 2

**VERIFIQUE QUE TODAS LAS PIEZAS ESTÉN EN LA LISTA
ANTES DE COMENZAR**



Estamos disponibles para ayudarlo de Lunes - Viernes
de 9:00 am - 5:00 pm Hora de la Zona Este.
1-800-729-1569
Sólo E.E.U.U.

MAINSTAYS PERKINS ESCRITORIO CON EL MARCO DEL METAL CON EL ALMACENAJE PARA EL GABINETE DEL ARCHIVO

NÚMERO DE STOCK DEL VENDEDOR
MS18-D1-1009-33 BLANCO
MS18-D1-1009-34 VERDADERO ROBLE NEGRO
MS18-D1-1009-35 CACAO

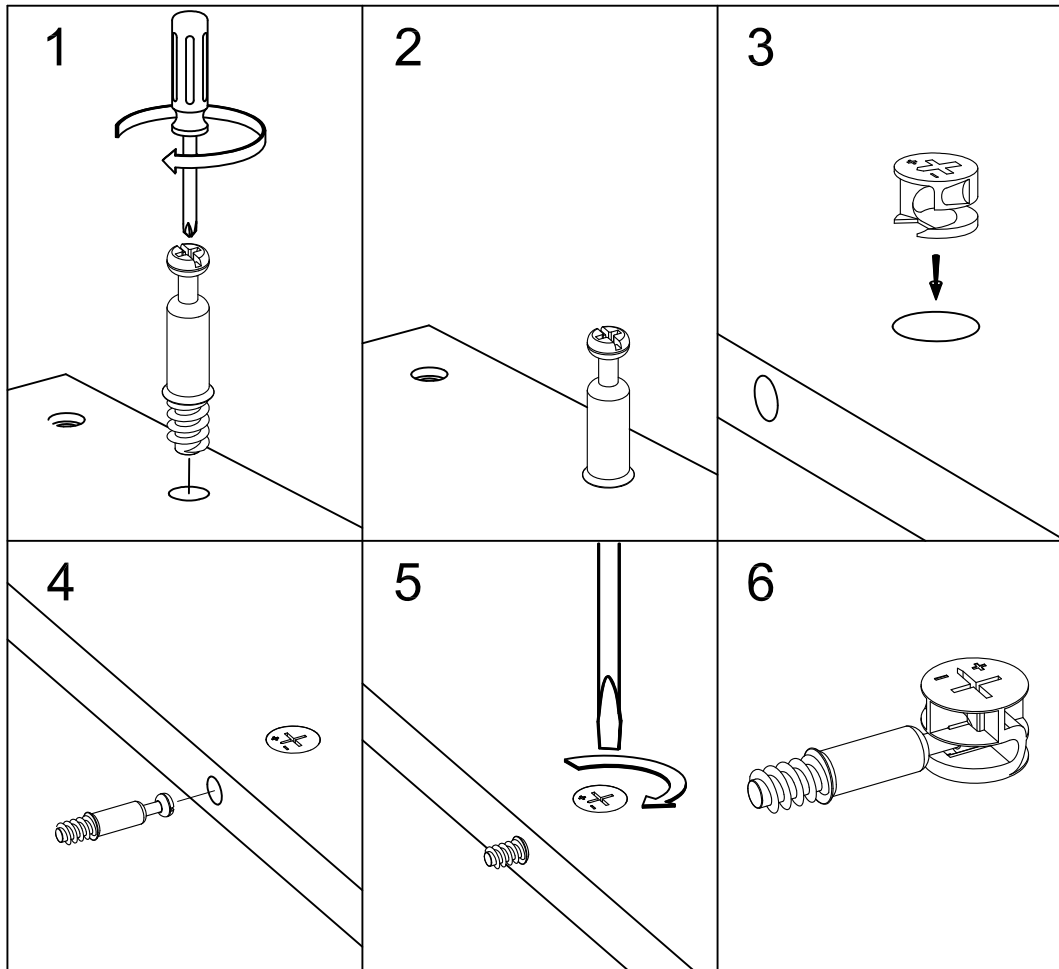

SISTEMA DE FIJACIÓN CAM

1. Atornille el **Tornillo de combadura** en el panel pretaladrado. El tornillo debe apretarse para que no haya roscas visibles.
2. El anillo más grande del cam debe tocar el panel.
3. Inserte el **Cerrojo de combadura** en el agujero pretaladrado en el panel. Los signos de más y menos deben estar orientados hacia el exterior del panel.
4. Conecte el **Tornillo de combadura** previamente apretado con el panel conectado en el **Cerrojo de combadura**.
5. Usando un destornillador de cabeza plana, gire el **Cerrojo de combadura** hasta la mitad en sentido antihorario para asegurar el **Tornillo de combadura**.
6. **SI NO SE ASEGURA ADECUADAMENTE EL CERROJO DE COMBADURA Y EL TORNILLO DE COMBADURA, PODRÍA RESULTAR INESTABILIDAD Y FALLAS EN EL PRODUCTO.**

Huisen Furniture (Longnan) Co.,Ltd.
Diseñado en el E.E.U.U.
Hecho en China



Estamos disponibles para ayudarlo de Lunes - Viernes
de 9:00 am - 5:00 pm Hora de la Zona Este.
1-800-729-1569
Sólo E.E.U.U.

1

Inserte el hardware ① ③ ⑤ en la parte A y I como se muestra.

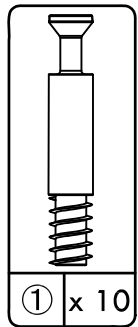
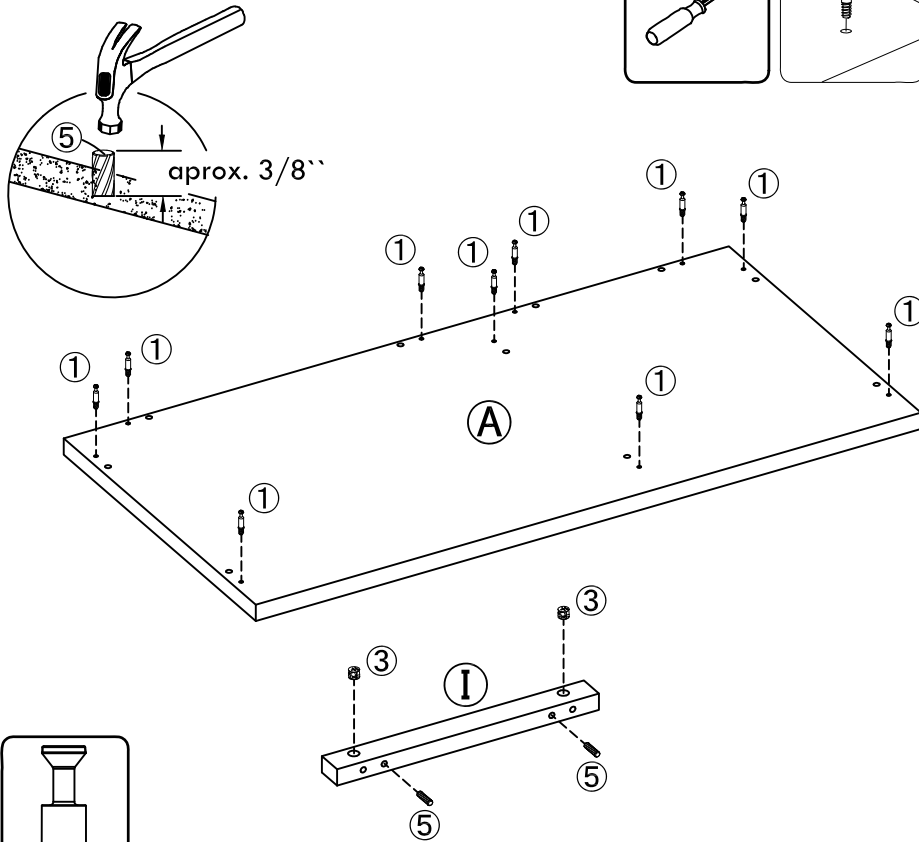
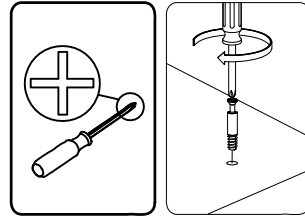

① x 10
Tornillo de combadura 1

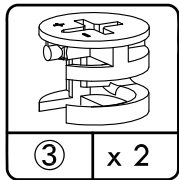

③ x 2
Cerrojo de combadura 1

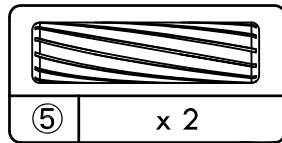

⑤ x 2
Clavija de madera

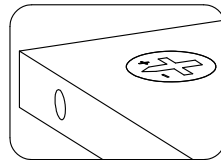

La flecha del camlock debe apuntar al orificio pretaladrado

2

Inserte el hardware ③ ④ ⑤ en la parte E y F y S como se muestra.

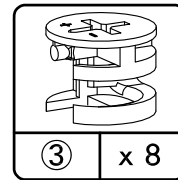
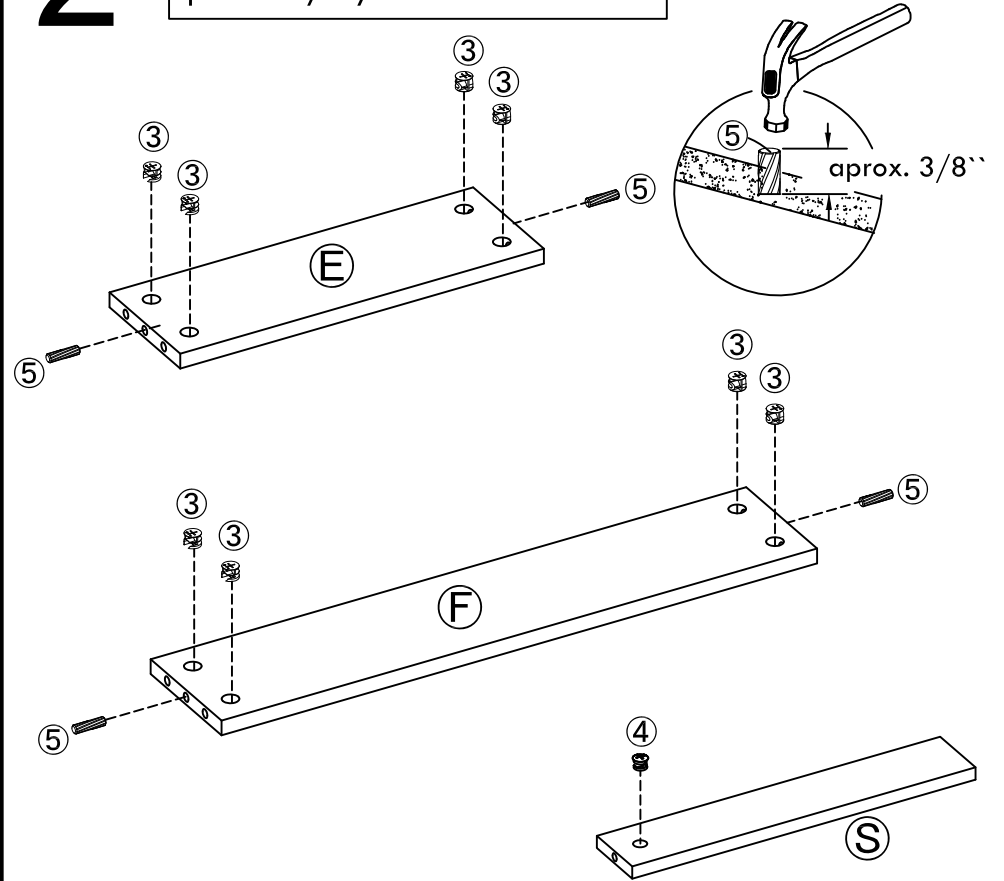

③ x 8
Cerrojo de combadura 1

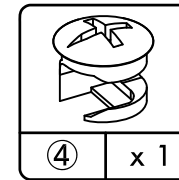

④ x 1
Cerrojo de combadura 2

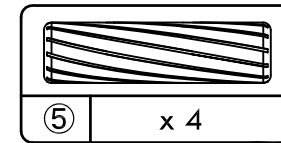

⑤ x 4
Clavija de madera

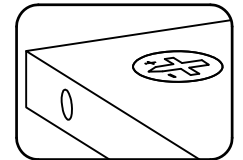

La flecha del camlock debe apuntar al orificio pretaladrado

3

Inserte el hardware ①③⑤ en la parte B como se muestra, luego fije la diapositiva 18a usando el tornillo ⑧ como se muestra.

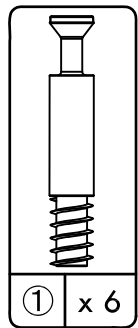
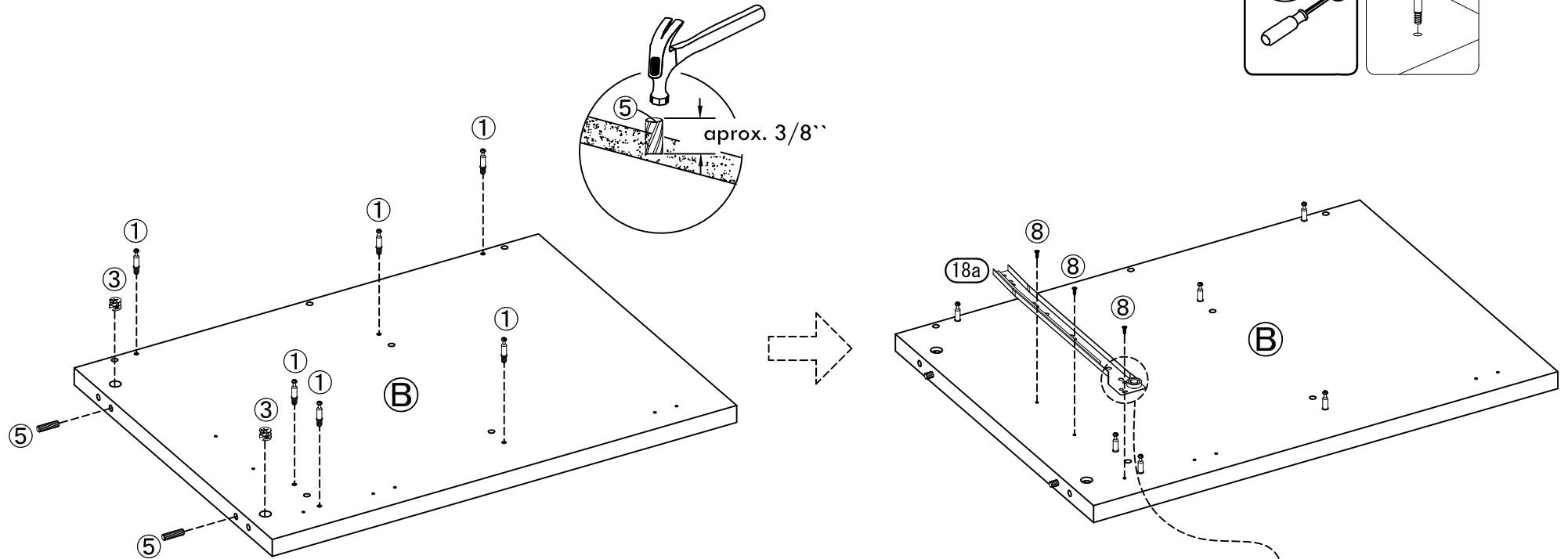
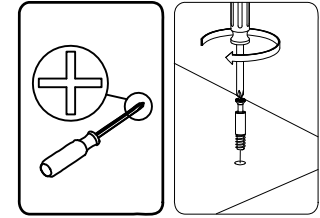

① x 6
Tornillo de combadura 1

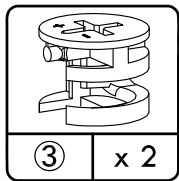

③ x 2
Cerrojo de combadura 1

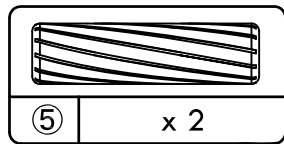

⑤ x 2
Clavija de madera

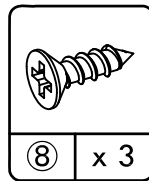

⑧ x 3
Tornillo 3

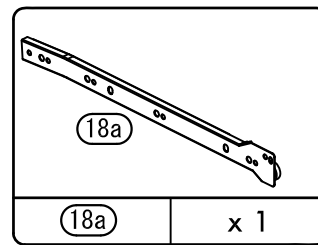

18a x 1
Diapositiva

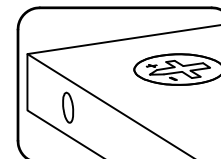

La flecha del camlock debe apuntar al orificio pretaladrado

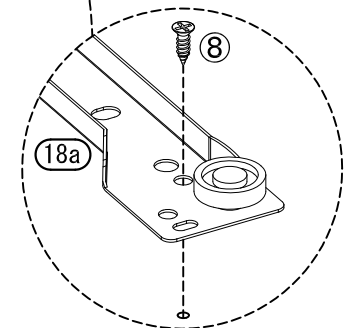

4

Inserte el hardware ①③⑤ en la parte D como se muestra, luego fije la diapositiva 18b usando el tornillo ⑧ como se muestra.

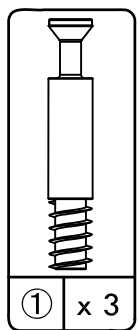
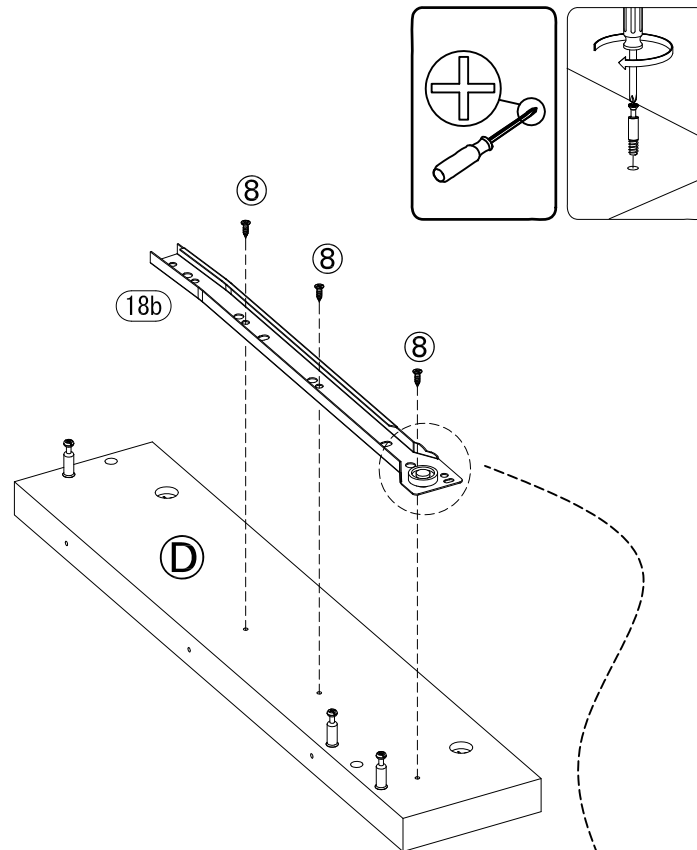
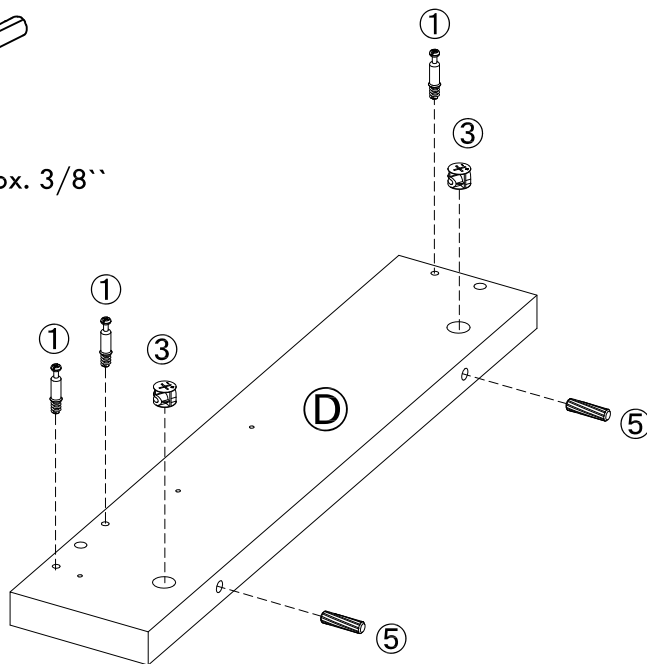
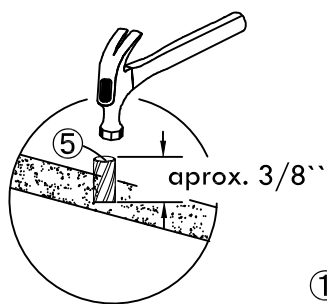

① x 3
Tornillo de combadura 1

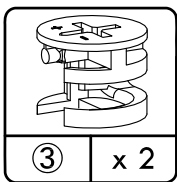

③ x 2
Cerrojo de combadura 1

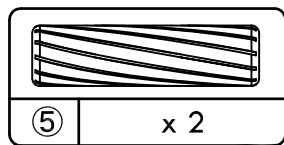

⑤ x 2
Clavija de madera

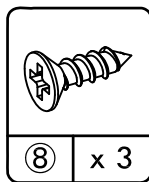

⑧ x 3
Tornillo 3

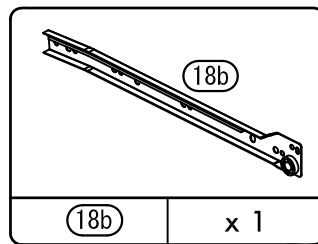

⑱b x 1
Diapositiva

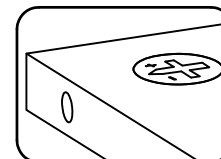

La flecha del camlock debe apuntar al orificio pretaladrado

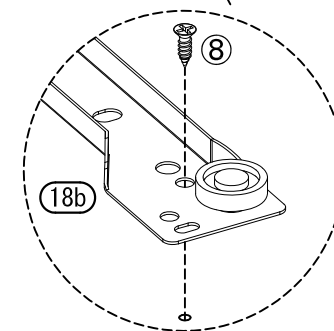

5

Inserte el hardware ①⑨⑬ en el primer lado de la parte C, luego fije la diapositiva 18b usando el tornillo ⑧ como se muestra.
 Tuego, voltea al lado opuesto de la parte C y inserte el hardware ①③⑤⑧, Luego fije la diapositiva 18a usando el tornillo ⑧ como se muestra.

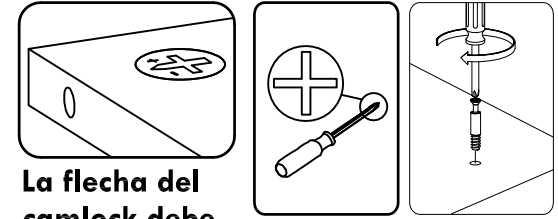
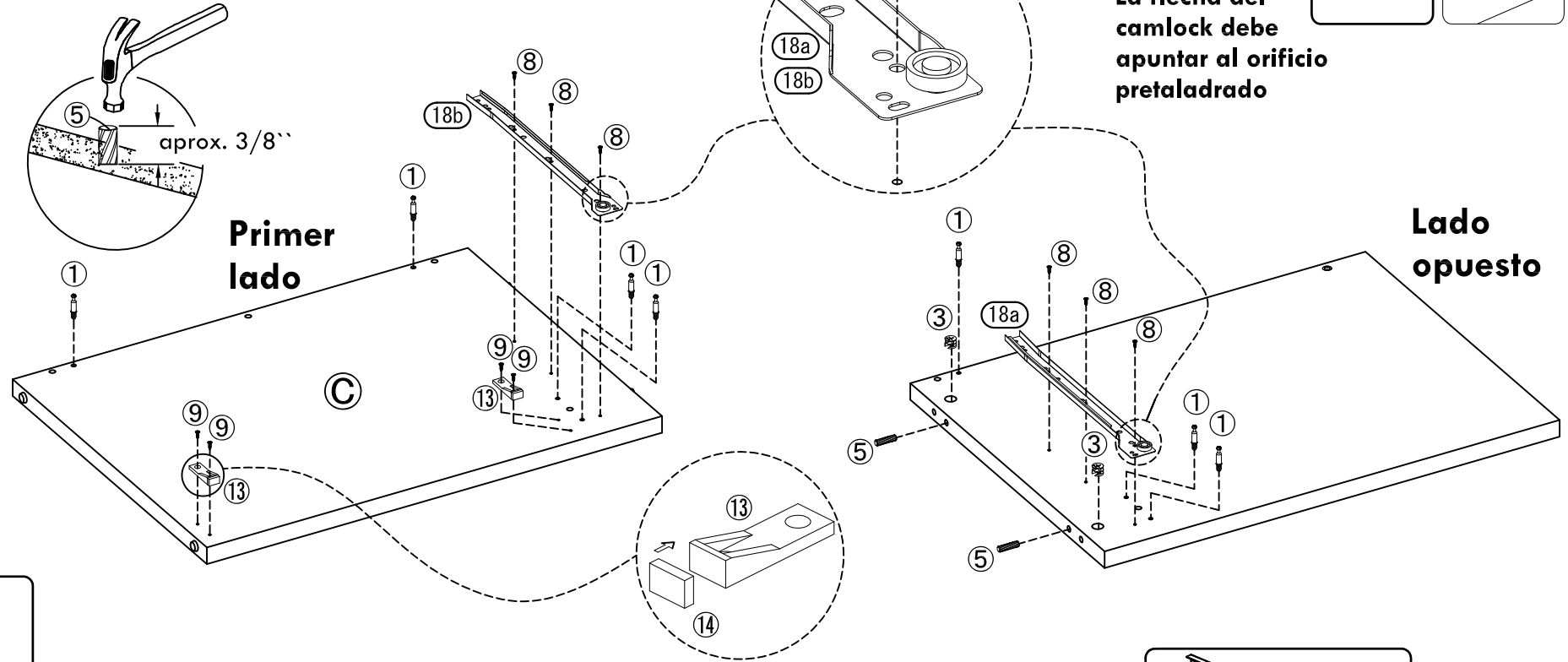

La flecha del camlock debe apuntar al orificio pretaladrado

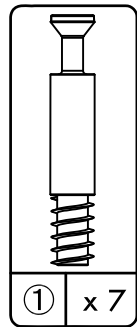

Tornillo de combadura 1

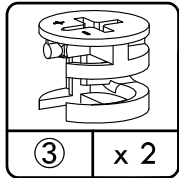

Cerrojo de combadura 1

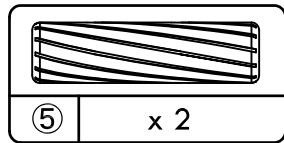

Clavija de madera

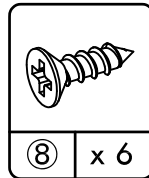

Tornillo 3

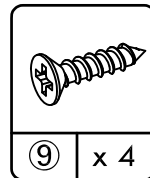

Tornillo 4

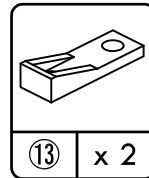

Taco plástico

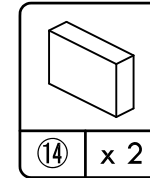

Almohadilla de EVA

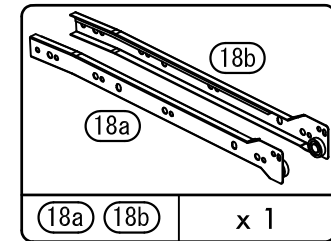

Diapositiva

6

Inserte el hardware ③ ⑤ en la parte G y H como se muestra.

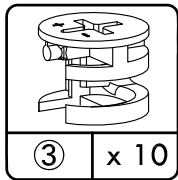
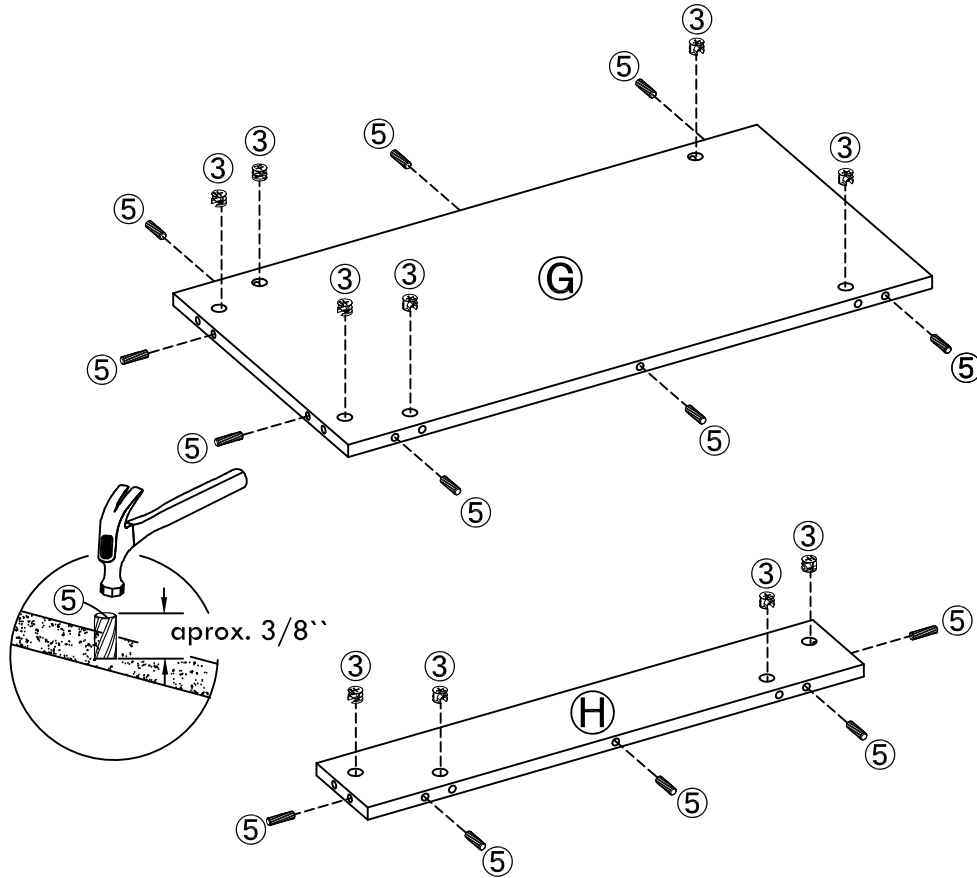

③ x 10
Cerrojo de combadura 1

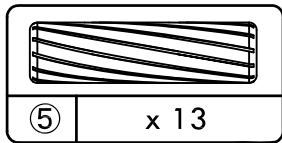

⑤ x 13
Clavija de madera

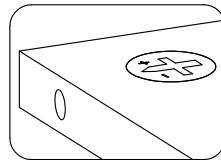

La flecha del camlock debe apuntar al orificio pretaladrado

7

Fije las bisagras ⑰ a la parte J usando el tornillo ⑧ como se muestra.

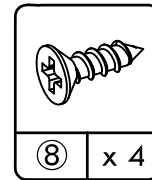
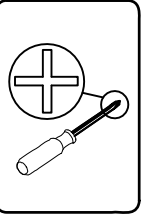
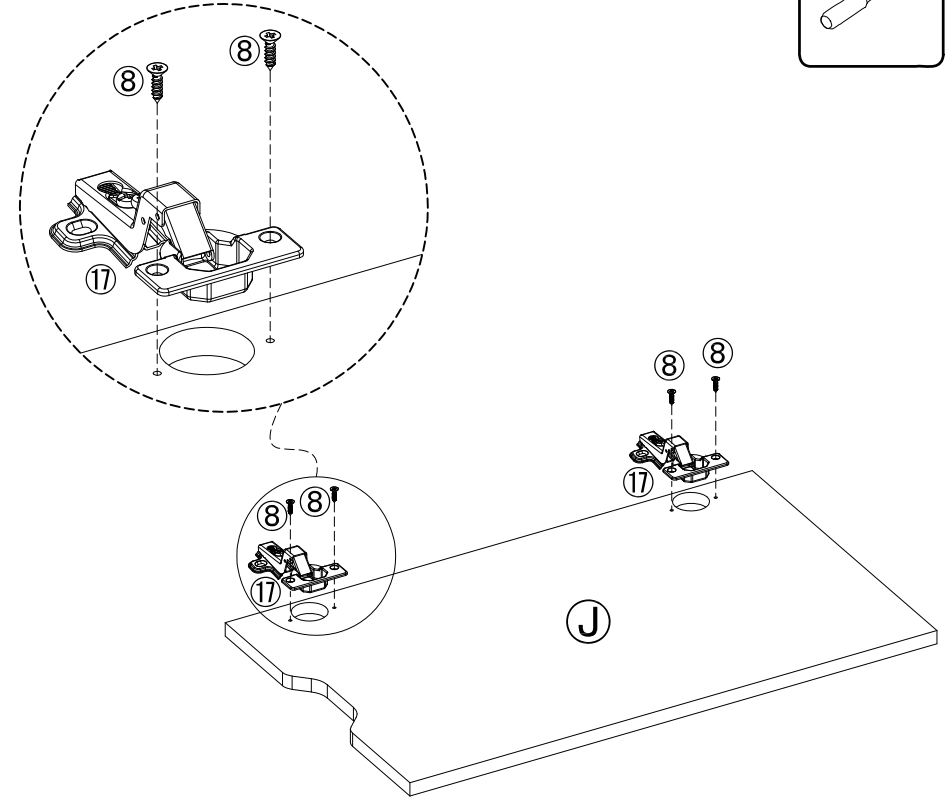

⑧ x 4
Tornillo 3

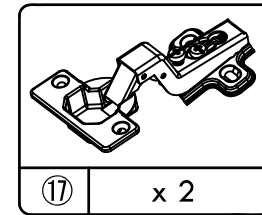

⑰ x 2
Bisagras

8

Inserte el hardware ② ⑦ ⑱ en la parte K y L como se muestra.

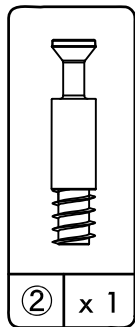
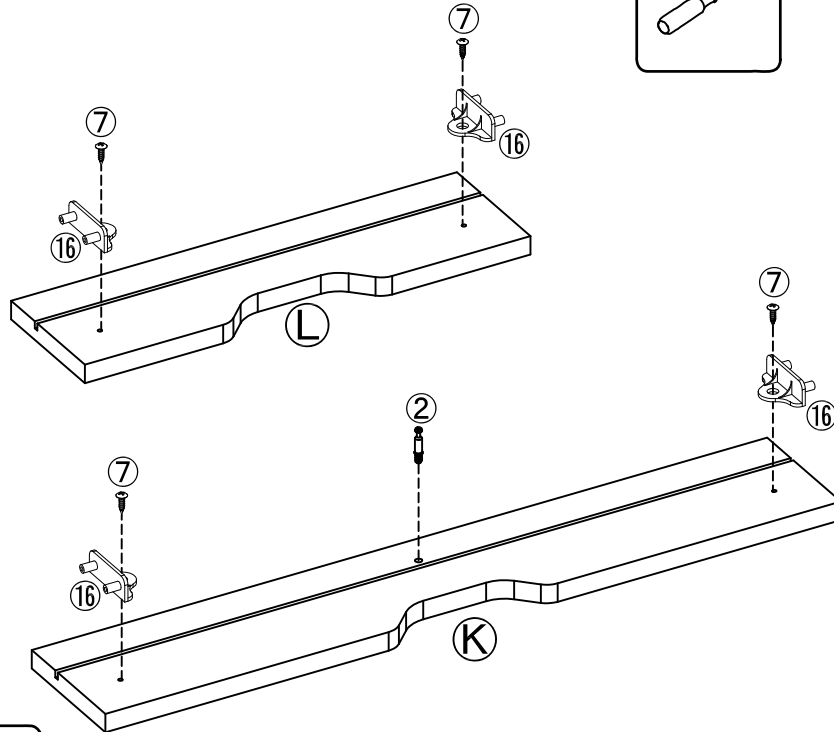
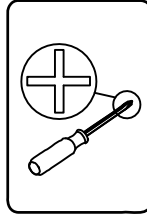

② x 1

Tornillo de combadura 2

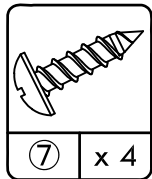

⑦ x 4

Tornillo 2

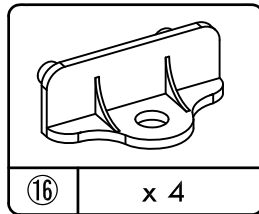

⑱ x 4

Conector de plástico

9

Fije la parte M y N y S a la parte O usando el tornillo ⑩ como se muestra, luego inserte la parte Q en la parte inferior como se muestra.

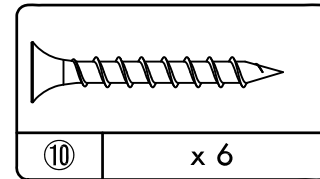
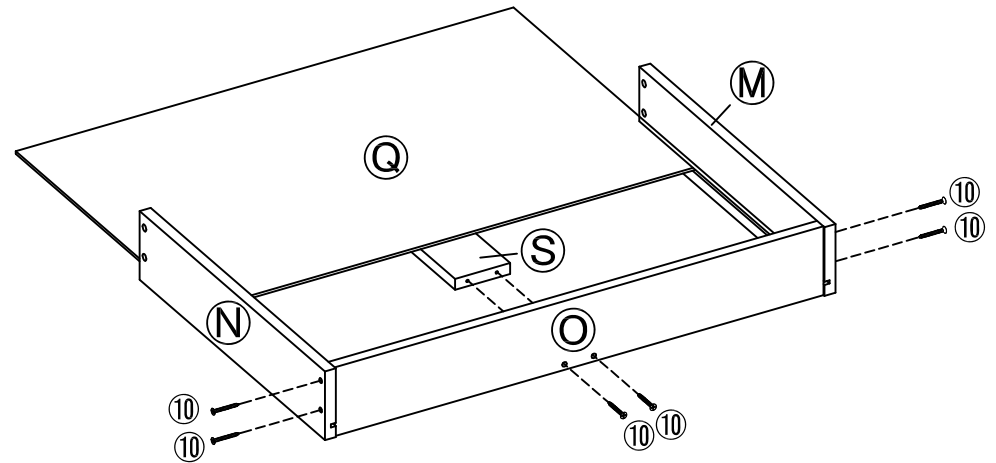
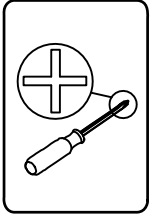

⑩ x 6

Tornillo 5

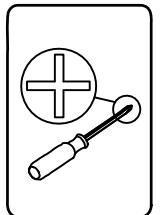

10

Fije la parte K a la estructura usando el tornillo ⑥ como se muestra.

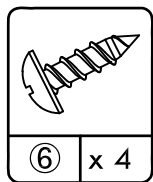
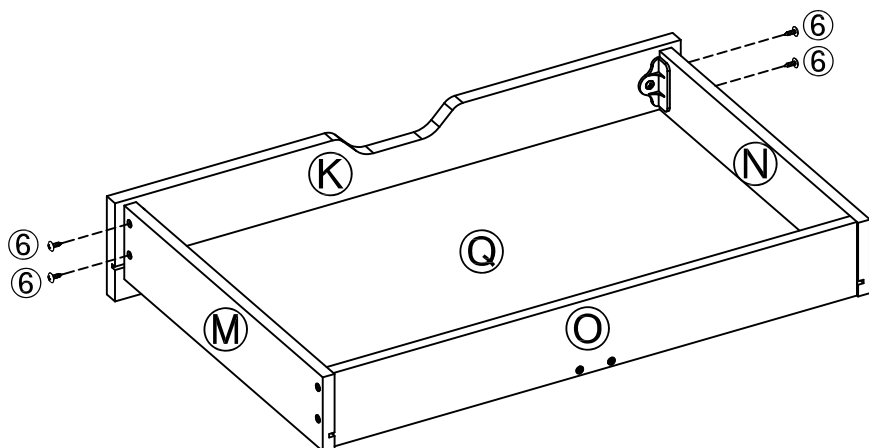
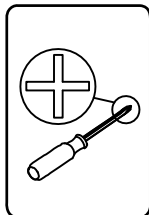

Tornillo 1

11

Fije la parte M y N a la parte P usando el tornillo ⑩ como se muestra, luego inserte la parte R en la parte inferior como se muestra.

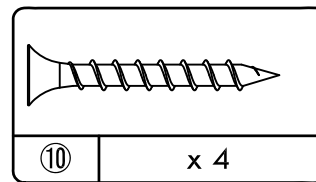
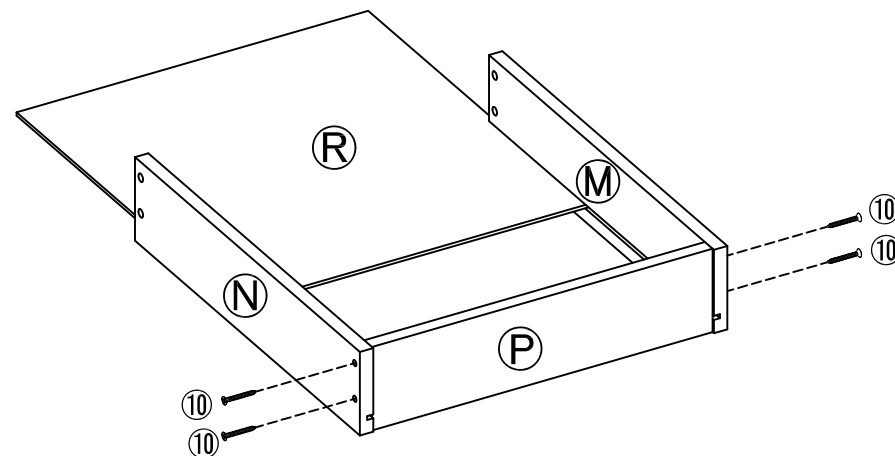
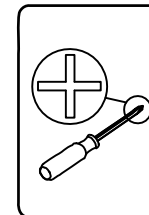

Tornillo 5

12

Fije la parte L a la estructura usando el tornillo ⑥ como se muestra.

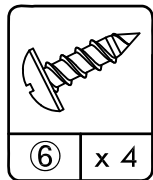
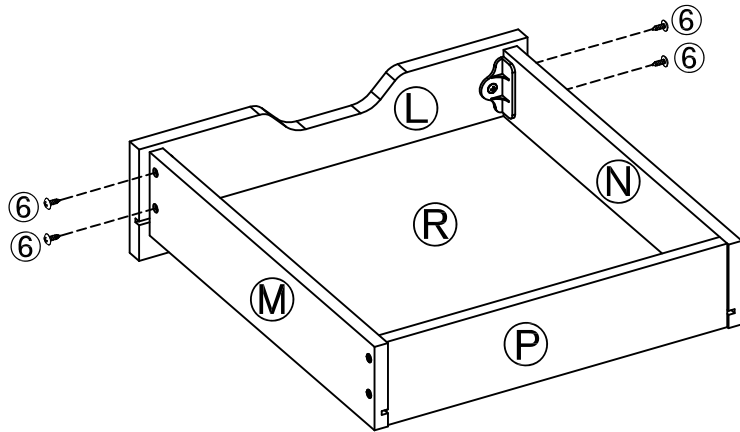
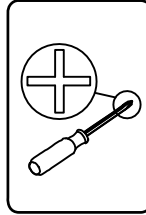

⑥ x 4

Tornillo 1

13

Fije la diapositiva 18c y 18d en la parte M y N usando el tornillo ⑧ como se muestra, luego apriete las cerraduras de la leva ④ om parte S.

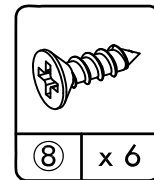
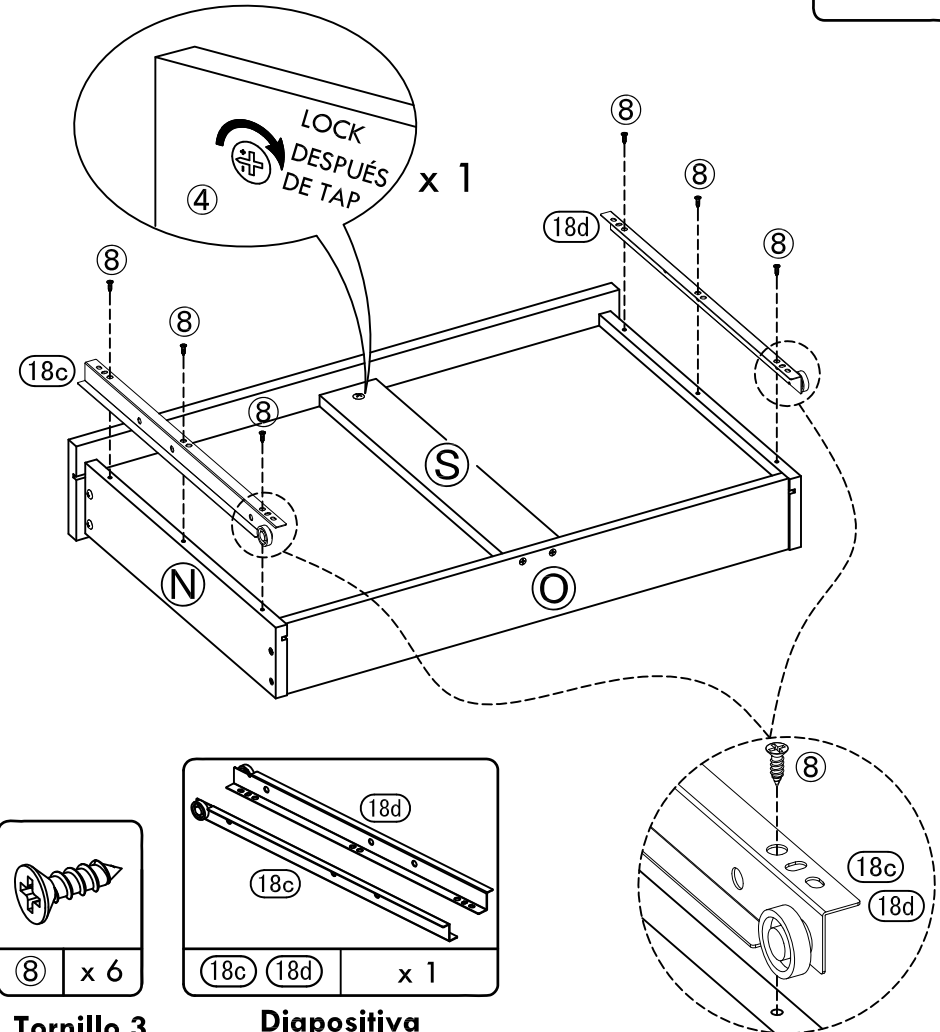
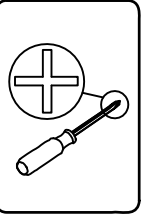

⑧ x 6

Tornillo 3

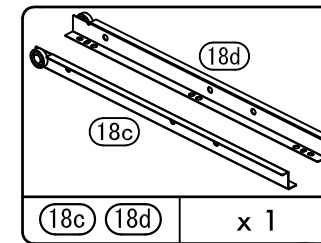

18c 18d x 1

Diapositiva

14

Fije la diapositiva 18c y 18d en la parte M y N usando el tornillo ⑧ como se muestra.

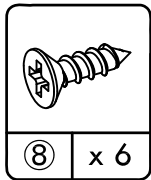
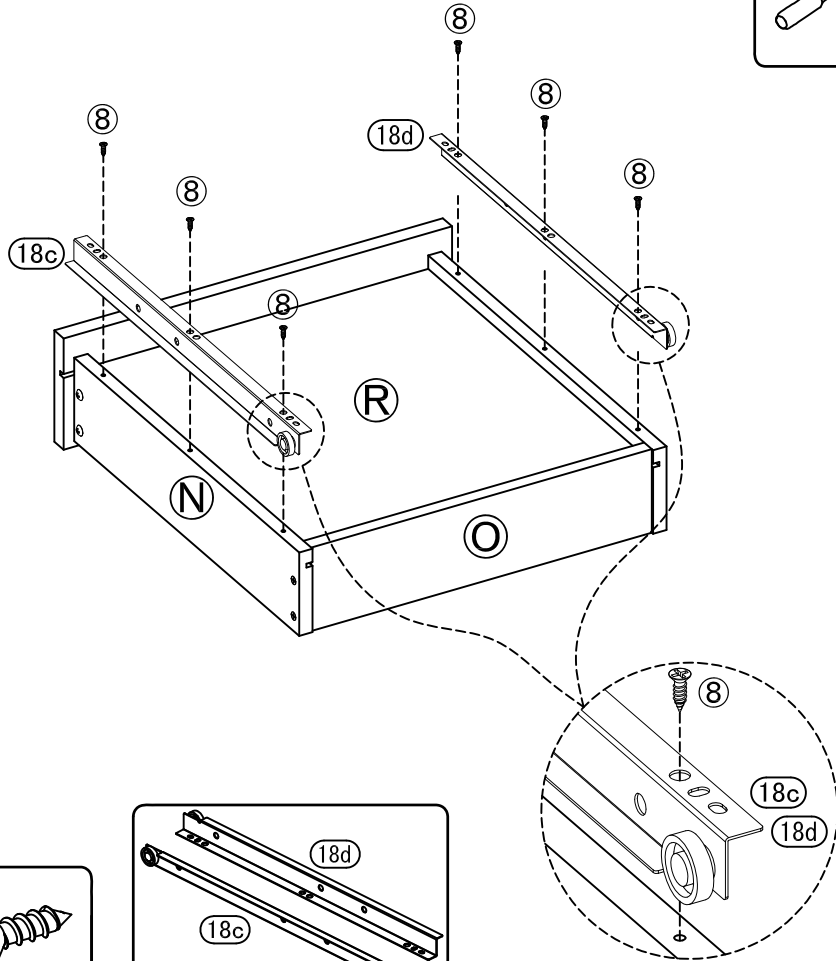
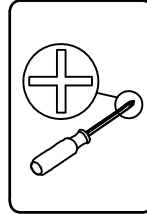

⑧ x 6

Tornillo 3

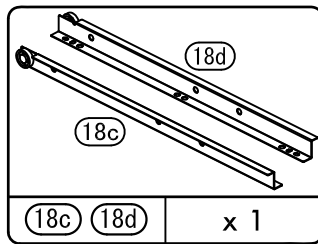

18c 18d x 1

Diapositiva

15

Fije la parte I a la parte B y luego apriete las cerraduras de la leva ③.

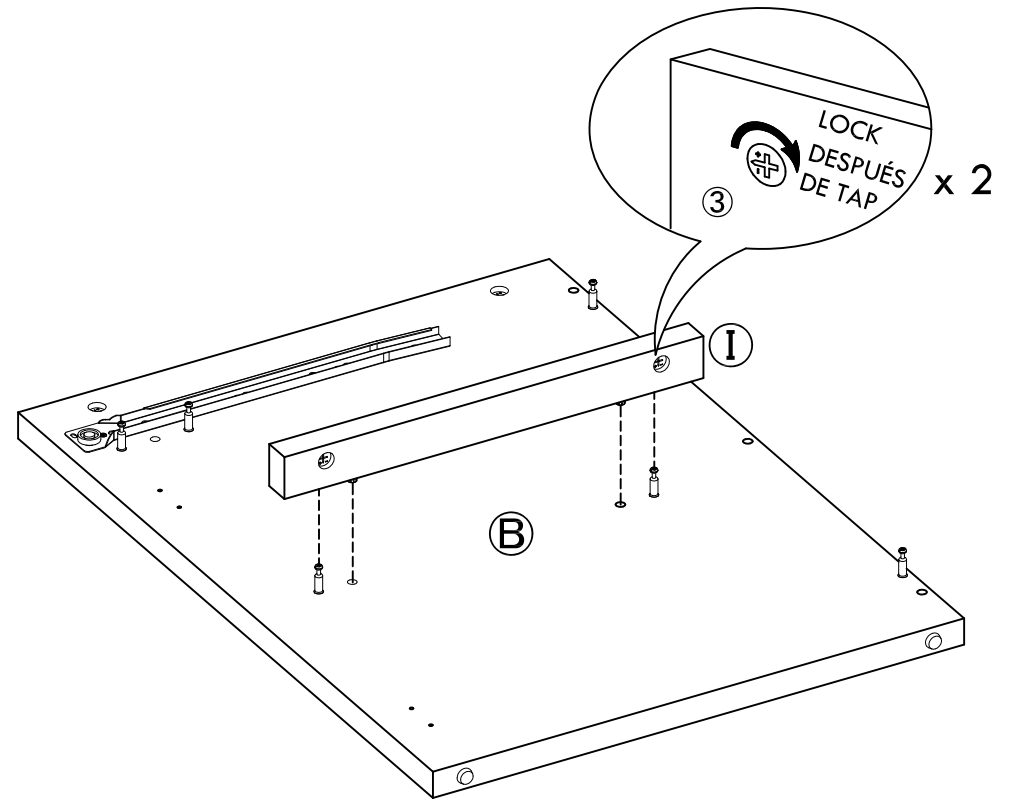
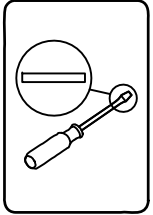

16

Fije la parte E y G a la parte C y luego apriete las cerraduras de la leva ③.

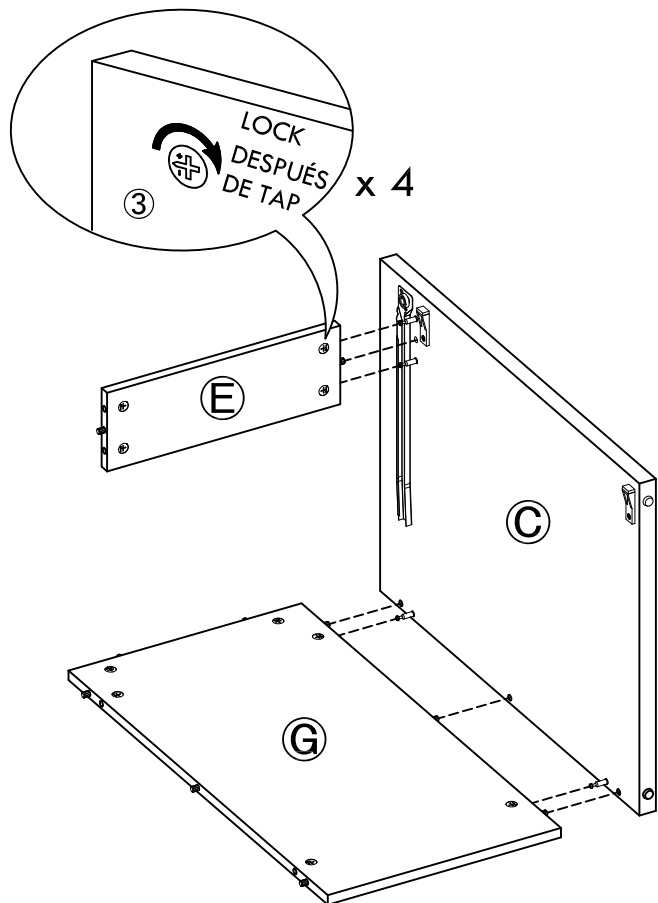
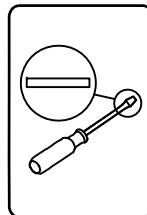

17

Fije la parte B a la estructura y luego apriete las cerraduras de la leva ③.

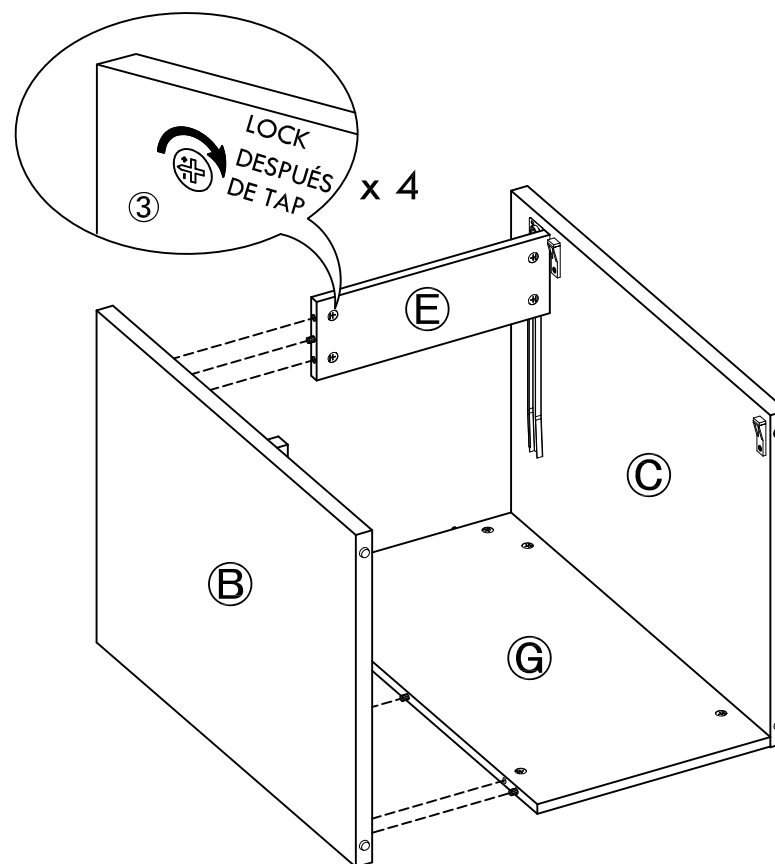
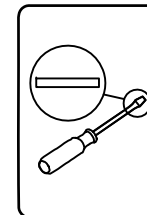

18

Fije la parte H y F a la estructura y luego apriete las cerraduras de la leva ③.

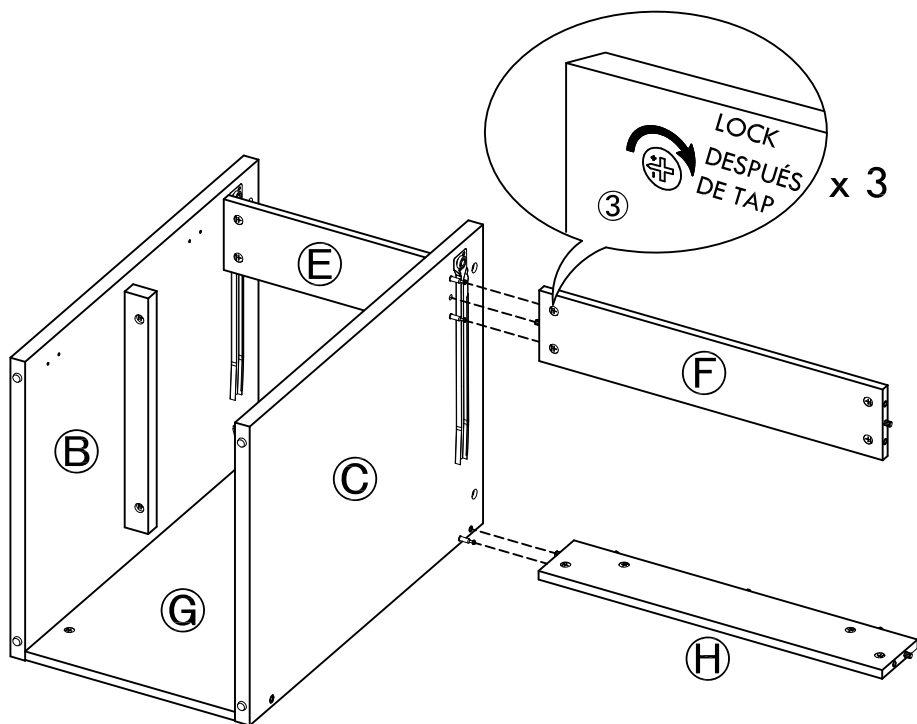
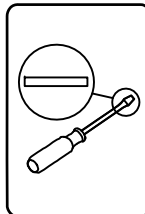

19

Fije la parte D a la estructura y luego apriete las cerraduras de la leva ③.

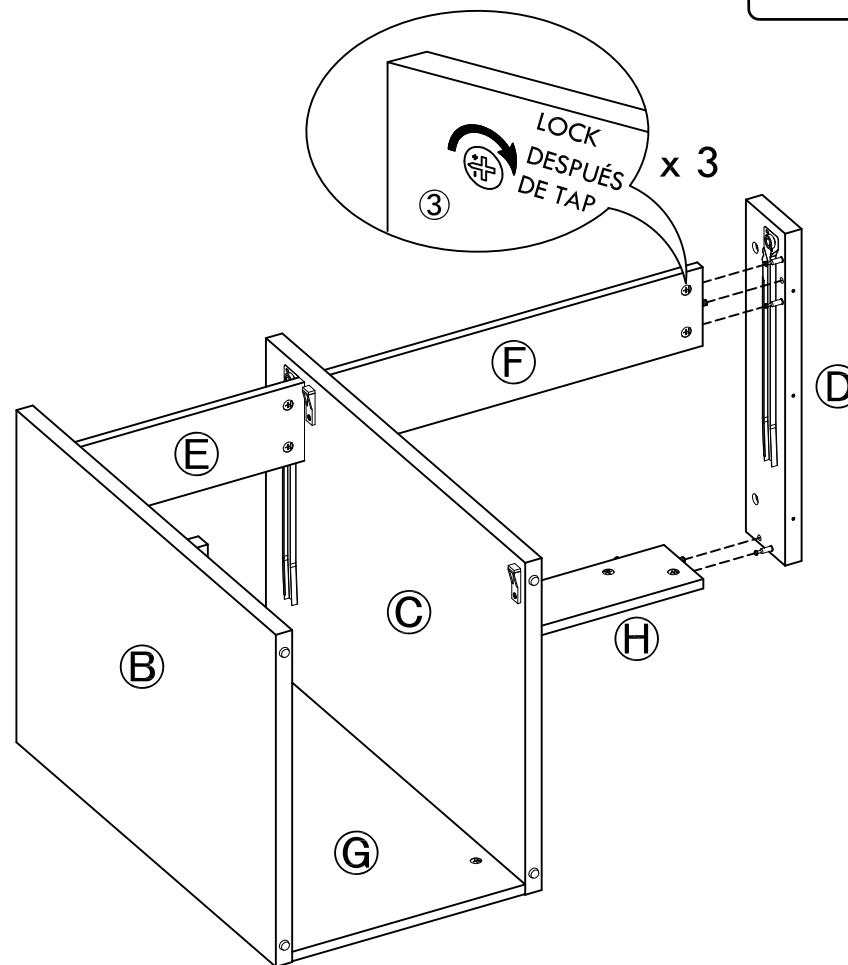
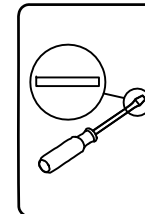

20

Fije la parte T a la estructura usando el tornillo ⑪ como se muestra.

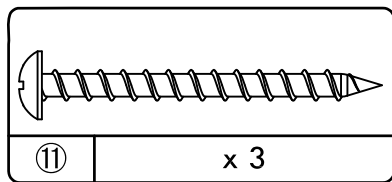
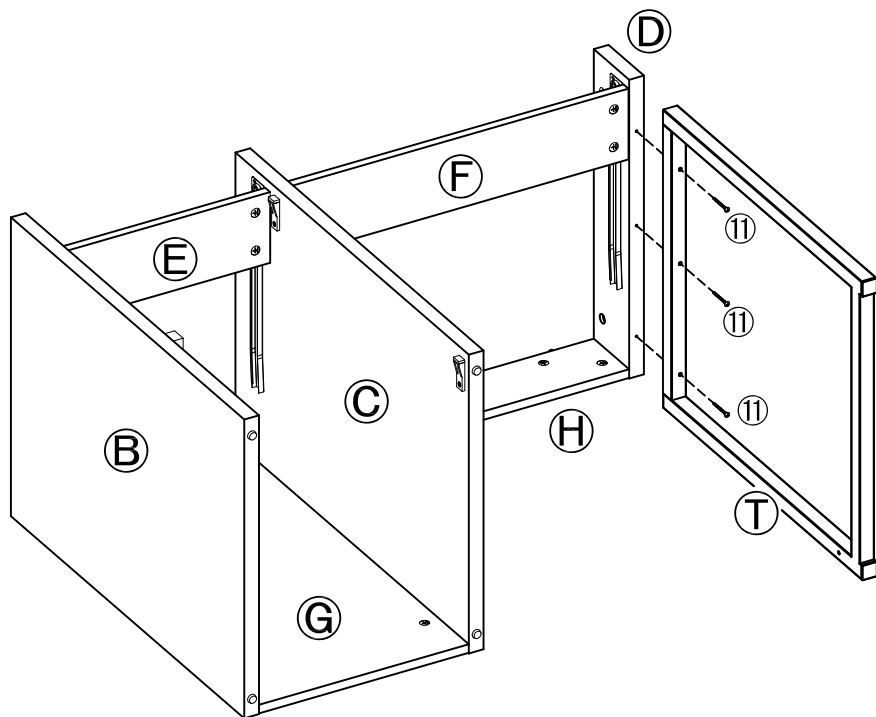
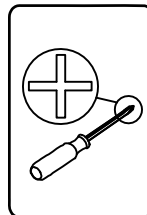

Tornillo 6

21

Fije la parte U a la estructura usando el tornillo ⑫ y llave allen como se muestra. Aprieta los tornillos por completo para evitar oscilaciones / inestabilidad.

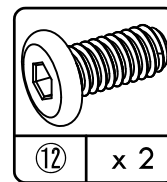
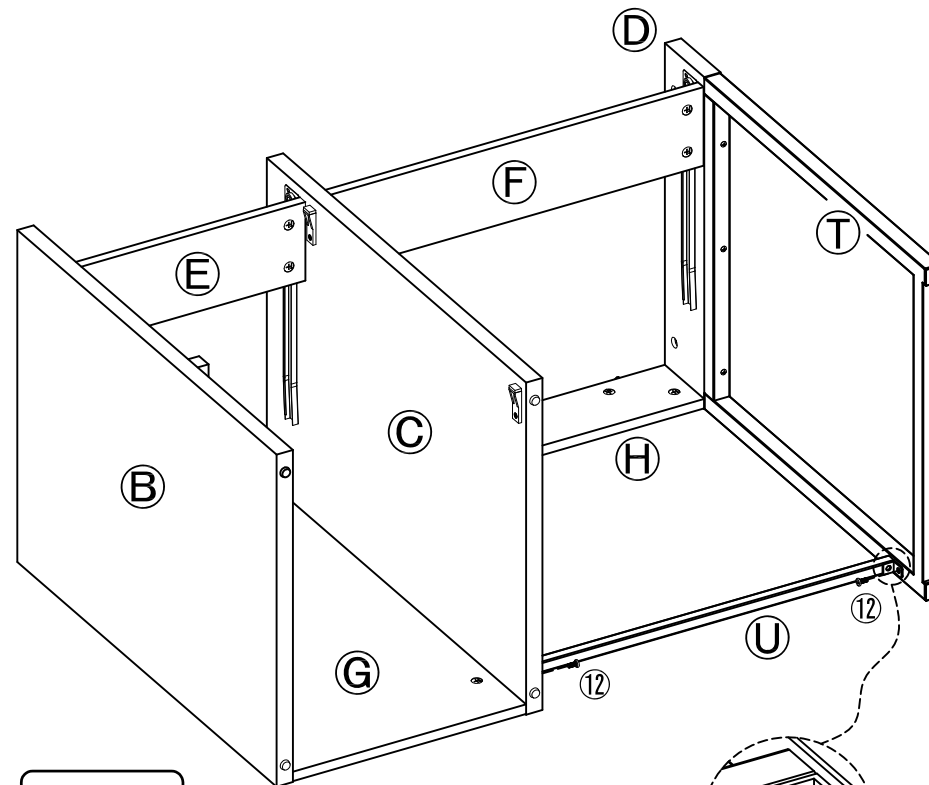
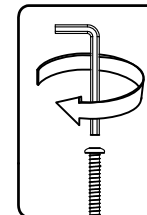

Tornillo

22

Fije la parte A a la estructura y luego apriete las cerraduras de leva ③.

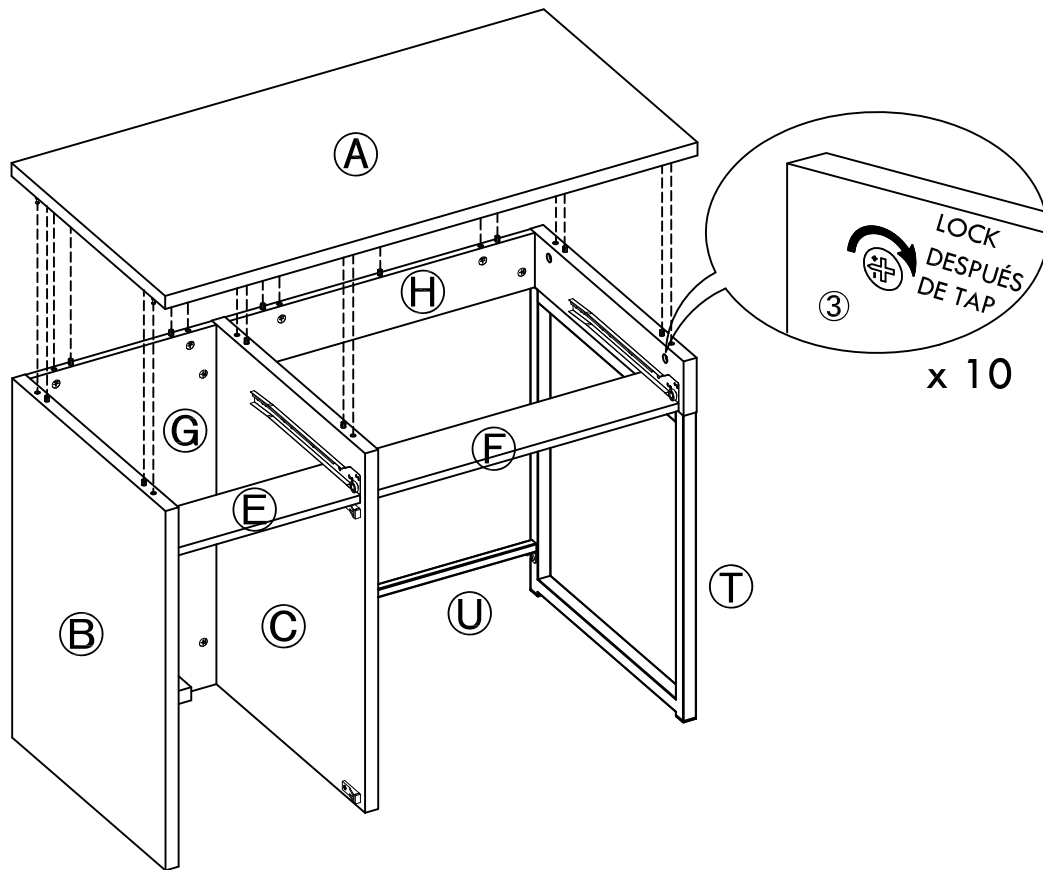
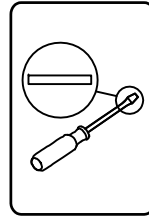

23

Ensamble el panel de puerta J en la parte B usando el tornillo ⑧ como se muestra.

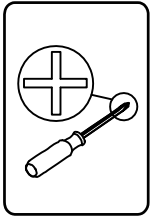

Ajuste de posibilidades

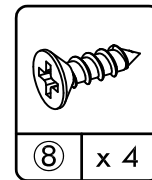
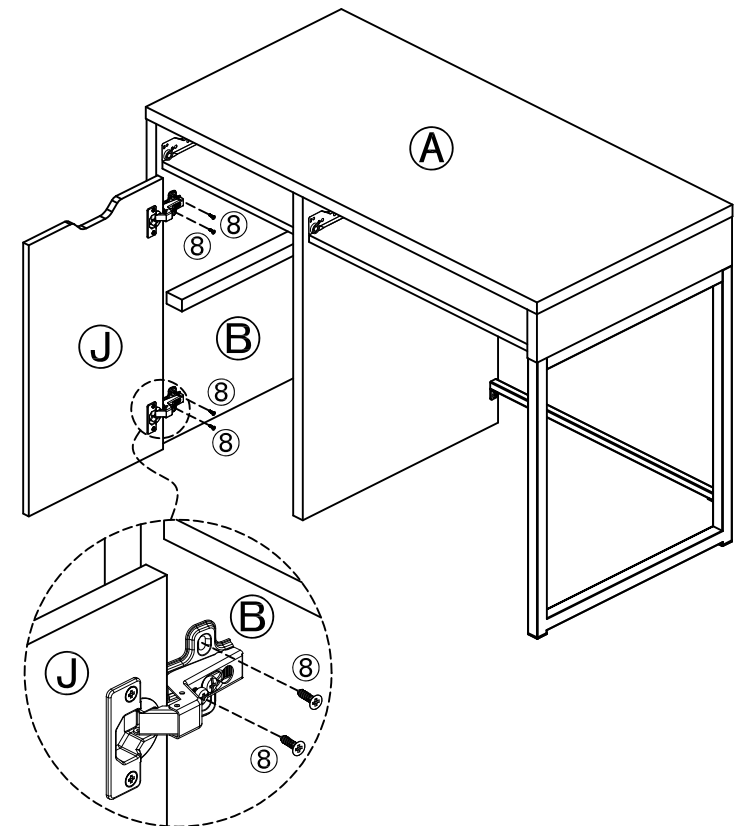
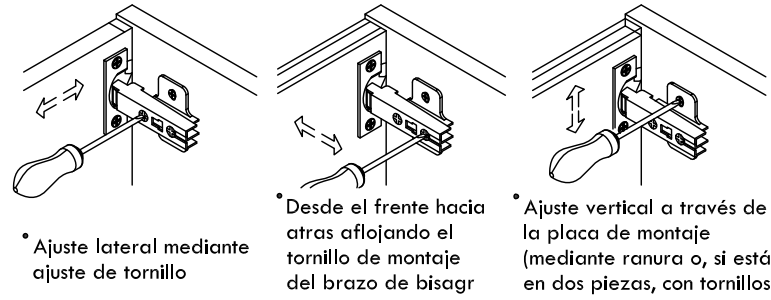

Tornillo 3

24

Poner el cajones dentro como se muestra.

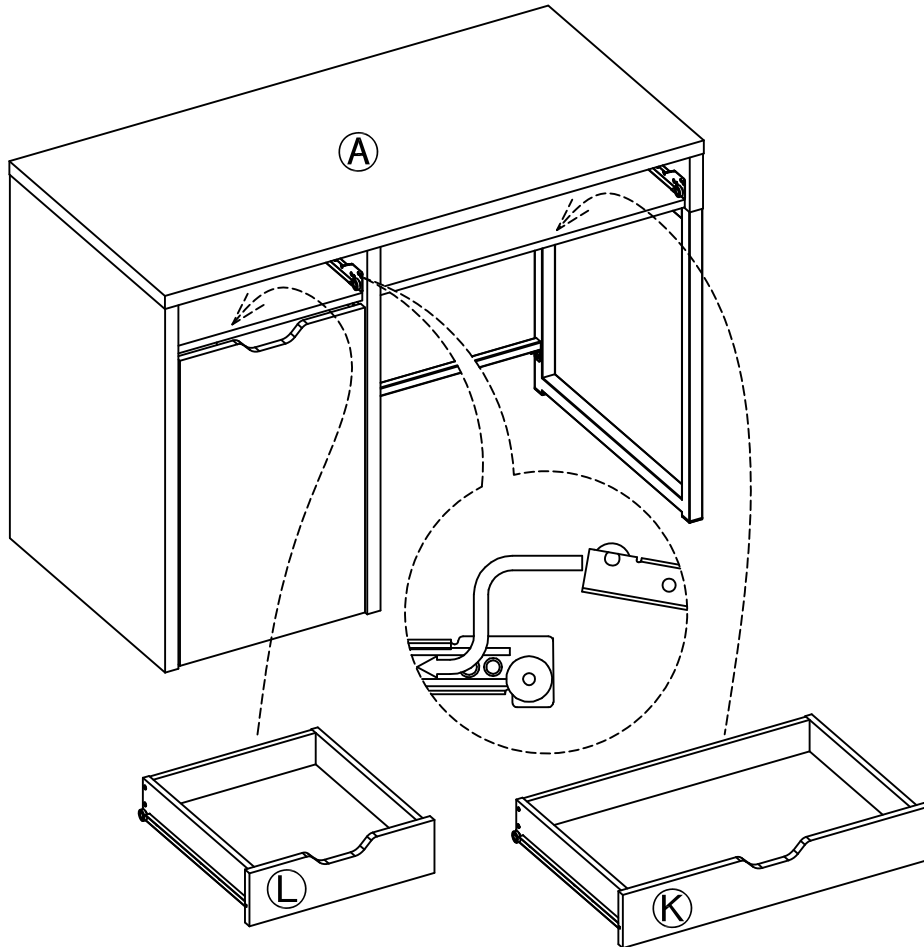

Ahora Su Unidad Está Compuesta

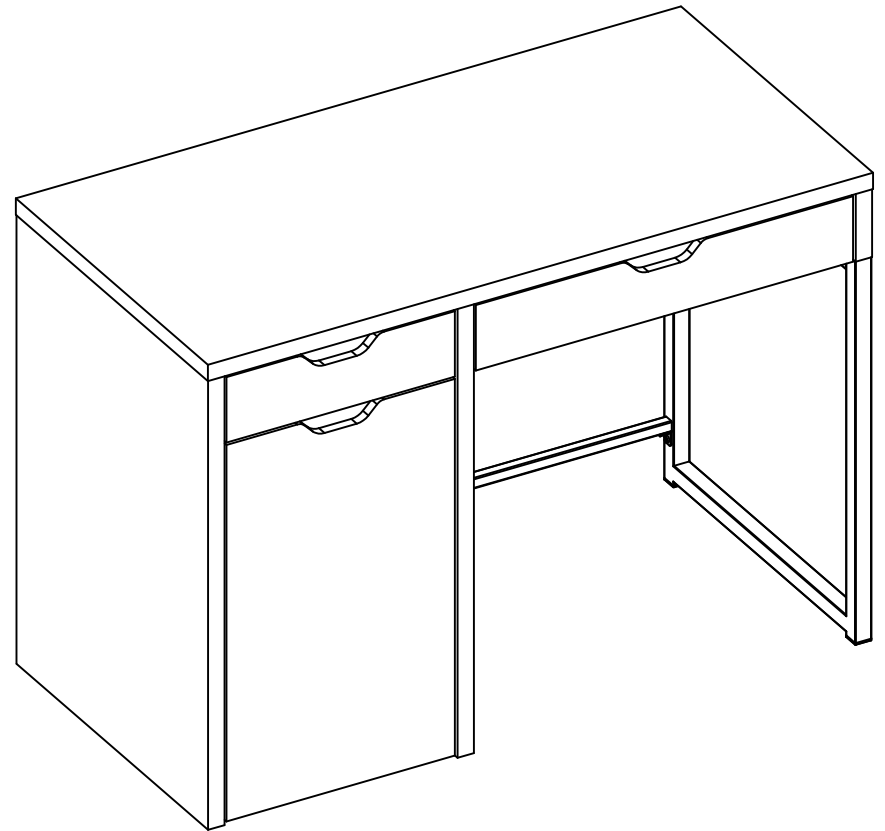

Por favor de llamarnos para piezas de reemplazo o ayudas:
1-800-729-1569 Lunes-Viernes 9:00am-5:00pm EST