

BETTER HOMES & GARDENS

6 CUBE WITH CUBBY ORGANIZER

VENDOR STOCK NUMBERS
BH5336278612104-WHITE TEXTURE
BH5336278612105-NATURAL PINE
BH5336278612106-WALNUT

THIS PRODUCT MUST ALWAYS BE MOUNTED TO A WALL OR STUD FOR USE.

TOP PANEL
MAXIMUM LOAD
100 LB (45.5 KG)

EACH CUBE
MAXIMUM LOAD
30 LB (13.6 KG)

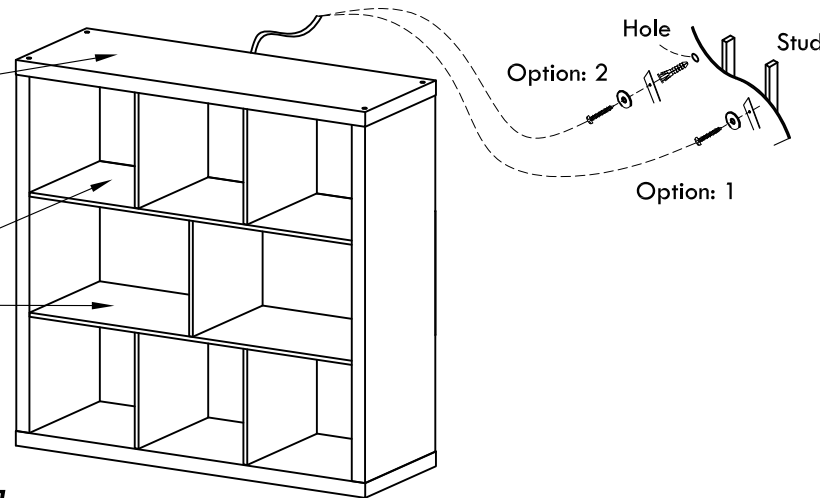

RECOMMENDED NUMBER OF PEOPLE FOR ASSEMBLY : 1
ESTIMATED ASSEMBLY TIME: 1 HOUR

- CALL OUR TOLL FREE NUMBER **1-800-729-1569** FOR FURTHER ASSISTANCE.
- ADDITIONAL PARTS ARE AVAILABLE FOR A FEE.
- THIS INSTRUCTION BOOKLET CONTAINS **IMPORTANT** SAFETY INFORMATION. PLEASE READ AND KEEP FOR FUTURE REFERENCE.
- DO NOT ALLOW CHILDREN TO CLIMB OR PLAY ON THE UNIT.
- CLEAN THE PRODUCT WITH YOUR FAVORITE FURNITURE POLISH AND A SOFT CLOTH.
- DO NOT USE HARSH CHEMICALS OR ABRASIVE CLEANERS.
- MOVE YOUR NEW FURNITURE CAREFULLY WITH TWO PEOPLE. NEVER PUSH OR DRAG THE UNIT.

DO NOT RETURN THE PRODUCT TO THE STORE.
INDIVIDUAL STORES DO NOT STOCK PARTS.
FOR MISSING OR DAMAGED PARTS CALL
1-800-729-1569.
PARTS WILL BE SHIPPED FREE OF CHARGE.

FOR PROMPT, RELIABLE SERVICE, PLEASE HAVE
YOUR ASSEMBLY MANUAL READY.

LOT NUMBER _____
DATE OF PURCHASE ___/___/___

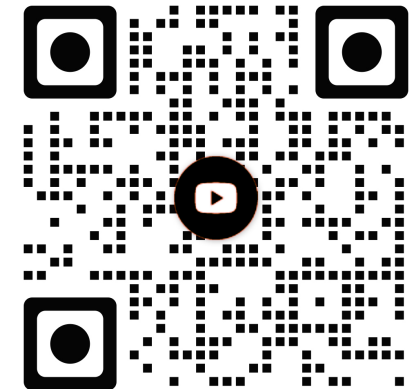

Scan the QR code above for a
video assembly guide.

Megaprima Home Pte Ltd.
Designed in the USA
Made in Malaysia



We are available to assist you Monday -Friday
from 9:00 am - 5:00 pm Eastern Standard Time.
1-800-729-1569
USA only.

BETTER HOMES & GARDENS

6 CUBE WITH CUBBY ORGANIZER

VENDOR STOCK NUMBERS
 BH5336278612104-WHITE TEXTURE
 BH5336278612105-NATURAL PINE
 BH5336278612106-WALNUT



BEFORE STARTING

- Read and understand all the steps carefully before starting. If each step is not followed in the correct order the assembly will be difficult and may result in damages.
- Work in a spacious area, preferably on a carpeted surface, near where the unit will be used.
- Make sure all the parts are included. Most boards are labeled with a removable sticker.

Helpful hints

- Call our toll free number if you need assistance. We are available to assist you Monday - Friday from 9:00 am - 5:00 pm Eastern Standard Time.
- **1-800-729-1569** USA only. Or submit a request through our self-service portal at www.huisenfurniture.zendesk.com

TOOLS NEEDED TO ASSEMBLE (NOT INCLUDED)

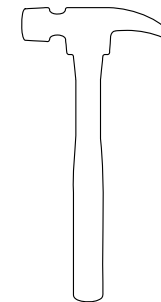
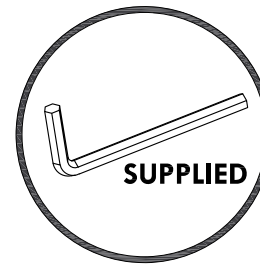

hammer



flat head
screwdriver



Phillips head
screwdriver



DO NOT USE POWER TOOLS TO ASSEMBLE YOUR FURNITURE. POWER TOOLS MAY RESULT IN DAMAGE.

Megaprima Home Pte Ltd.
 Designed in the USA
 Made in Malaysia



We are available to assist you Monday -Friday from 9:00 am - 5:00 pm Eastern Standard Time.
1-800-729-1569
 USA only.

BETTER HOMES & GARDENS

6 CUBE WITH CUBBY ORGANIZER

VENDOR STOCK NUMBERS
BH5336278612104-WHITE TEXTURE
BH5336278612105-NATURAL PINE
BH5336278612106-WALNUT

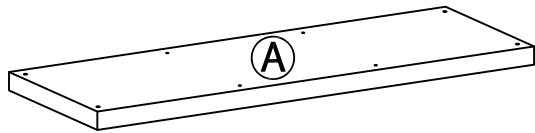

Top Panel
(Qty: 1)

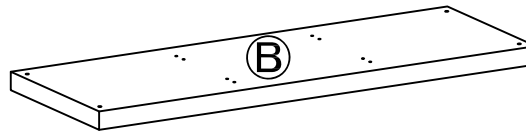

Bottom Panel
(Qty: 1)

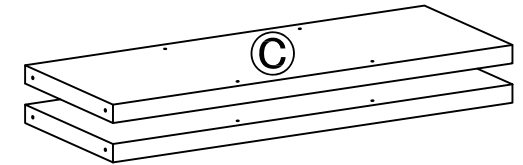

Side Panel
(Qty: 2)

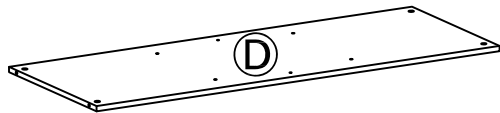

Fixed Shelf 1
(Qty: 1)

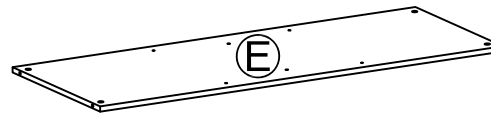

Fixed Shelf 2
(Qty: 1)

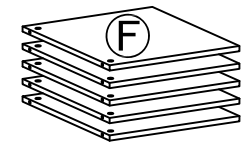

Partition Board
(Qty: 5)

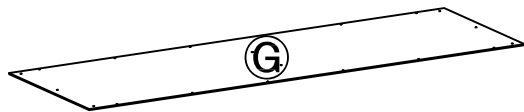

Back Panel
(Qty: 1)

VERIFY THAT ALL PARTS ARE PRESENT BEFORE BEGINNING



We are available to assist you Monday -Friday
from 9:00 am - 5:00 pm Eastern Standard Time.
1-800-729-1569
USA only.

BETTER HOMES & GARDENS

6 CUBE WITH CUBBY ORGANIZER

VENDOR STOCK NUMBERS
 BH5336278612104-WHITE TEXTURE
 BH5336278612105-NATURAL PINE
 BH5336278612106-WALNUT



①

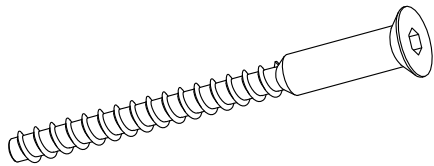

Screw Bolt
Qty: 8

②

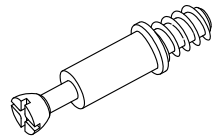

Cam Bolt
Qty: 18

③



Cam Lock
Qty: 18

④

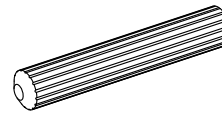

Dowel
Qty: 10

⑤

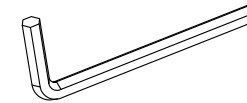

Allen Key
Qty: 1

⑥

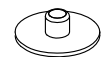

Cap
Qty: 18+1 Extra

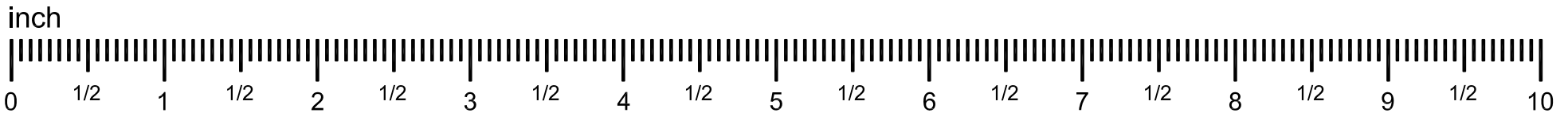

⑦

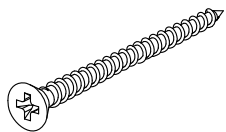

Screw #1
Qty: 6

⑧

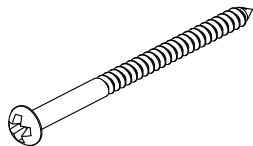

Screw #2
Qty: 4

⑨

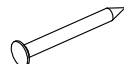

Nail
Qty: 20+1 Extra

⑩

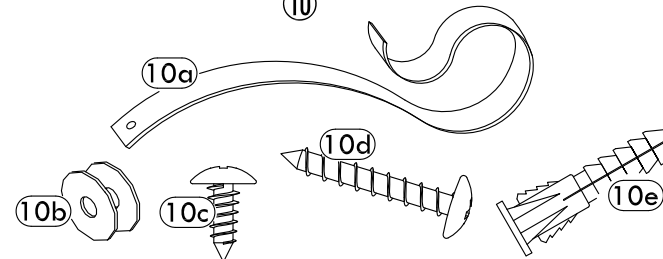

Safety Strap Kit
Qty: 1

⑪

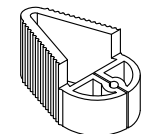

Nail Holder
Qty: 1

VERIFY THAT ALL PARTS ARE PRESENT BEFORE BEGINNING



We are available to assist you Monday -Friday
 from 9:00 am - 5:00 pm Eastern Standard Time.
1-800-729-1569
 USA only.

BETTER HOMES & GARDENS

6 CUBE WITH CUBBY ORGANIZER

VENDOR STOCK NUMBERS
BH5336278612104-WHITE TEXTURE
BH5336278612105-NATURAL PINE
BH5336278612106-WALNUT

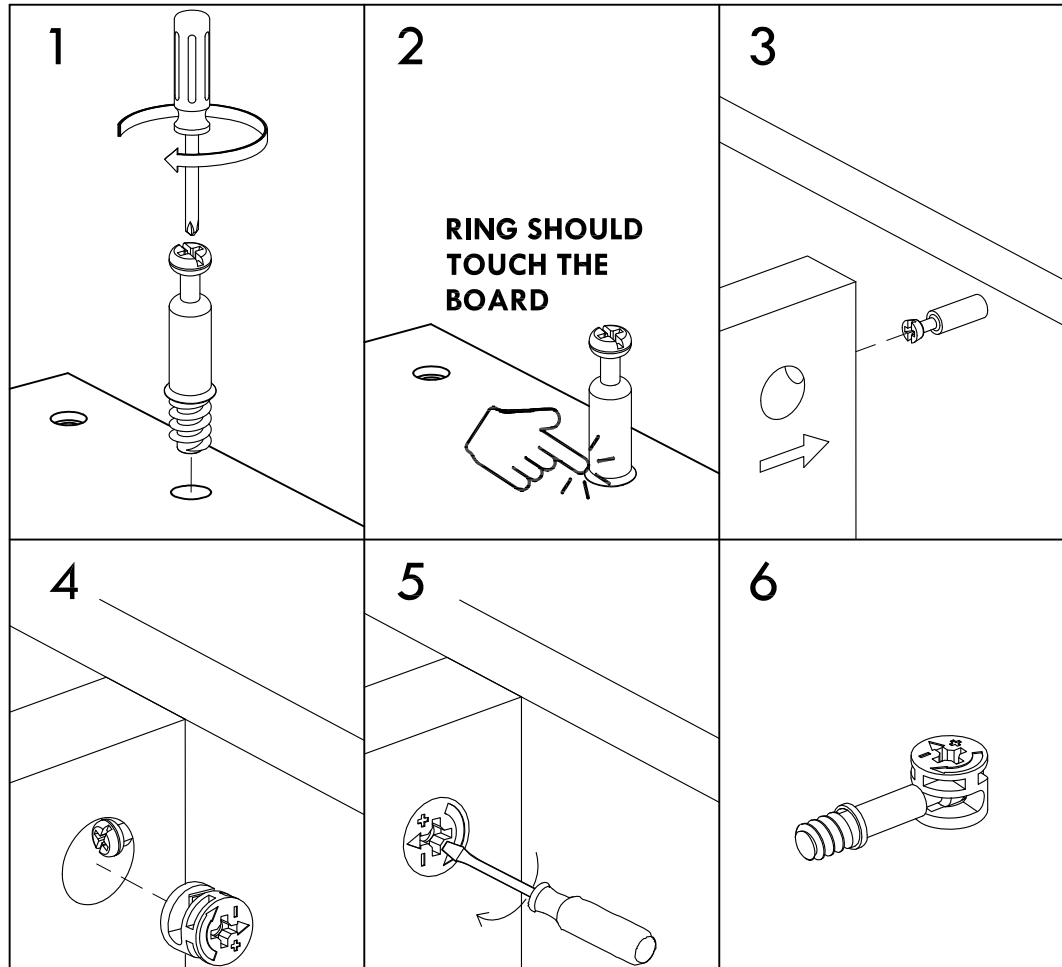

CAM FASTENING SYSTEM

1. Screw the **cam bolt** into the predrilled panel. The screw should be tightened so no threads are visible.
2. The larger ring of the cam should touch the panel.
3. Connect the previously tightened cam bolt to the panel.
4. Insert the **cam lock** into the predrilled hole in the panel. The plus and minus signs should be facing the predrilled hole in the edge of panel.
5. Using a flat head screw driver, turn the **cam lock** halfway clockwise to secure the **cam bolt**.
6. **FAILURE TO PROPERLY SECURE THE CAM LOCK AND CAM BOLT COULD RESULT IN PRODUCT INSTABILITY AND FAILURE.**

Megaprima Home Pte Ltd.
Designed in the USA
Made in Malaysia



We are available to assist you Monday -Friday
from 9:00 am - 5:00 pm Eastern Standard Time.
1-800-729-1569
USA only.

1

Screw Cam Bolts ② into (A) & (C) Panels.

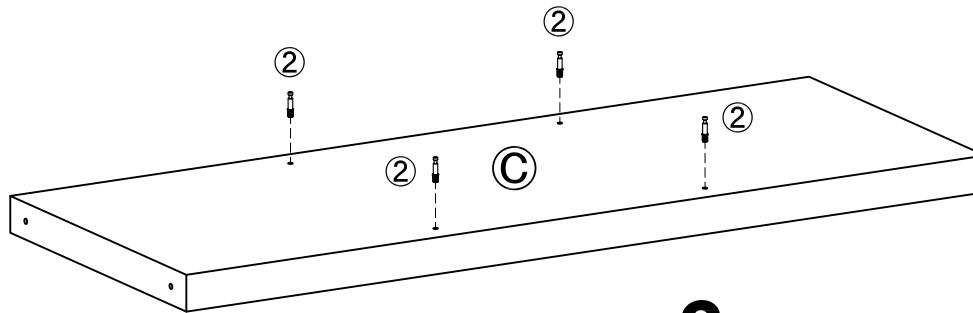
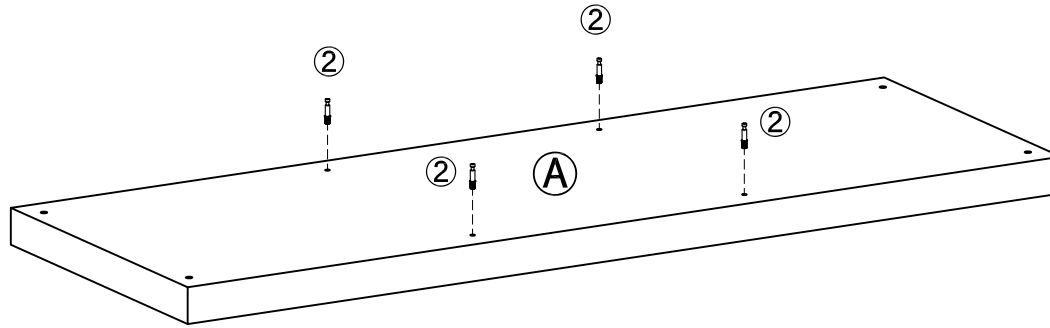

x 2

ADDITIONAL NOTES

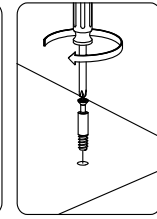
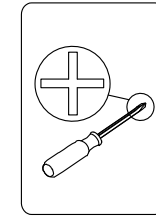

PARTS

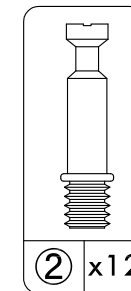

inch

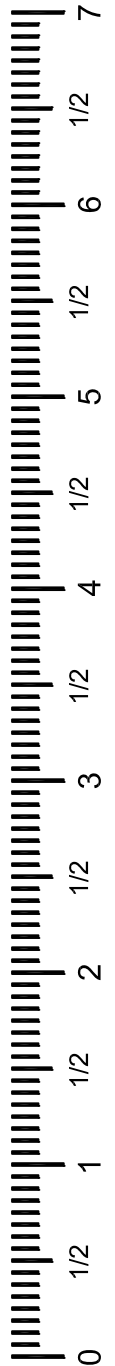

2

Screw Cam Bolts ② into (D) & (E) Panels.

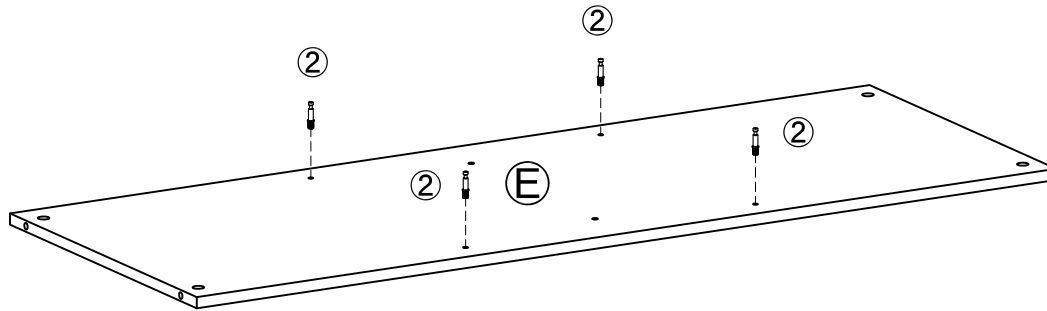
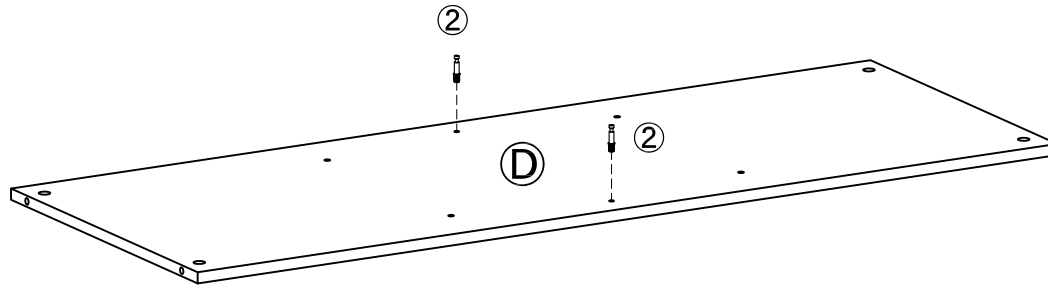

ADDITIONAL NOTES

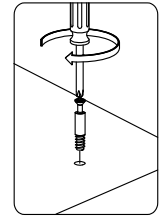
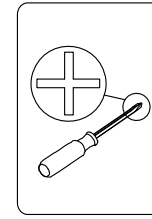

PARTS

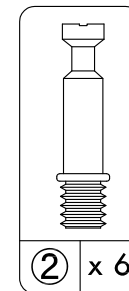

② x 6

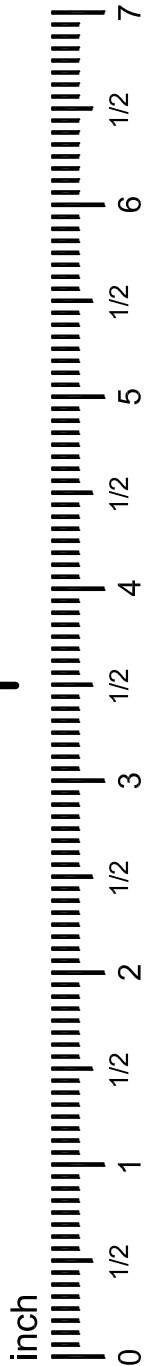

3

Insert two Dowels ④ into each (F) Panel.
Push dowels into predrilled holes leaving 3/8" exposed.

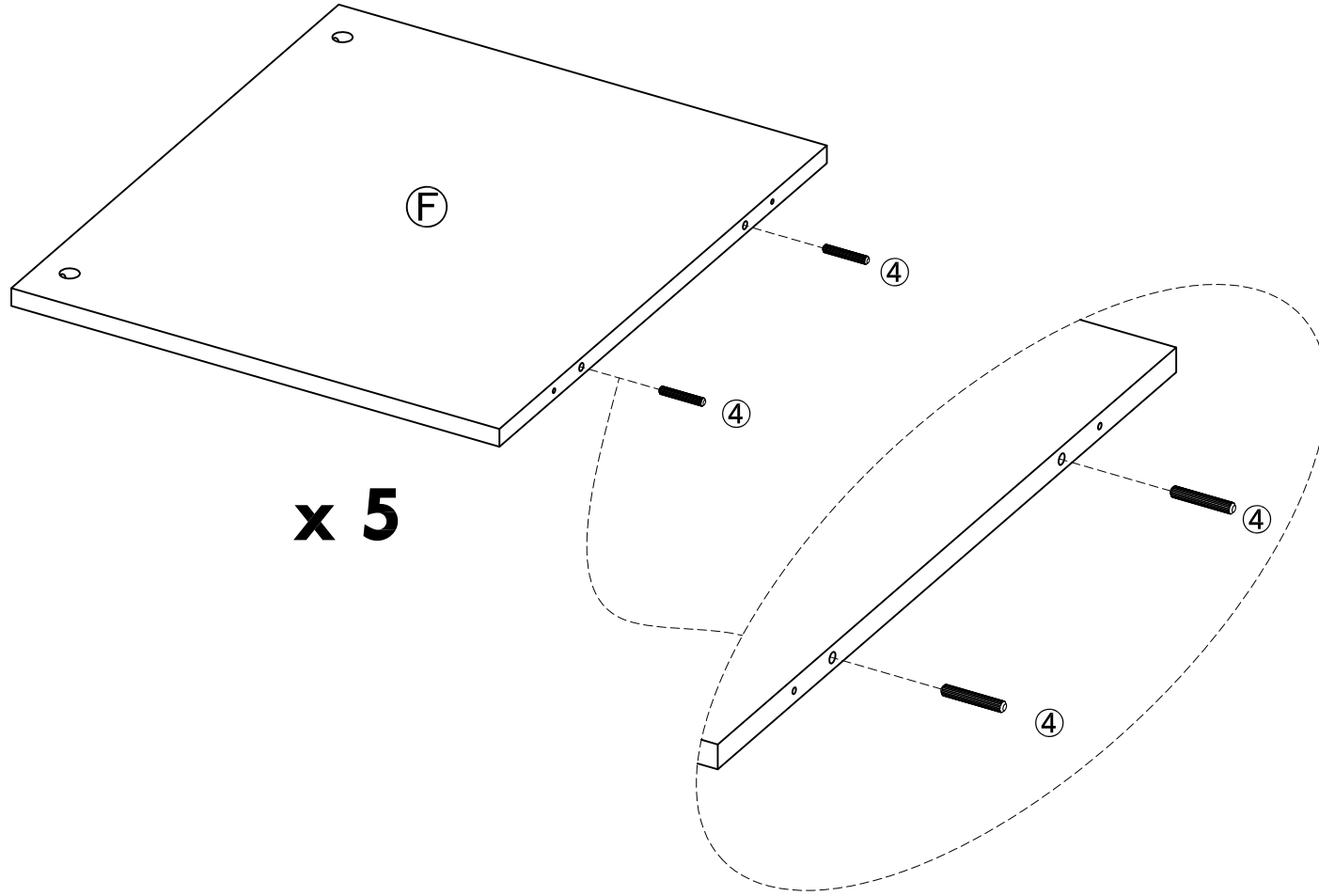

x 5

ADDITIONAL NOTES

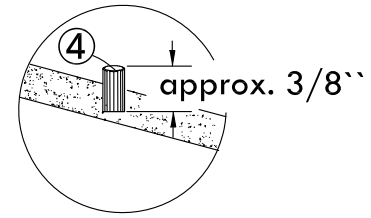

PARTS

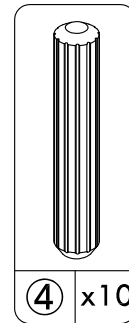

④ x10

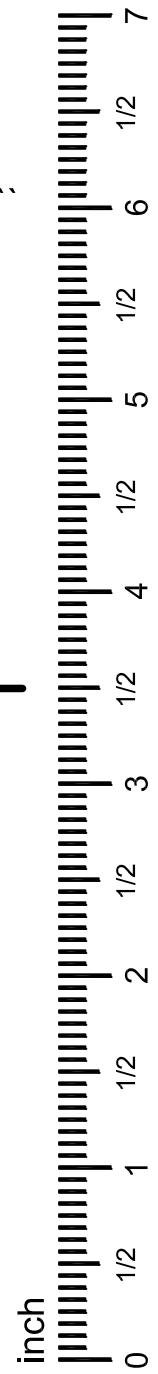

4

Use Screw #1 ⑦ to attach two (F) Panels to (D) Panel, and one (F) Panel to (E) Panel.

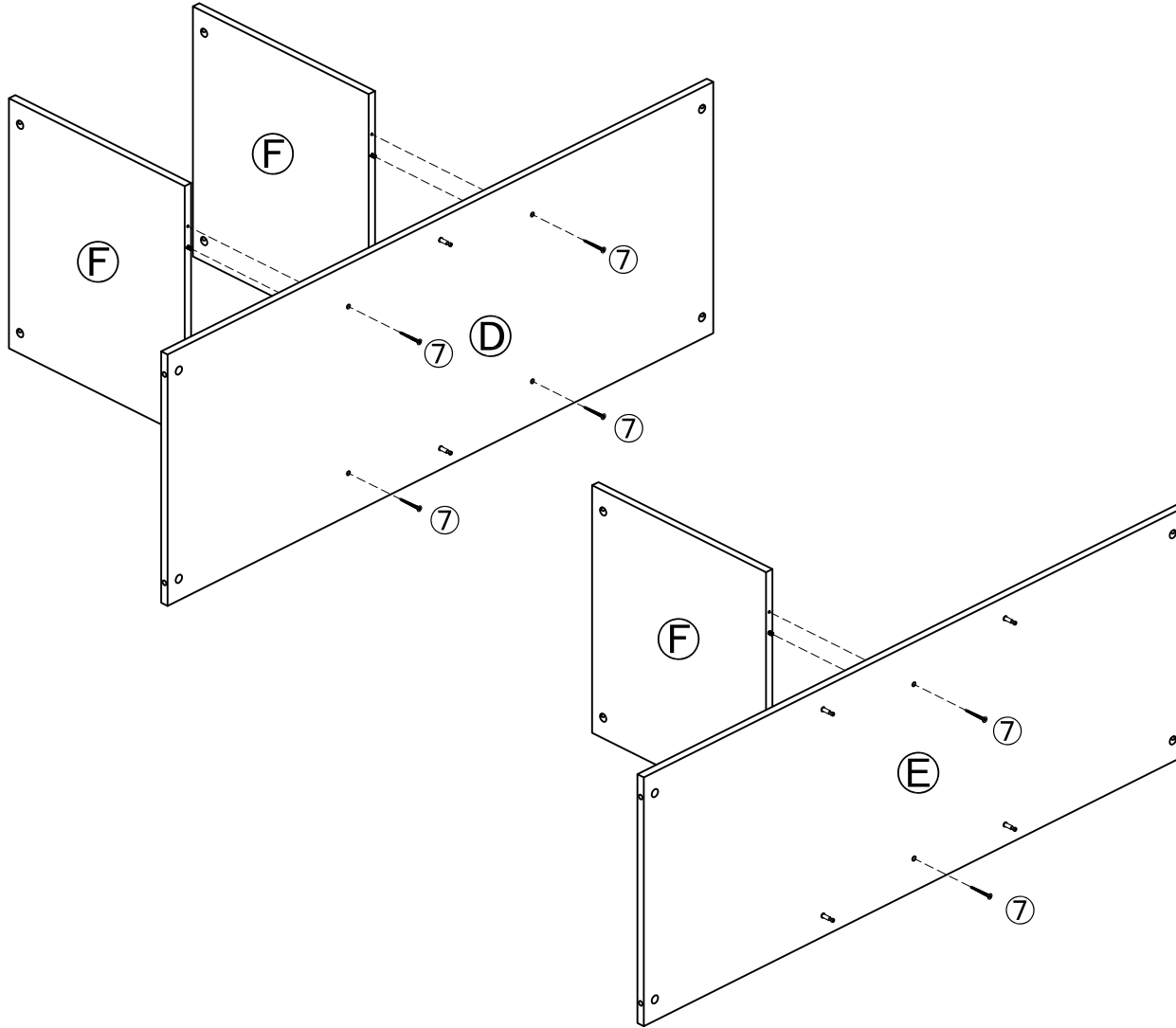

ADDITIONAL NOTES

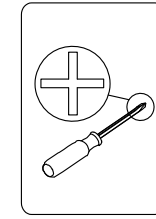

PARTS

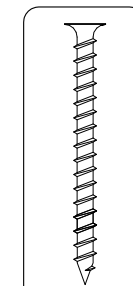

⑦ x 6

inch



5

Connect remaining two (F) Panels to (E) Panel.
Insert Cam Locks ③ into two (F) Panels.
Using a flat head screwdriver, turn each Cam Lock ③ 180° clockwise.

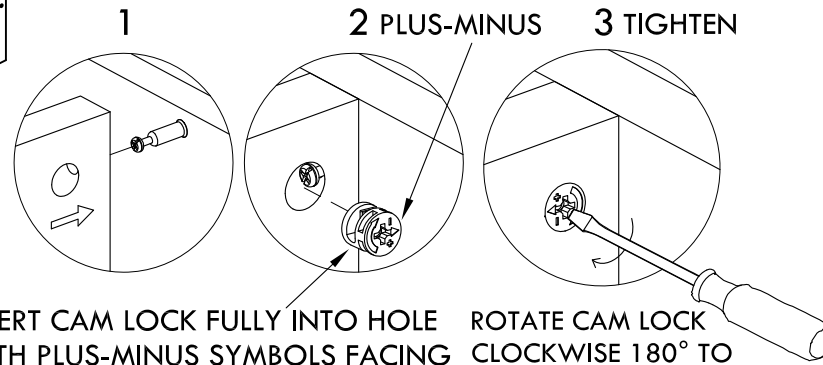
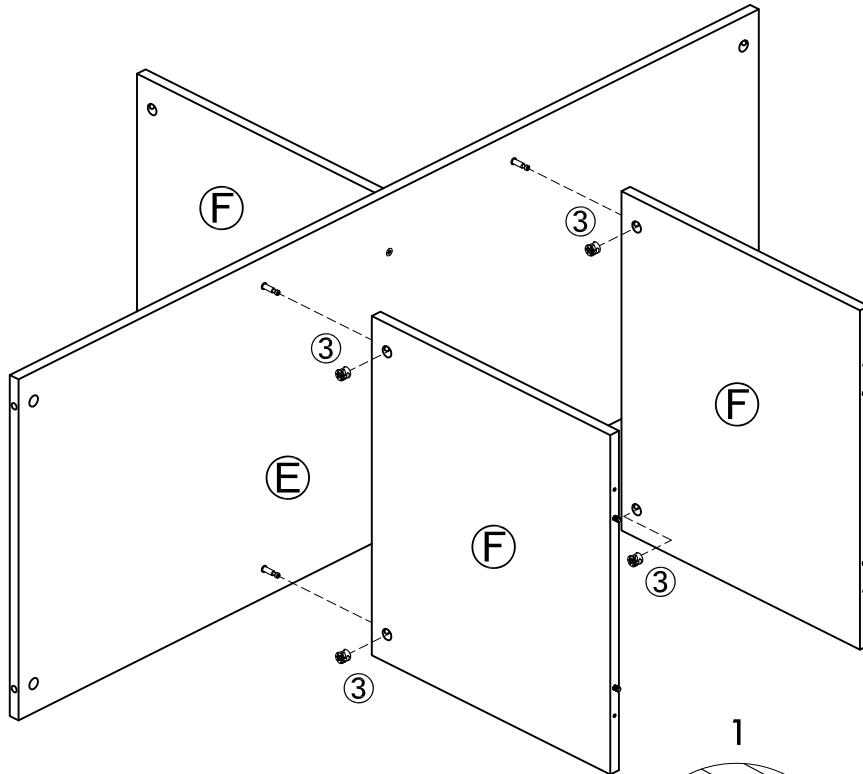

1
INSERT CAM LOCK FULLY INTO HOLE
WITH PLUS-MINUS SYMBOLS FACING
PREDRILLED HOLE IN EDGE OF PANEL

2 PLUS-MINUS 3 TIGHTEN

ROTATE CAM LOCK
CLOCKWISE 180° TO
SECURELY FASTEN

ADDITIONAL NOTES

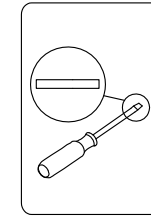

PARTS

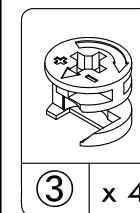

inch

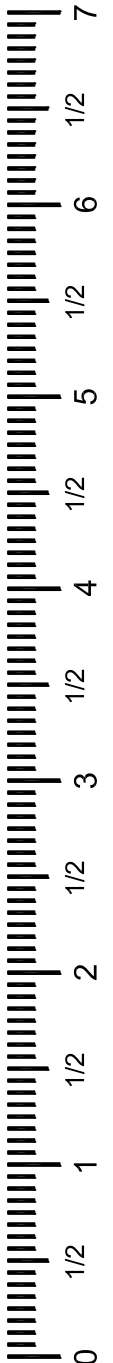

6

Connect (F) Panel to (D) Panel.
Insert Cam Locks ③ into (F) Panel.
Using a flat head screwdriver, turn each Cam Lock ③ 180° clockwise.

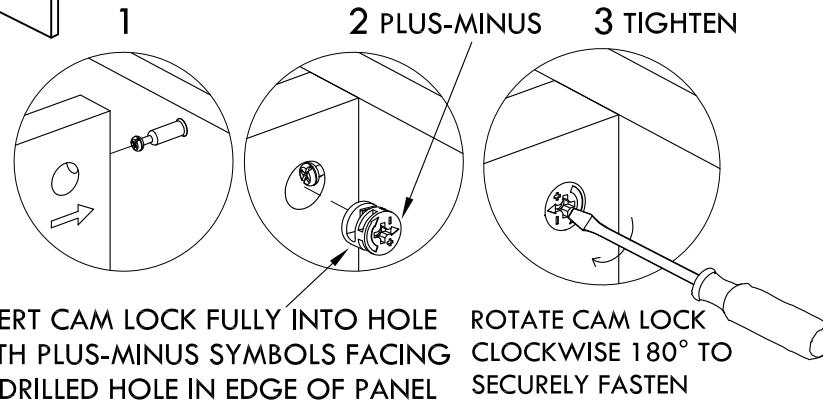
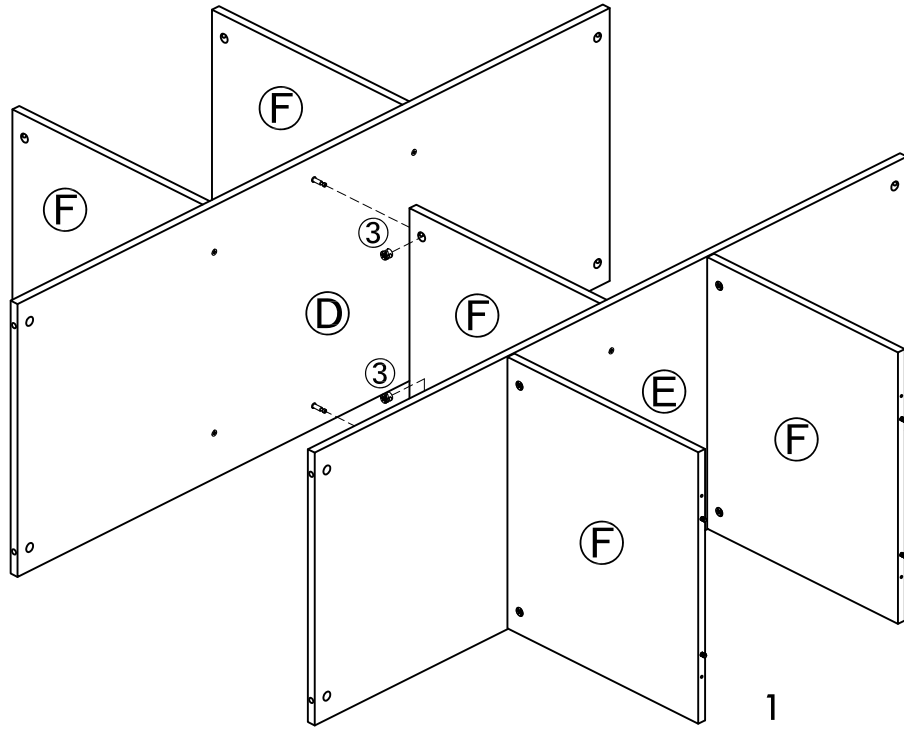

ADDITIONAL NOTES

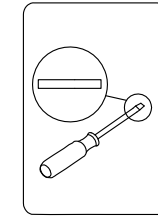

PARTS

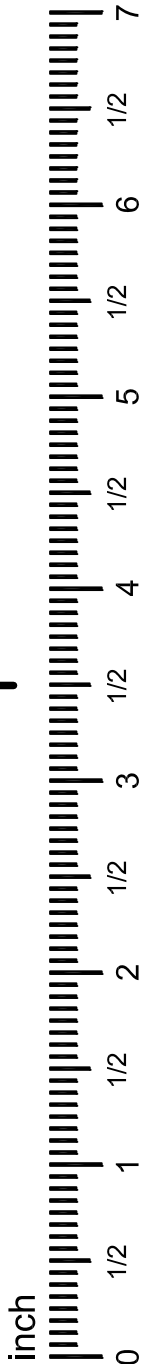
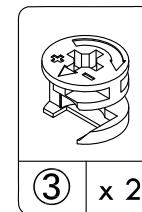

7

Connect Side Panel (C) to the structure.
 Make sure (C) Panel is connected to (D) & (E) panels, NOT (F) Panels.
 Insert Cam Locks ③ into (D) & (E) Panels.
 Using a flat head screwdriver, turn each Cam Lock ③ 180° clockwise.

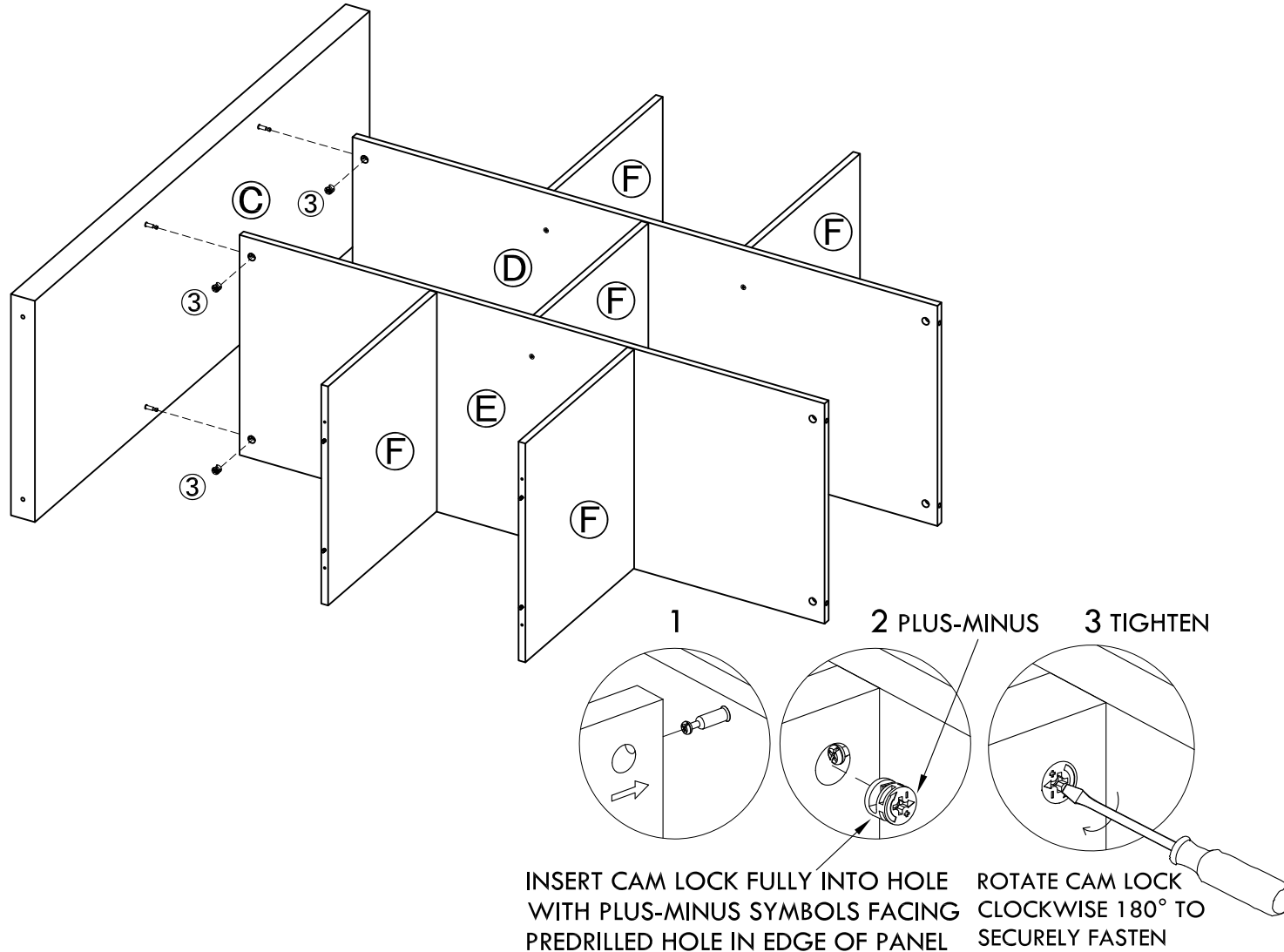

ADDITIONAL NOTES

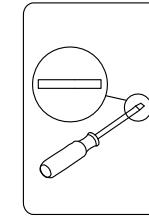

▲ WARNING
 Do not move product until A & B (top/bottom) panels are attached. Failure to follow this could result in product damage and failure.

PARTS

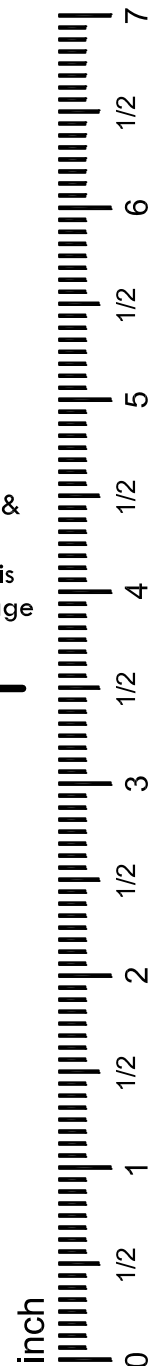
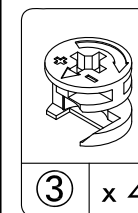

8

Connect Side Panel (C) to the structure.
 Make sure (C) Panel is connected to (D) & (E) panels, NOT (F) Panels.
 Insert Cam Locks ③ into (D) & (E) Panels.
 Using a flat head screwdriver, turn each Cam Lock ③ 180° clockwise.

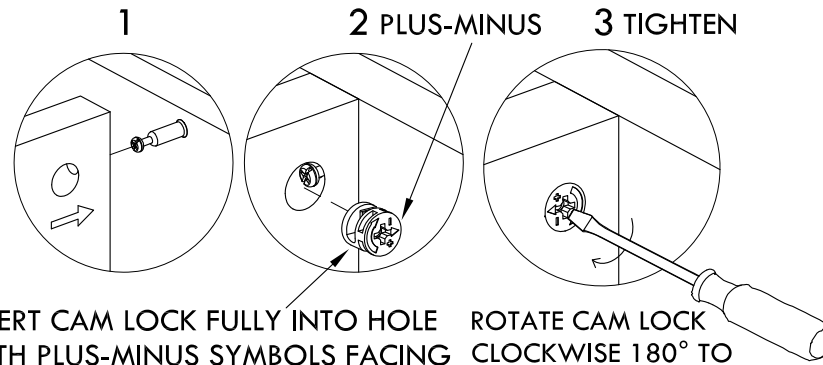
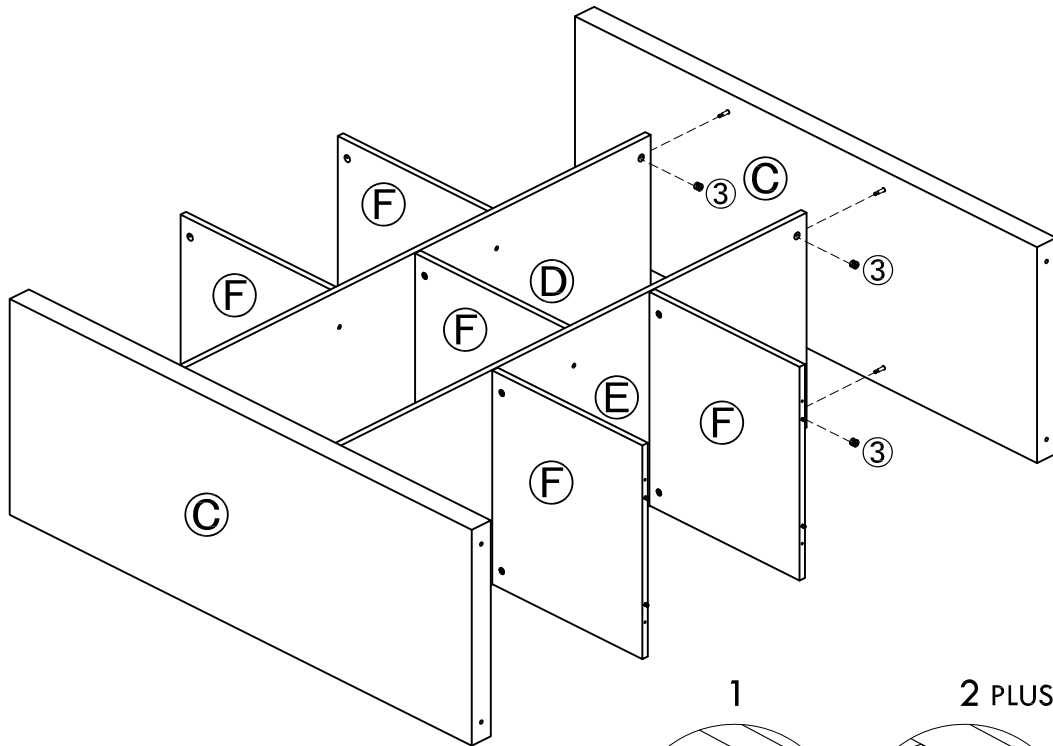

1 INSERT CAM LOCK FULLY INTO HOLE WITH PLUS-MINUS SYMBOLS FACING PREDRILLED HOLE IN EDGE OF PANEL

2 PLUS-MINUS 3 TIGHTEN

ROTATE CAM LOCK CLOCKWISE 180° TO SECURELY FASTEN

ADDITIONAL NOTES

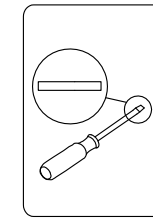

▲ WARNING
 Do not move product until A & B (top/bottom) panels are attached. Failure to follow this could result in product damage and failure.

PARTS

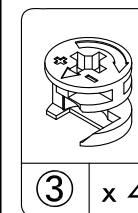

③ x 4

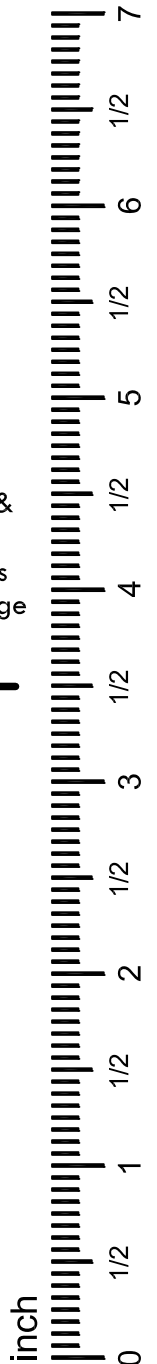

9

Connect Bottom Panel (B) to structure.
 Make sure (B) Panel is connected to the end closest to (E) Panel, NOT (D) Panel.
 Attach (B) Panel using Screw Bolts ① in corners and Screw #2 ⑧ in the center.

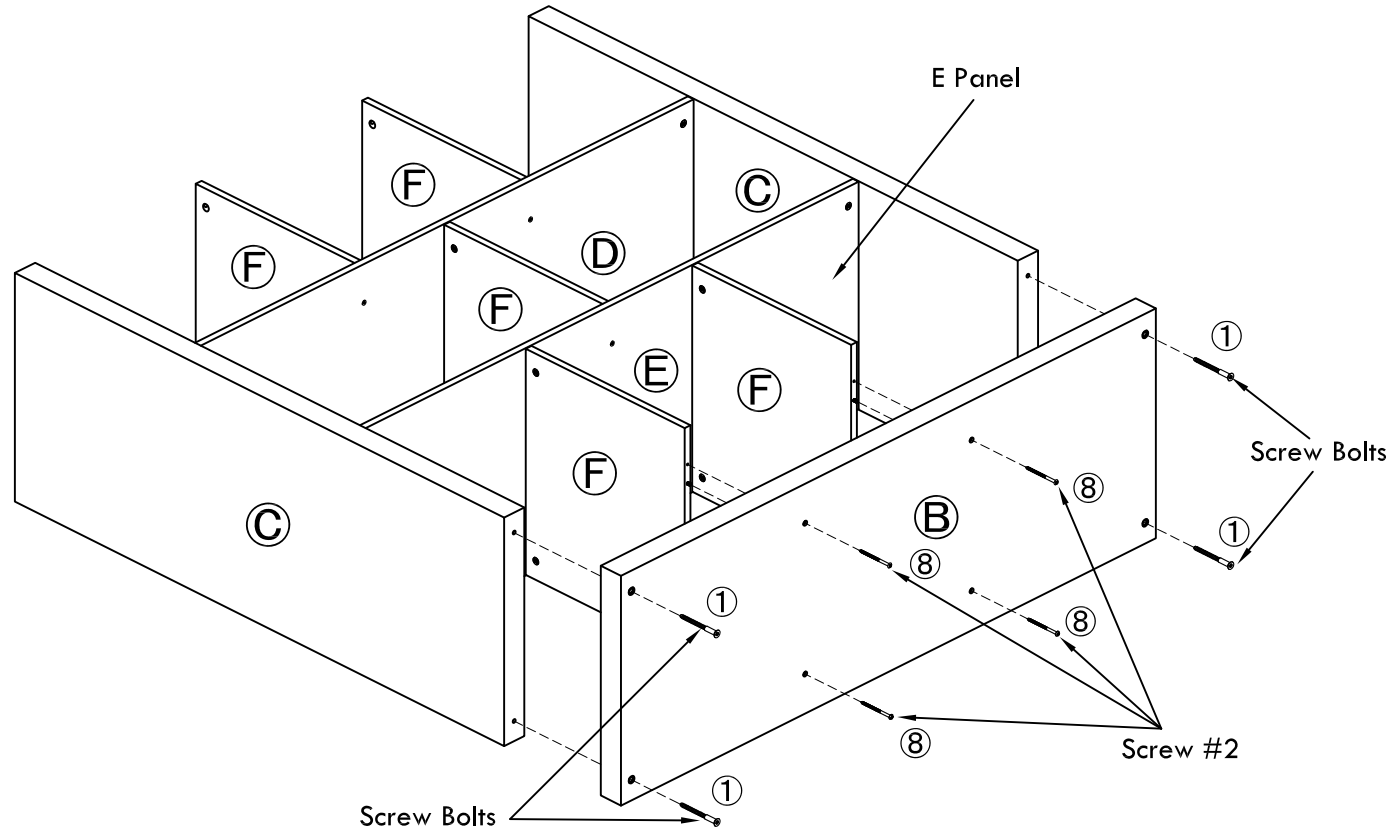

ADDITIONAL NOTES

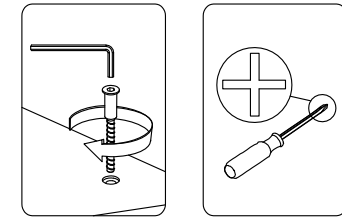

PARTS

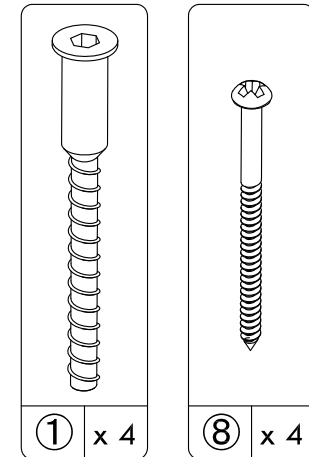

inch

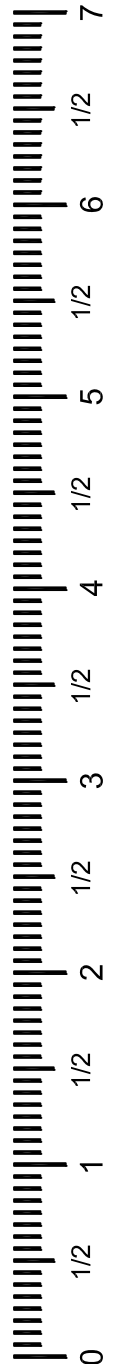

10

Connect Top Panel (A) to structure and attach using Screw Bolts ① & Allen Key ⑤.

Insert Cam Locks ③ into (F) Panels.

Using a flat head screwdriver, turn each Cam Lock ③ 180° clockwise.

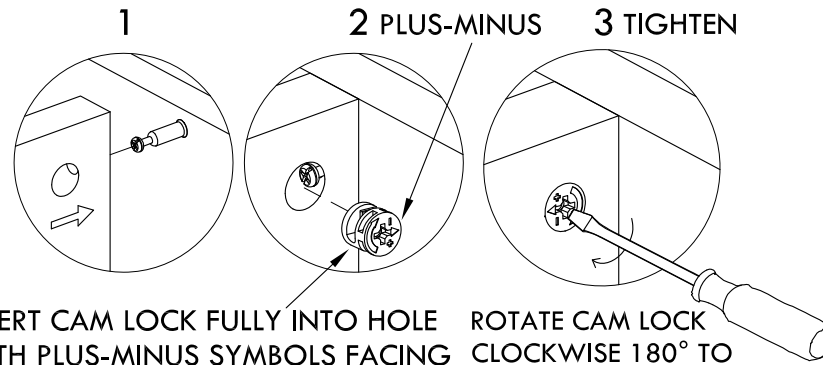
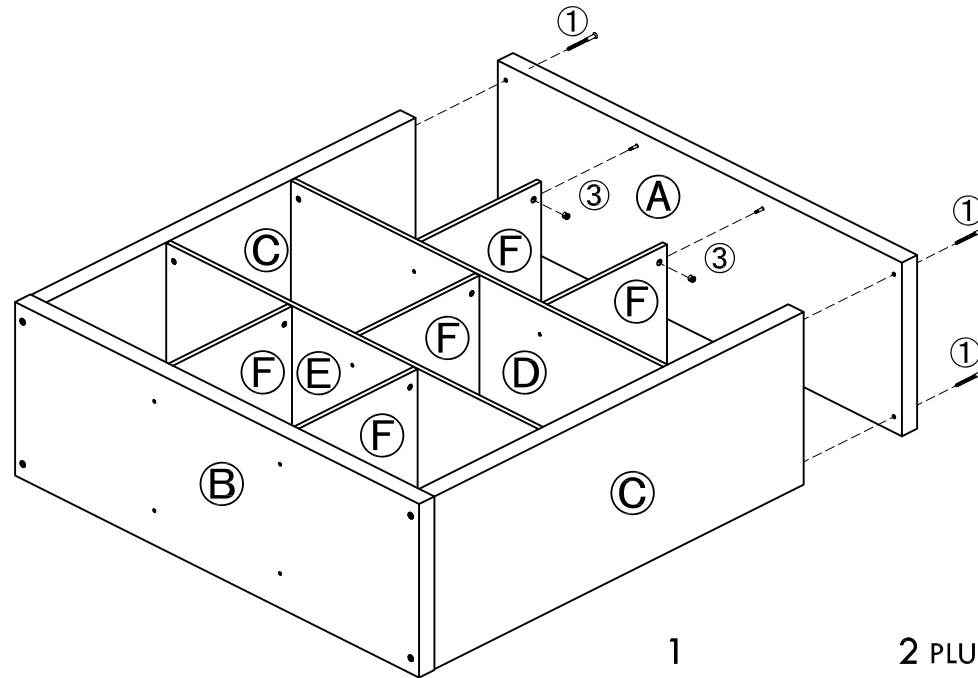

1 INSERT CAM LOCK FULLY INTO HOLE WITH PLUS-MINUS SYMBOLS FACING PREDRILLED HOLE IN EDGE OF PANEL

2 PLUS-MINUS 3 TIGHTEN

ROTATE CAM LOCK CLOCKWISE 180° TO SECURELY FASTEN

ADDITIONAL NOTES

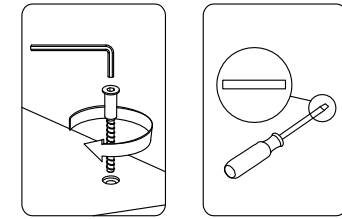

PARTS

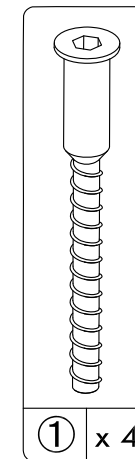

① x 4

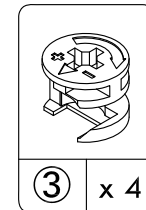

③ x 4

inch



11

Use Caps ⑥ to cover exposed screw heads in (A), (B) & (F) Panels.
Center wall strap ⑩a in the edge of Top Panel (A) and attach using ⑩b & ⑩c.

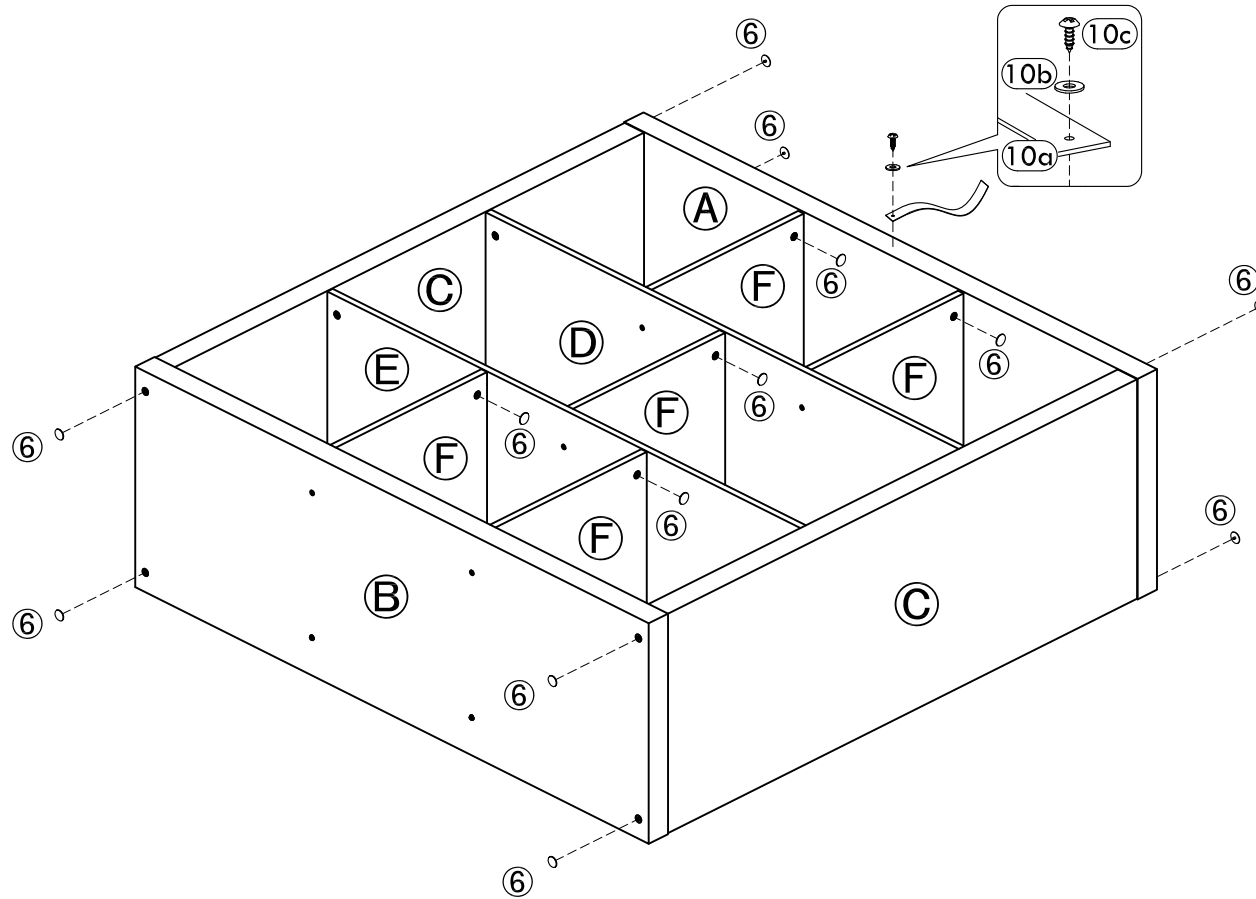

ADDITIONAL NOTES

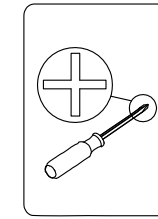

PARTS

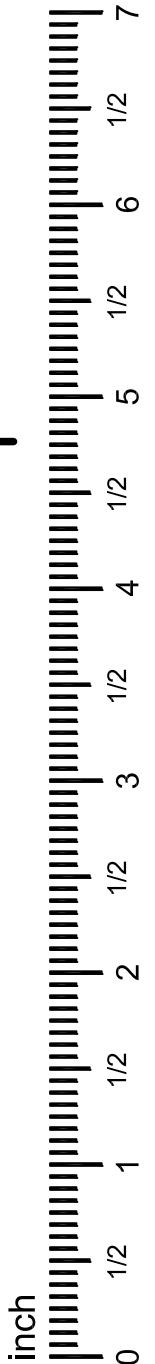
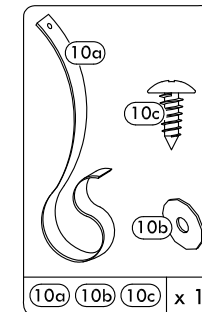
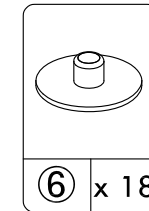

12

Align Back Panel (G) to unit and use Nails (9) to attach.
 Nail holder (11) can be used to help position nails when attaching along edges of (D) & (E) panels

Place a nail into the nail holder and slide the nail holder up to the side of the unit until flush. The nail will be positioned in the center of the particle board. Hammer the nail slightly into board, then slide nail holder back and hammer the nail in the rest of the way.

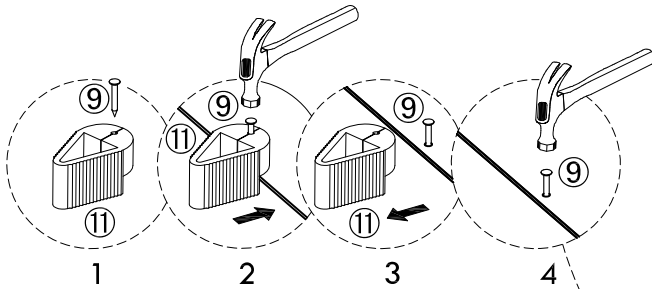

CAUTION: Back panels must be attached before moving or using unit. Failure to attach back panels will result in instability.

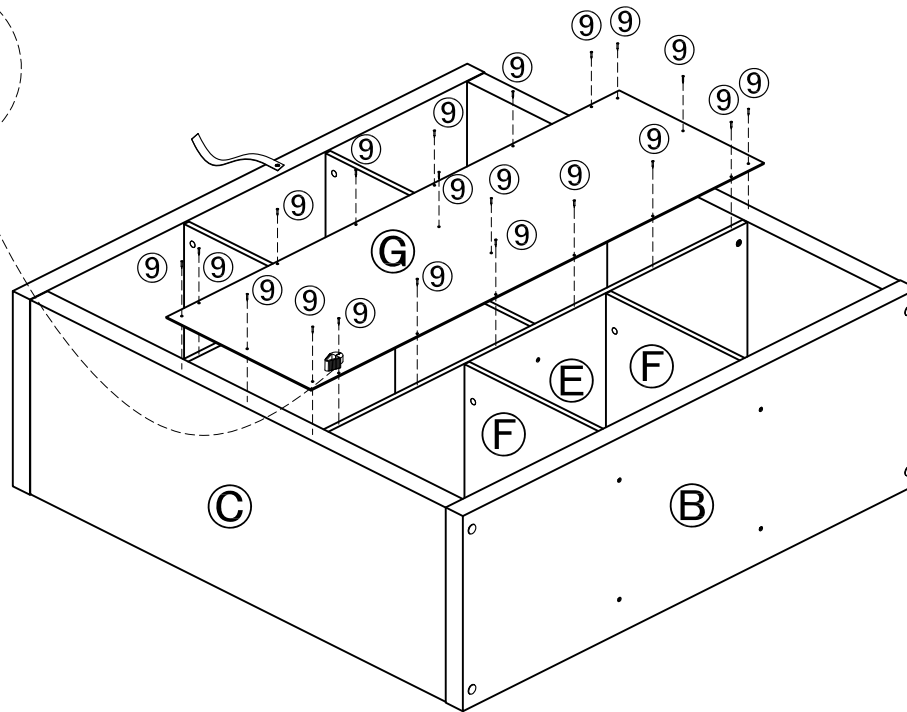

ADDITIONAL NOTES

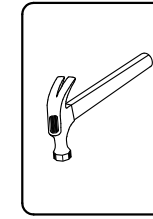

PARTS

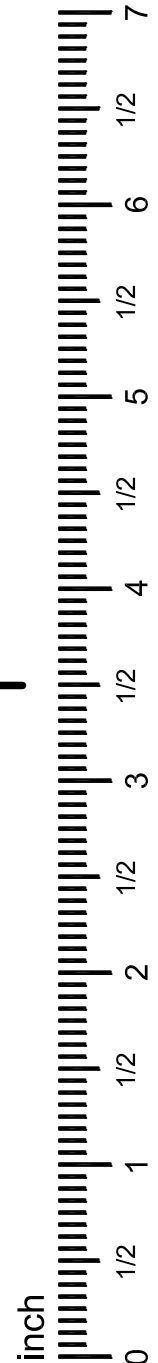
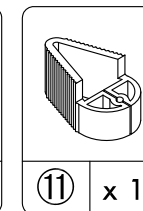
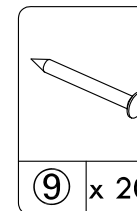

13

Fasten safety strap to wall using Option 1 or Option 2 as shown below.

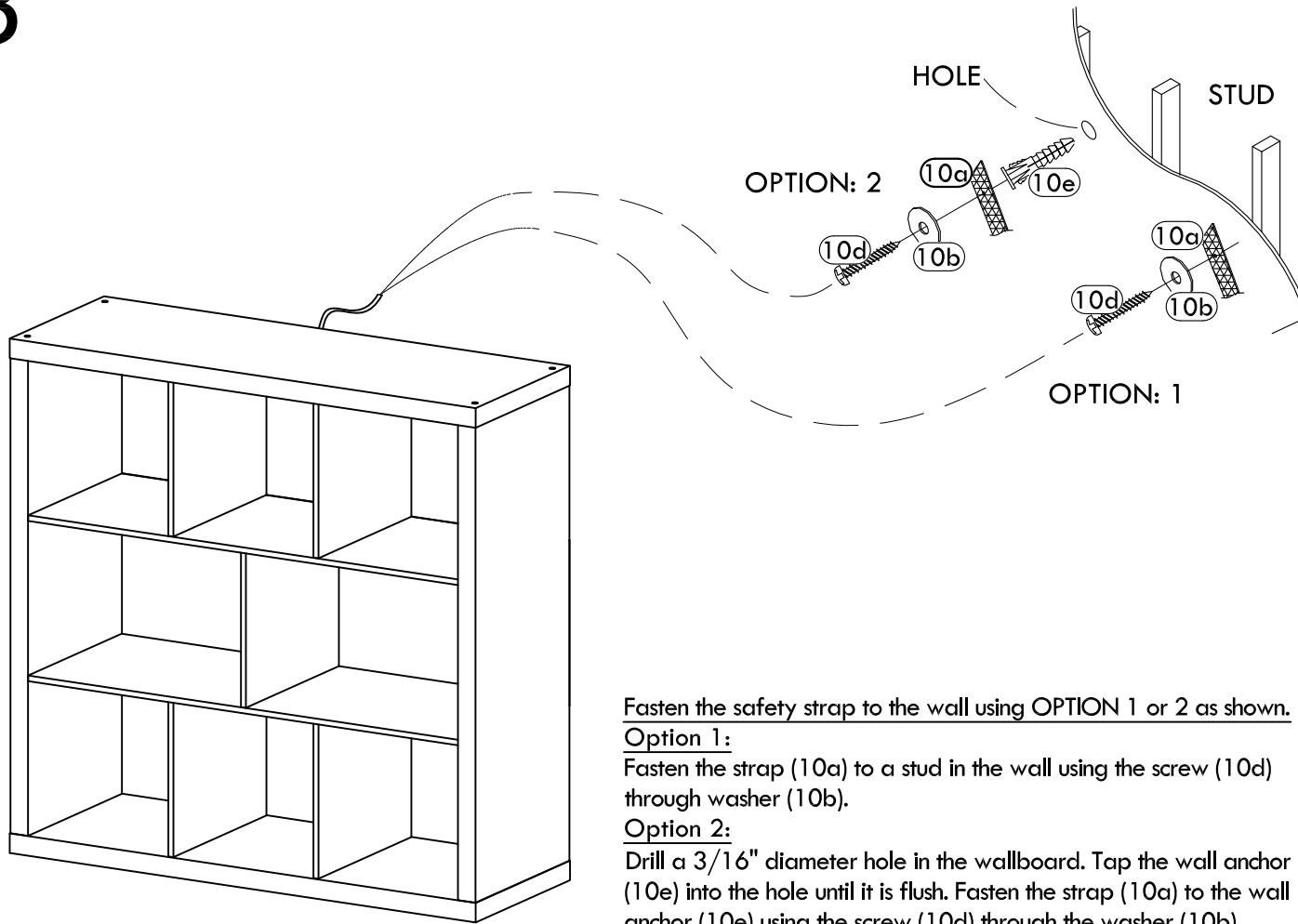

Fasten the safety strap to the wall using **OPTION 1** or **2** as shown.

Option 1:

Fasten the strap (10a) to a stud in the wall using the screw (10d) through washer (10b).

Option 2:

Drill a 3/16" diameter hole in the wallboard. Tap the wall anchor (10e) into the hole until it is flush. Fasten the strap (10a) to the wall anchor (10e) using the screw (10d) through the washer (10b).

ADDITIONAL NOTES

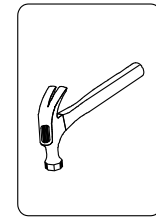
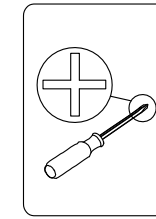

PARTS

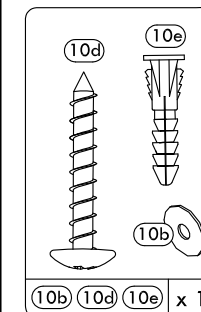

(10b) (10d) (10e) x 1

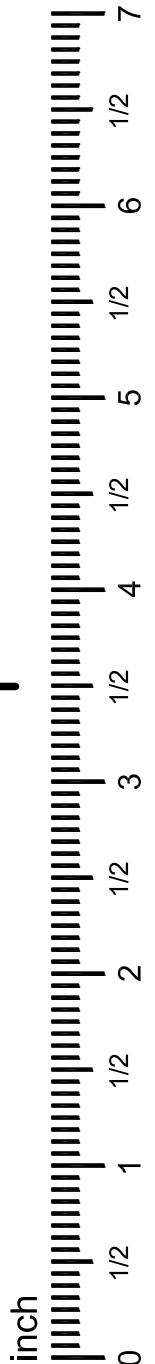

**CONGRATULATIONS, YOUR UNIT IS COMPLETE,
PLEASE ENJOY AND BE SURE TO TELL US ABOUT YOUR EXPERIENCE!**

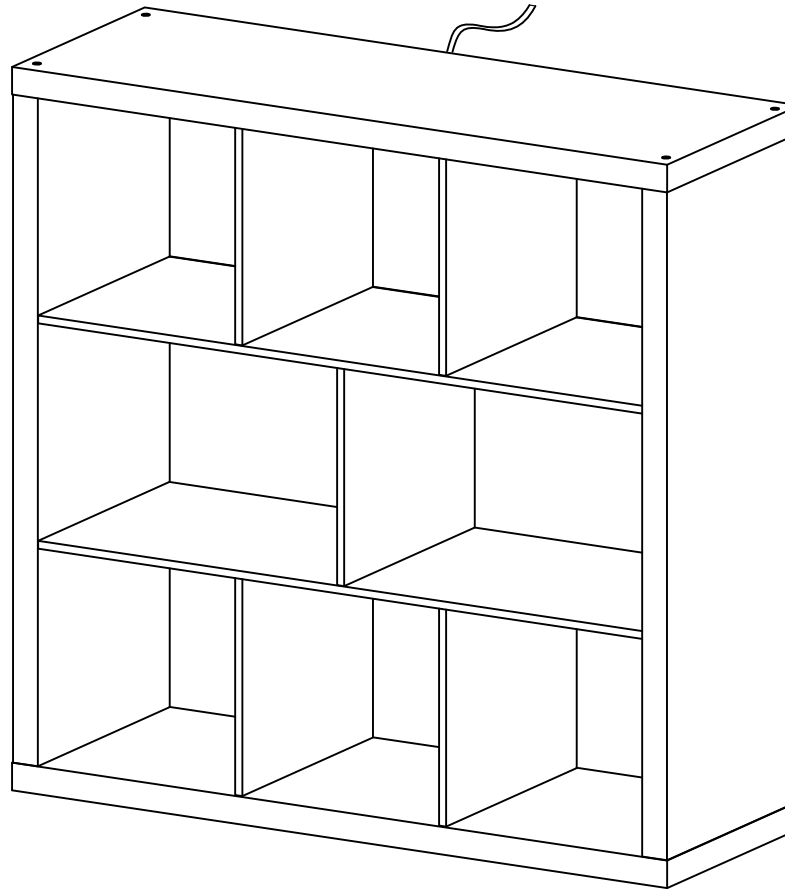

Quality Guarantee

Should this product be defective in workmanship or materials or fail under normal use, we will repair or replace it for up to (1) year from date of purchase.

This warranty gives you specific legal rights and you may also have other rights which vary from State to State.

**Please call for replacement parts or assistance: 1-800-729-1569
Monday - Friday 9:00 am - 5:00 pm EST**

BETTER HOMES & GARDENS

6 CUBOS Y 2 ESPACIOS CÚBICOS

ESTE PRODUCTO DEBE MONTARSE SIEMPRE EN UNA PARED O EN UN EXTREMO PARA SU USO.

PANEL SUPERIOR
CARGA MÁXIMA
100 LB (45.5 KG)

CADA CUBO
CARGA MÁXIMA
30 LB (13.6 KG)

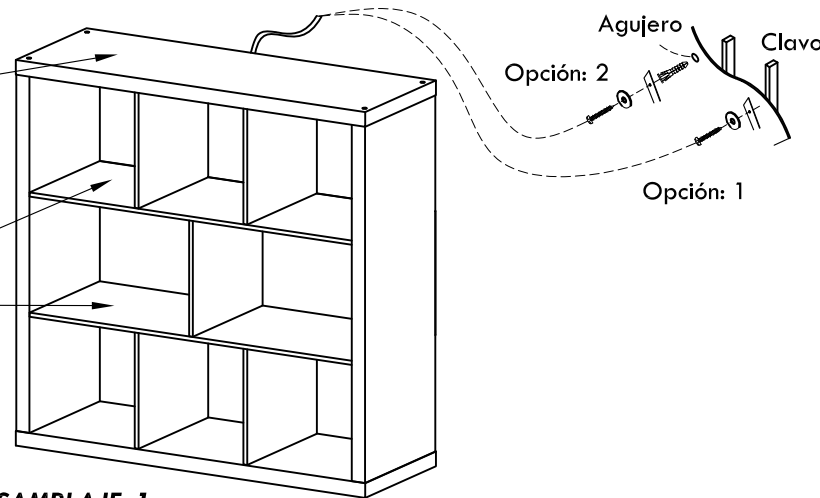

NÚMERO DE PERSONAS RECOMENDADO PARA EL ENSAMBLAJE: 1
TIEMPO ESTIMADO DE ENSAMBLAJE: 1 HORA

- LLAME A NUESTRO NÚMERO GRATUITO **1-800-729-1569** PARA OBTENER MÁS AYUDA.
- PIEZAS ADICIONALES ESTÁN DISPONIBLES POR UNA TARIFA.
- ESTE MANUAL DE INSTRUCCIÓN CONTIENE INFORMACIÓN **IMPORTANTE** DE SEGURIDAD. POR FAVOR DE LEER Y GUARDAR PARA FUTURAS REFERENCIAS.
- NO DEJAR A LOS NIÑOS SUBIR O JUGAR SOBRE LA UNIDAD.
- LIMPIAR EL PRODUCTO CON TU PULIDOR FAVORITE DE MUEBLE Y UN TRAPO BLANDO.
- NO USAR QUÍMICOS FUERTES O PRODUCTO DE LIMPIEZA ABRASIVO.
- MUEVA SUS NUEVOS MUEBLES CUIDADOSAMENTE CON DOS PERSONAS, NUNCA EMPUJE O ARRASTRE LA UNIDAD.

NÚMERO DE STOCK DEL VENDEDOR
BH5336278612104-TEXTURA BLANCO
BH5336278612105-PINO NATURAL
BH5336278612106-NUEZ

NO DEVOLVER EL PRODUCTO A LA TIENDA.
TIENDAS INDIVIDUALES NO RESERVAN PIEZAS.
PARA PIEZAS PERDIDAS O DAÑADAS LLAME AL
1-800-729-1569.
PARTES SERÁN ENVIADOS DE FORMA GRATUITA.
PARA UN SERVICIO RÁPIDO Y CONFIABLE, POR
FAVOR DE TENER A MANO EL MANUAL DE
ENSAMBLAJE.

NÚMERO DE PARTIDA _____
FECHA DE COMPRA ___/___/___

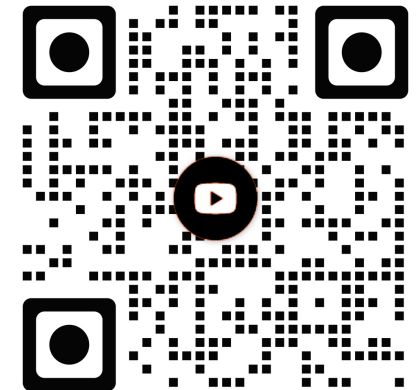

Escanee el código arriba para ver
la guía de vídeo de ensamblaje.

Megaprima Home Pte Ltd.
Diseñado en el E.E.U.U.
Hecho en Malaysia



Estamos disponibles para ayudarlo de Lunes - Viernes
de 9:00 am - 5:00 pm Hora de la Zona Este.
1-800-729-1569
Sólo E.E.U.U.

BETTER HOMES & GARDENS

6 CUBOS Y 2 ESPACIOS CÚBICOS

NÚMERO DE STOCK DEL VENDEDOR
BH5336278612104-TEXTURA BLANCO
BH5336278612105-PINO NATURAL
BH5336278612106-NUEZ



ANTES DE COMENZAR

- Leer y entender todos los pasos cuidadosamente antes de comenzar. si no se sigue cada paso en el orden correcto, el montaje será difícil y puede ocasionar daños.
- Trabajar en una zona amplia, mejor sobre la alfombra, cerca del sitio donde la unidad se utiliza.
- Asegurarse de que todas las piezas estén incluidos. La mayoría de los tableros están etiquetados con una pegatina removible.

Consejos útiles

- Llamar a nuestro número gratis para ayuda. Estamos disponibles para ayudarlo de lunes - Viernes de 9:00 am - 5:00 pm hora de la zona este.
- **1-800-729-1569** Sólo E.E.U.U.
O haga una solicitud a través de nuestro portal de autoservicio en www.huisenfurniture.zendesk.com

HERRAMIENTAS NECESARIAS PARA ENSAMBLAR (NO INCLUIDO)

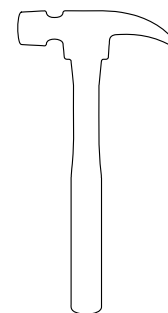

martillo



destornillador de
cabeza plana



destornillador de
cabeza phillips



**NO UTILICE HERRAMIENTAS ELÉCTRICAS
PARA MONTAR SUS MUEBLES.
HERRAMIENTAS ELÉCTRICAS PUEDEN
PROVOCAR DAÑOS.**

Megaprima Home Pte Ltd.
Diseñado en el E.E.U.U.
Hecho en Malaysia



Estamos disponibles para ayudarlo de Lunes - Viernes
de 9:00 am - 5:00 pm Hora de la Zona Este.
1-800-729-1569
Sólo E.E.U.U.

BETTER HOMES & GARDENS

6 CUBOS Y 2 ESPACIOS CÚBICOS

NÚMERO DE STOCK DEL VENDEDOR
BH5336278612104-TEXTURA BLANCO
BH5336278612105-PINO NATURAL
BH5336278612106-NUEZ

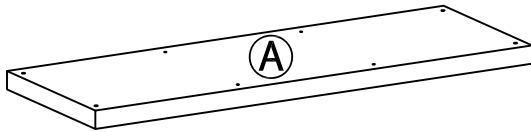

Panel Superior
(Cantidad: 1)

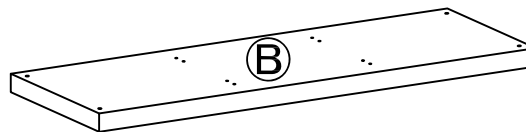

Panel Inferior
(Cantidad: 1)

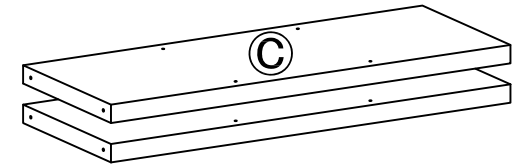

Panel Lateral
(Cantidad: 2)

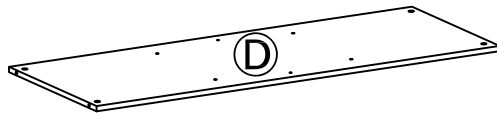

Estante Fijo 1
(Cantidad: 1)

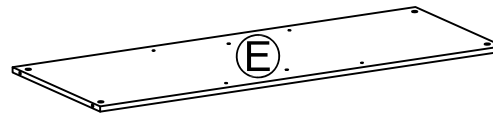

Estante Fijo 2
(Cantidad: 1)



Tabla De Tabique
(Cantidad: 5)



Panel Posterior
(Cantidad: 1)

VERIFIQUE QUE TODAS LAS PIEZAS ESTÉN EN LA LISTA ANTES DE COMENZAR

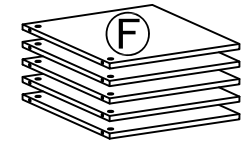
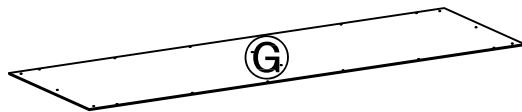

Estamos disponibles para ayudarlo de Lunes - Viernes de 9:00 am - 5:00 pm Hora de la Zona Este.
1-800-729-1569
Sólo E.E.U.U.

BETTER HOMES & GARDENS

6 CUBOS Y 2 ESPACIOS CÚBICOS

NÚMERO DE STOCK DEL VENDEDOR
 BH5336278612104-TEXTURA BLANCO
 BH5336278612105-PINO NATURAL
 BH5336278612106-NUEZ



①

②

③

④

⑤

⑥

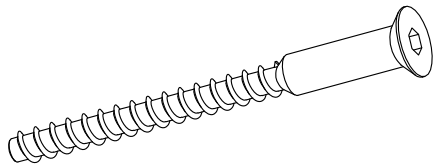

Tornillo
 Cantidad: 8

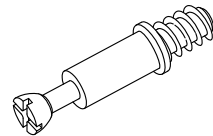

Tornillo De Combadura
 Cantidad: 18



Cerrojo De Combadura
 Cantidad: 18

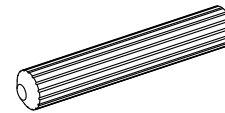

Clavija
 Cantidad: 10

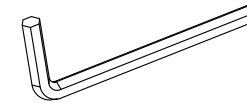

Llave Allen
 Cantidad: 1

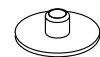

Tapón
 Cantidad: 18+1 Extra

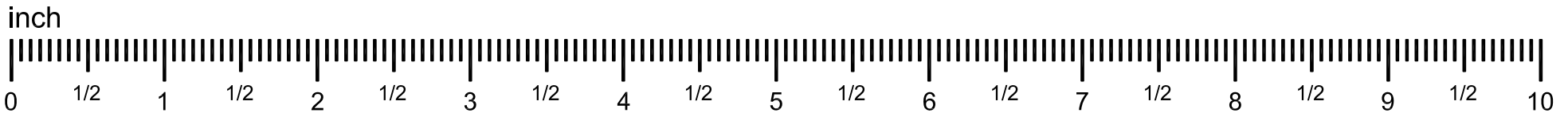

⑦

⑧

⑨

⑩

⑪

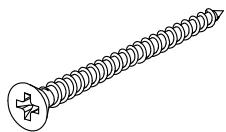

Tornillo #1
 Cantidad: 6

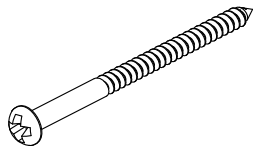

Tornillo #2
 Cantidad: 4

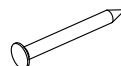

Clavo
 Cantidad: 20+1 Extra

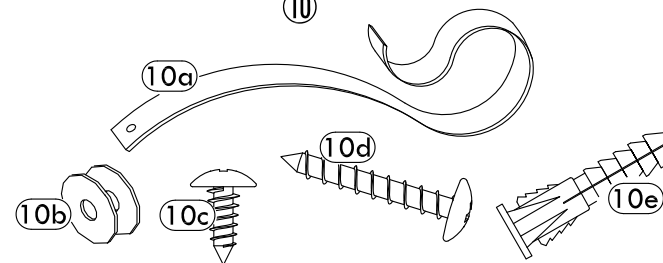

Cinturón
 Cantidad: 1

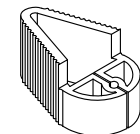

Soporte De Clavo
 Cantidad: 1

VERIFIQUE QUE TODAS LAS PIEZAS ESTÉN EN LA LISTA ANTES DE COMENZAR



Estamos disponibles para ayudarlo de Lunes - Viernes de 9:00 am - 5:00 pm Hora de la Zona Este.
1-800-729-1569
 Sólo E.E.U.U.

BETTER HOMES & GARDENS

6 CUBOS Y 2 ESPACIOS CÚBICOS

NÚMERO DE STOCK DEL VENDEDOR
BH5336278612104-TEXTURA BLANCO
BH5336278612105-PINO NATURAL
BH5336278612106-NUEZ

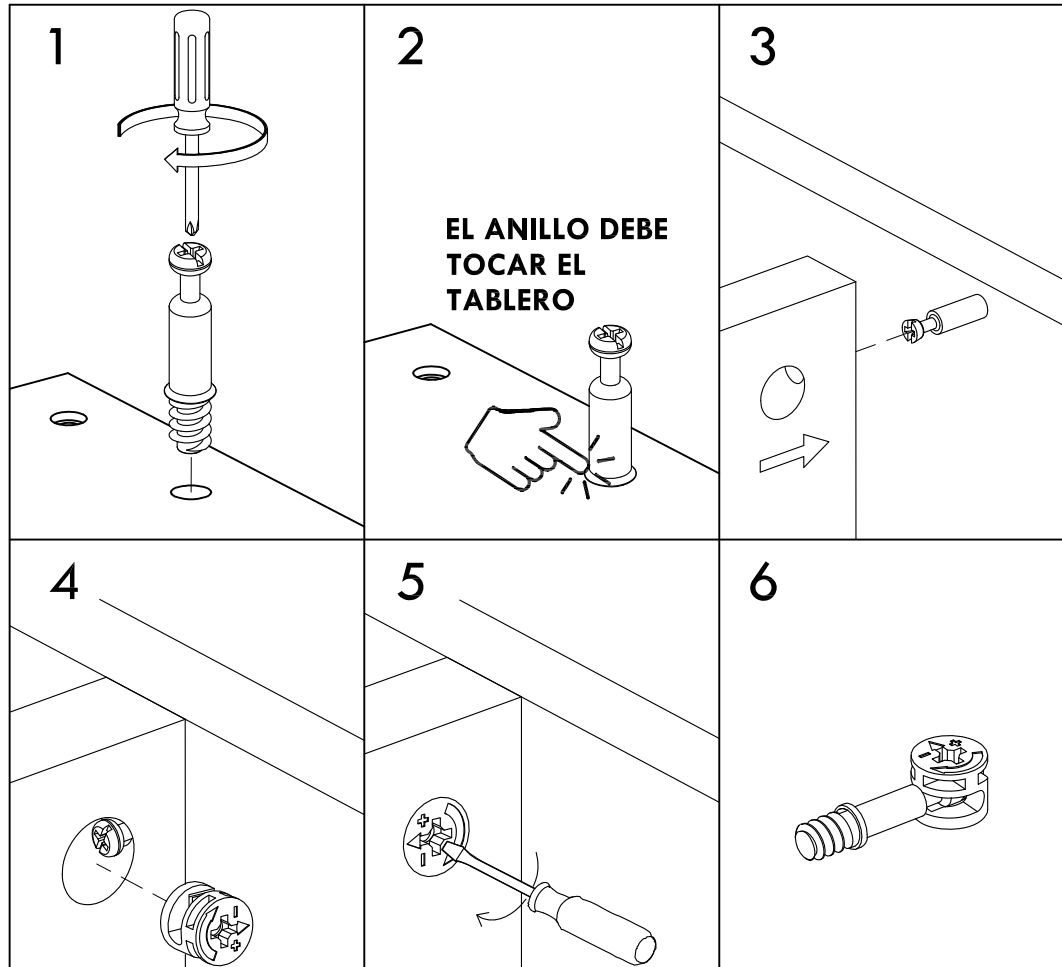

EJEMPLO DE SISTEMA DE CIERRE DE LEVA

1. Atornille el **Tornillo de combadura** en el panel pretaladrado. El tornillo debe apretarse para que no haya roscas visibles.
2. El anillo más grande del cam debe tocar el panel.
3. Conecte el tornillo de combadura previamente apretado a panel.
4. Inserte el **Cerrojo de combadura** en el agujero pretaladrado en el panel. Los Signos más y menos deberían encararse al agujero perforado en el borde del panel.
5. Usando un destornillador de cabeza plana, gire el **Cerrojo de combadura** hasta la mitad en según las agujas del reloj para asegurar el **Tornillo de combadura**.
6. **SI NO SE ASEGURA ADECUADAMENTE EL CERROJO DE COMBADURA Y EL TORNILLO DE COMBADURA, ODRÍA RESULTAR INESTABILIDAD Y FALLAS EN EL PRODUCTO.**

Megaprima Home Pte Ltd.
Diseñado en el E.E.U.U.
Hecho en Malaysia



Estamos disponibles para ayudarlo de Lunes - Viernes
de 9:00 am - 5:00 pm Hora de la Zona Este.
1-800-729-1569
Sólo E.E.U.U.

1

Atornille la Tornillo De Combadura ② en el Paneles (A) & (C).

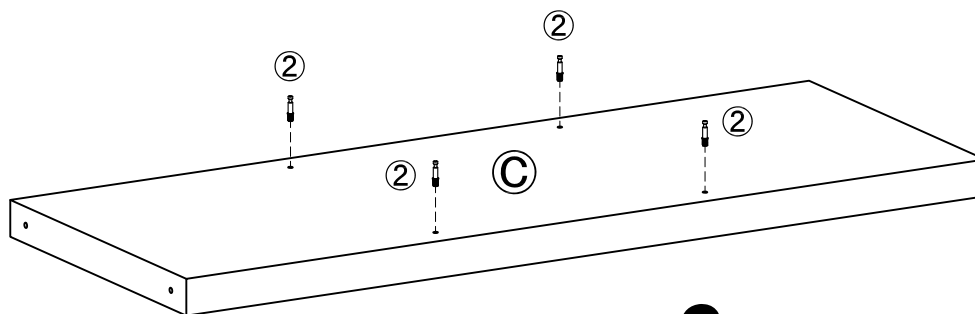
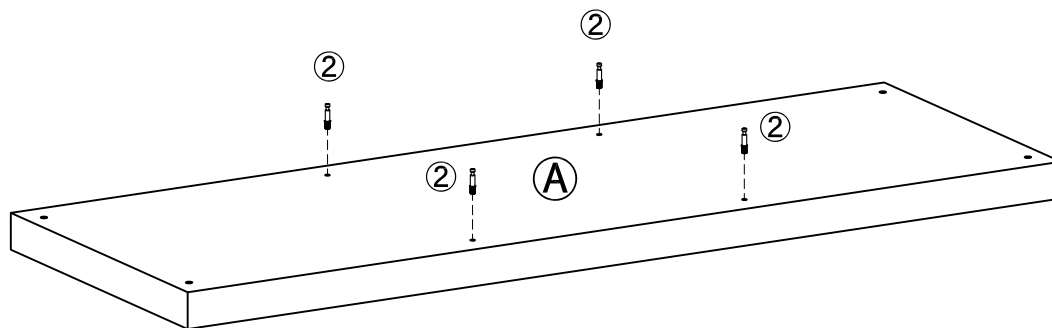

x 2

NOTAS ADICIONALES

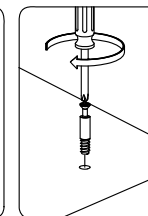
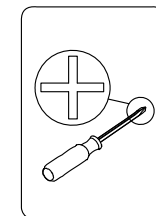

PARTES

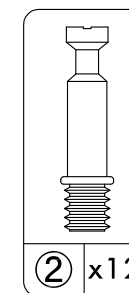

inch

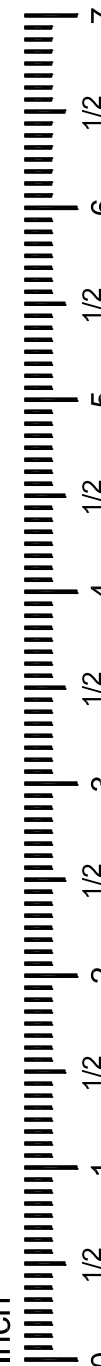

2

Atornille la Tornillo De Combadura ② en el Paneles (D) & (E).

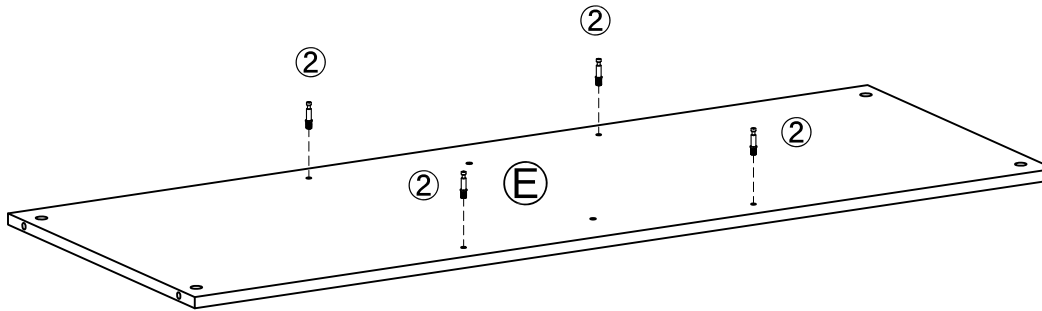
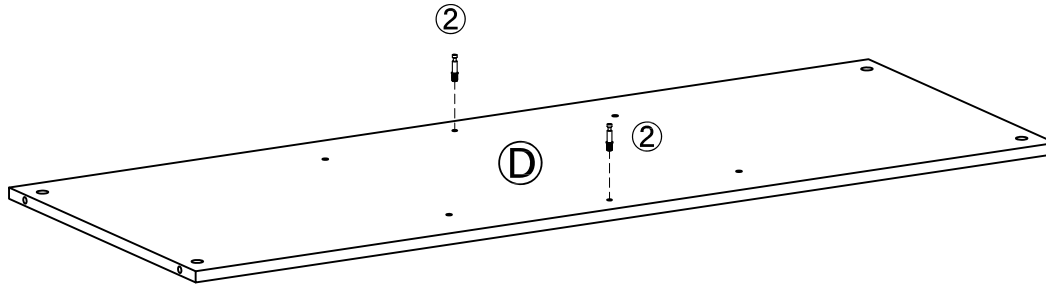

NOTAS ADICIONALES

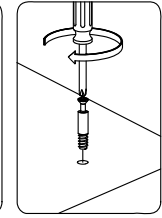
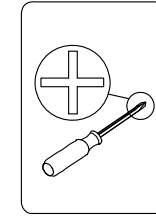

PARTES

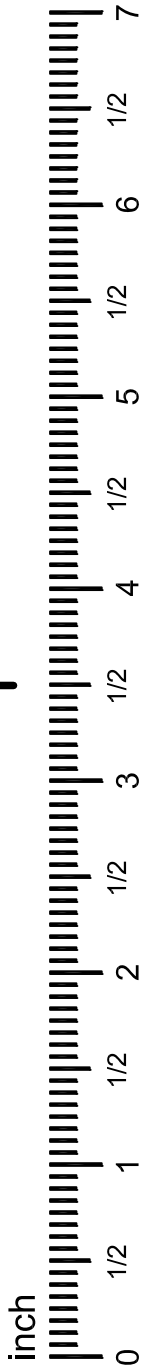
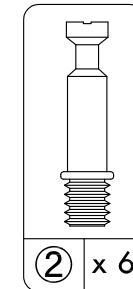

3

Inserte la dos Clavijas ④ en el cada Panel (F).
Empuje los tapones en el agujero predrillado dejando 3/8" expuesto.

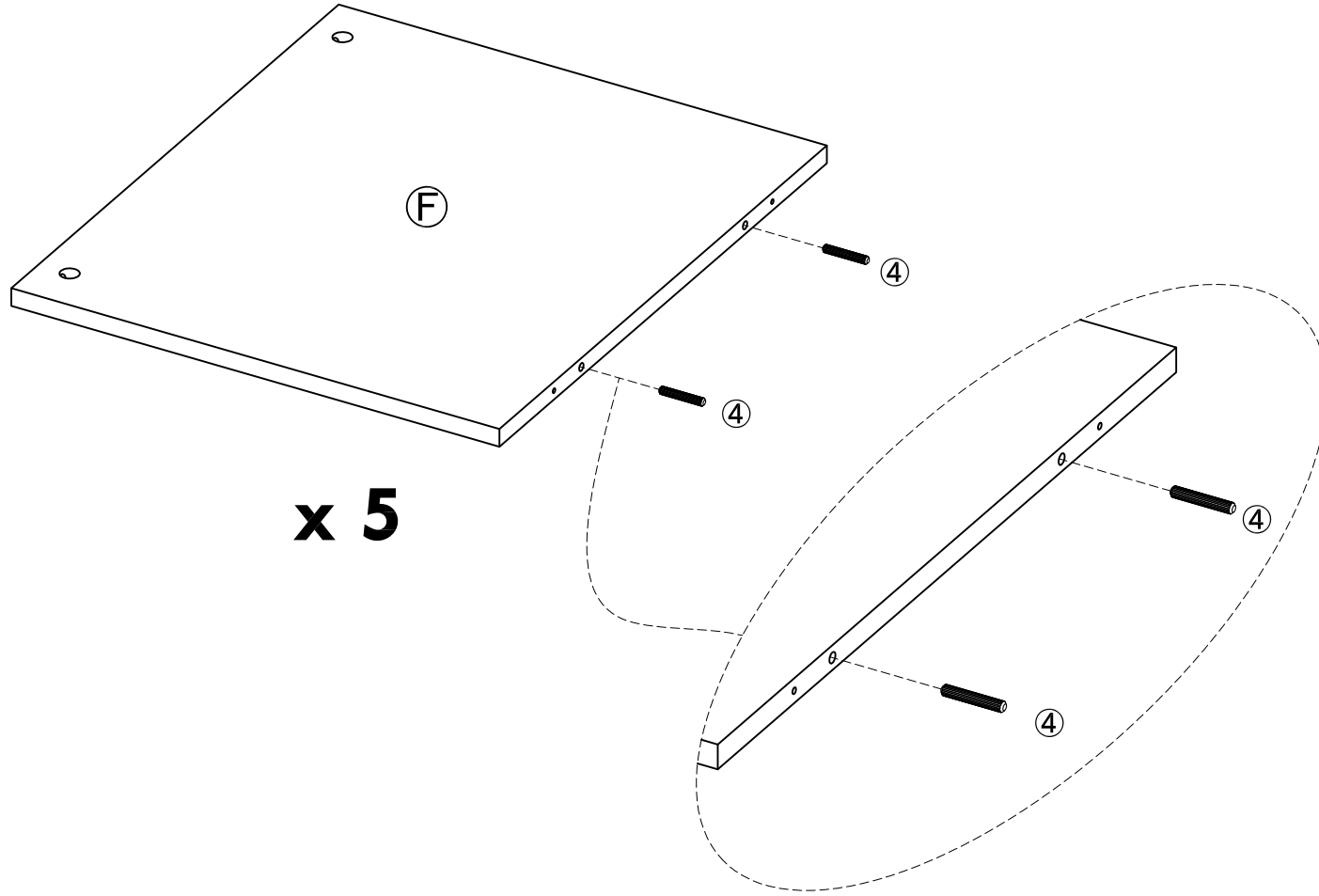

NOTAS ADICIONALES

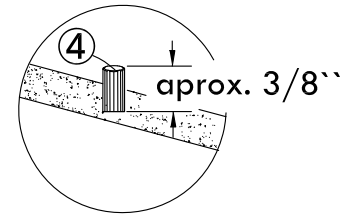

PARTES

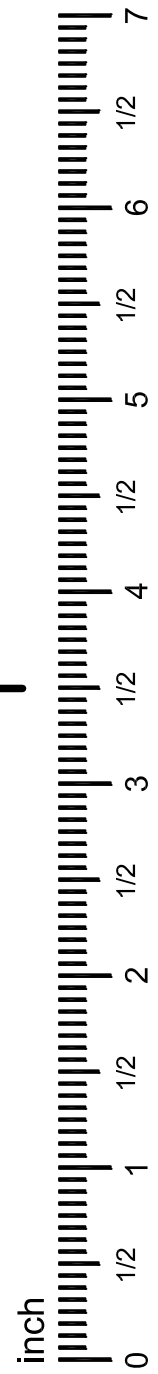
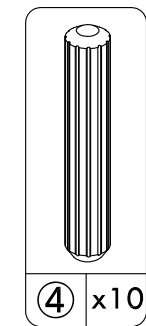

4

Utilice el Tornillo#1 ⑦ para fijar dos Paneles (F) a Panel (D), y uno Panel (F) a Panel (E).

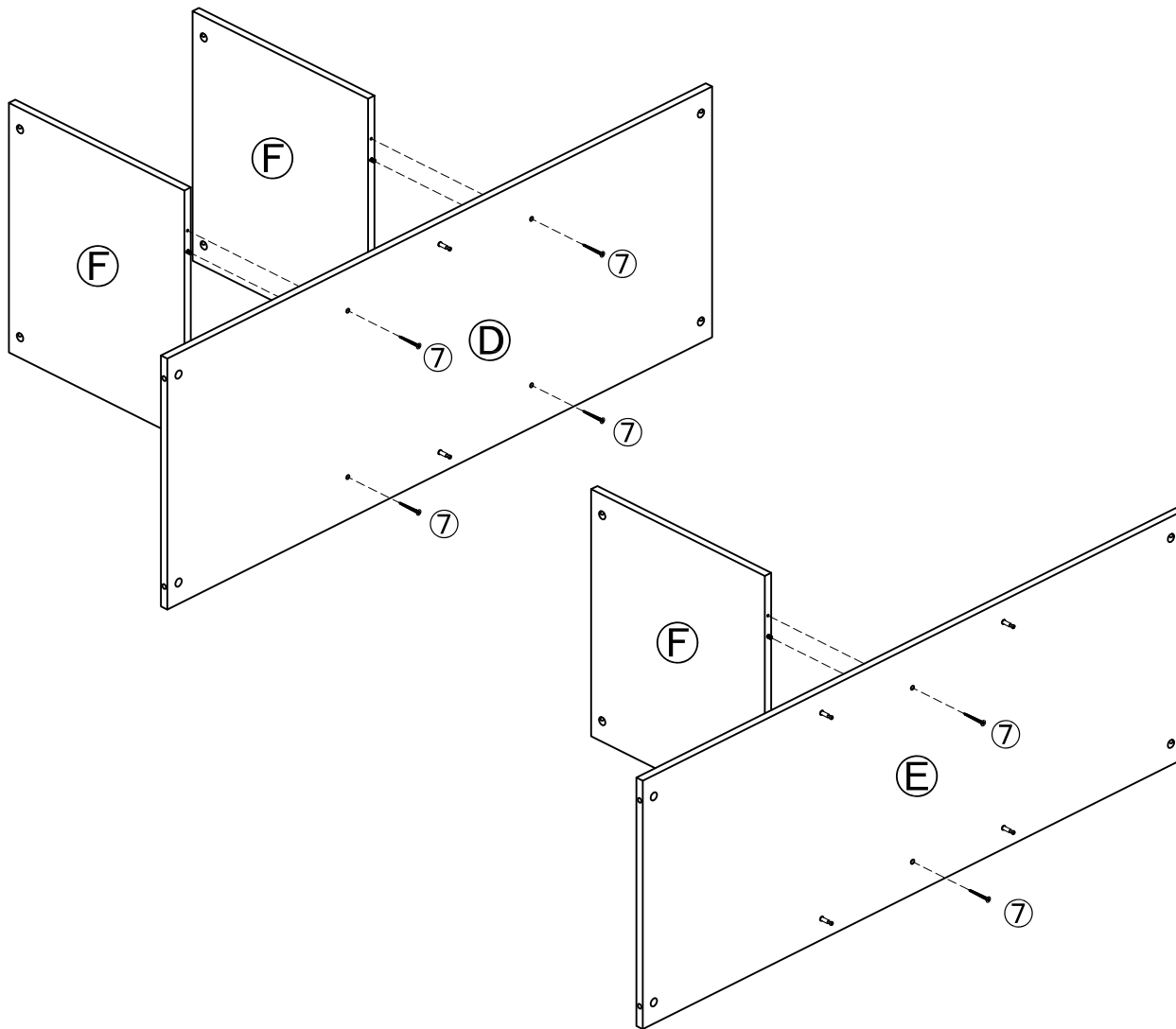

NOTAS ADICIONALES

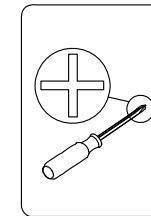

PARTES

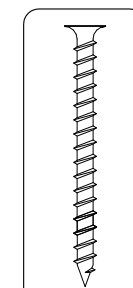

⑦ x 6

inch

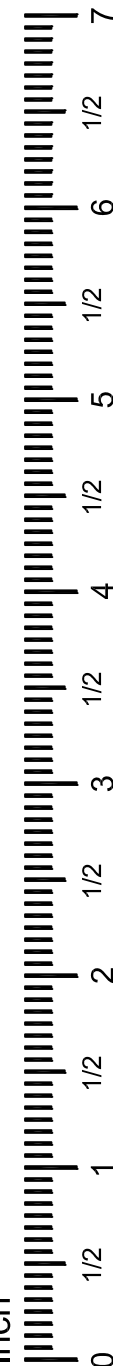

5

Conectar la dos Paneles restantes (F) a Panel (E).

Inserte la Cerrojo De Combadura ③ en el dos Paneles (F).

Con un destornillador de cabeza plana, gire cada Perno De Leva ③ 180° en sentido horario.

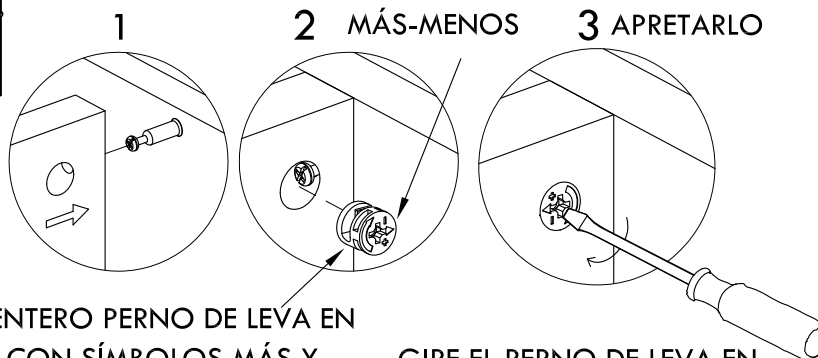
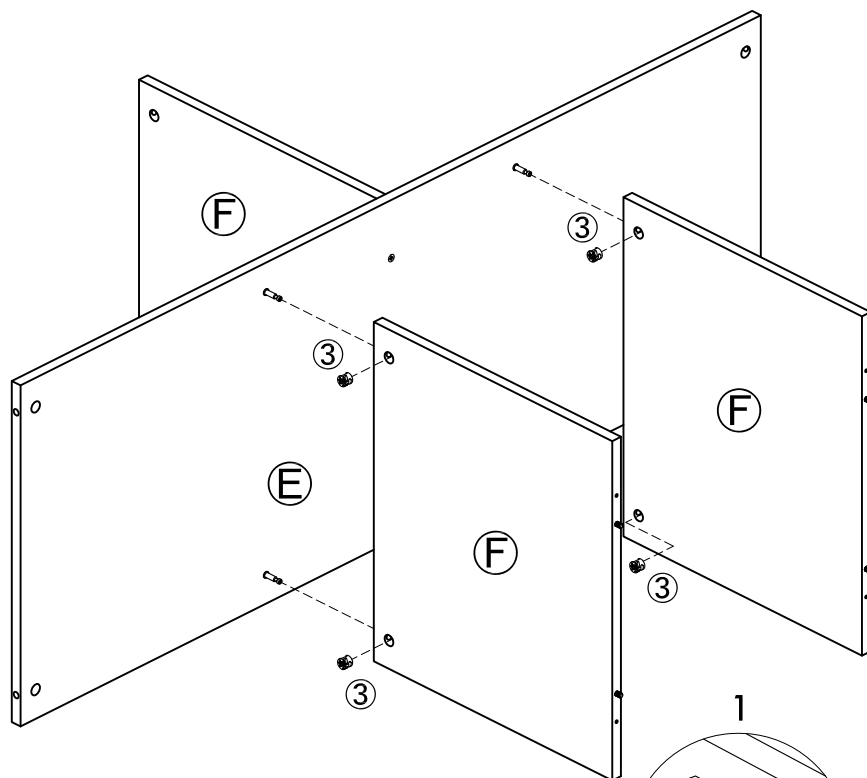

INSERTE EL ENTERO PERNO DE LEVA EN EL ORIFICIO CON SÍMBOLOS MÁS Y MENOS ORIENTADO HACIA EL ORIFICIO PERFORADO EN EL BORDE DEL PANEL

GIRE EL PERNO DE LEVA EN SENTIDO HORARIO 180° PARA FIJARLO DE FORMA SEGURA

NOTAS ADICIONALES

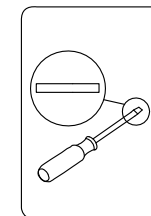

PARTES

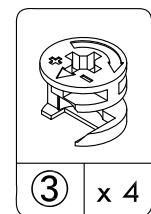

inch

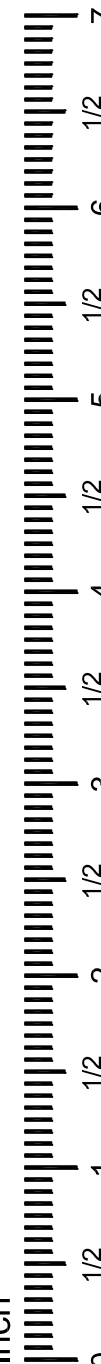

6

Conectar la Panel (F) a Panel (D).

Inserte la Cerrojo De Combadura ③ en el Panel (F).

Con un destornillador de cabeza plana, gire cada Perno De Leva ③ 180° en sentido horario.

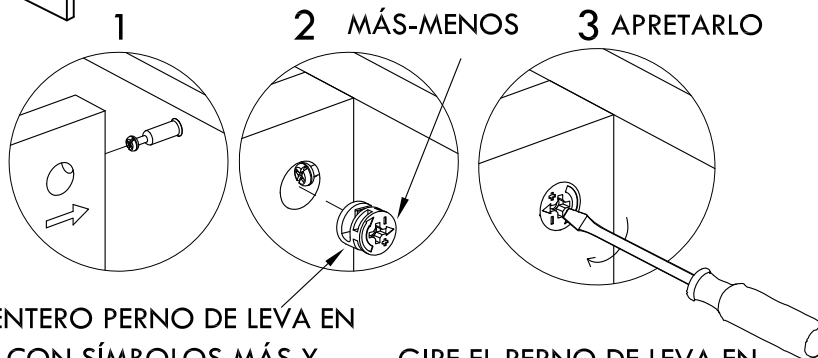
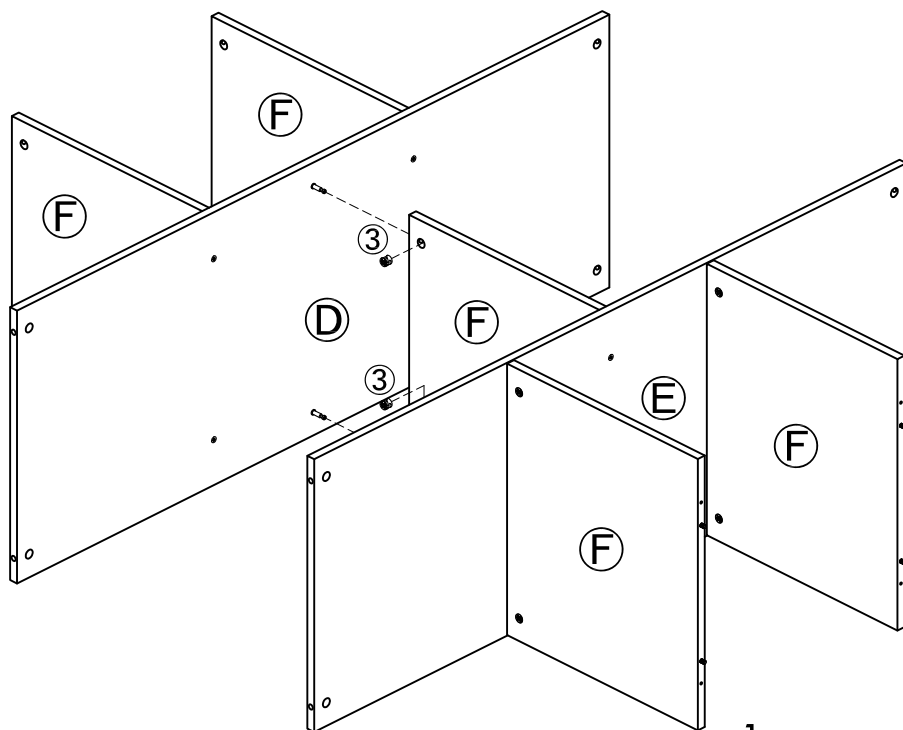

1
INSERTE EL ENTERO PERNO DE LEVA EN EL ORIFICIO CON SÍMBOLOS MÁS Y MENOS ORIENTADO HACIA EL ORIFICIO PERFORADO EN EL BORDE DEL PANEL

2 MÁS-MENOS
3 APRETARLO
GIRE EL PERNO DE LEVA EN SENTIDO HORARIO 180° PARA FIJARLO DE FORMA SEGURA

NOTAS ADICIONALES

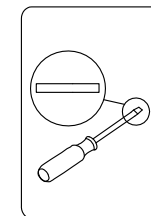

PARTES

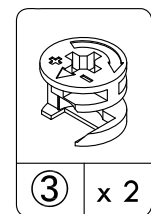

inch

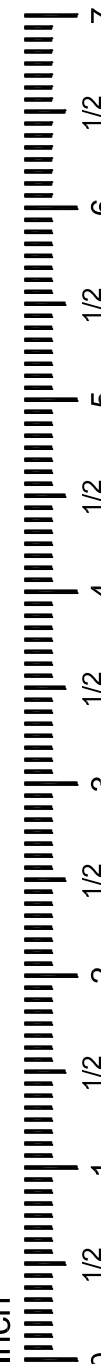

7

Conectar la Panel Lateral (C) a la estructura.

Asegúrese de que el Panel (C) esté conectado a los Paneles (D) & (E), y NO a los Paneles (F).

Inserte la Cerrojo De Combadura ③ en el paneles (D) & (E).

Con un destornillador de cabeza plana, gire cada Perno De Leva ③ 180° en sentido horario.

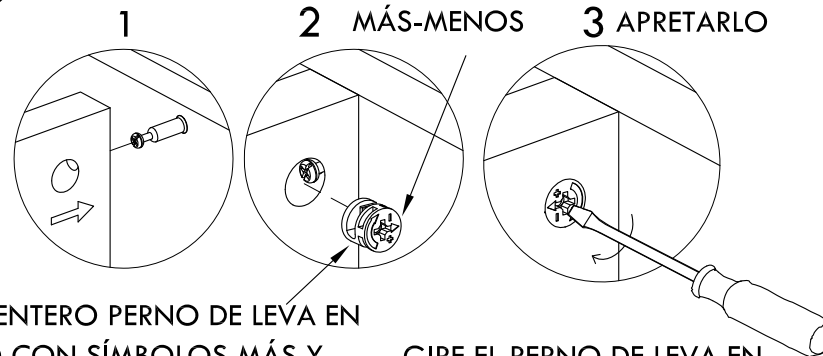
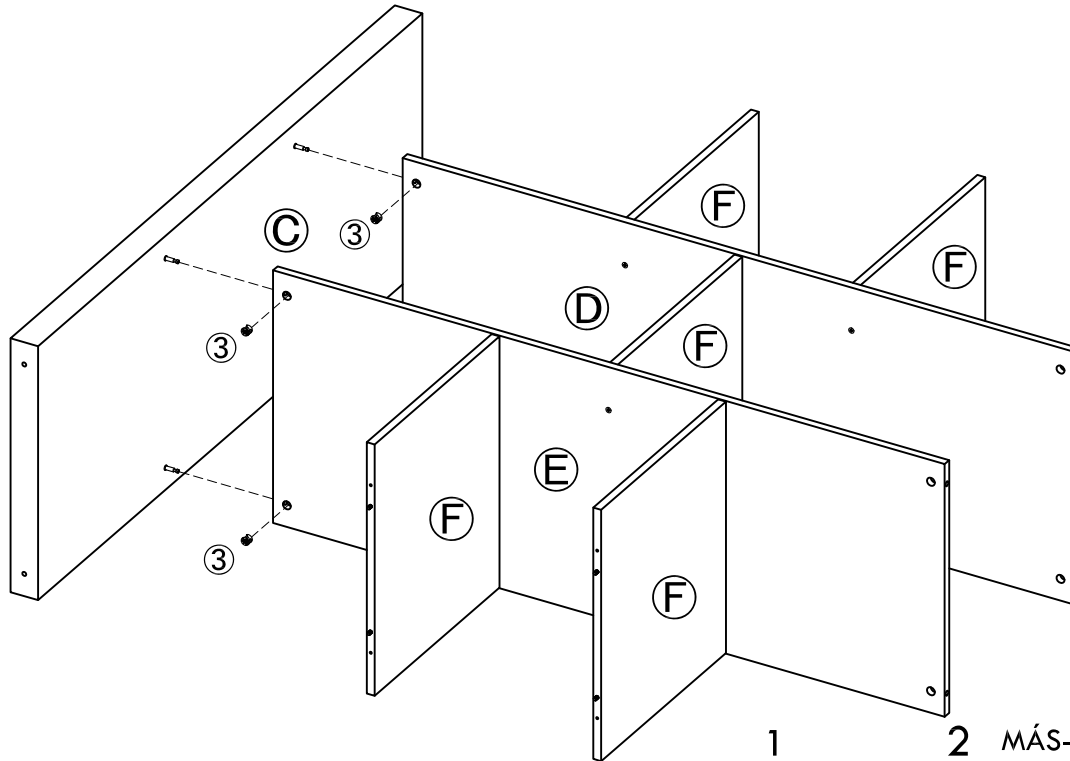

1
INSERTE EL ENTERO PERNO DE LEVA EN EL ORIFICIO CON SÍMBOLOS MÁS Y MENOS ORIENTADO HACIA EL ORIFICIO PERFORADO EN EL BORDE DEL PANEL

2 MÁS-MENOS
3 APRETARLO
GIRE EL PERNO DE LEVA EN SENTIDO HORARIO 180° PARA FIJARLO DE FORMA SEGURA

NOTAS ADICIONALES

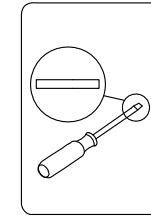

▲ ADVERTENCIA

Este producto no se moverá hasta que los paneles A & B (superior y inferior) panel estén unidos. El incumplimiento de esto puede ocasionar daños y fallas en el producto.

PARTES

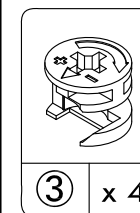

inch



8

Conectar la Panel Lateral (C) a la estructura.

Asegúrese de que el Panel (C) esté conectado a los Paneles (D) & (E), y NO a los Paneles (F).

Inserte la Cerrojo De Combadura ③ en el Paneles (D) & (E).

Con un destornillador de cabeza plana, gire cada Perno De Leva ③ 180° en sentido horario.

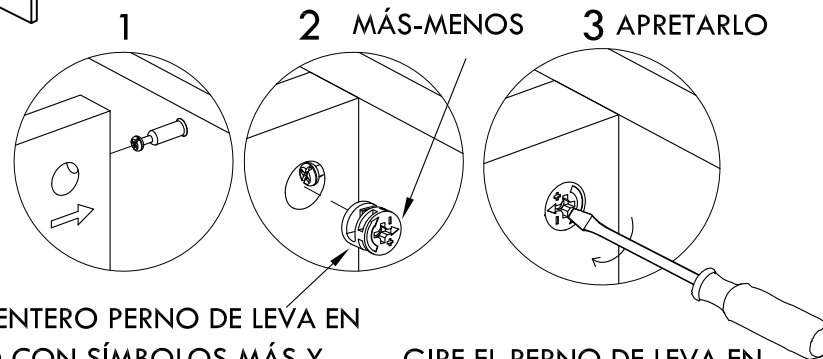
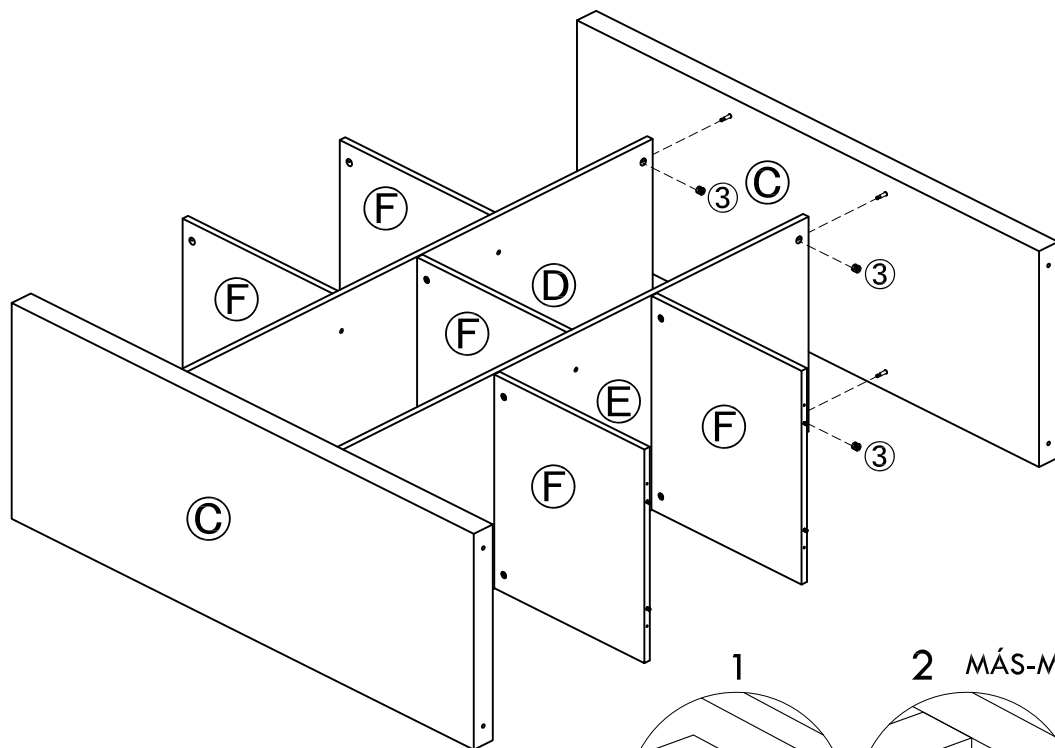

1
INSERTE EL ENTERO PERNO DE LEVA EN EL ORIFICIO CON SÍMBOLOS MÁS Y MENOS ORIENTADO HACIA EL ORIFICIO PERFORADO EN EL BORDE DEL PANEL

2 MÁS-MENOS
3 APRETARLO
GIRE EL PERNO DE LEVA EN SENTIDO HORARIO 180° PARA FIJARLO DE FORMA SEGURA

NOTAS ADICIONALES

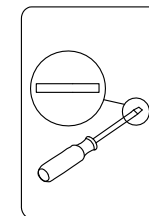

▲ ADVERTENCIA

Este producto no se moverá hasta que los paneles A & B (superior y inferior) panel estén unidos. El incumplimiento de esto puede ocasionar daños y fallas en el producto.

PARTES

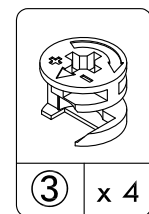

③ x 4

inch

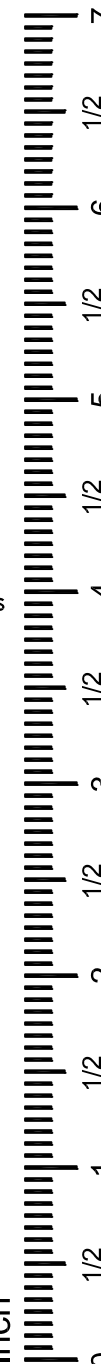

9

Conectar la Panel Inferior (B) a la estructura.

Asegúrese de que el Panel (B) esté conectado al extremo cercano al Panel (E), y NO al Panel (D).

Fije el Panel (B) con Pernos ① en los vértices y los Tornillos #2 ⑧ en el centro.

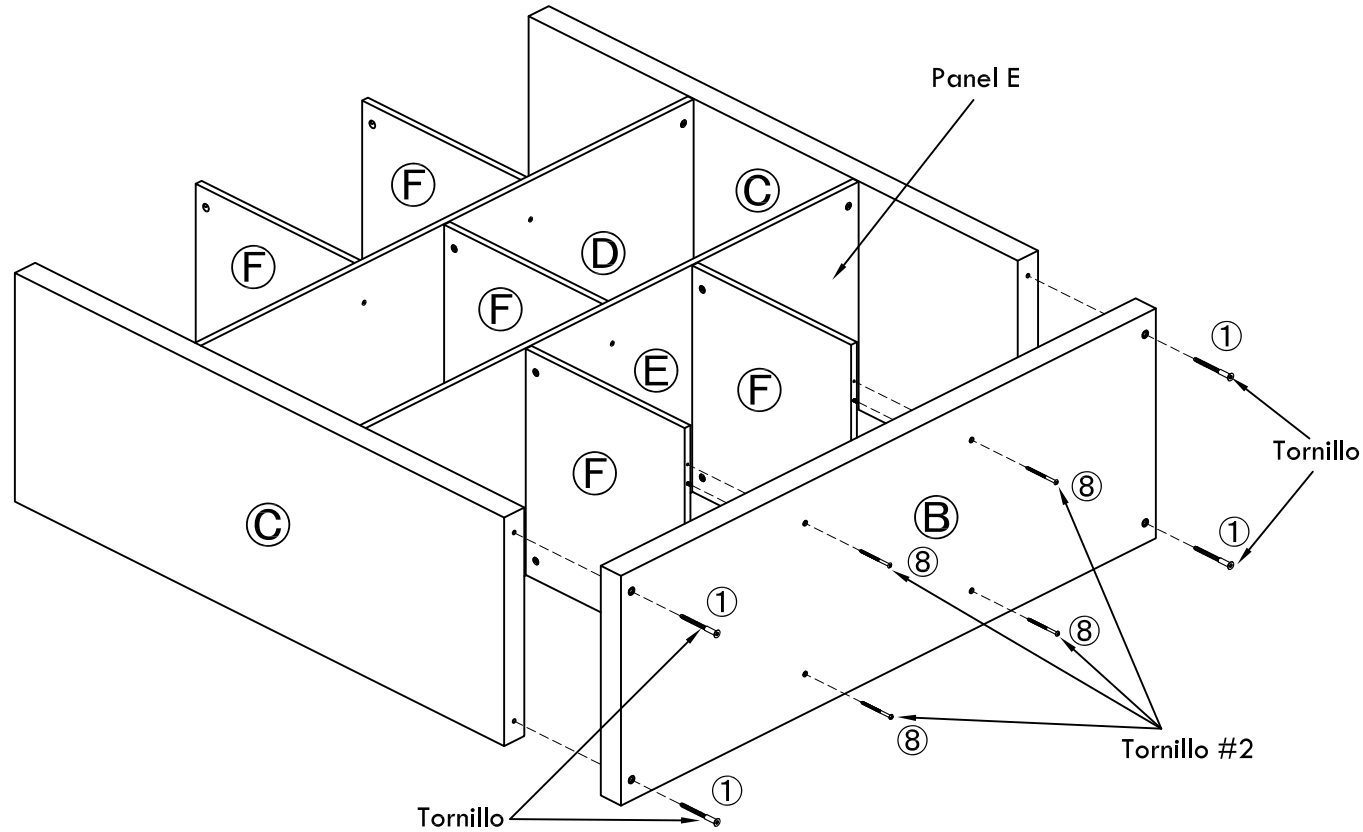

NOTAS ADICIONALES

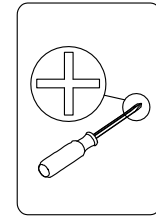
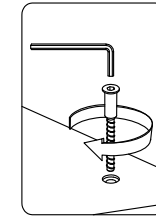

PARTES

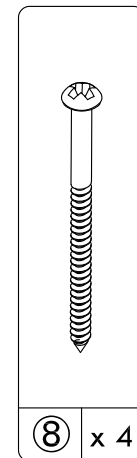
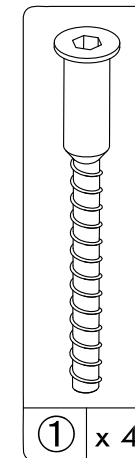

inch

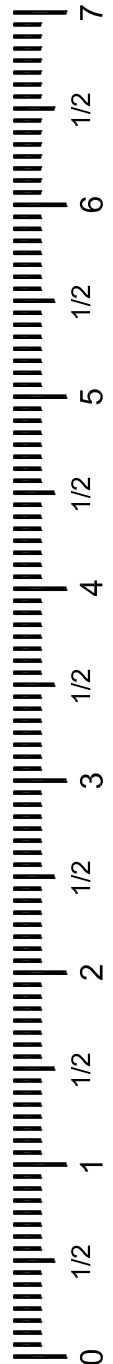

10

Conectar la Panel Superior (A) a la estructura y fije con el Tornillo ① y Llave Allen ⑤.
 Inserte la Cerrojo De Combadura ③ en el Paneles (F).
 Con un destornillador de cabeza plana, gire cada Perno De Leva ③ 180° en sentido horario.

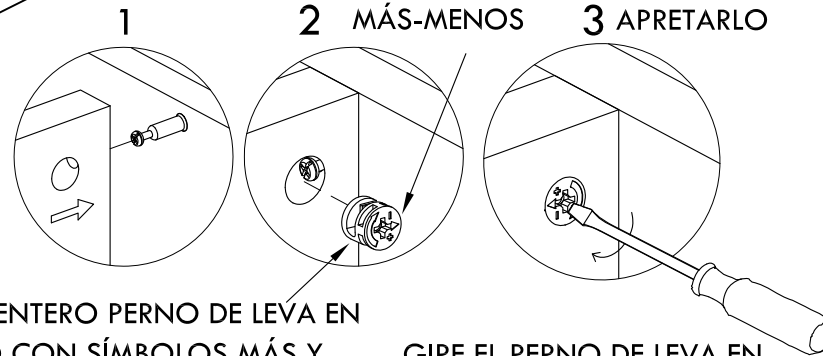
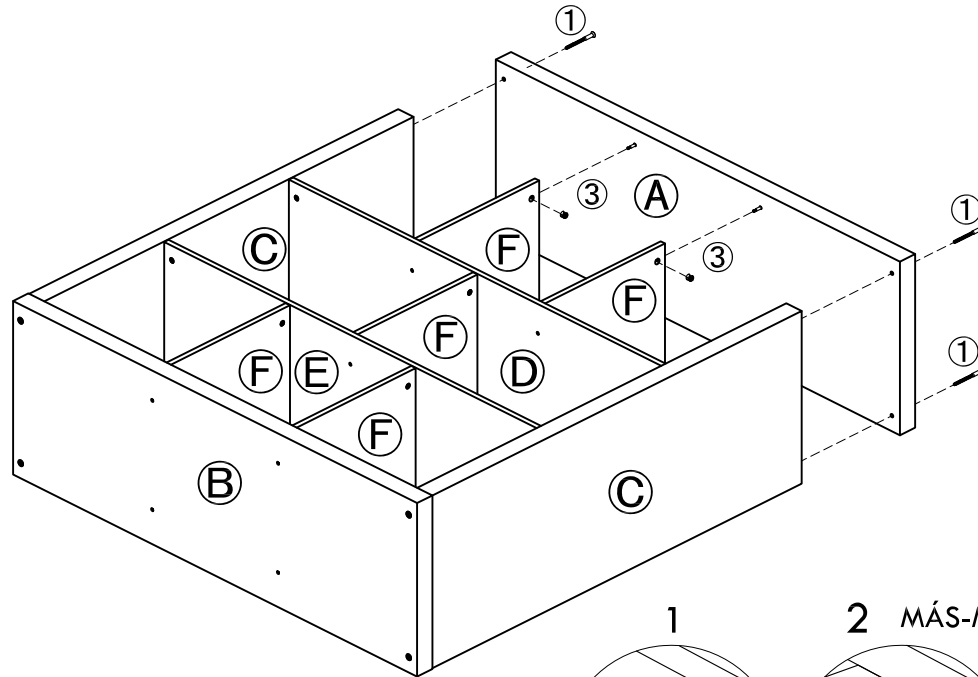

1
 INSERTE EL ENTERO PERNO DE LEVA EN EL ORIFICIO CON SÍMBOLOS MÁS Y MENOS ORIENTADO HACIA EL ORIFICIO PERFORADO EN EL BORDE DEL PANEL

2 MÁS-MENOS 3 APRETARLO
 GIRE EL PERNO DE LEVA EN SENTIDO HORARIO 180° PARA FIJARLO DE FORMA SEGURA

NOTAS ADICIONALES

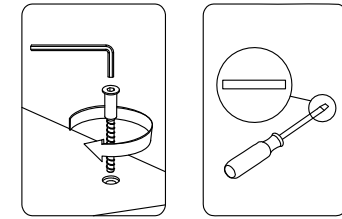

PARTES

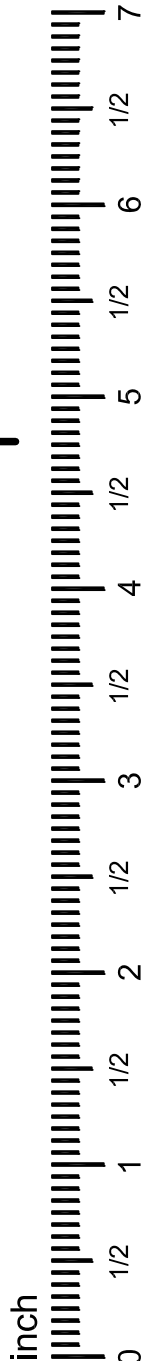
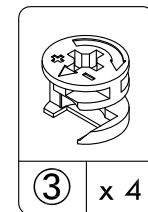
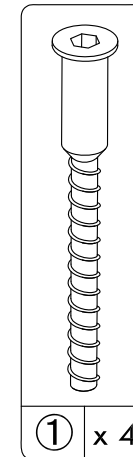

11

Utilice la tapón ⑥ para cubrir los cabezas el tornillo expuestos en el paneles (A), (B) & (F).
 Coloque la correa de pared central (10a) en el borde del Panel Superior (A) y fija usando (10b) y (10c).

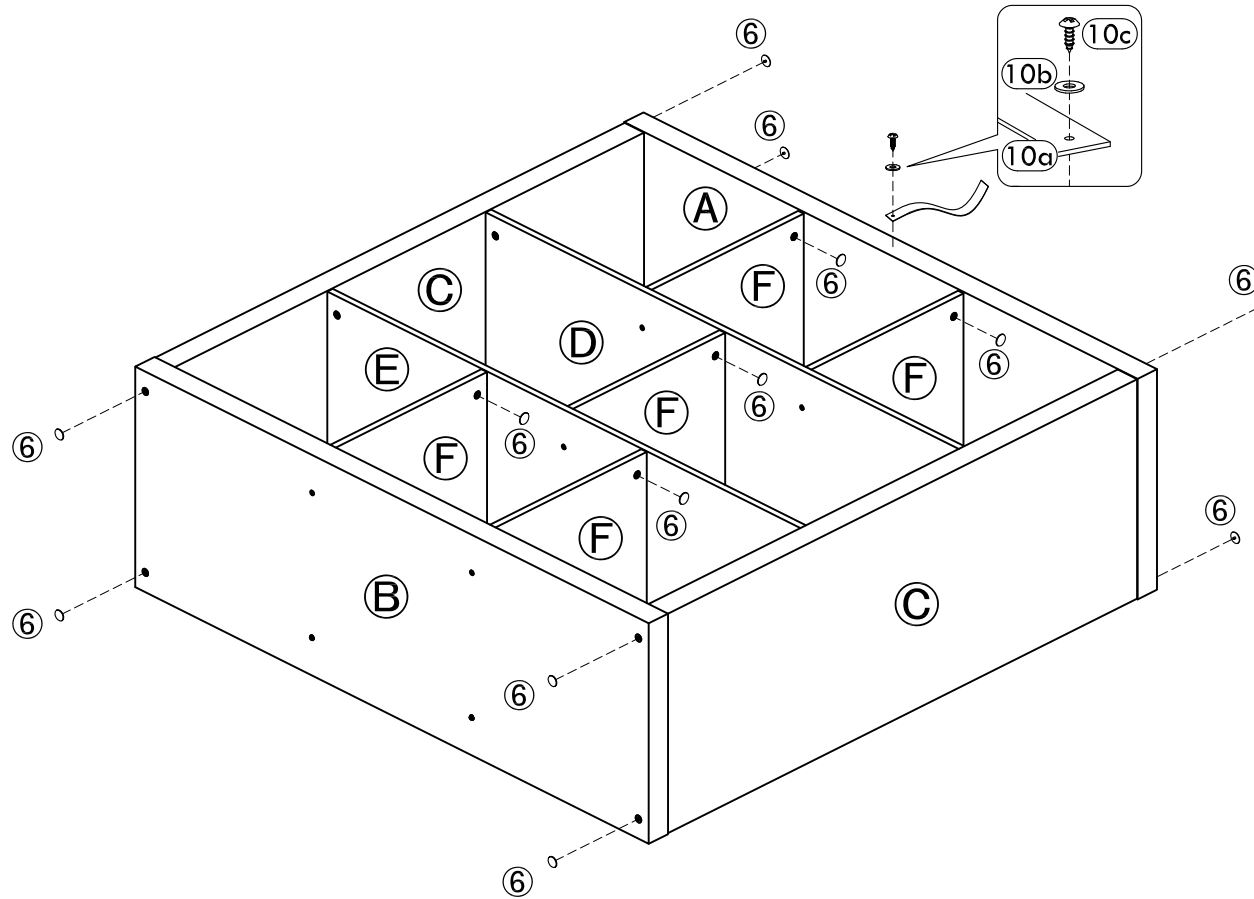

NOTAS ADICIONALES

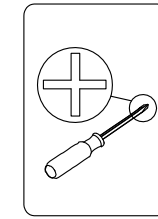

PARTES

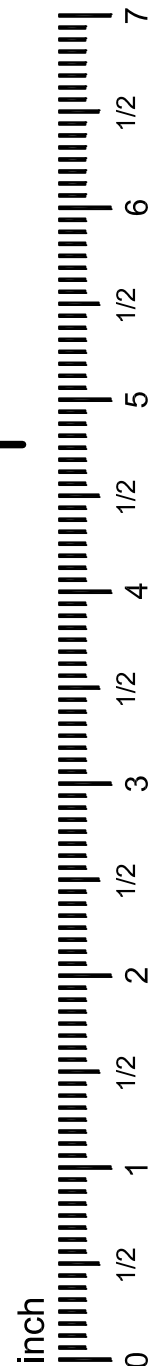
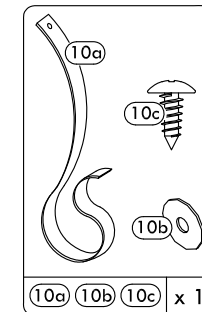
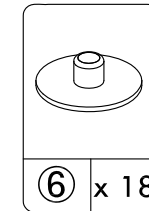

12

Alinee el Panel Trasero (G) al conjunto y lo fije con Clavos (9).

El Soporte de clavo (11) puede usarse para posicionar los clavos al fijar los bordes largos de los Planes (D) & (E).

Coloque un clavo en el soporte de clavos y deslice el soporte hacia el borde de la unidad hasta que quede al ras. El clavo se colocará en el centro del tablero de partículas. Martille el clavo ligeramente en el tablero, luego deslice el soporte hacia atrás y martille el resto de clavo.

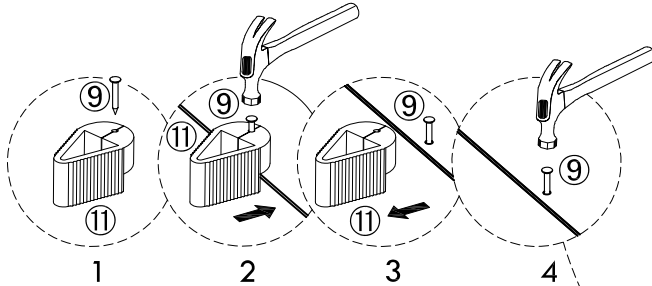

PRECAUCIÓN: Los paneles traseros deben fijarse antes de mover o utilizar la unidad. El fallo de fijarse los paneles traseros resultará en inestabilidad.

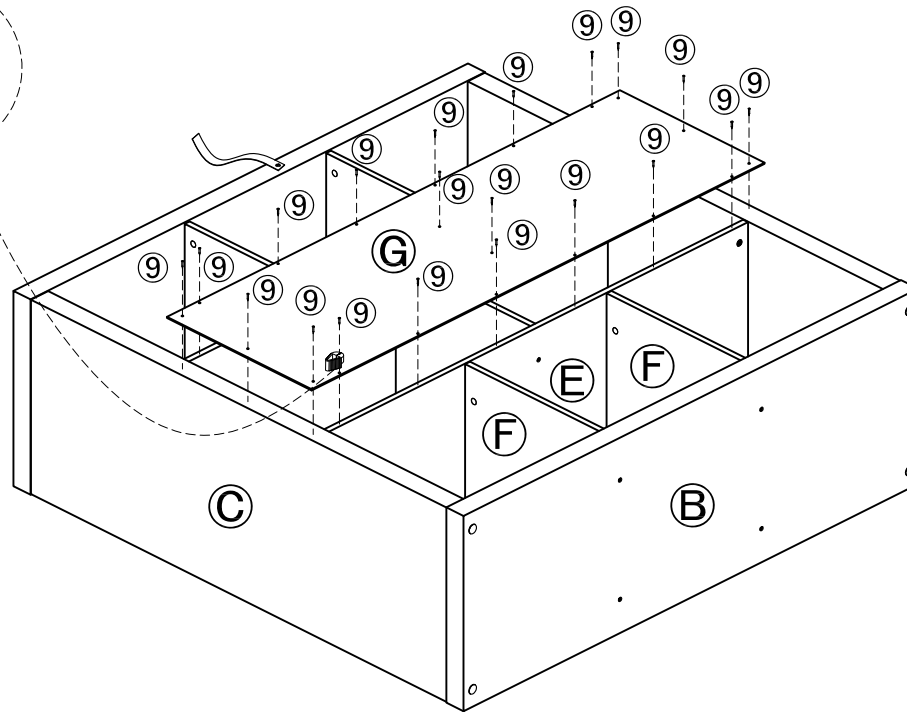

NOTAS ADICIONALES

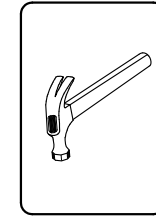

PARTES

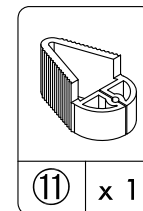
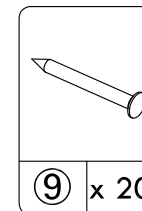

inch



13

Abrochar el cinturón con la pared usando Opción 1 o Opción 2 muestra a continuación.

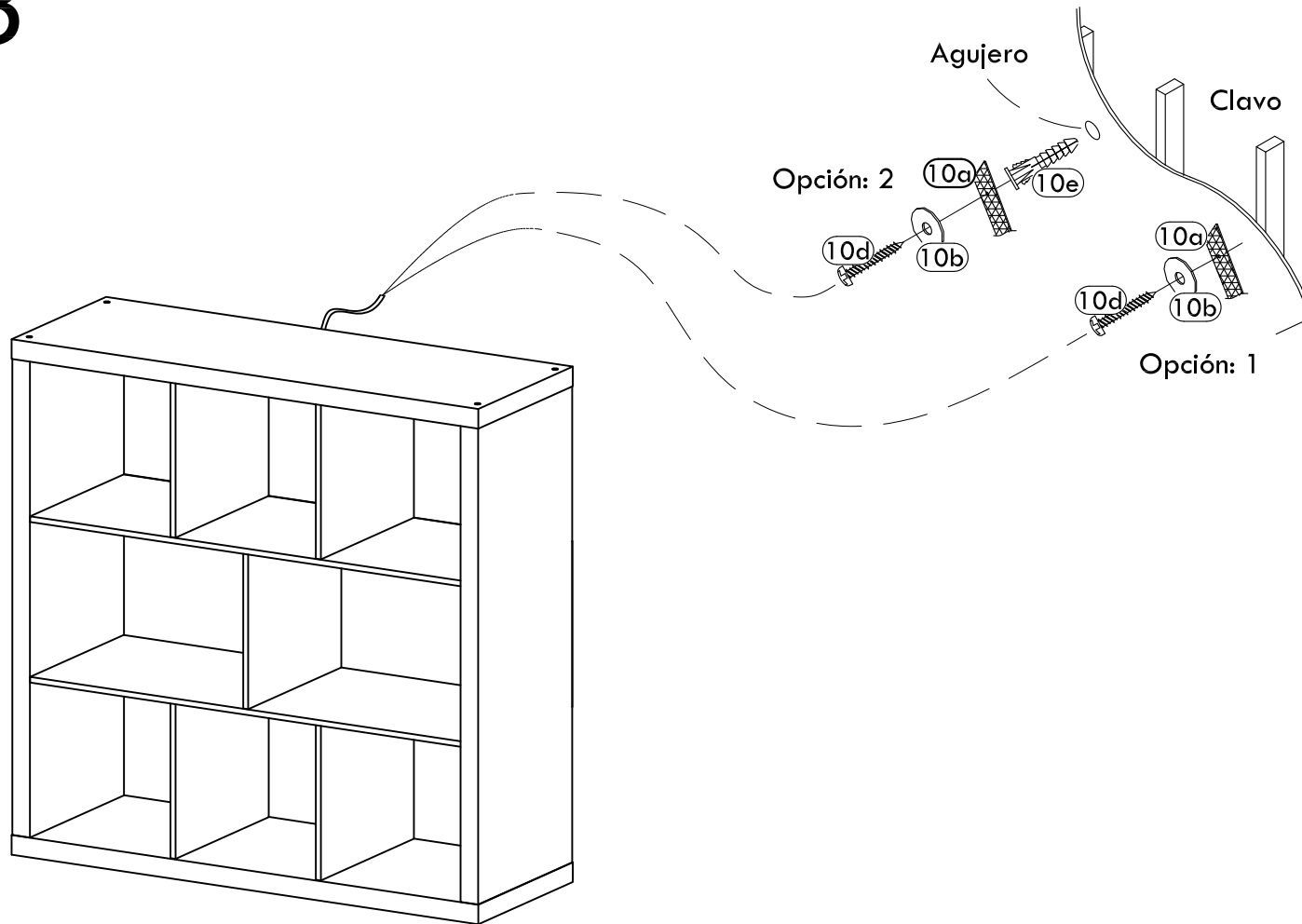

Abrochar el cinturón con la pared usando OPCIÓN 1 o 2 como ilustrado.

Opción 1:

Abrochar el cinturón (10a) con el clavo en la pared usando tornillo (10d) a través de arandela (10b).

Opción 2:

Perforar un agujero de diámetro 3/16" en la barra. Espitar la ancla de pared (10e) en el agujero hasta que es quede al mismo nivel. Fijar el cinturón (10a) con la ancla de pared (10e) usando el tornillo (10d) a través de la arandela (10b).

NOTAS ADICIONALES

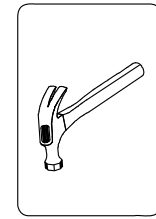
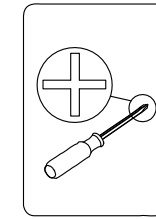

PARTES

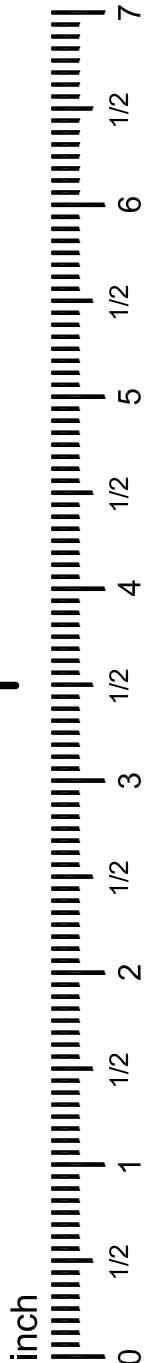
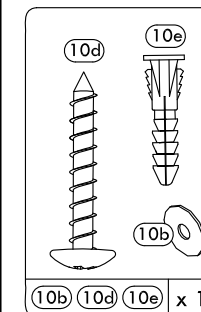

ENHORABUENA, SU ACCESORIO ESTÁ COMPLETO, ¡DISFRUTE Y NO DEJE DE CONTARNOS SU EXPERIENCIA!

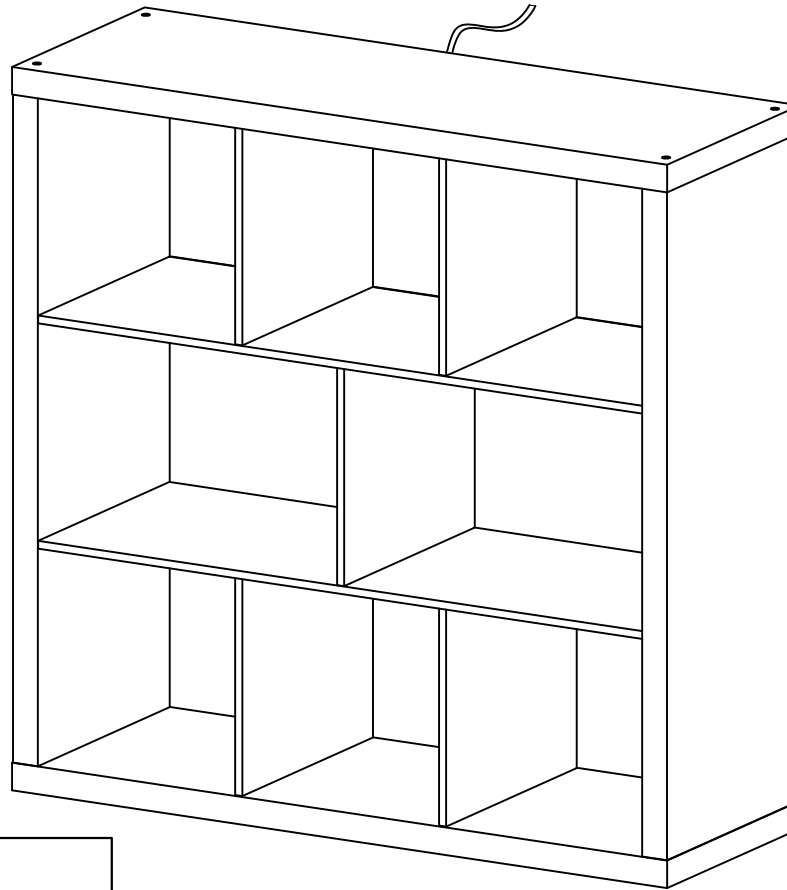

Garantía de Calidad

Si este producto presenta defectos de fabricación o de materiales o se cae bajo usos normales, lo arreglaremos o sustituiremos por hasta (1) año desde la fecha de compra.

Esta garantía te otorga derechos legales específicos y tú también tienes otros derechos que varían de un Estado a otro.

**Por favor de llamarnos para piezas de reemplazo o ayudas: 1-800-729-1569
Lunes - Viernes 9:00 am - 5:00 pm EST**