

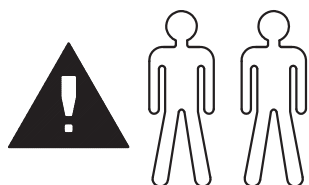

HOMETRENDS ACCENT CABINET

VENDOR STOCK NUMBERS
HS201806-15-DARK OAK



TOP PANEL
MAXIMUM LOAD
44 LB (20 KG)

SHELF PANEL
MAXIMUM LOAD
55 LB (25 KG)

INNER ADJUSTABLE SHELF
MAXIMUM LOAD
22 LB (10 KG)

BOTTOM PANEL
MAXIMUM LOAD
55 LB (25 KG)

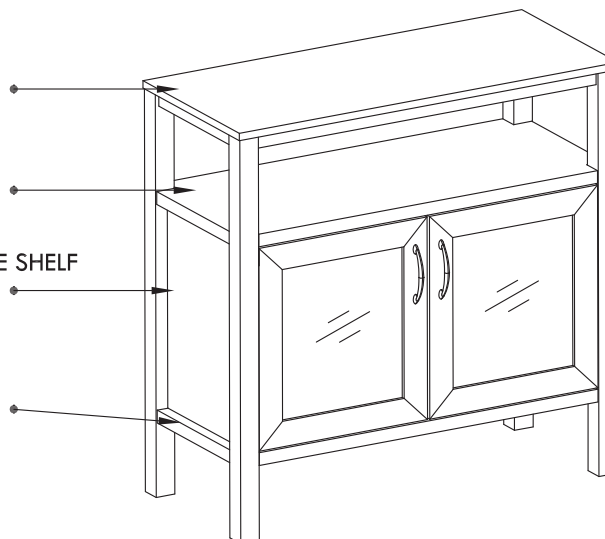

RECOMMENDED NUMBER OF PEOPLE FOR ASSEMBLY : 2
ESTIMATED ASSEMBLY TIME: 1 HOUR

- CALL OUR TOLL FREE NUMBER **1-800-729-1569** FOR FURTHER ASSISTANCE.
- ADDITIONAL PARTS ARE AVAILABLE FOR A FEE.
- THIS INSTRUCTION BOOK CONTAINS IMPORTANT SAFETY INFORMATION, PLEASE READ IT AND KEEP FOR FUTURE REFERENCE.
- DO NOT ALLOW CHILDREN TO CLIMB OR PLAY ON THE UNIT.
- CLEAN THE PRODUCT WITH YOUR FAVORITE FURNITURE POLISH AND A SOFT CLOTH.
- DO NOT USE HARSH CHEMICALS OR ABRASIVE CLEANERS.
- MOVE YOUR NEW FURNITURE CAREFULLY WITH TWO PEOPLE. NEVER PUSH OR DRAG THE UNIT.

DO NOT RETURN THE PRODUCT TO THE STORE.
INDIVIDUAL STORES DO NOT STOCK PARTS.
FOR MISSING OR DAMAGED PARTS CALL
1-800-729-1569.
PARTS WILL BE SHIPPED FREE OF CHARGE.

FOR PROMPT, RELIABLE SERVICE, PLEASE HAVE
YOUR ASSEMBLY MANUAL READY.

LOT NUMBER _____
DATE OF PURCHASE ____/____/____

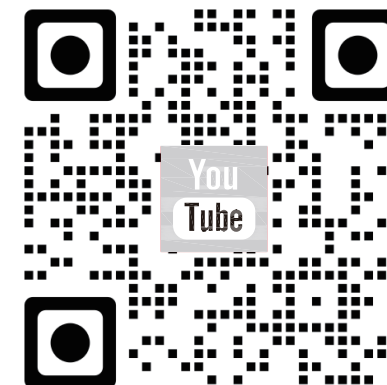

Open your camera and scan the code
above for a video assembly guide.

Huisen Furniture (Longnan) Co.,Ltd.
Designed in the USA
Made in China



We are available to assist you Monday -Friday
from 9:00 am - 5:00 pm Eastern Standard Time.
1-800-729-1569

HOMETRENDS ACCENT CABINET

VENDOR STOCK NUMBERS
HS201806-15-DARK OAK



BEFORE STARTING

- Read and understand all the steps carefully before starting. If each step is not followed in the correct order the assembly will be difficult and may result in damages.
- Work in a spacious area, preferably on a carpeted surface, near where the unit will be used.
- Make sure all the parts are included. Most boards are labeled with a removable sticker.

Helpful hints

- Call our toll free number if you need assistance.
We are available to assist you Monday - Friday from 9:00 am - 5:00 pm Eastern Standard Time.
- **1-800-729-1569**
Or submit a request through our self-service portal at www.huisenfurniture.zendesk.com

TOOLS NEEDED TO ASSEMBLE

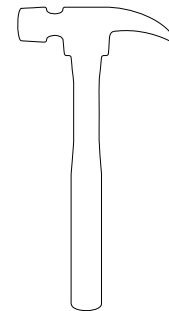

hammer



flat head
screwdriver

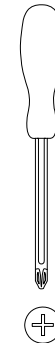

phillips head
screwdriver



**DO NOT USE POWER TOOLS TO ASSEMBLE
YOUR FURNITURE. POWER TOOLS MAY
RESULT IN DAMAGE.**

Huisen Furniture (Longnan) Co.,Ltd.
Designed in the USA
Made in China



We are available to assist you Monday -Friday
from 9:00 am - 5:00 pm Eastern Standard Time.
1-800-729-1569

HOMETRENDS ACCENT CABINET

VENDOR STOCK NUMBERS
HS201806-15-DARK OAK

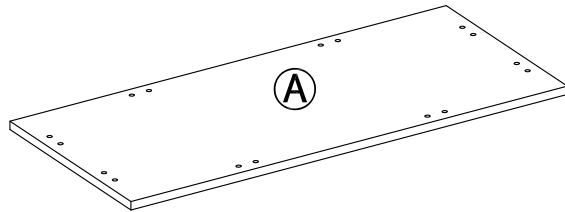

Top panel
(Qty: 1)

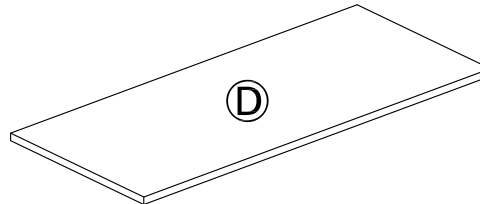

Adjustable shelf
(Qty: 1)

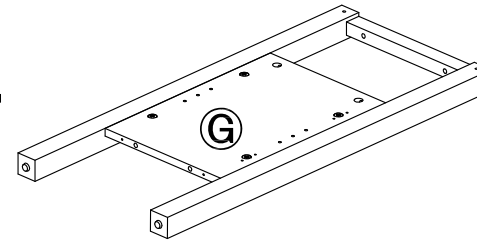

Right side frame
(Qty: 1)

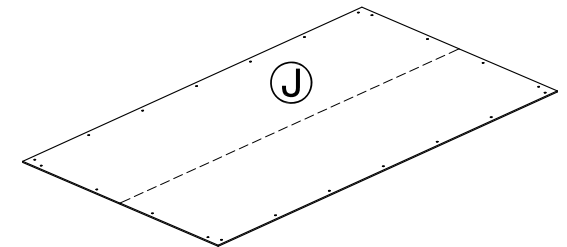

Back panel
(Qty: 1)

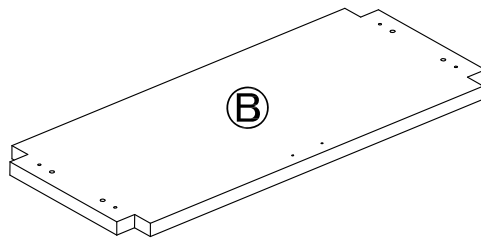

Shelf panel
(Qty: 1)

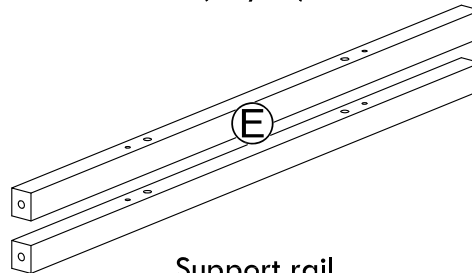

Support rail
(Qty: 2)

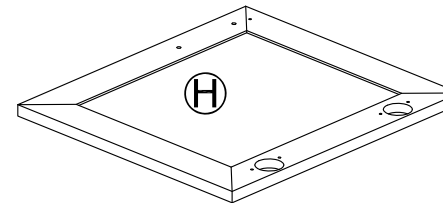

Left door panel
(Qty: 1)

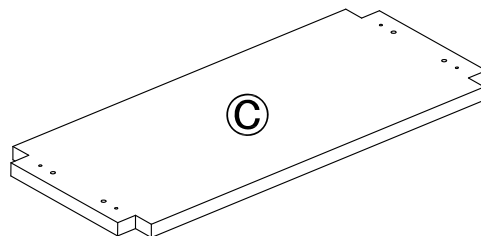

Bottom panel
(Qty: 1)

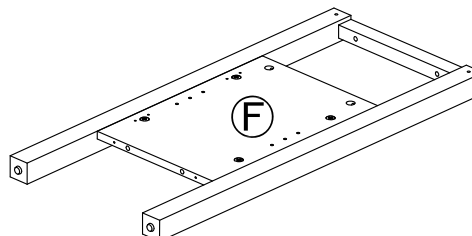

Left side frame
(Qty: 1)

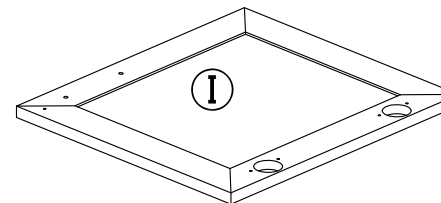

Right door panel
(Qty: 1)

VERIFY THAT ALL PARTS ARE PRESENT BEFORE BEGINNING



We are available to assist you Monday -Friday
from 9:00 am - 5:00 pm Eastern Standard Time.
1-800-729-1569

HOMETRENDS ACCENT CABINET

VENDOR STOCK NUMBERS
HS201806-15-DARK OAK

①



Cam lock
Qty: 8

②

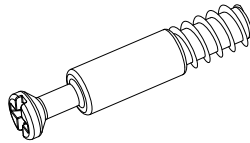

Cam bolt
Qty: 8

③

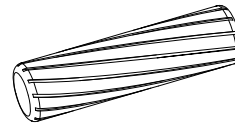

Wood dowel
Qty: 16

④

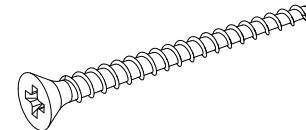

Screw #1
Qty: 4

⑤

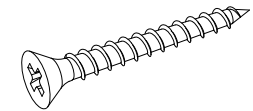

Screw #2
Qty: 8

⑥

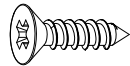

Screw #3
Qty: 16

⑦

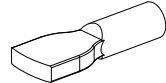

Shelf support
Qty: 4

⑧



Screw #4
Qty: 4

⑨

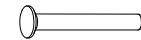

Nail
Qty: 22

⑩

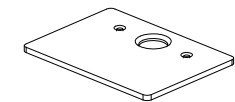

Magnet strike
Qty: 2

⑪



Screw #5
Qty: 2

⑫



Screw #6
Qty: 2

⑬

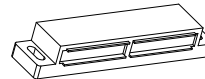

Magnet
Qty: 1

⑭



Handle
Qty: 2

⑮

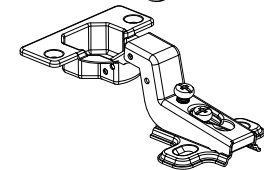

Hinges
Qty: 4

VERIFY THAT ALL PARTS ARE PRESENT BEFORE BEGINNING



We are available to assist you Monday -Friday
from 9:00 am - 5:00 pm Eastern Standard Time.
1-800-729-1569

HOMETRENDS ACCENT CABINET

VENDOR STOCK NUMBERS
HS201806-15-DARK OAK

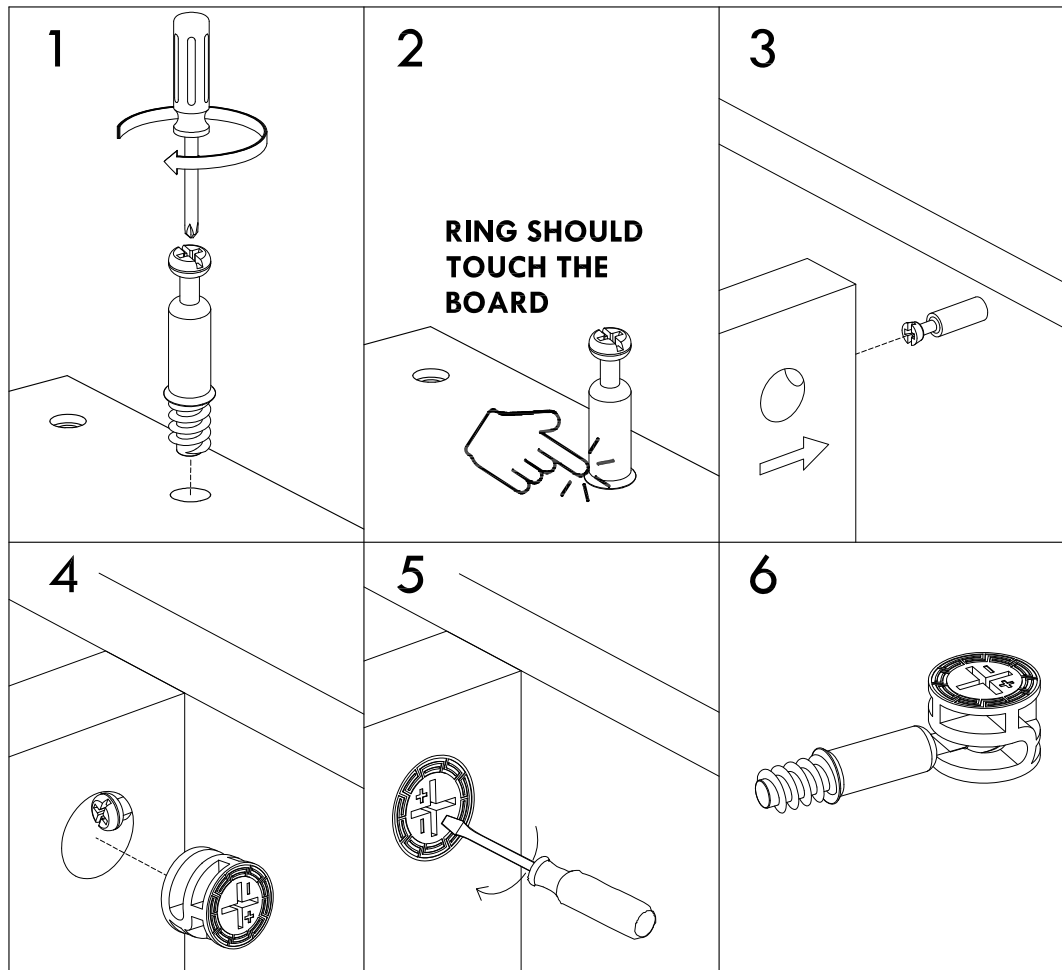

CAM FASTENING SYSTEM

1. Screw the **cam bolt** into the predrilled panel. The screw should be tightened so no threads are visible.
2. The larger ring of the cam should touch the panel.
3. Connect the previously tightened cam bolt to the panel.
4. Insert the **cam lock** into the predrilled hole in the panel. The plus and minus signs should be facing the predrilled hole in the edge of panel.
5. Using a flat head screw driver, turn the **cam lock** halfway clockwise to secure the **cam bolt**.
6. **FAILURE TO PROPERLY SECURE THE CAM LOCK AND CAM BOLT COULD RESULT IN PRODUCT INSTABILITY AND FAILURE.**

Huisen Furniture (Longnan) Co.,Ltd.
Designed in the USA
Made in China



We are available to assist you Monday -Friday
from 9:00 am - 5:00 pm Eastern Standard Time.
1-800-729-1569

1

Screw part ② (cam bolts) into B panel.
Use part ⑫ (screw #6) to attach part ⑬ (magnet) to B panel.

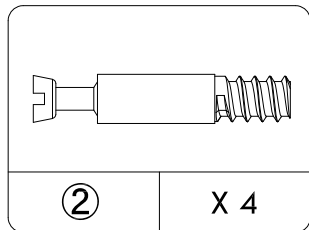
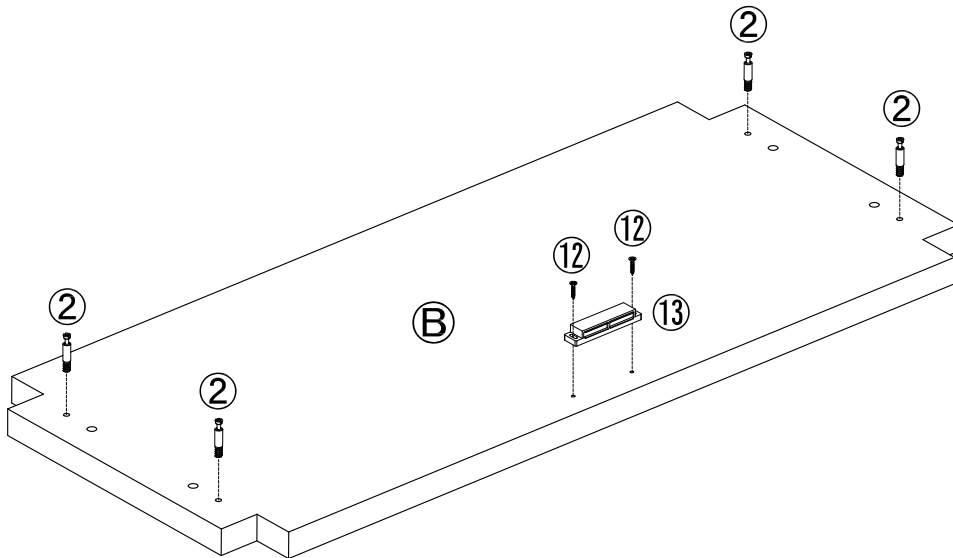
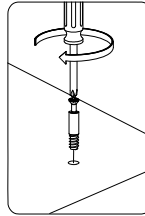

Cam bolt

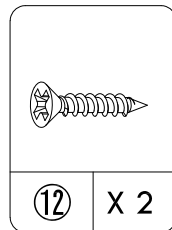

Screw #6

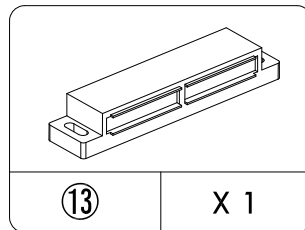

Magnet

2

Insert part ③ (dowels) into side frames F & G.
Screw part ② (cam bolts) into side frames F & G.

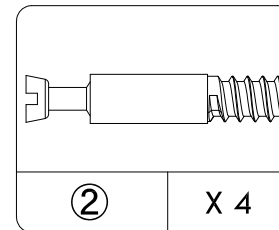
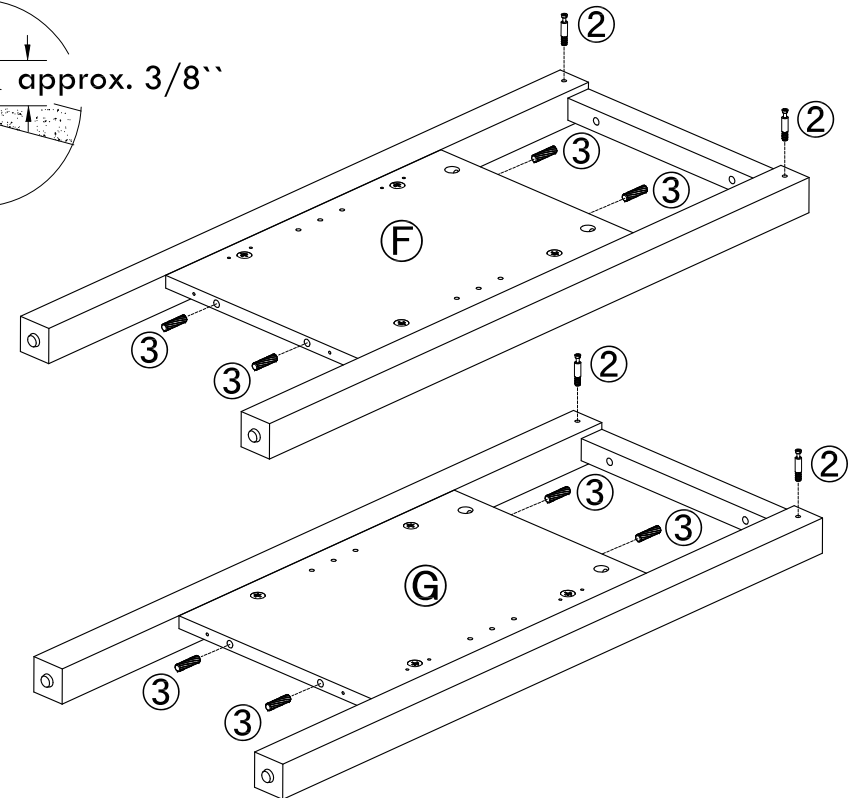
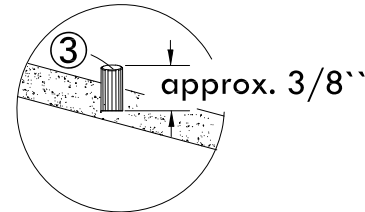

Cam bolt

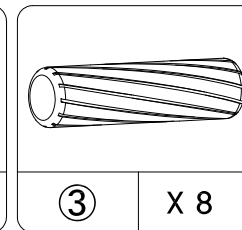

Wood dowel

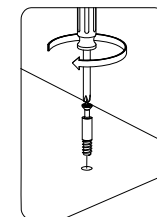

3

Use part ⑪ (screw #5) to attach part ⑩ (magnet strikes) to H & I panels.
 Use part ⑧ (screw #4) to attach part ⑭ (handles) to H & I panels.
 Use part ⑥ (screw #3) to attach part ⑮ (hinges) to H & I panels.

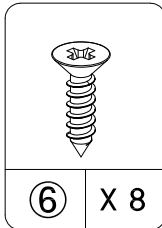
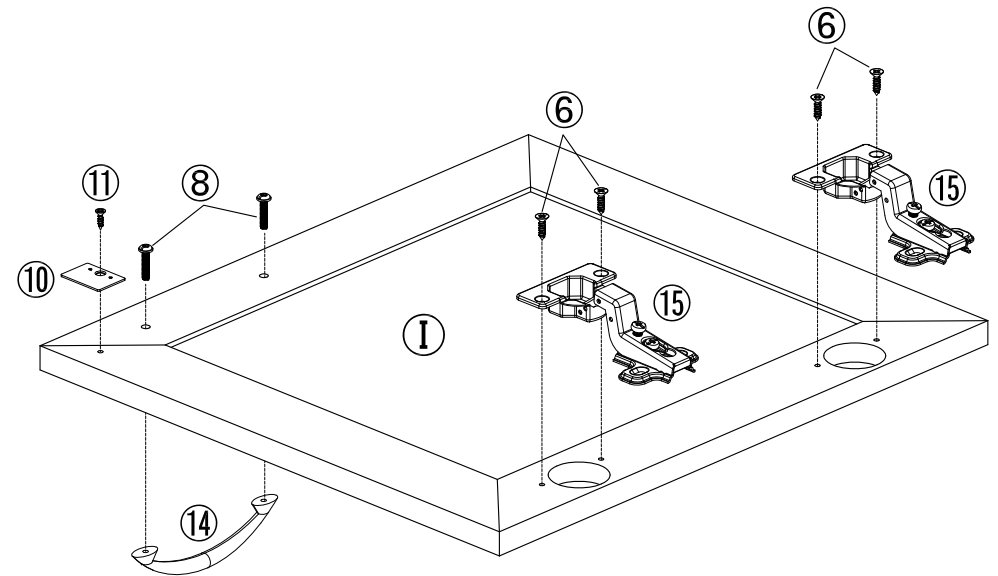
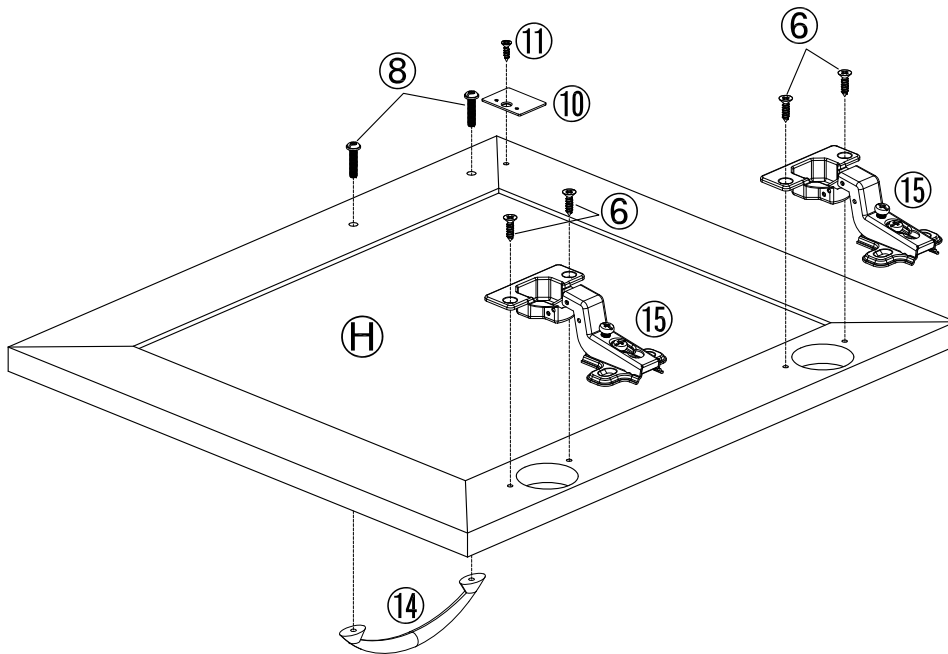
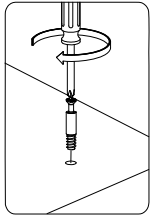

Screw #3

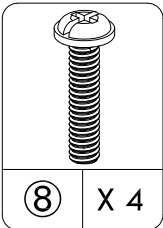

Screw #4

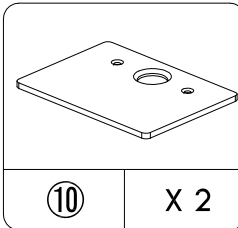

Magnet strike

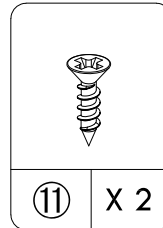

Screw #5

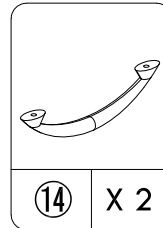

Handle

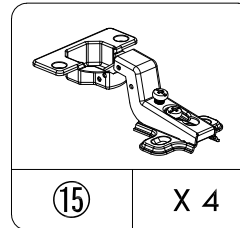

Hinges

4

Connect B panel to side frame F, insert part ① (cam locks) into side frame F and tighten cam locks ①.

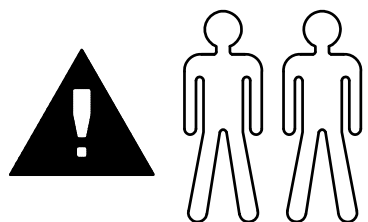
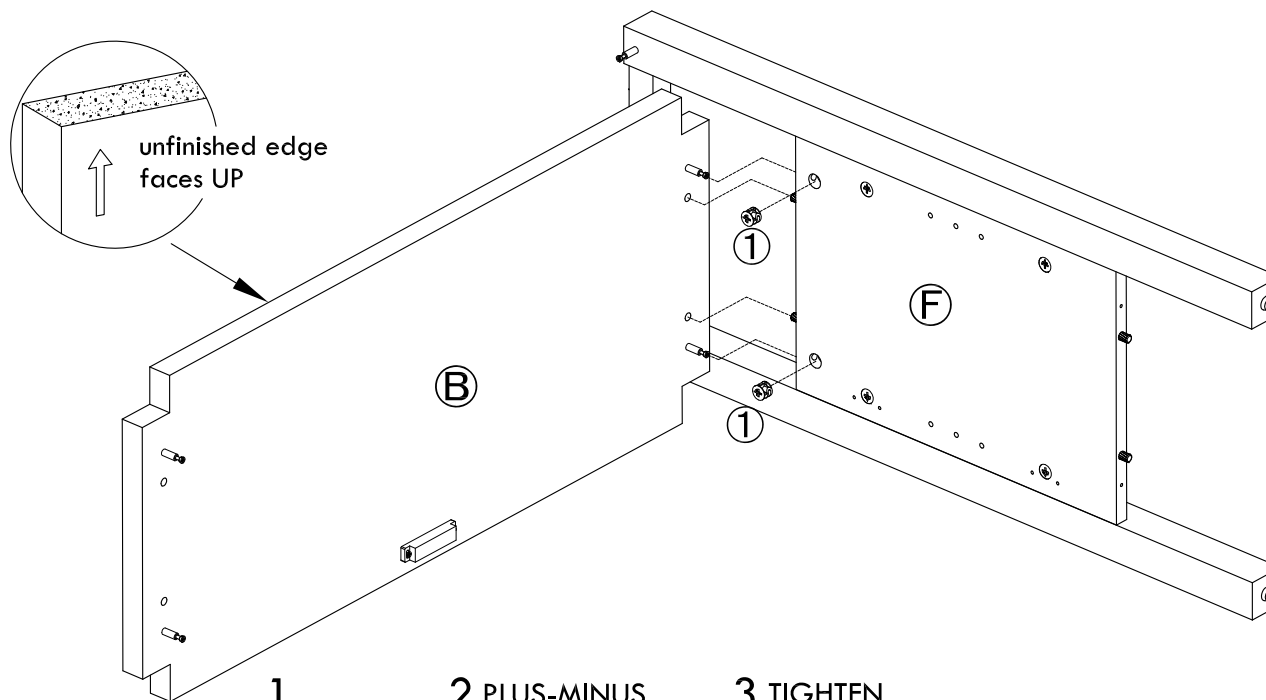
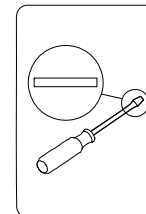

2 PEOPLE ARE NEEDED TO COMPLETE THIS STEP

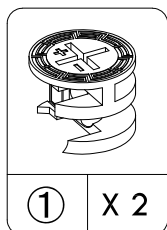

Cam lock

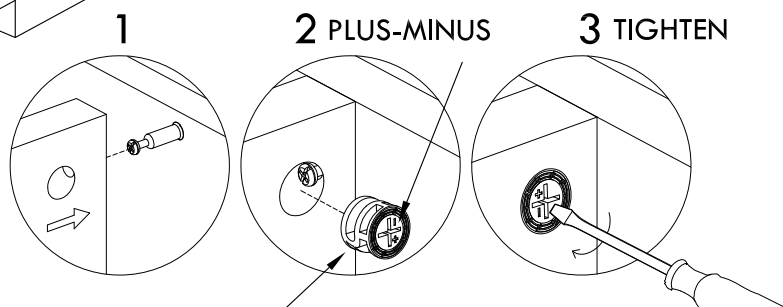

INSERT CAM LOCK FULLY INTO HOLE WITH PLUS-MINUS SYMBOLS FACING PREDRILLED HOLE IN EDGE OF PANEL

ROTATE CAM LOCK CLOCKWISE 180° TO SECURELY FASTEN

REFER TO PAGE 5 FOR ADDITIONAL INSTRUCTIONS ON CAM FASTENING SYSTEM

5

Connect E rails to side frame F, insert part ① (cam locks) into E rails and tighten cam locks ①.

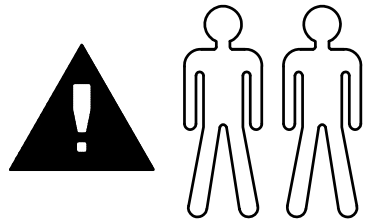
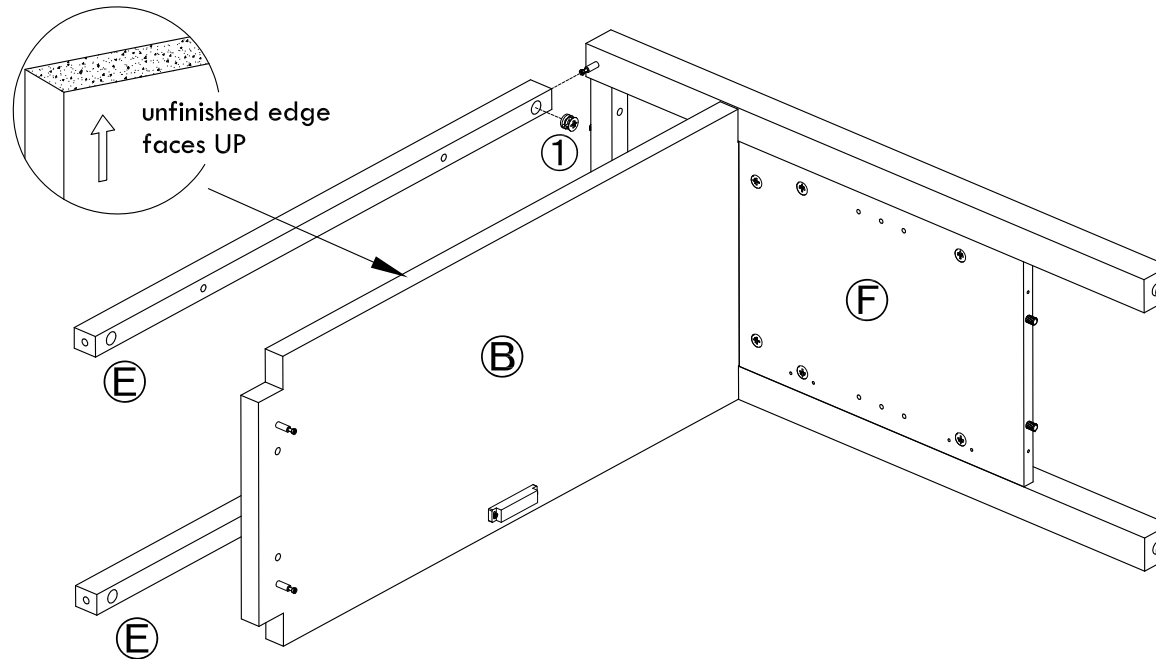
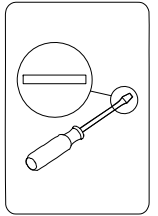

2 PEOPLE ARE NEEDED TO COMPLETE THIS STEP

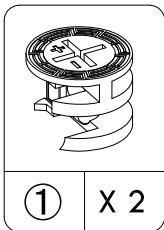

Cam lock

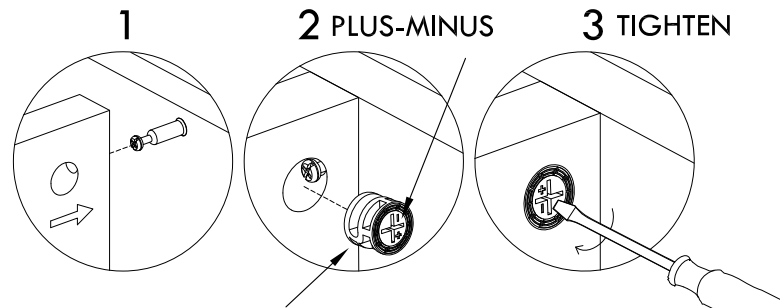

1 INSERT CAM LOCK FULLY INTO HOLE WITH PLUS-MINUS SYMBOLS FACING PREDRILLED HOLE IN EDGE OF PANEL

2 PLUS-MINUS
3 ROTATE CAM LOCK CLOCKWISE 180° TO SECURELY FASTEN

REFER TO PAGE 5 FOR ADDITIONAL INSTRUCTIONS ON CAM FASTENING SYSTEM

6

Connect side frame G to B panel and E rails, insert part ① (cam locks) into side frame G and tighten cam locks ①.

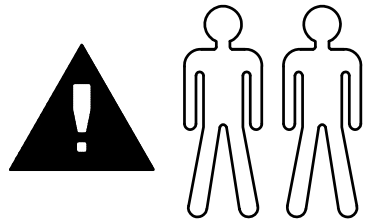
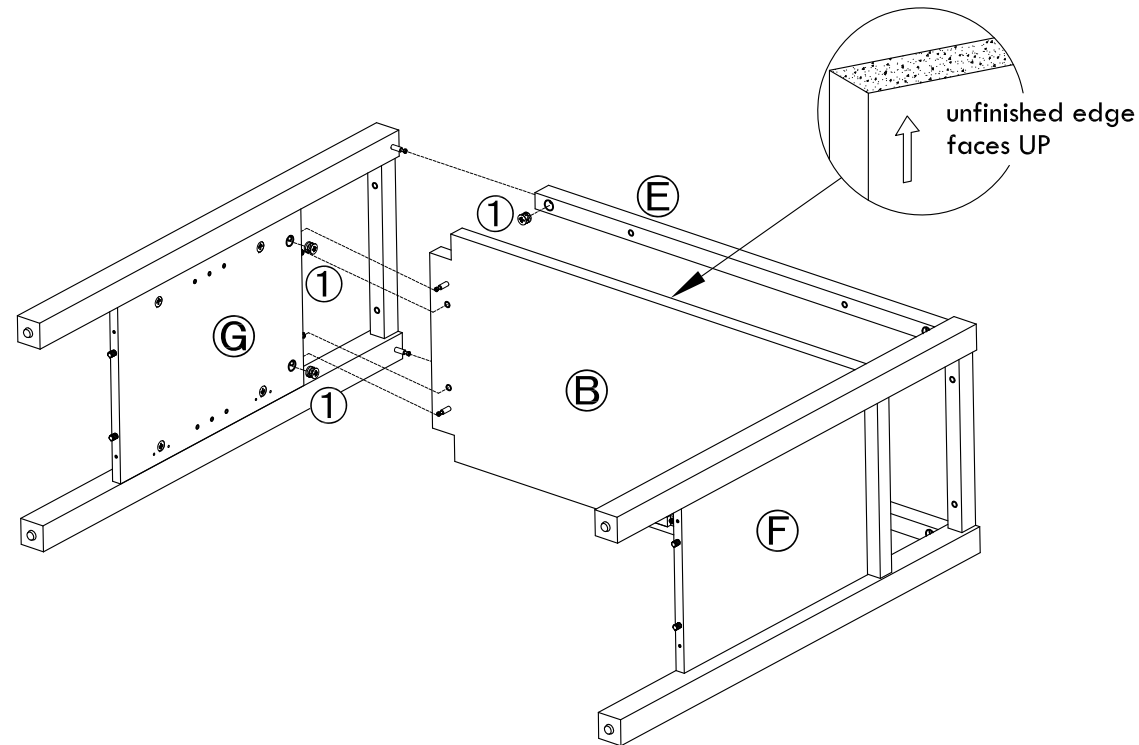
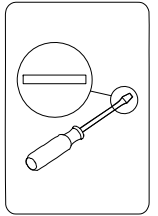

2 PEOPLE ARE NEEDED TO COMPLETE THIS STEP

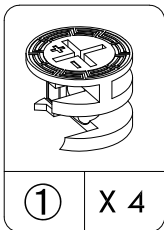

Cam lock

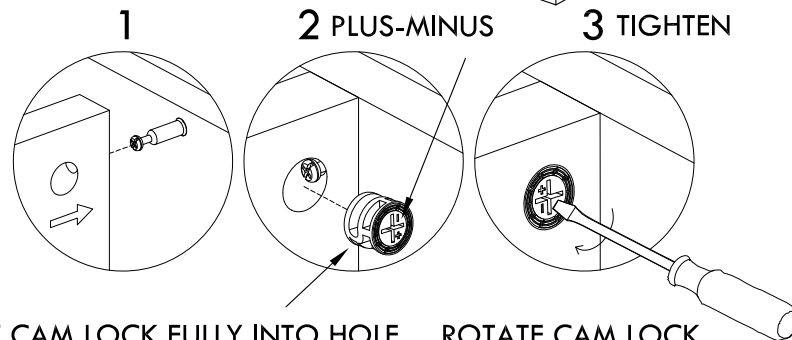

1
INSERT CAM LOCK FULLY INTO HOLE
WITH PLUS-MINUS SYMBOLS FACING
PREDRILLED HOLE IN EDGE OF PANEL

2 PLUS-MINUS
ROTATE CAM LOCK
CLOCKWISE 180° TO
SECURELY FASTEN

3 TIGHTEN
REFER TO PAGE 5 FOR
ADDITIONAL INSTRUCTIONS ON
CAM FASTENING SYSTEM

7

Use part ④ (screw #1) to attach C panel to side frames G & F.

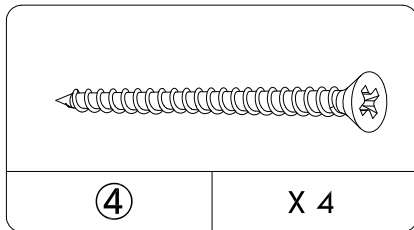
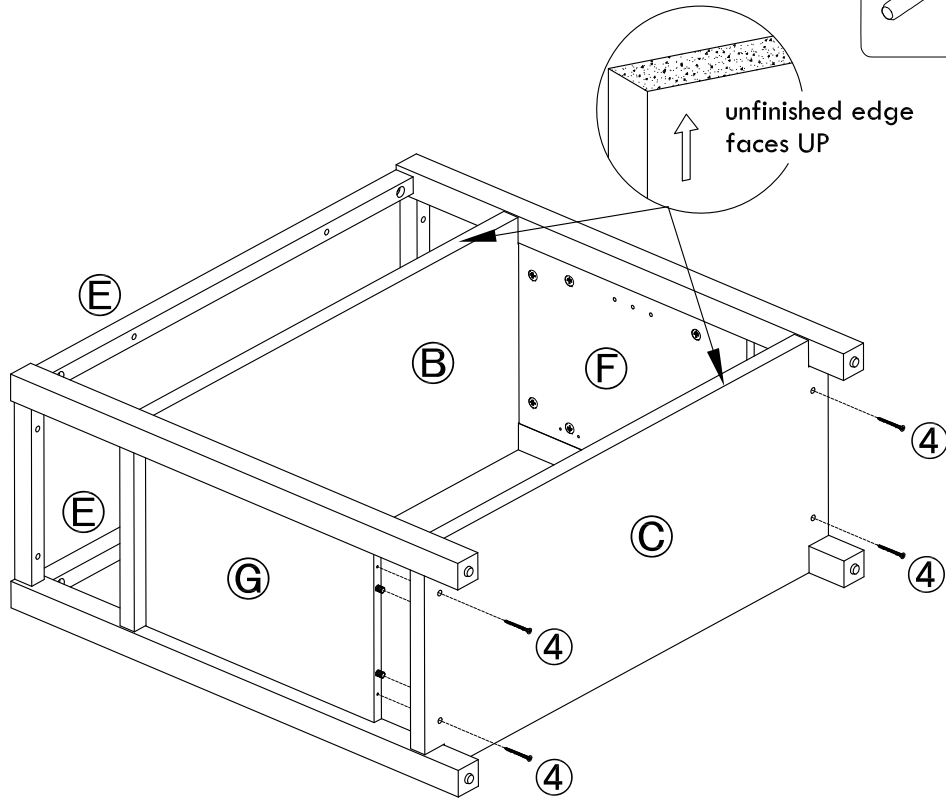
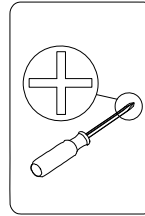

Screw #1

8

Align and attach back panel J to unit using part ⑨ (nails).

Note: To keep back panels aligned start by hammering one nail in each corner, then hammer in remaining nails.

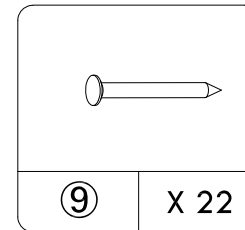
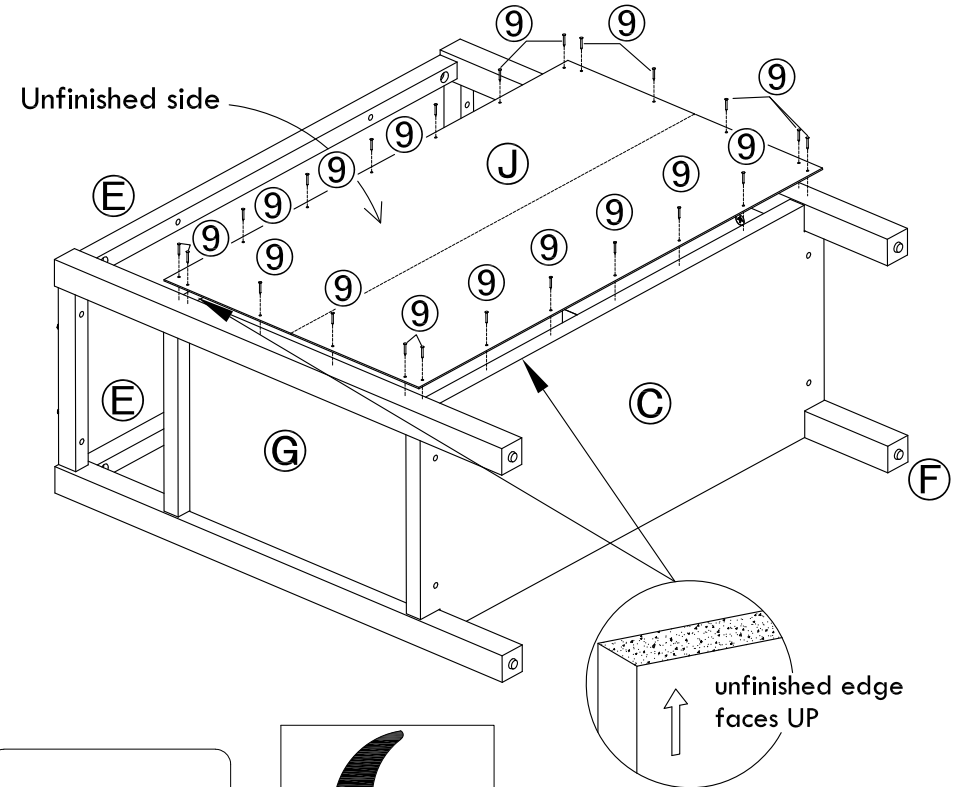

Nail

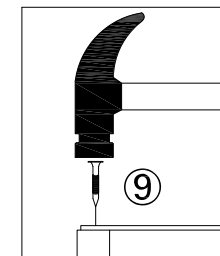

9

Insert part ③ (dowels) into E rails and side frames F & G.

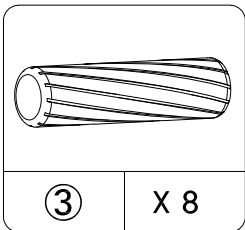
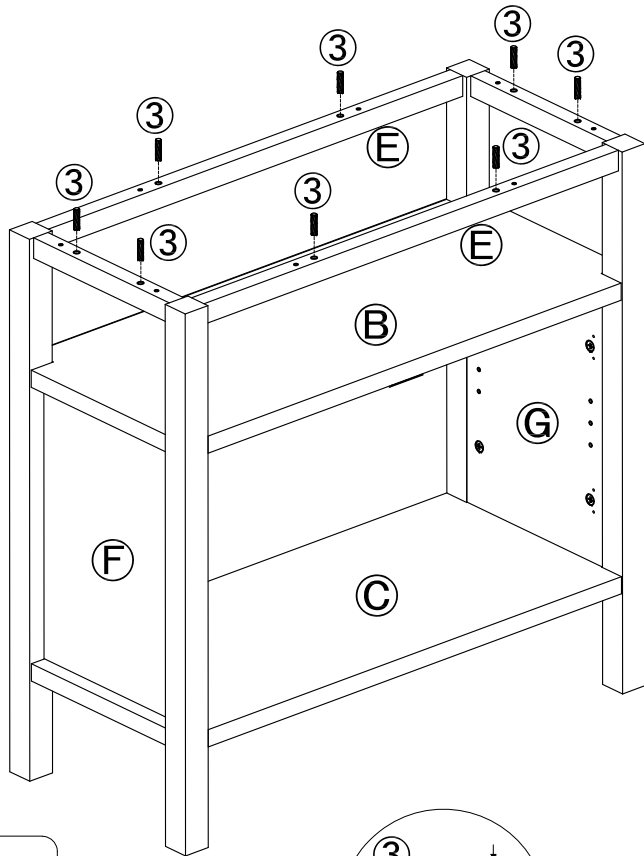

Wood dowel

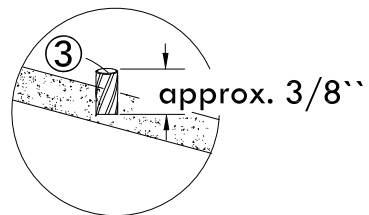

10

Use part ⑤ (screw #2) to attach A panel to structure.

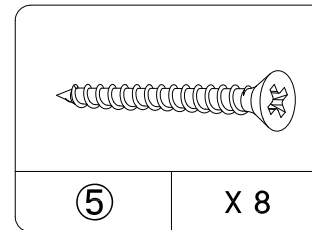
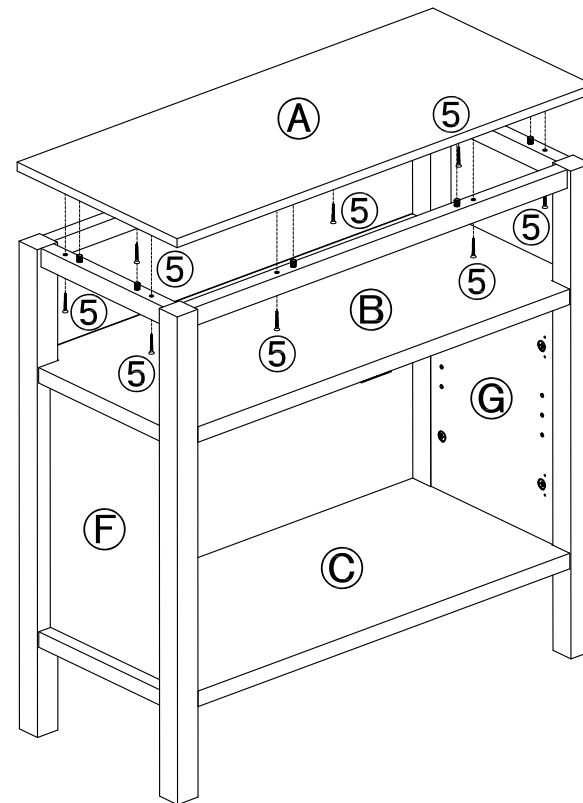

Screw #2

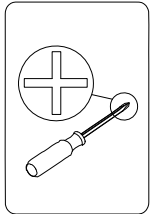

11

Insert part ⑦ (shelf supports) into side frames F & G at desired height, then install adjustable shelf D.

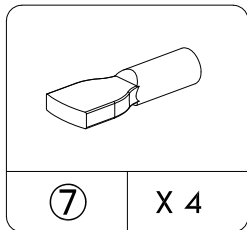
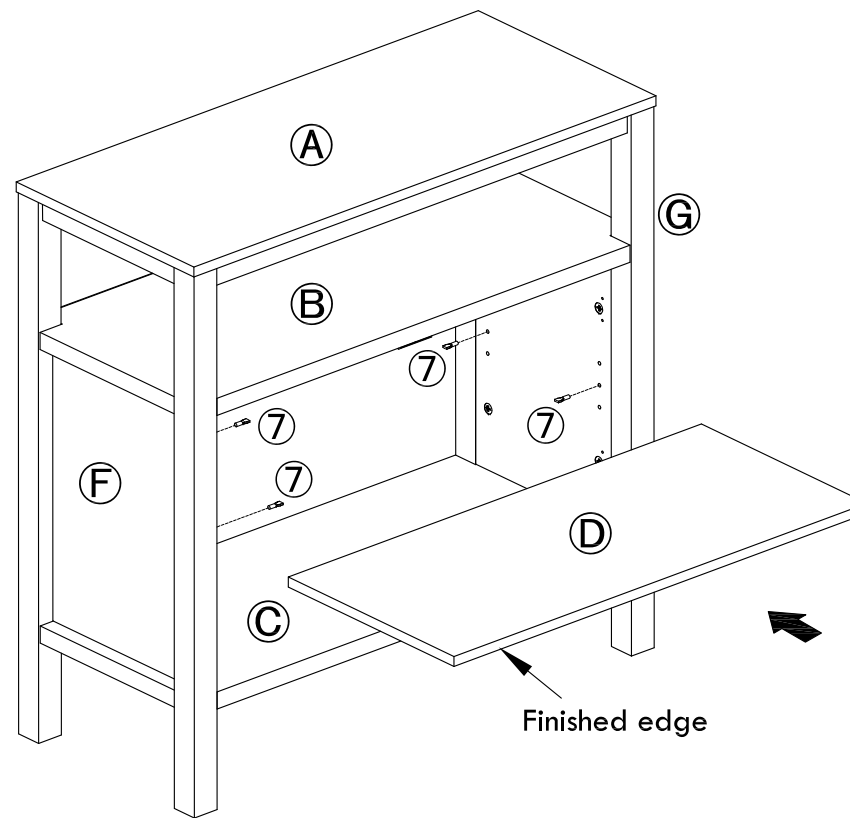

Shelf support

12

Use part ⑥ (screw #3) to attach door panel H to side frame F.
Use part ⑥ (screw #3) to attach door panel I to side frame G.

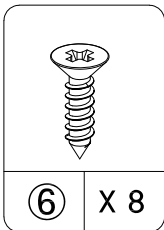
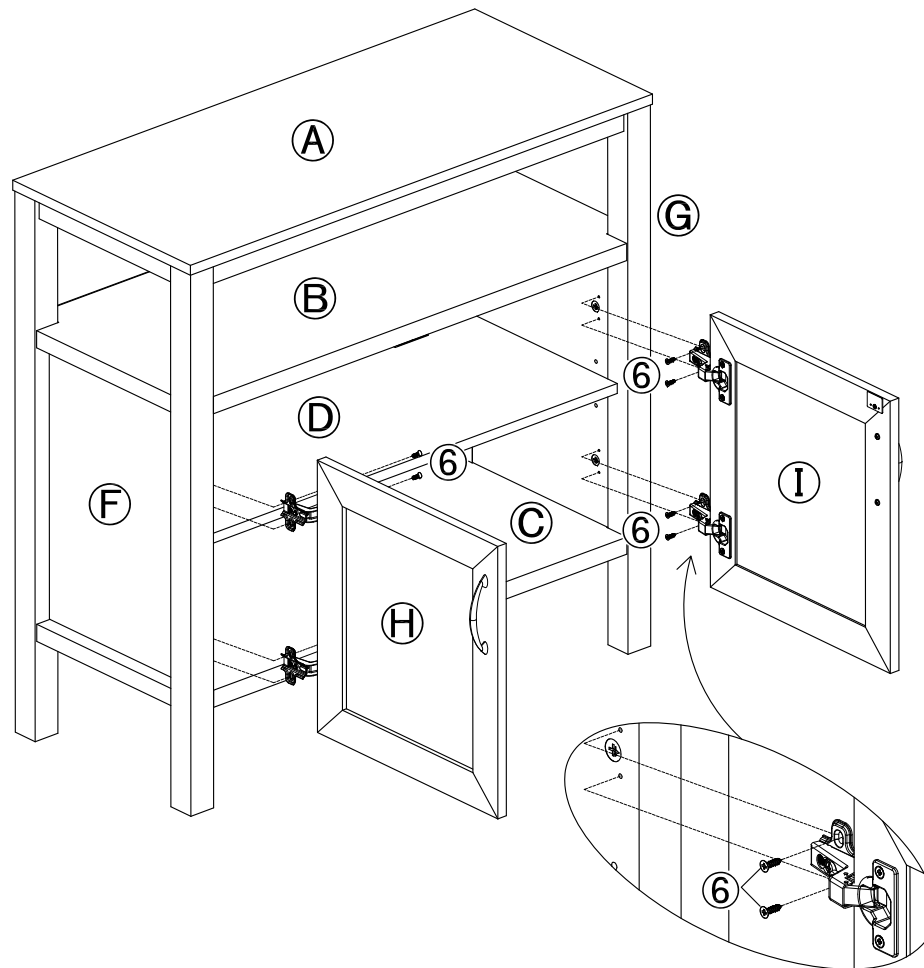
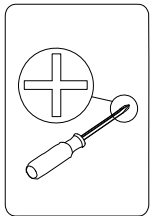

⑥ X 8

Screw #3

13

If necessary, adjust hinges to properly align doors as shown below, or scan the QR code to access an instructional video.

Door Hinge Adjustment Video

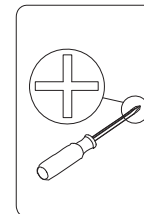
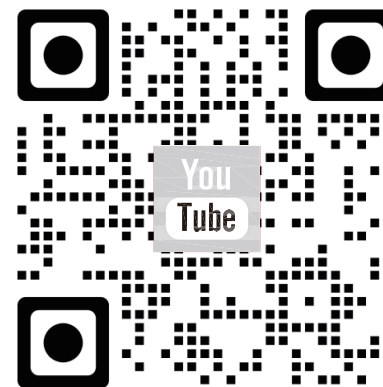

Adjusting possibilities

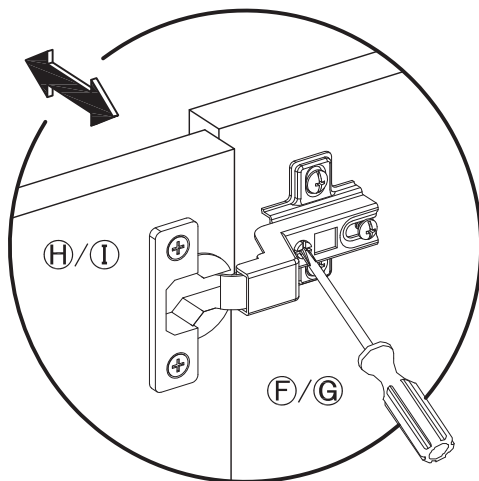

Lateral Adjustment

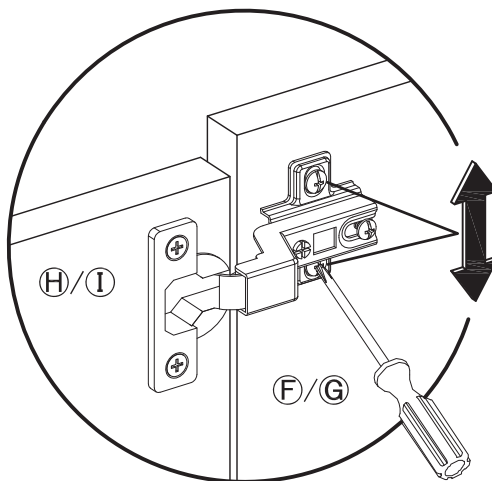

Vertical adjustment

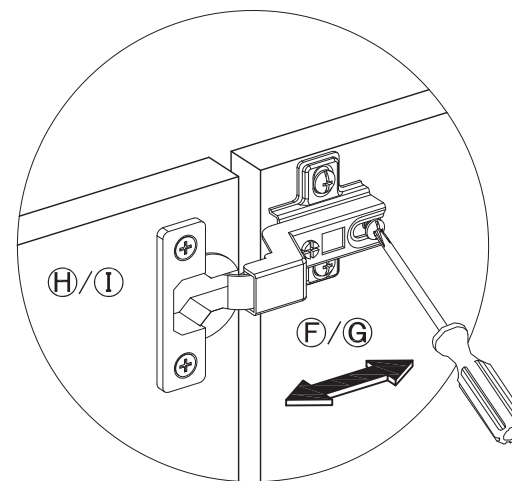

Forward/backwards adjustment

**CONGRATULATIONS, YOUR UNIT IS COMPLETE, PLEASE ENJOY
AND BE SURE TO TELL US ABOUT YOUR EXPERIENCE!**

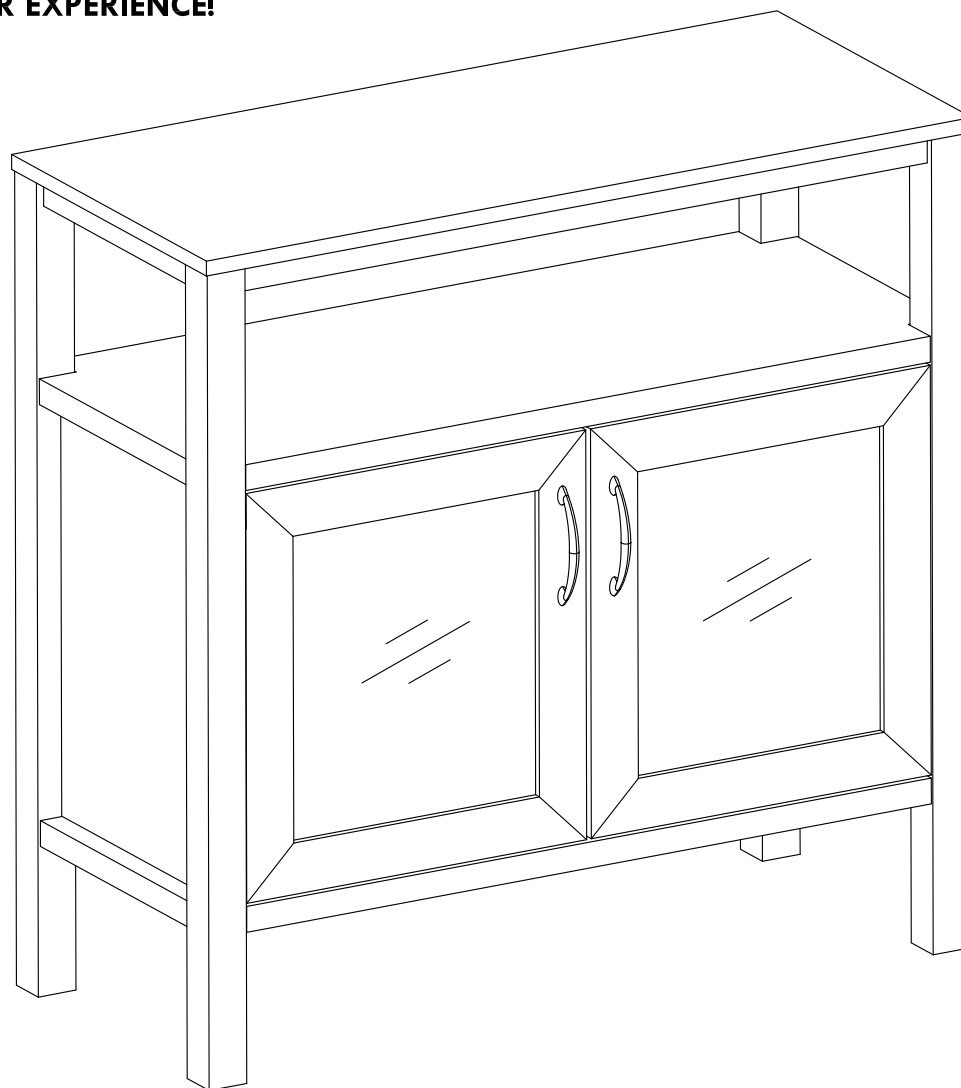

**Please call for replacement parts or assistance: 1-800-729-1569
Monday - Friday 9:00 am - 5:00 pm EST**

HOMETRENDS BUFFET DÉCORATIF

NUMÉRO D'INVENTAIRE DU FOURNISSEUR
HS201806-15-CHÊNE FONCÉ

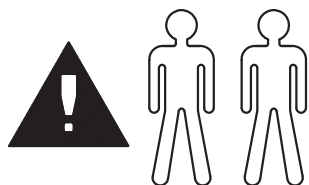

PANNEAU DU HAUT
CHARGE MAXIMALE
44 LB (20 KG)

PANNEAU D'ÉTAGÈRE
CHARGE MAXIMALE
55 LB (25 KG)

ÉTAGÈRE RÉGLABLE INTÉRIEURE
MAXIMUM LOAD
22 LB (10 KG)

PANNEAU DU FON
CHARGE MAXIMALE
55 LB (25 KG)

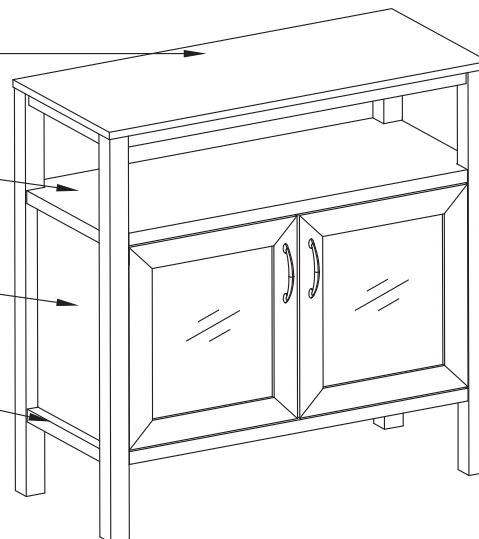

NOMBRE RECOMMANDÉ DE TRAVAILLEURS PAR ASSEMBLAGE: 2
TEMPS DE MONTAGE ESTIMÉ: 1 HEURE.

- COMPOSEZ NOTRE NUMÉRO SANS FRAIS **1-800-729-1569** POUR PLUS D'AIDE.
- DES PIÈCES SUPPLÉMENTAIRES SONT DISPONIBLES POUR UN FRAIS.
- CE MANUEL D'INSTRUCTION COMPREND DES INFORMATIONS DE SECURITE IMPORTANTES, LIRE ET BIEN GARDER POUR LA REFERENCE DANS LE FUTUR.
- IL EST INTERDIT DE FAIRE JOUER LES ENFANTS SUR LE PRODUIT.
- NETTOYEZ LE PRODUIT AVEC VOTRE VERNIS À MEUBLES PRÉFÉRÉ ET UN CHIFFON DOUX.
- N'UTILISEZ PAS DE PRODUITS CHIMIQUES DURS OU DE NETTOYANTS ABRASIFS.
- DÉPLACEZ SOIGNEUSEMENT VOS NOUVEAUX MEUBLES PAR DEUX TRAVAILLEURS.
NE PAS POUSSER OU TIRER L'UNITÉ.

**NE RENTREZ PAS LE PRODUIT A LA BOUTIQUE,
POUR DES PIÈCES DISPARITION OU ENDOMMAGÉES
APPEL 1-800-729-1569.
LES PIÈCES SERONT EXPÉDIÉES GRATUITEMENT.**

**POUR PROMPT, SERVICE FIABLE, S'IL VOUS PLAÎT
AVOIR VOTRE PRÊT MANUEL DE MONTAGE.**

NUMERO DE LOT _____
DATE D'ACHAT ____/____/____

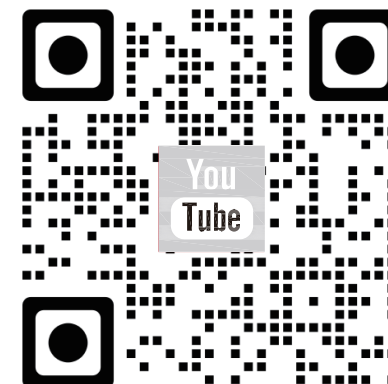

Ouvrez votre caméra et scannez
le code ci-dessus pour obtenir un
guide vidéo d'assemblage.

Huisen Furniture (Longnan) Co.,Ltd.
Conçu aux États-Unis
Fabriqué en Chine



Nous serons disponibles pour vous aider du lundi -
vendredi de 9:00 am - 5:00 pm (heure normale de l'Est).
1-800-729-1569

HOMETRENDS BUFFET DÉCORATIF

NUMÉRO D'INVENTAIRE DU FOURNISSEUR
HS201806-15-CHÊNE FONCÉ



AVANT DE COMMENCER

- Lisez attentivement toutes les étapes avant de commencer. Tout manquement à suivre les étapes peut entraîner des difficultés ou des dommages lors du montage.
- Travaillez dans une zone étendue, de préférence sur une surface recouverte de moquette, près de l'endroit où l'unité sera utilisée.
- Assurez-vous que toutes les pièces sont incluses. La plupart des cartes sont étiquetées avec un autocollant amovible.

ASTUCES UTILES

- Appelez notre numéro sans frais si vous avez besoin d'aide. Nous serons disponibles pour vous aider du lundi - vendredi de 9:00 am - 5:00 pm (heure normale de l'Est).
- **1-800-729-1569**
Ou soumettez une demande via notre portail libre-service sur www.huisenfurniture.zendesk.com

OUTILS NÉCESSAIRES POUR ASSEMBLER

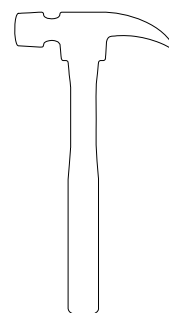

marteau



tournevis à
tête plate



tournevis
cruciforme



**N'UTILISEZ AUCUN OUTIL ÉLECTRIQUE
POUR ASSEMBLER VOS MEUBLES, CE QUI
POURRAIT ENDOMMAGER LES MEUBLE.**

Huisen Furniture (Longnan) Co.,Ltd.
Conçu aux États-Unis
Fabriqué en Chine



Nous serons disponibles pour vous aider du lundi -
vendredi de 9:00 am - 5:00 pm (heure normale de l'Est).
1-800-729-1569

HOMETRENDS BUFFET DÉCORATIF

NUMÉRO D'INVENTAIRE DU FOURNISSEUR
HS201806-15-CHÊNE FONCÉ

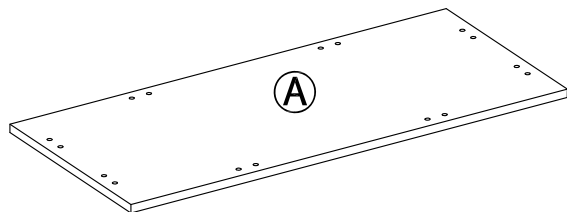

Panneau du haut
(Quantité: 1)

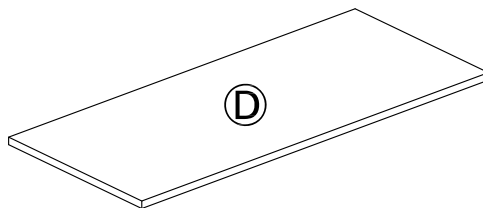

Étagère réglable
(Quantité: 1)

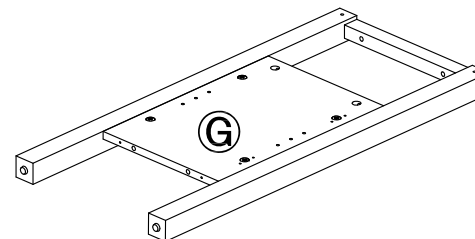

Cadre latéral droit
(Quantité: 1)

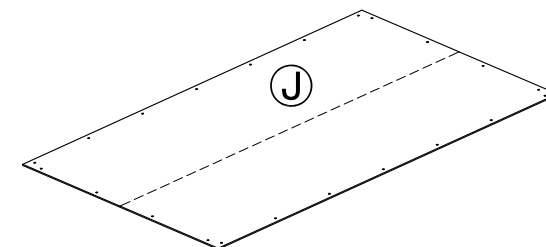

Panneau arrière
(Quantité: 1)

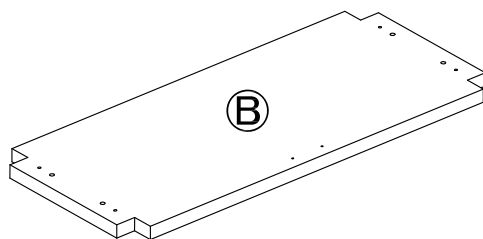

Panneau d'étagère
(Quantité: 1)

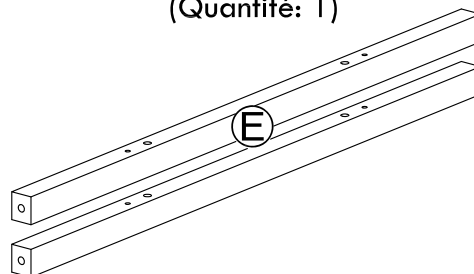

Chemin de fer supports
(Quantité: 2)

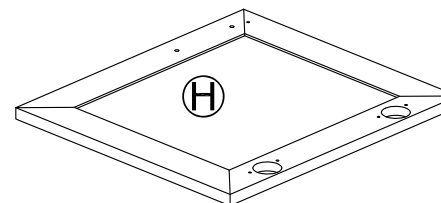

Panneau gauche portet
(Quantité: 1)

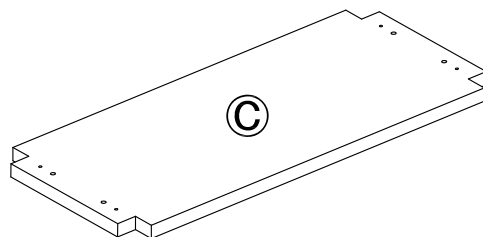

Panneau de fon
(Quantité: 1)

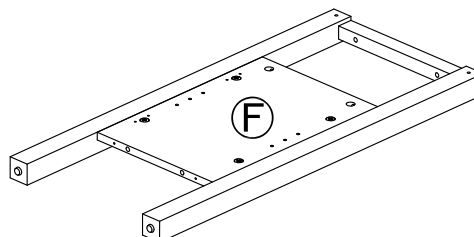

Cadre latéral gauche
(Quantité: 1)

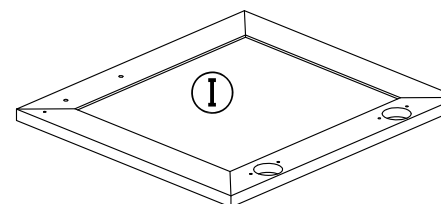

Panneau droit portet
(Quantité: 1)

**VÉRIFIEZ QUE TOUTES LES PIÈCES SONT LISTÉES AVANT
DE COMMENCER**



Nous serons disponibles pour vous aider du lundi -
vendredi de 9:00 am - 5:00 pm (heure normale de l'Est).
1-800-729-1569

HOMETRENDS BUFFET DÉCORATIF

NUMÉRO D'INVENTAIRE DU FOURNISSEUR
HS201806-15-CHÊNE FONCÉ

①



Serrure à came
Quantité: 8

②

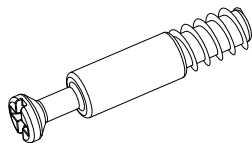

Boulon à came
Quantité: 8

③

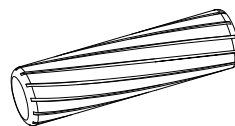

Cheville courte
Quantité: 16

④

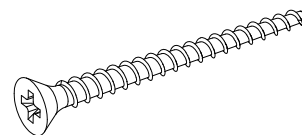

Vis #1
Quantité: 4

⑤

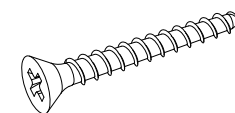

Vis #2
Quantité: 8

⑥

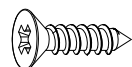

Vis #3
Quantité: 16

⑦

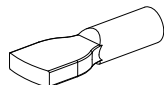

Support d'étagère
Quantité: 4

⑧

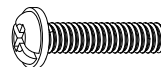

Vis 4
Quantité: 4

⑨

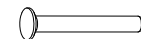

Clou
Quantité: 22

⑩

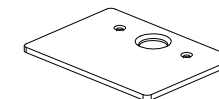

Gache d'aimant
Quantité: 2

⑪



Vis #5
Quantité: 2

⑫



Vis #6
Quantité: 2

⑬

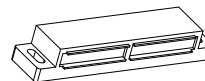

Mimant
Quantité: 1

⑭



Poignée
Quantité: 2

⑮

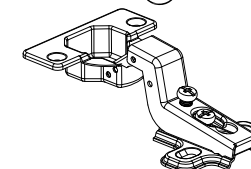

Charnières
Quantité: 4

**VÉRIFIEZ QUE TOUTES LES PIÈCES SONT LISTÉES AVANT
DE COMMENCER**



Nous serons disponibles pour vous aider du lundi -
vendredi de 9:00 am - 5:00 pm (heure normale de l'Est).
1-800-729-1569

HOMETRENDS BUFFET DÉCORATIF

NUMÉRO D'INVENTAIRE DU FOURNISSEUR
HS201806-15-CHÊNE FONCÉ

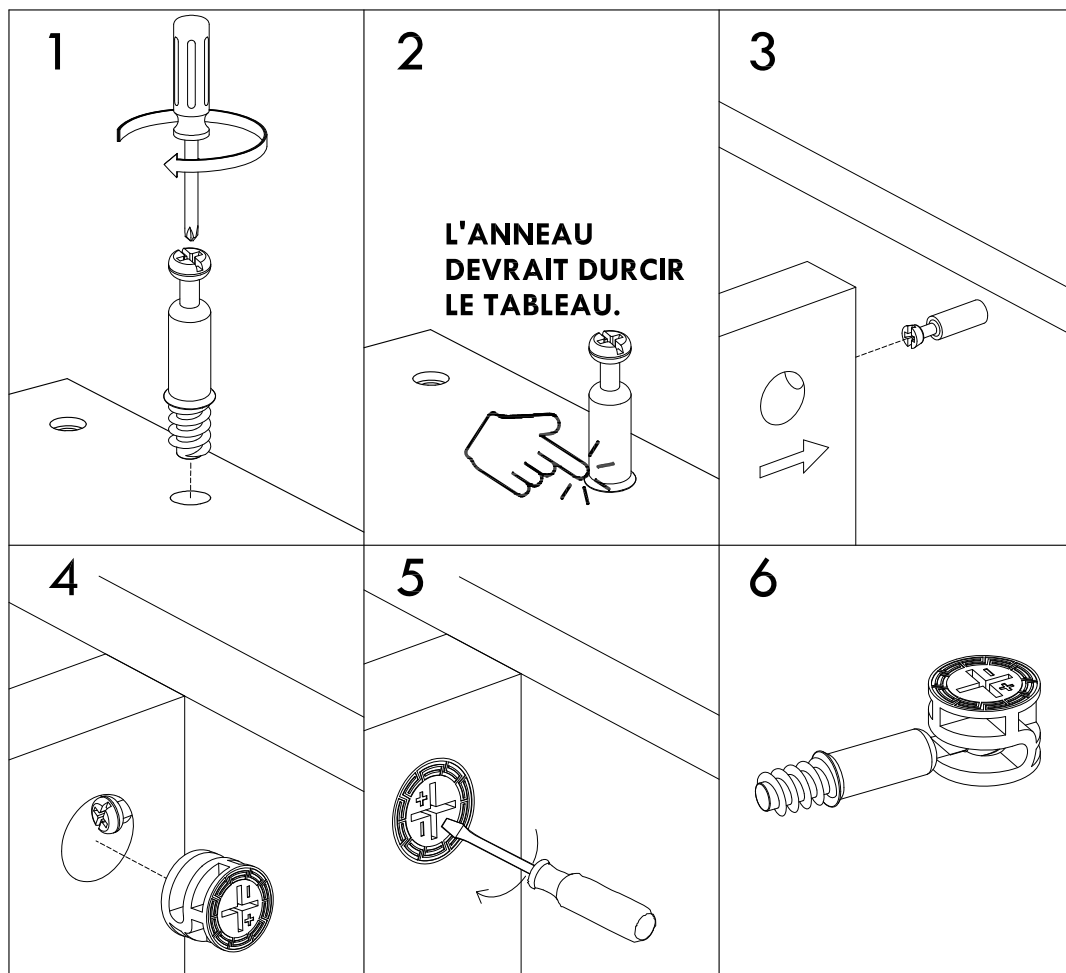

SYSTÈME DE FIXATION CAM

1. Vissez le **boulon à came** dans le panneau perforé. Vissez fermement pour vous assurer qu'il n'y a pas de filetage visible.
2. Le plus grand anneau du **serrure à came** doit toucher le panneau.
3. Insérez le **serrure à came** dans le trou pré-percé du panneau. Le signe plus + / moins - devrait faire face à l'extérieur du panneau.
4. Raccordez le **serrure à came** précédemment serré avec le panneau connecté à **boulon à came**.
5. Tournez **boulon à came** avec un tournevis à tête plate. Fixez **serrure à came** à mi-course dans le sens antihoraire.
6. **SI VOUS NE FIXEZ PAS CORRECTEMENT L'ÉCROU À CAME ET LE SERRURE À CAME, VOUS RISQUEZ DE PROVOQUER UNE INSTABILITÉ ET UNE DÉFAILLANCE DU PRODUIT.**

Huisen Furniture (Longnan) Co.,Ltd.
Conçu aux États-Unis
Fabriqué en Chine



Nous serons disponibles pour vous aider du lundi -
vendredi de 9:00 am - 5:00 pm (heure normale de l'Est).
1-800-729-1569

1

Visser la pièce ② (boulons à came) dans le panneau B.
Utilisez la pièce ⑫ (vis #6) pour fixer la pièce ⑬ (Mimant) au panneau B.

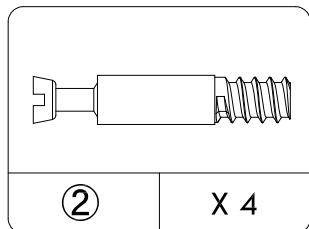
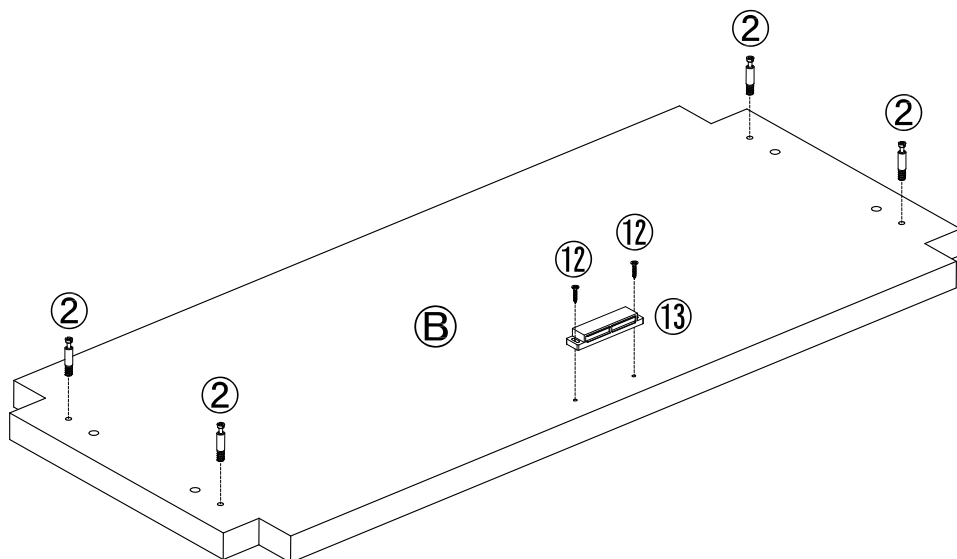
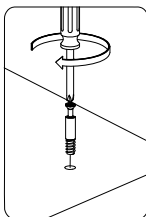

Boulon à came

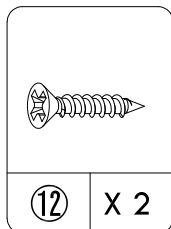

Vis #6

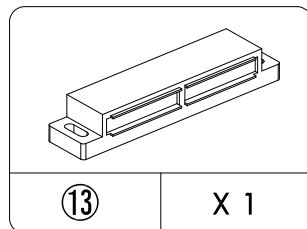

Mimant

2

Insérez la pièce ③ (cheville courte) dans les cadres latéraux F&G.
Visser la pièce ② (boulons à came) dans les cadres latéraux F&G.

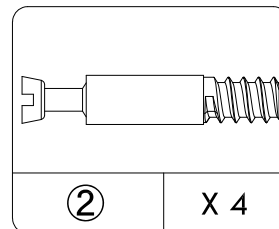
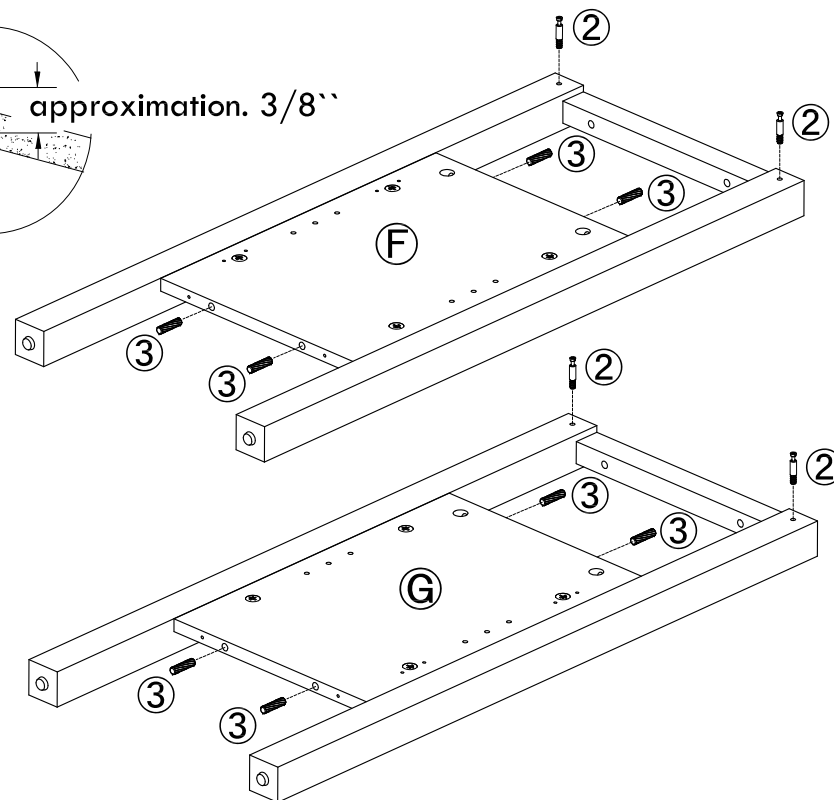
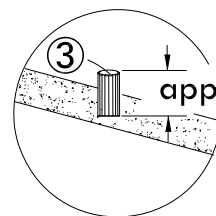

Boulon à came

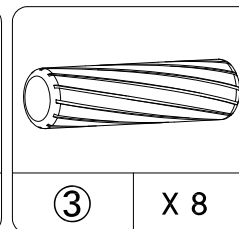

Cheville courte

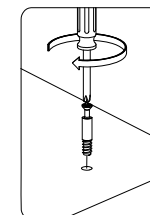

3

Utilisez la pièce ⑪ (vis #5) pour fixer la pièce ⑩ (gache d'aimant) aux panneaux H & I.
Utilisez la pièce ⑧ (vis #4) pour fixer la pièce ⑭ (poignées) aux panneaux H & I.
Utilisez la pièce ⑥ (vis #3) pour fixer la pièce ⑮ (charnières) aux panneaux H & I.

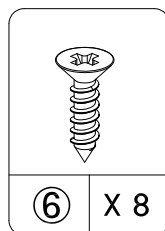
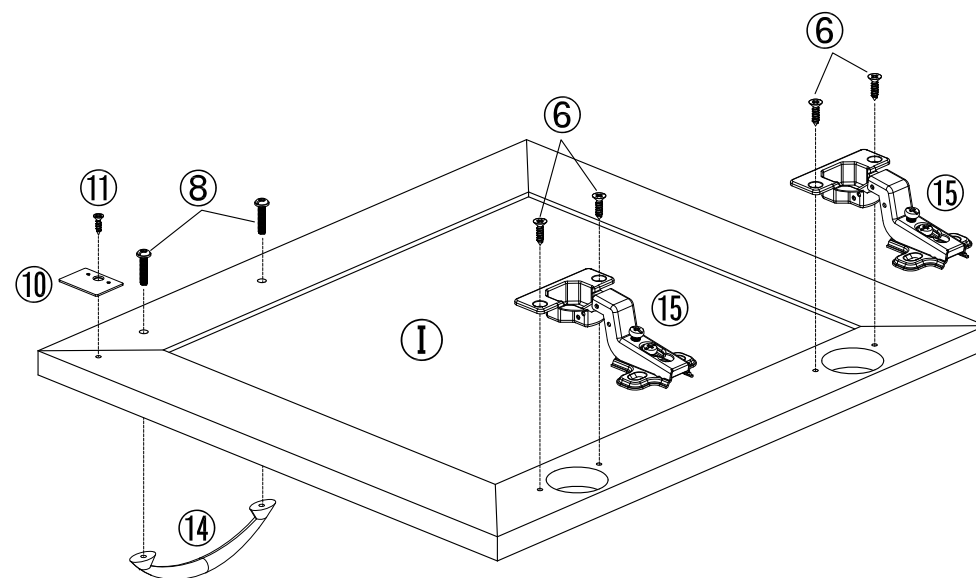
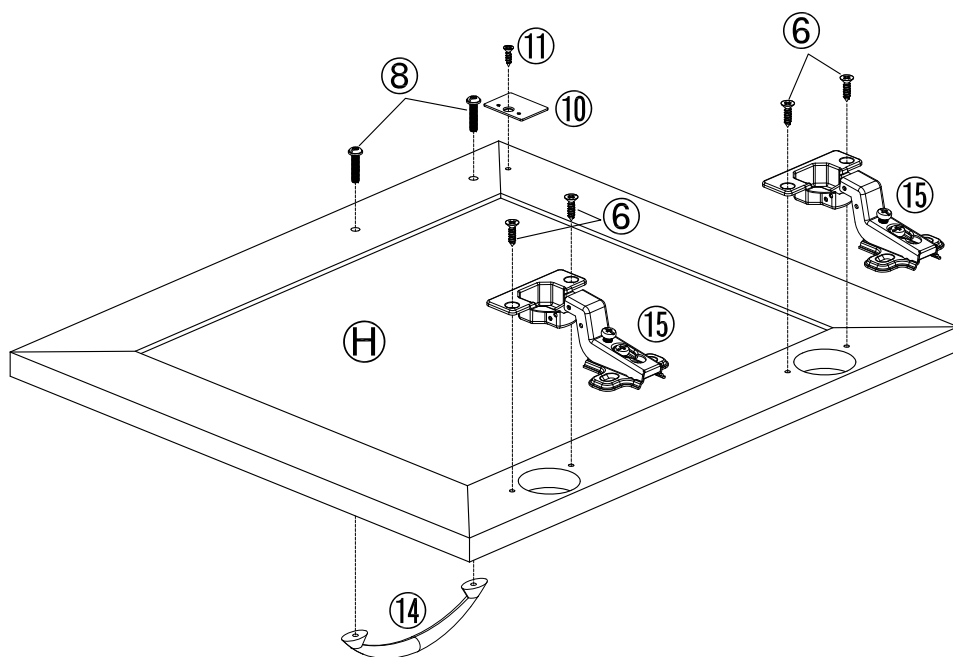
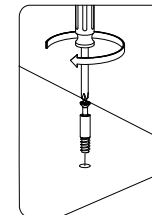

Vis #3

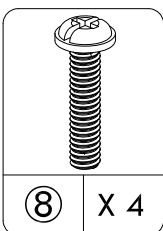

Vis #4

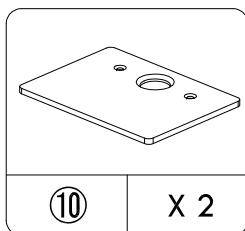

Gache d'aimant

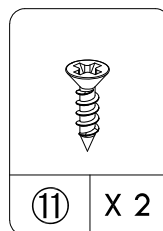

Vis #5

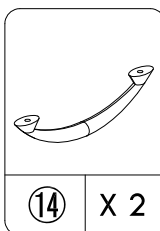

Poignée

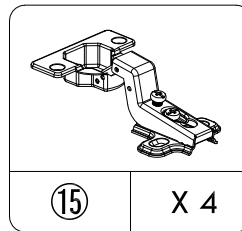

Charnières

4

Connectez le panneau B au cadre latéral F, insérez la pièce ① (serrures à cames) dans le cadre latéral F et serrez les serrures à cames ①.

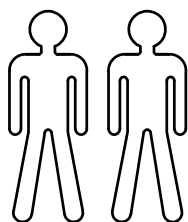
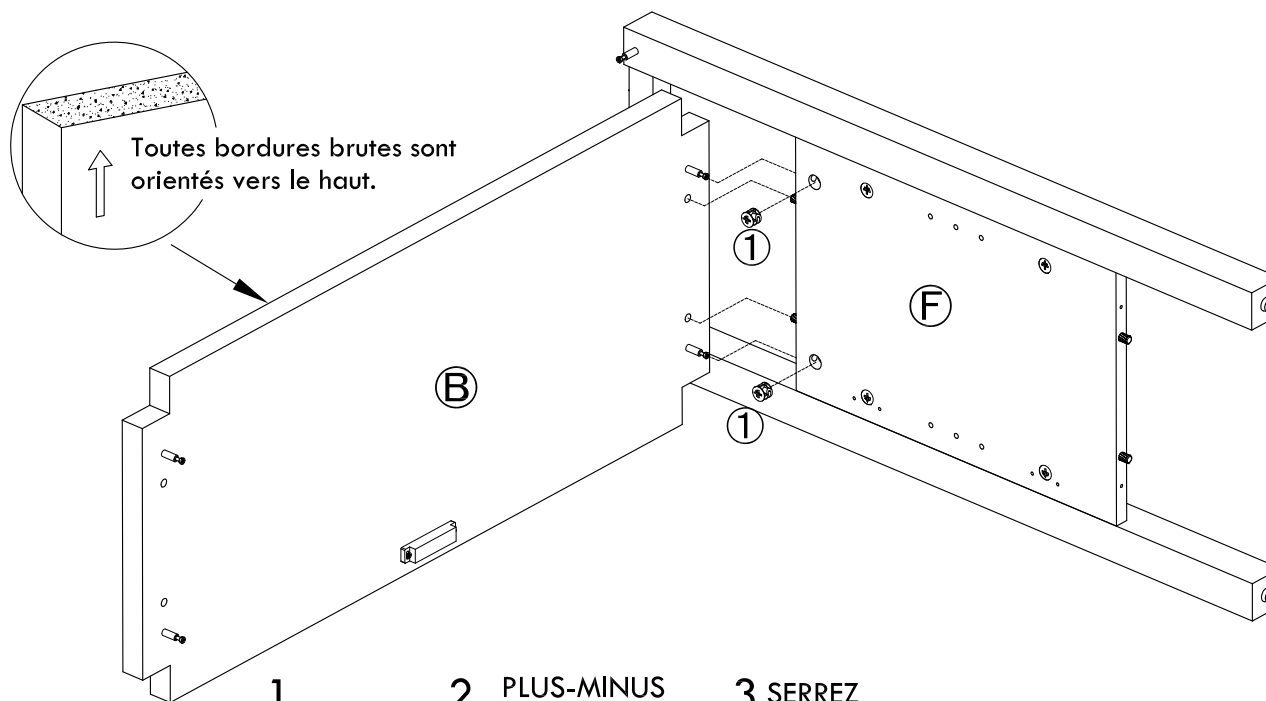
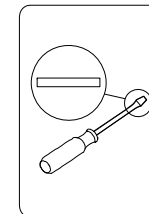

2 PERSONNES SONT NÉCESSAIRES
POUR RÉALISER CETTE ÉTAPE.

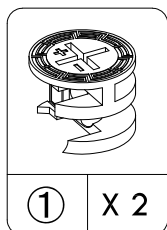

Serrure à came

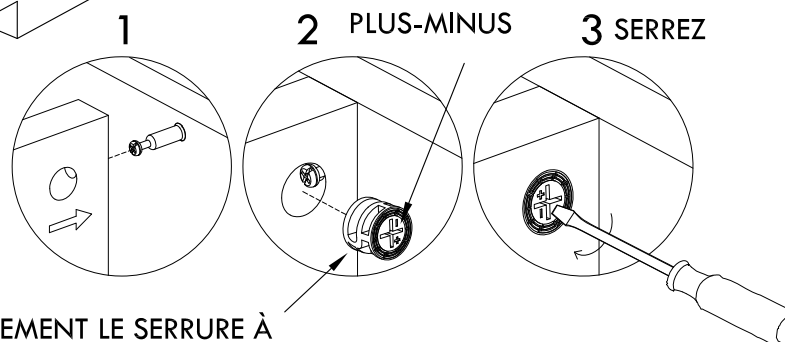

INSÉREZ COMPLÈTEMENT LE SERRURE À
CAME DANS LE TROU AVEC LES
SYMBLES PLUS-MOINS FACE AU TROU
PRÉ-PERCÉ DANS LE BORD DU PANNEAU.

FAITES PIVOTER LE SERROU À CAME DANS
LE SENS DES AIGUILLES D'UNE MONTRE DE
180 POUR LE FIXER SOLIDEMENT.

POUR PLUS DE DÉTAILS SUR LE
SYSTÈME DE FIXATION À CAME,
RÉFÉREZ-VOUS À LA PAGE 5

5

Connectez les rails E au cadre latéral F, insérez les verrous à came de la pièce ① (serrures à cames) dans les rails E et serrez les serrures à cames ①.

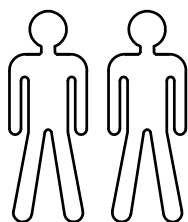
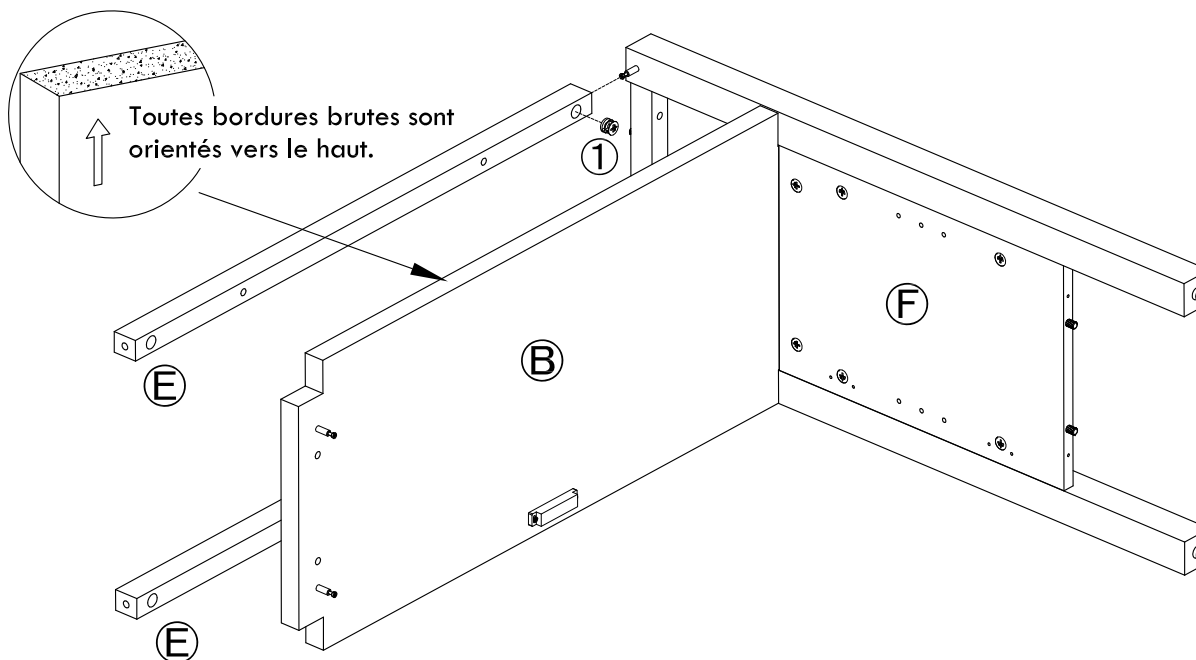
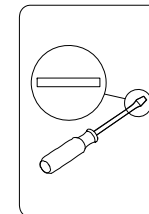

2 PERSONNES SONT NÉCESSAIRES
POUR RÉALISER CETTE ÉTAPE.

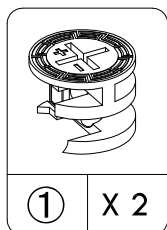

Serrure à came

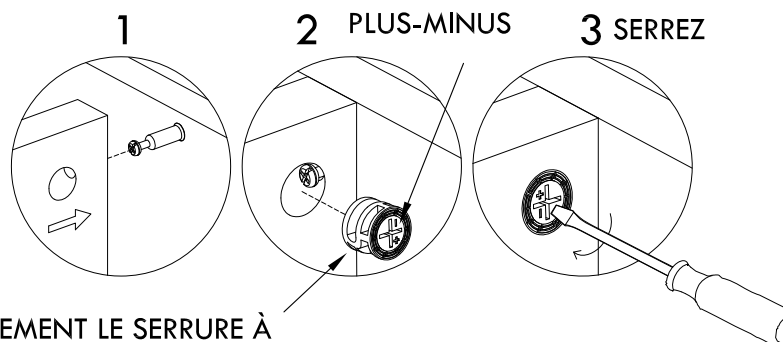

INSÉREZ COMPLÈTEMENT LE SERRURE À
CAME DANS LE TROU AVEC LES
SYMBOLES PLUS-MOINS FACE AU TROU
PRÉ-PERCÉ DANS LE BORD DU PANNEAU.

FAITES PIVOTER LE SERROU À CAME DANS
LE SENS DES AIGUILLES D'UNE MONTRE DE
180° POUR LE FIXER SOLIDEMENT.

POUR PLUS DE DÉTAILS SUR LE
SYSTÈME DE FIXATION À CAME,
RÉFÉREZ-VOUS À LA PAGE 5

6

Connectez le cadre latéral G au panneau B et aux rails E, insérez les de la partie ① (serrures à cames) dans le cadre latéral G et serrez les serrures à cames ①.

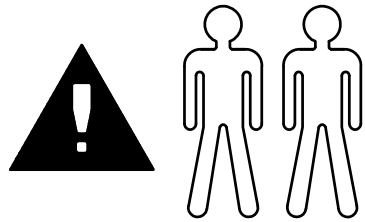
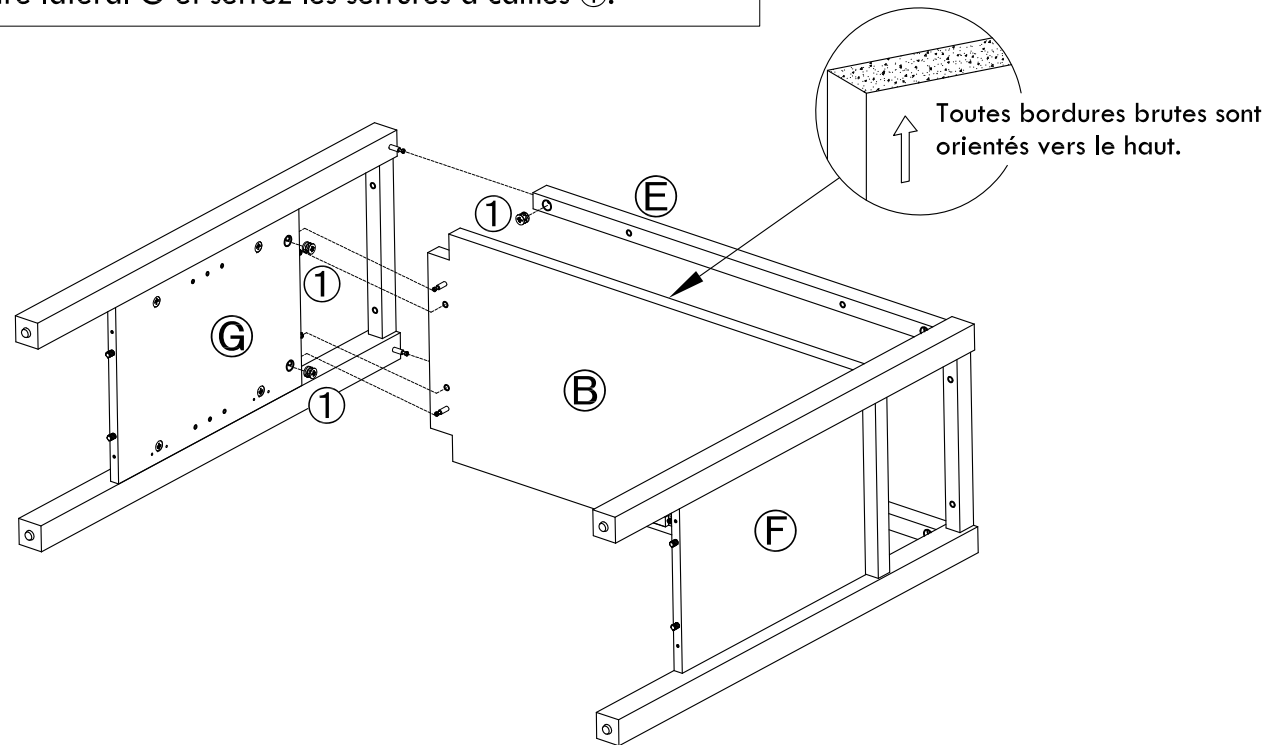
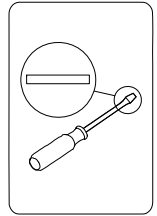

2 PERSONNES SONT NÉCESSAIRES
POUR RÉALISER CETTE ÉTAPE.

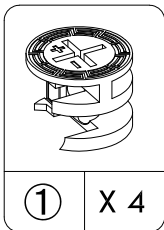

Serrure à came

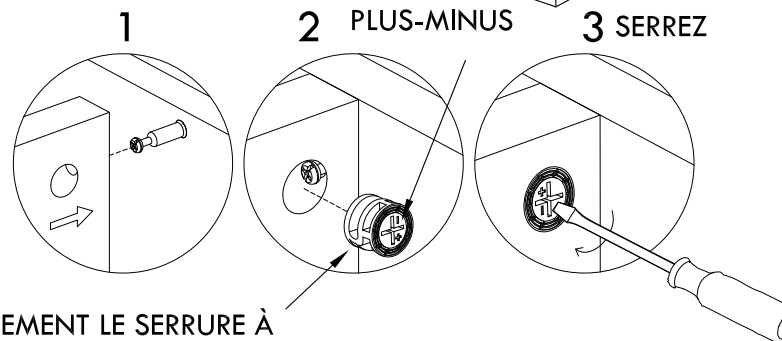

INSÉREZ COMPLÈTEMENT LE SERRURE À
CAME DANS LE TROU AVEC LES
SYMBOLES PLUS-MOINS FACE AU TROU
PRÉ-PERCÉ DANS LE BORD DU PANNEAU.

FAITES PIVOTER LE SERROU À CAME DANS
LE SENS DES AIGUILLES D'UNE MONTRE DE
180 POUR LE FIXER SOLIDEMENT.

POUR PLUS DE DÉTAILS SUR LE
SYSTÈME DE FIXATION À CAME,
RÉFÉREZ-VOUS À LA PAGE 5

7

Utilisez la pièce ④ (vis #1) pour fixer le panneau C aux cadres latéraux G et F.

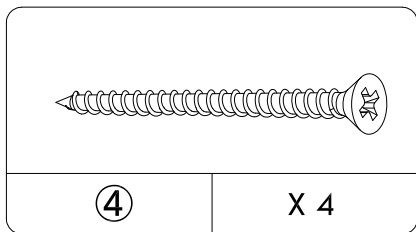
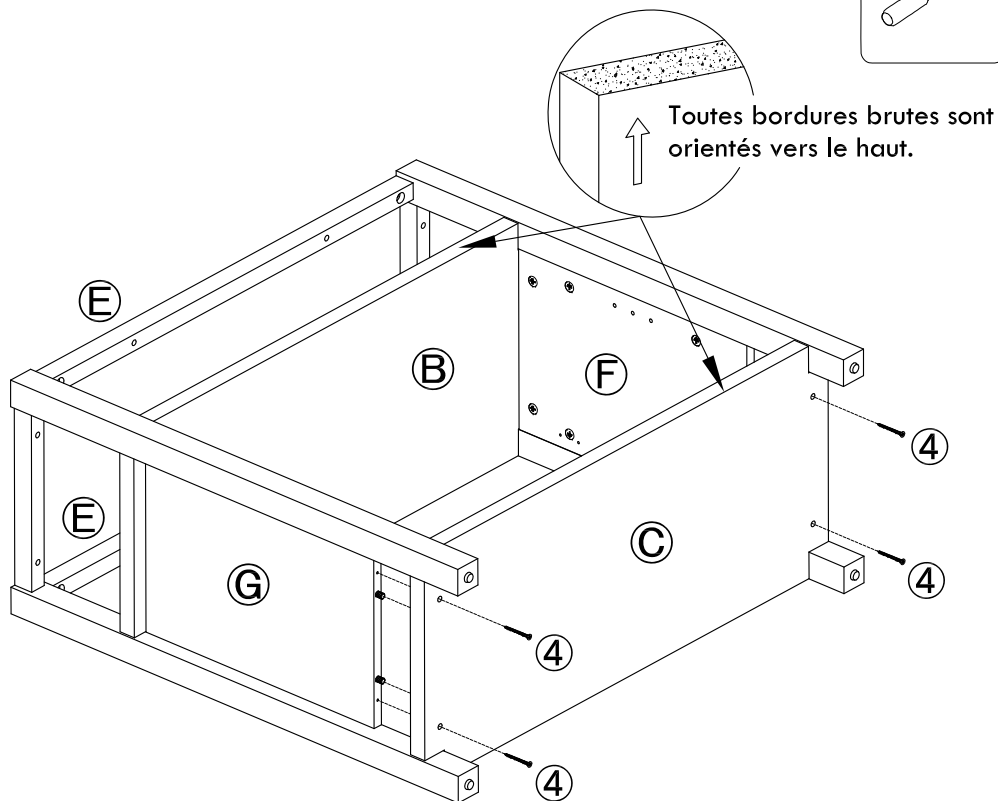
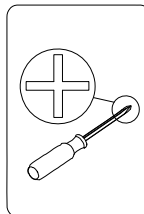

Vis #1

8

Alignez et fixez le panneau arrière J à l'unité à l'aide de la pièce ⑨ (clous).

Remarque: Pour garder le panneau arrière aligné, clouez d'abord un clou à chaque coin, puis clouez les clous restants.

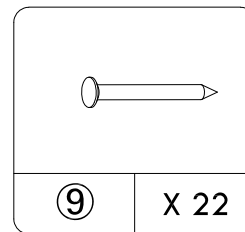
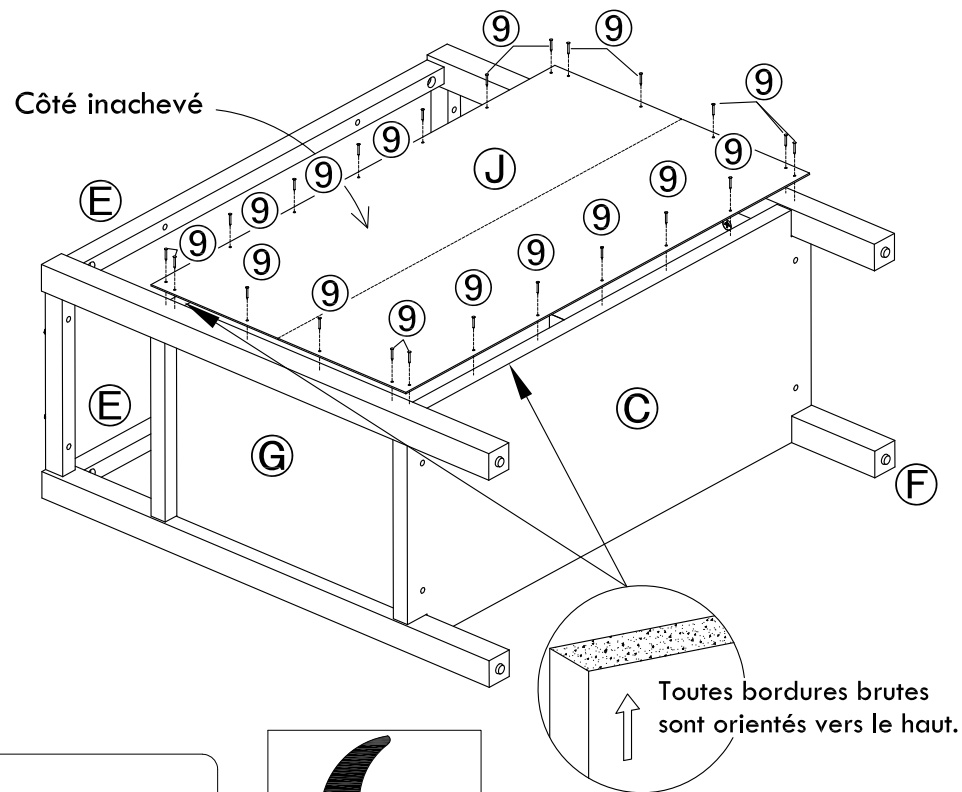

Clou

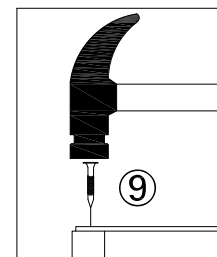

9

Insérez la pièce ③ (cheville courte) dans les rails E et les cadres latéraux F et G.

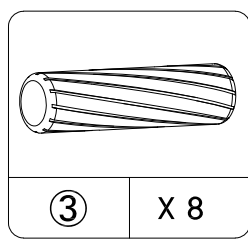
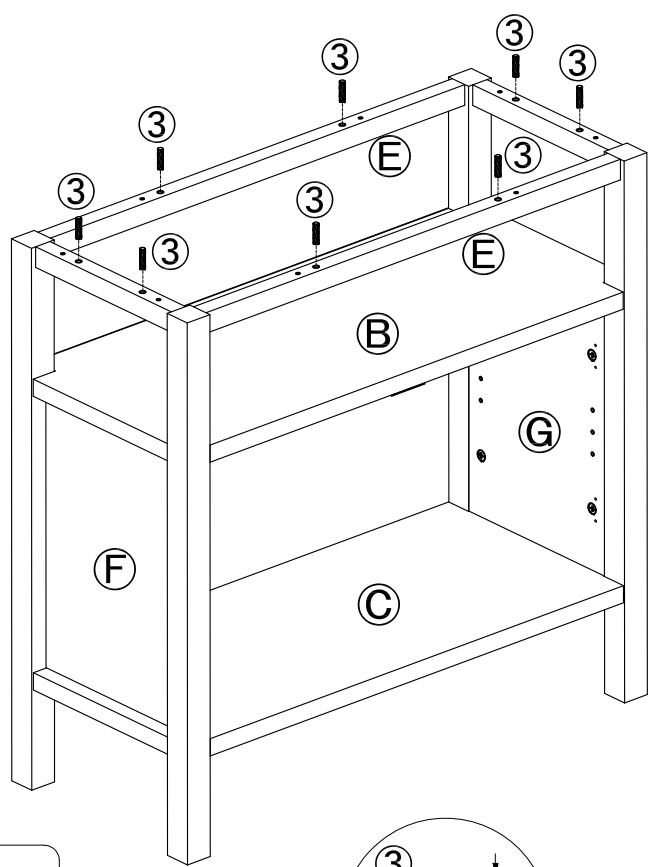

Cheville courte

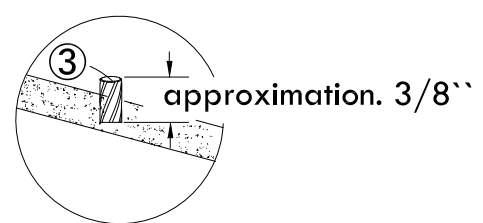

10

Utilisez la pièce ⑤ (vis #2) pour fixer le panneau A à la structure.

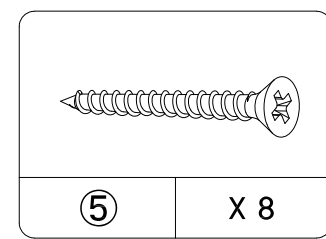
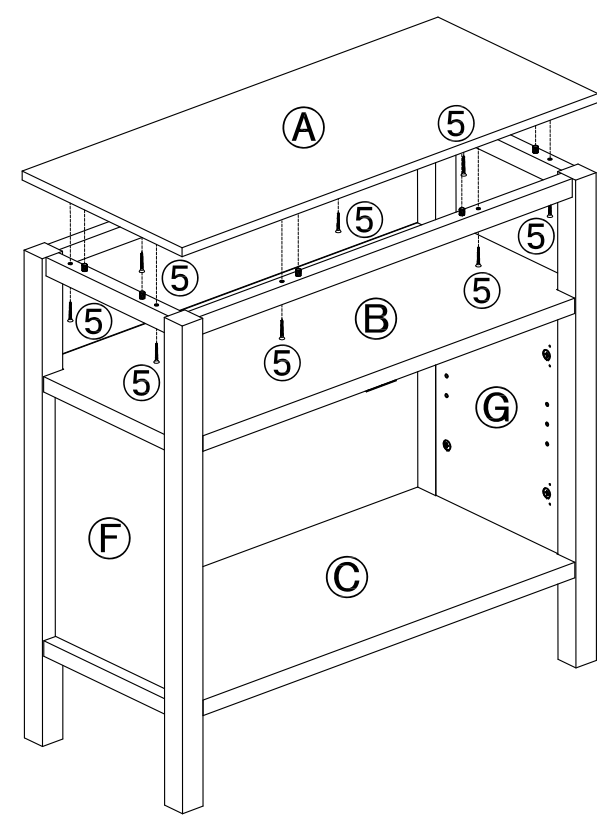

Vis #2

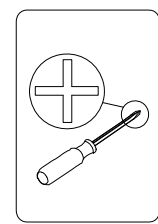

11

Insérez la pièce ⑦ (supports d'étagère) dans les cadres latéraux F et G à la hauteur désirée, puis installez la tablette.

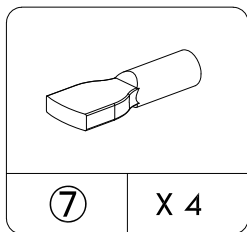
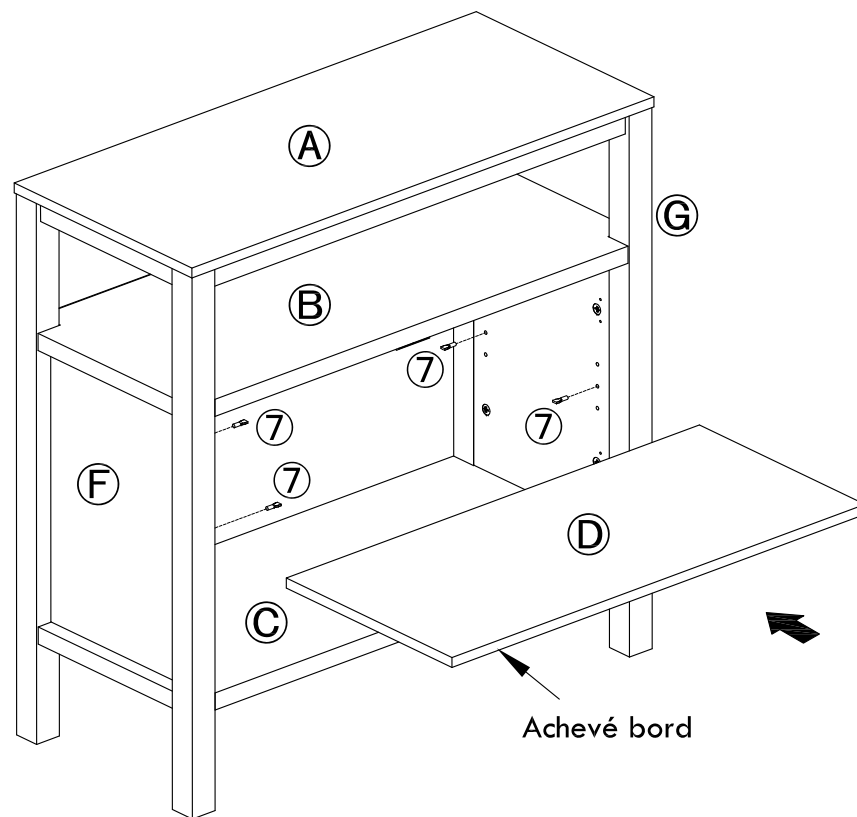

Support d'étagère

12

Utilisez la pièce ⑥ (vis #3) pour fixer le panneau de porte H au cadre latéral F.
Utilisez la pièce ⑥ (vis #3) pour fixer le panneau de porte I au cadre latéral G.

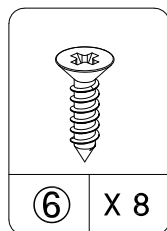
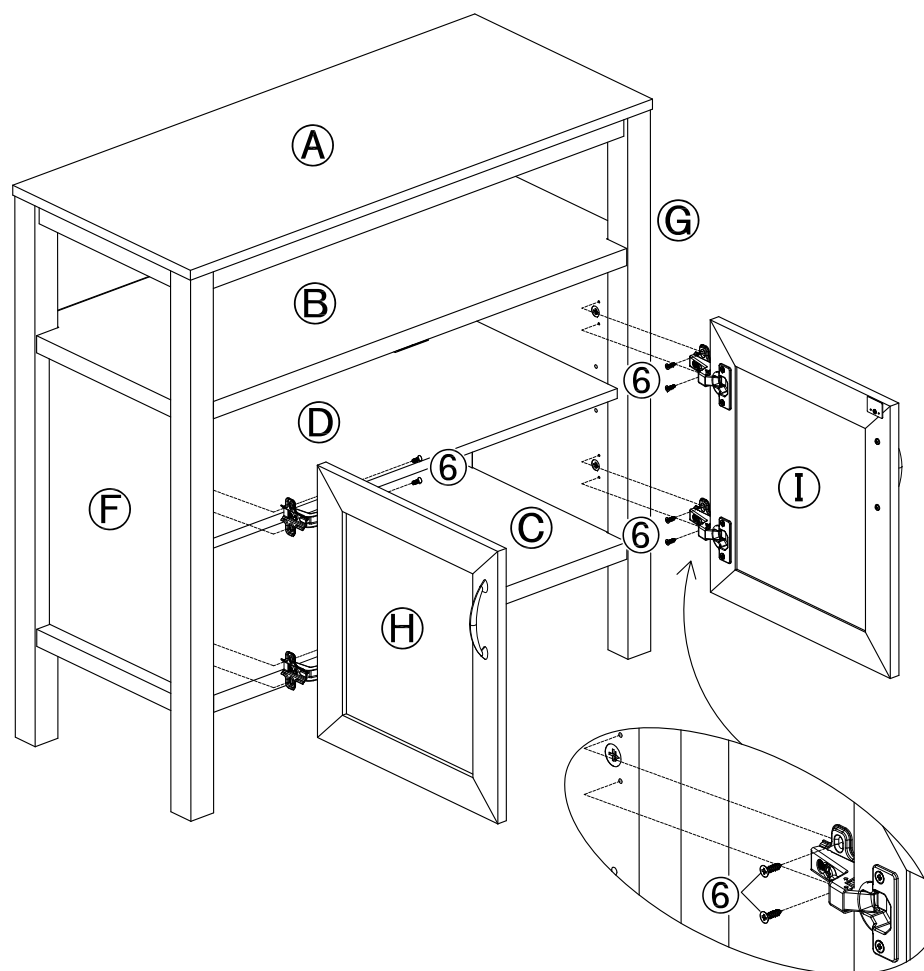
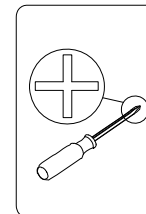

Vis #3

13

Si nécessaire, ajustez les charnières pour aligner correctement les portes comme indiqué ci-dessous, ou scannez le code QR pour voir une vidéo d'instruction.

Vidéo sur l'ajustement des charnières de porte

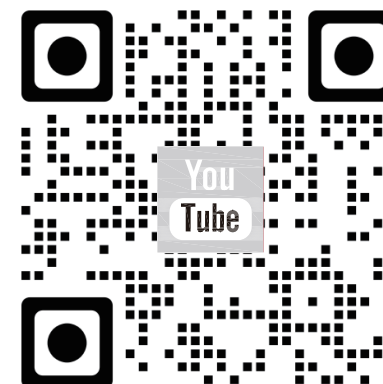
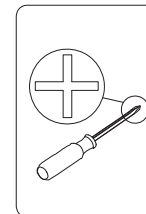

Possibilités de réglage

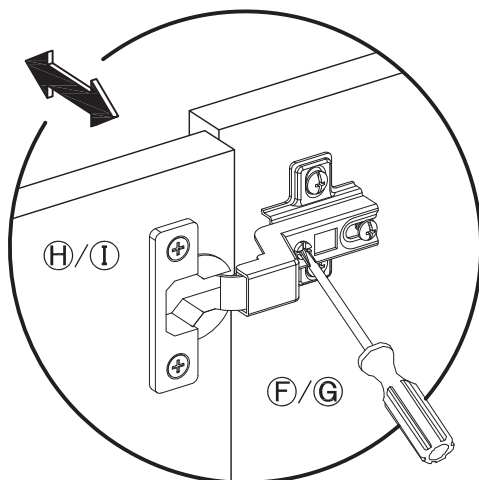

Ajustement horizontal

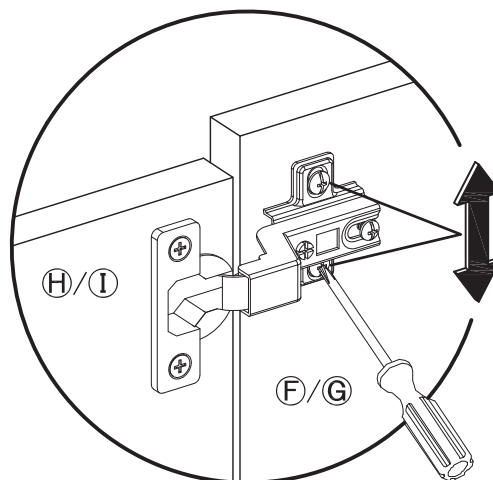

Ajustement vertical

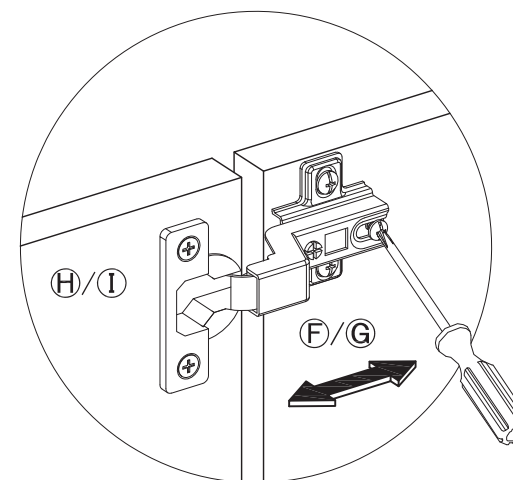

Ajustement vers l'avant/vers l'arrière

**FÉLICITATIONS, CETTE UNITÉ EST UNE UNITÉ COMPLÈTE.
PROFITEZ-EN ET PARLEZ DE VOTRE EXPÉRIENCE!**

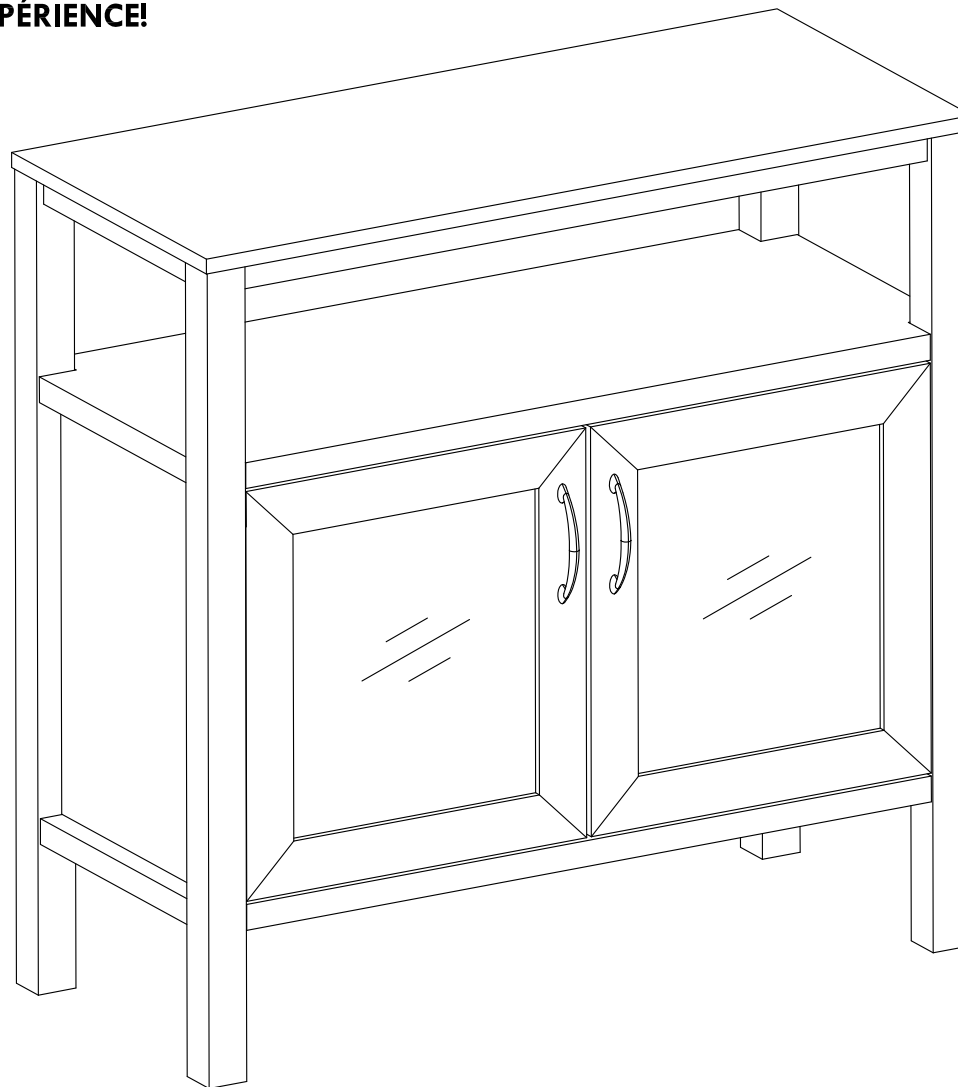

**S'il vous plaît appelez pour des pièces de rechange ou de d'aide:
1-800-729-1569 Lundi-Vendredi 9am-5pm.**